





**CURVE TABLE**

CURVE	RADIUS	ARC	LTH	CHD	LTH	CHD	BEARING	DELTA
C20	30.00'	3.69'	3.69'				N07°14'20"E	7°03'02"
C21	95.00'	4.30'	4.30'				N87°35'45"E	2°35'43"
C22	125.00'	5.66'	5.66'				S87°35'45"W	2°35'43"
C23	155.00'	7.02'	7.02'				S87°35'45"W	2°35'40"
C24	533.00'	3.05'	3.05'				S00°56'34"E	0°19'39"
C25	331.94'	4.19'	4.19'				S00°28'17"E	0°43'21"
C26	289.00'	6.83'	6.83'				N00°30'17"W	1°21'12"
C27	467.00'	2.60'	2.60'				S00°29'19"E	0°19'08"
C28	467.00'	3.74'	3.74'				S00°52'38"E	0°27'31"
C29	180.01'	136.76'	133.50'				S67°13'03"W	43°31'49"
C31	120.00'	58.91'	58.32'				N74°44'02"E	28°07'37"
C32	120.36'	32.27'	32.18'				N52°58'18"E	15°21'52"
C33	150.00'	113.64'	110.94'				S67°32'04"W	43°24'21"
C34	120.00'	90.91'	88.75'				S67°32'04"W	43°24'20"
C35	180.00'	136.36'	133.13'				S67°32'04"W	43°24'20"
C36	65.00'	29.03'	28.79'				S04°25'25"E	25°35'29"

**LINE TABLE**

#	BEARING	DISTANCE
L1	N03°30'44"E	3.93'
L2	N03°40'59"E	3.93'
L3	S03°42'06"E	61.35'
L4	N03°42'06"W	60.00'
L5	N03°42'06"W	70.00'
L6	N03°42'06"W	70.00'
L7	N03°42'06"W	60.00'
L8	S03°42'06"E	61.35'
L9	S03°42'06"E	61.35'
L10	N03°42'06"W	60.00'
L11	N03°42'06"W	70.00'
L12	N03°42'06"W	70.00'
L13	N03°42'06"W	60.00'
L14	S03°42'06"E	61.35'
L15	N86°17'54"E	65.30'
L16	S01°27'14"E	10.25'
L18	N89°14'14"E	65.51'
L19	N89°39'41"W	19.96'
L20	S89°14'14"W	8.62'
L21	S03°43'24"E	11.18'
L24	S89°51'46"W	20.00'
L25	S00°47'46"W	141.12'

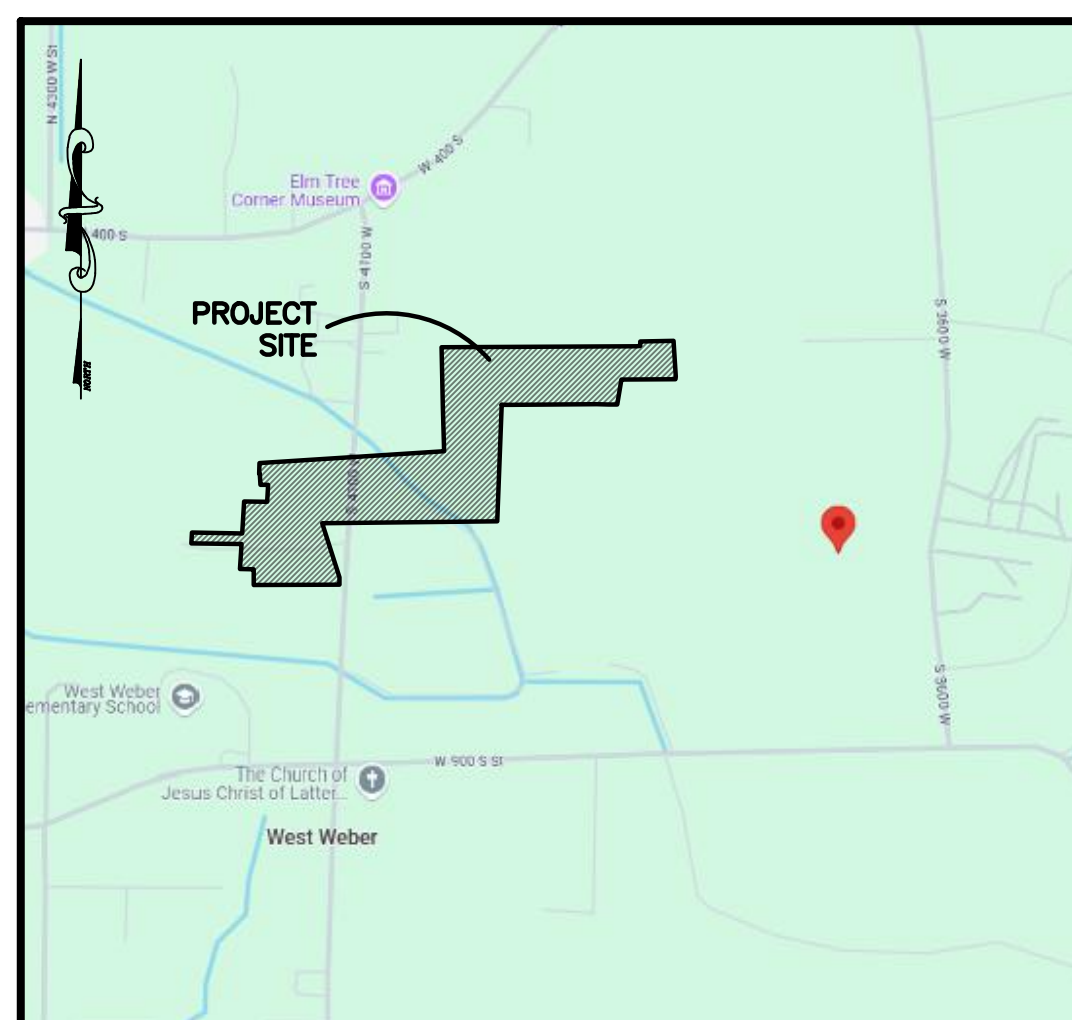

**VICINITY MAP**  
(NOT TO SCALE)

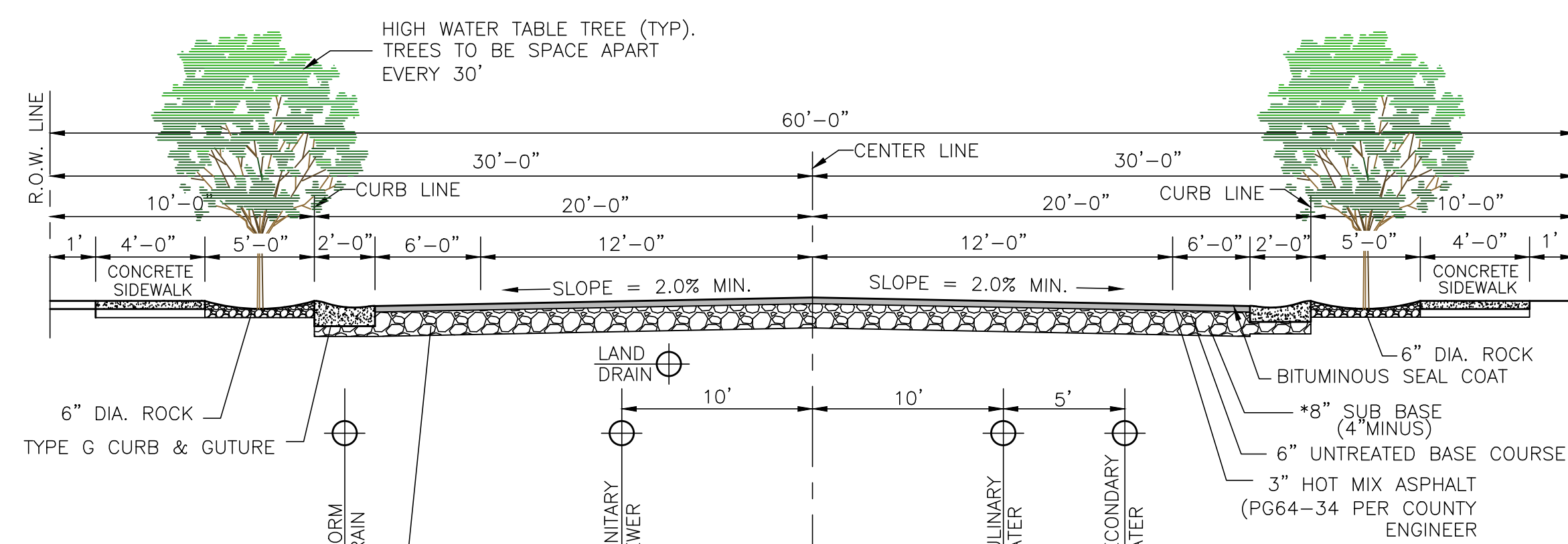

PROVIDE 4" THICKNESS OF 3/4" OR 1" GRAVEL BASE COURSE UNDER SIDEWALK, DRIVEWAY APPROACHES AND CURB & GUTTER WHEN SUBGRADE IS CLAY OR C.B.R. IS LESS THAN 10 OR AS DIRECTED BY COUNTY ENGINEER

**STREET SECTION (60' R.O.W.)  
(STREETS 'A' & 'B' & BITTON LANE,  
HERRICK LANE & LEROY ROAD)**

SCALE: NONE  
\*VERIFY LOCATION WITH PHONE, GAS AND POWER COMPANIES.

**BOUNDARY DESCRIPTION**

PART OF THE SOUTH HALF OF SECTION 16, TOWNSHIP 6 NORTH, RANGE 2 WEST, SALT LAKE BASE AND MERIDIAN, U.S. SURVEY. MORE PARTICULARLY DESCRIBED AS FOLLOWS:

BEGINNING AT A POINT BEING 1416.36 FEET SOUTH 89°15'33" EAST AND 925.77 FEET NORTH 00°44'27" EAST FROM THE SOUTHWEST CORNER OF SAID SECTION 16; (SAID SOUTHWEST CORNER BEING NORTH 89°15'33" WEST 2646.21 FEET FROM THE SOUTH QUARTER CORNER OF SAID SECTION 16);

THENCE NORTH 03°40'59" EAST 64.01 FEET; THENCE SOUTH 89°12'14" EAST 335.79 FEET; THENCE NORTH 00°47'46" EAST 191.38 FEET; THENCE SOUTH 89°12'16" EAST 76.19 FEET; THENCE NORTH 00°47'44" EAST 99.89 FEET; THENCE NORTH 01°55'16" WEST 64.38 FEET; THENCE NORTH 52°57'36" WEST 5.04 FEET; THENCE NORTH 01°30'44" EAST 62.39 FEET; THENCE NORTH 86°17'54" EAST 1104.19 FEET; THENCE NORTH 01°27'14" WEST 620.91 FEET; THENCE NORTH 89°40'16" EAST 1165.20 FEET; THENCE NORTH 85°44'15" EAST 23.15 FEET; THENCE NORTH 00°25'21" EAST 26.20 FEET; THENCE NORTH 89°04'52" EAST 206.12 FEET TO THE CENTERLINE OF 3600 WEST STREET; THENCE SOUTH 03°43'24" EAST 211.14 FEET; THENCE SOUTH 09°23'36" WEST 19.20 FEET; THENCE SOUTH 89°00'54" WEST 167.97 FEET; THENCE SOUTH 00°27'27" EAST 3.06 FEET; THENCE SOUTH 89°32'33" WEST 163.21 FEET; THENCE SOUTH 09°24'33" WEST 150.00 FEET; THENCE SOUTH 89°38'05" WEST 50.18 FEET; THENCE NORTH 88°13'58" WEST 70.71 FEET; THENCE SOUTH 89°34'12" WEST 508.51 FEET; THENCE SOUTH 89°17'40" WEST 59.93 FEET; THENCE SOUTH 02°18'57" WEST 695.99 FEET; THENCE SOUTH 89°22'26" WEST 1045.11 FEET; THENCE SOUTH 17°57'14" EAST 339.19 FEET; THENCE SOUTH 00°47'46" WEST 44.09 FEET TO NORTH LINE OF THE HOOPER IRRIGATION CO PROPERTY; THENCE SOUTH 89°51'46" WEST 525.77 FEET ALONG SAID NORTH LINE; THENCE NORTH 00°08'14" EAST 93.71 FEET; THENCE NORTH 89°12'14" WEST 67.76 FEET; THENCE NORTH 03°30'46" EAST 150.00 FEET; THENCE NORTH 89°12'14" WEST 308.56 FEET TO THE POINT OF BEGINNING.

CONTAINING 1,368,560 SQUARE FEET OR 31.418 ACRES.

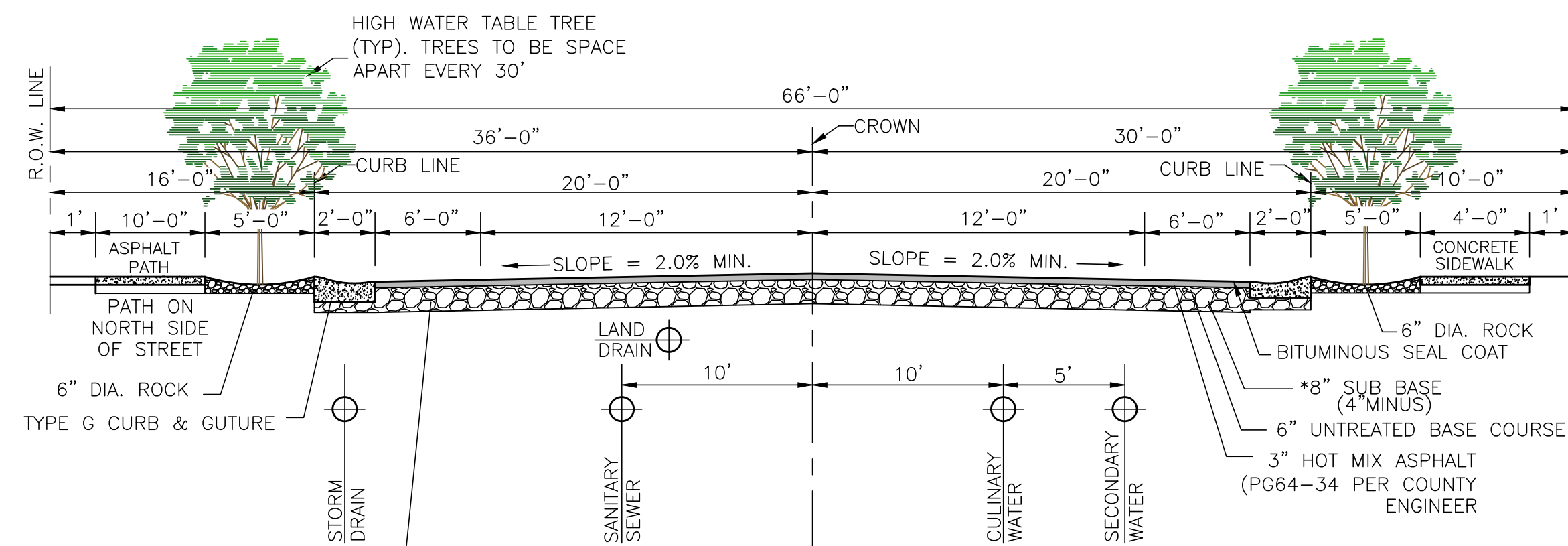

PROVIDE 4" THICKNESS OF 3/4" OR 1" GRAVEL BASE COURSE UNDER SIDEWALK, DRIVEWAY APPROACHES AND CURB & GUTTER WHEN SUBGRADE IS CLAY OR C.B.R. IS LESS THAN 10 OR AS DIRECTED BY COUNTY ENGINEER

**STREET SECTION (66' R.O.W.)  
(STREET 'C' & 4100 WEST STREET)**

SCALE: NONE  
\*VERIFY LOCATION WITH PHONE, GAS AND POWER COMPANIES.

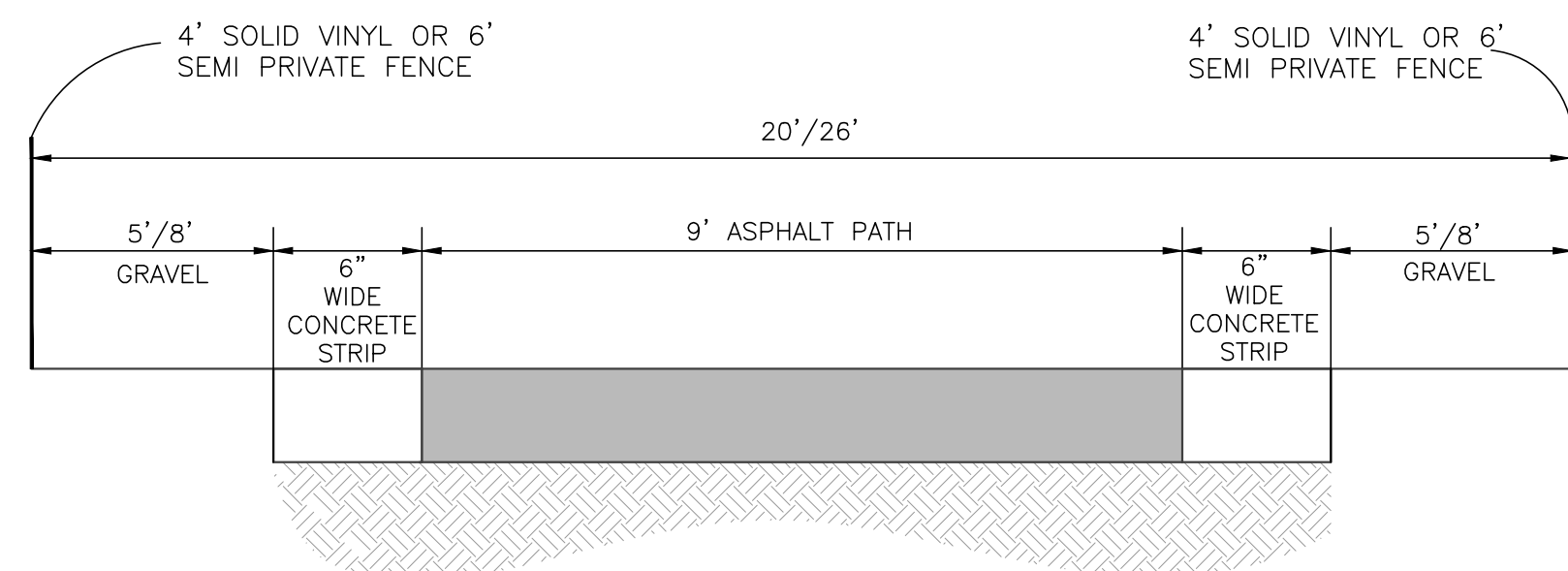

**20'/26' TRAIL EASEMENT DETAIL**

SCALE: NONE

**Herrick Estates**

Weber County, Utah



REVISIONS	DESCRIPTION
DATE	

**Herrick Estates**  
PART OF THE WEST HALF OF SECTION 16, T.6N., R.2W., S.11B.&M., U.S. SURVEY  
WEBER COUNTY, UTAH

**Details Sheet**

**Project Info.**

Engineer:	N. Reeve
Planner:	C. Cove
Designer:	S. Simrayh
Date:	4-3-25
Name:	HERRICK ESTATES
Number:	6298-39

Sheet	<b>2</b>
<b>2</b>	Sheets