

General Notes

- 1. ALL CONSTRUCTION MUST STRICTLY FOLLOW THE STANDARDS AND SPECIFICATIONS SET FORTH BY: GOVERNING UTILITY MUNICIPALITY, GOVERNING CITY OR COUNTY (IF UNINCORPORATED), INDIVIDUAL PRODUCT MANUFACTURERS, AMERICAN PUBLIC WORKS ASSOCIATION (APWA), AND THE DESIGN ENGINEER...

Utility Notes

- 1. CONTRACTOR SHALL COORDINATE LOCATION OF NEW "DRY UTILITIES" WITH THE APPROPRIATE UTILITY COMPANY, INCLUDING BUT NOT LIMITED TO: TELEPHONE SERVICE, GAS SERVICE, CABLE, POWER, INTERNET...

Erosion Control General Notes

- 1. THE CONTRACTOR TO USE BEST MANAGEMENT PRACTICES FOR PROVIDING EROSION CONTROL FOR CONSTRUCTION OF THIS PROJECT. ALL MATERIAL AND WORKMANSHIP SHALL CONFORM TO GOVERNING AGENCIES ORDINANCES AND ALL WORK SHALL BE SUBJECT TO INSPECTION BY THE COUNTRIES. ALSO, INSPECTORS WILL HAVE THE RIGHT TO CHANGE THE FACILITIES AS NEEDED...

Maintenance

- 1. ALL BEST MANAGEMENT PRACTICES (BMP'S) SHOWN ON THIS PLAN MUST BE MAINTAINED AT ALL TIMES UNTIL PROJECT CLOSE-OUT. THE CONTRACTOR'S RESPONSIBILITY SHALL INCLUDE MAKING BI-WEEKLY CHECKS ON ALL EROSION CONTROL MEASURES TO DETERMINE IF REPAIR OR SEDIMENT REMOVAL IS NECESSARY. CHECKS SHALL BE DOCUMENTED AND COPIES OF THE INSPECTIONS KEPT ON SITE...

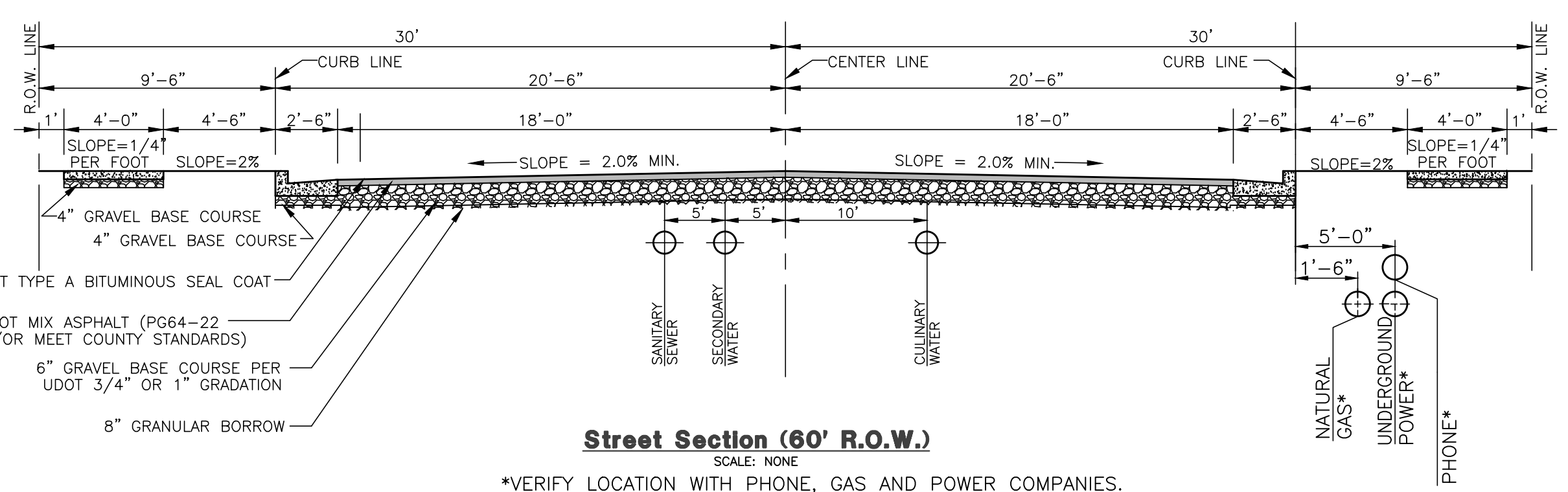

Street Section (60' R.O.W.) *VERIFY LOCATION WITH PHONE, GAS AND POWER COMPANIES.

Master Legend

- W--- = PROPOSED CULINARY WATER LINE
---EX.W--- = EXISTING CULINARY WATER LINE
---SS--- = PROPOSED SANITARY SEWER LINE
---EX.SS--- = EXISTING SANITARY SEWER LINE
---SD--- = PROPOSED STORM DRAIN LINE
---EX.SD--- = EXISTING STORM DRAIN LINE
---LD--- = PROPOSED LAND DRAIN LINE
---EX.LD--- = EXISTING LAND DRAIN LINE
---SW--- = PROPOSED SECONDARY WATER LINE
---EX.SW--- = EXISTING SECONDARY WATER LINE
---IRR--- = PROPOSED IRRIGATION LINE
---EX.IRR--- = EXISTING IRRIGATION LINE
---OHP--- = EXISTING OVERHEAD POWER LINE
---TEL--- = EXISTING TELEPHONE LINE
---GAS--- = EXISTING NATURAL GAS LINE
---X---X---X--- = EXISTING EDGE OF PAVEMENT
---M---M---M--- = MASONRY BLOCK/RETAINING WALL
---D---D---D--- = DITCH/SWALE FLOWLINE
● = PROPOSED FIRE HYDRANT
○ = EXISTING FIRE HYDRANT
○ = PROPOSED MANHOLE
○ = EXISTING MANHOLE
● = PROPOSED SEWER CLEAN-OUT
X = PROPOSED GATE VALVE
X = EXISTING GATE VALVE
□ = PROPOSED WATER METER
□ = EXISTING WATER METER
■ = PROPOSED CATCH BASIN
L.F. = LINEAR FEET
NG = NATURAL GRADE
O.C. = ON CENTER
PC = POINT OF CURVE
PRC = POINT OF REVERSE CURVE
PRVC = POINT OF VERTICAL CURVE
PT = POINT OF TANGENT
PP = PUBLIC UTILITY POLE
P.U.E. = PUBLIC UTILITY EASEMENT
R/C = REBAR & CAP
RCB = REINFORCED CONCRETE BOX
RCP = REINFORCED CONCRETE PIPE
RIM = RIM OF MANHOLE
R.O.W. = RIGHT-OF-WAY
SD = STORM DRAIN
SS = SANITARY SEWER
SW = SECONDARY WATER
TBC = TOP BACK OF CURB
TOE = TOE OF SLOPE
TOP = TOP OF SLOPE
TOW = TOP OF WALL
TSW = TOP OF SIDEWALK
VPI = VERTICAL POINT OF INTERSECT.
W = CULINARY WATER
WM = WATER METER
--- = PROPOSED PAVEMENT
--- = PROPOSED CONCRETE

General Project Notes

- 1. ALL CONSTRUCTION ON THIS PROJECT SHALL CONFORM TO THE DEVELOPMENT STANDARDS OF WEBER COUNTY AND THE STANDARD DRAWINGS CONTAINED THEREIN. WEBER COUNTY PUBLIC WORKS REQUIREMENTS SHALL BE MET.

SECONDARY WATER NOTES

- 1. ALL SECONDARY WATER SHALL BE IN CONFORMANCE WITH HOOPER IRRIGATION WATER STANDARDS. ALL SECONDARY WATER MAINS TO HAVE A MINIMUM OF 4' OF COVER.

Reeve & Associates, Inc. logo and revision table with columns for DATE, DESCRIPTION, and REVISIONS.

Blue Acres Subdivision Phase-4 Notes/Legend/ Street Cross-Section

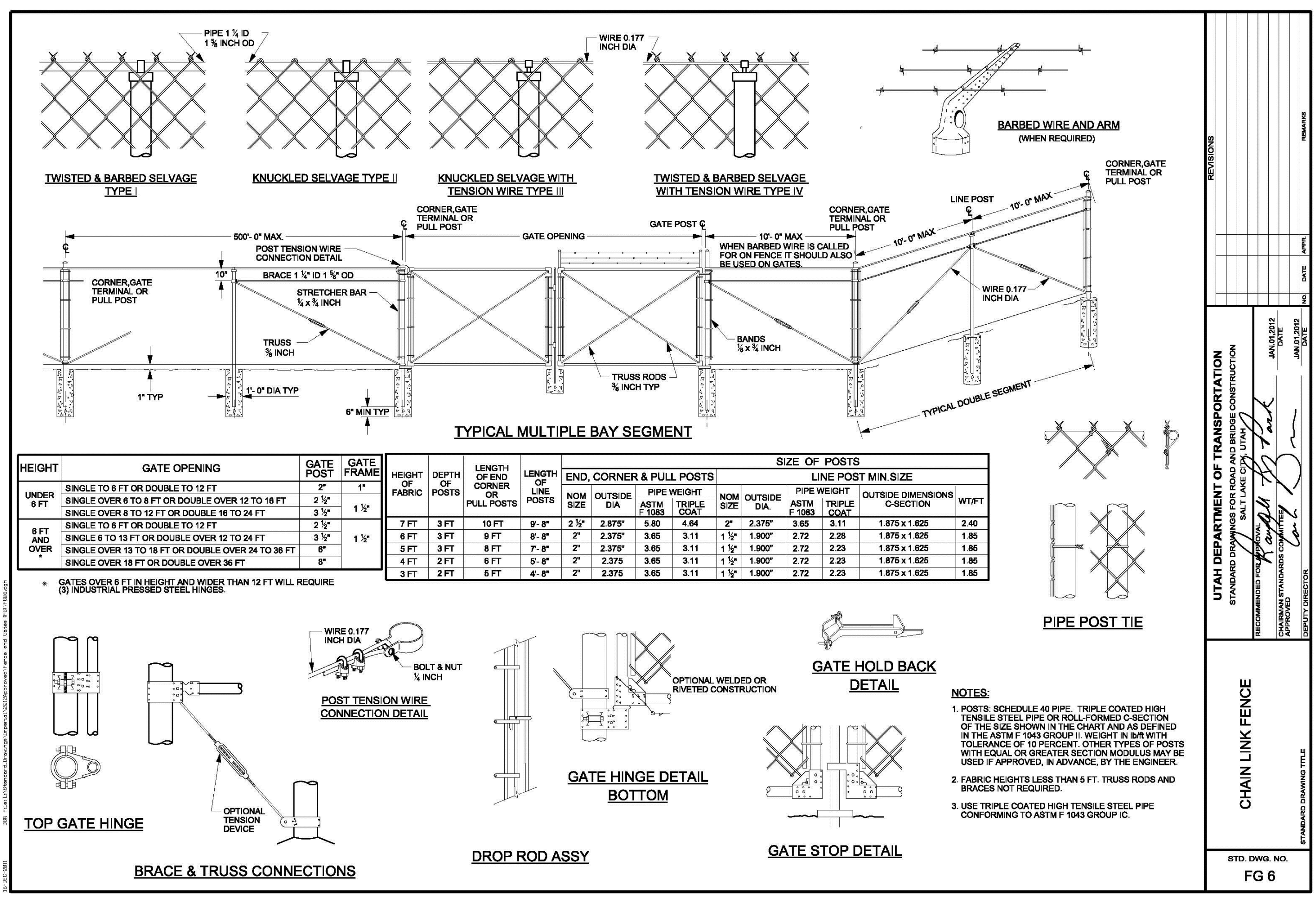

Revised: 11-25-15

Professional Engineer seal for J. NATE REEVE, STATE OF UTAH.

Project Info. Engineer: J. NATE REEVE, P.E. Drafter: R. HANSEN. Begin Date: JUNE 10, 2014. Name: BLUE ACRES SUBDIVISION PHASE-4. Number: 5036-01.

Sheet 2 of 8 Sheets