

Irrigation Crossing Detail
SCALE: 1"=2'

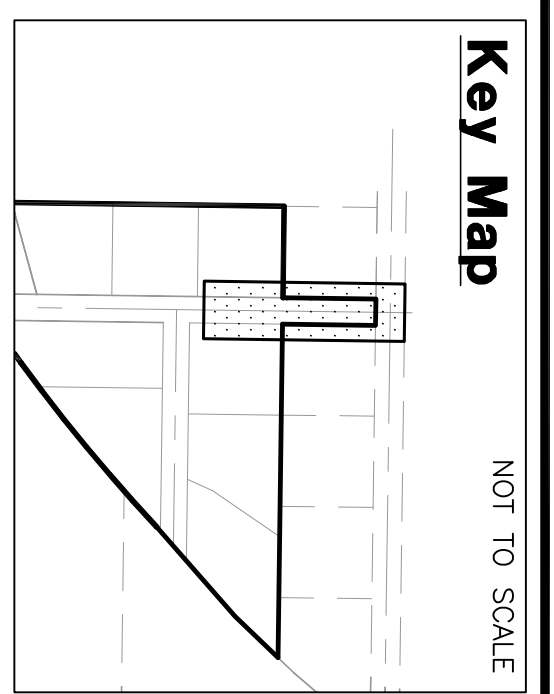
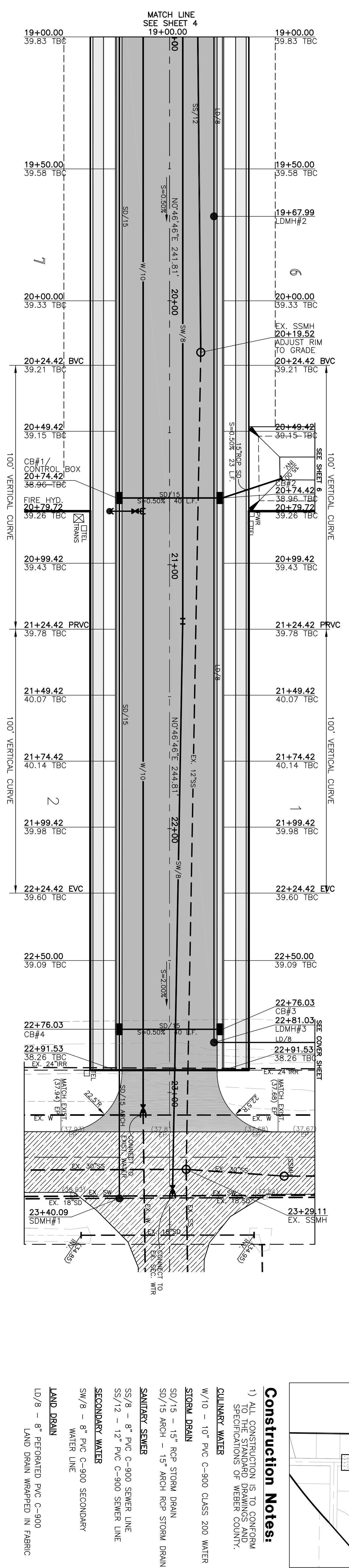
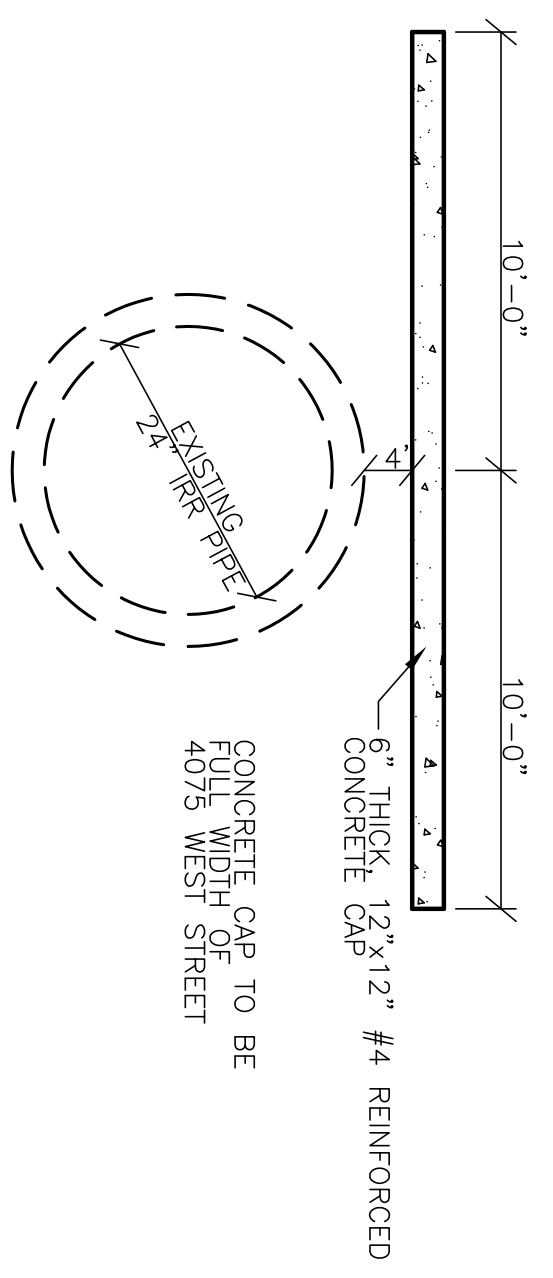

Construction Notes:

- 1) ALL CONSTRUCTION IS TO CONFORM TO THE STANDARD DRAWINGS AND SPECIFICATIONS OF WEBER COUNTY.
- CULINARY WATER
- W/10 - 10" PVC C-900 CLASS 200 WATER STORM DRAIN
- SD/15 - 15" RCP STORM DRAIN
- SD/15 ARCH - 15" ARCH RCP STORM DRAIN
- SANITARY SEWER
- SS/8 - 8" PVC C-900 SEWER LINE
- SS/12 - 12" PVC C-900 SEWER LINE
- SECONDARY WATER
- SW/8 - 8" PVC C-900 SECONDARY WATER LINE
- LAND DRAIN
- LD/8 - 8" PERFORATED PVC C-900 LAND DRAIN WRAPPED IN FABRIC

THESE PLANS AND SPECIFICATIONS ARE THE PROPERTY OF REEVE & ASSOCIATES, INC., 920 CHAMBERS STREET #14, OGDEN, UTAH 84403, AND SHALL NOT BE PHOTOCOPIED, RE-DRAWN, OR USED ON ANY PROJECT OTHER THAN THE PROJECT SPECIFICALLY DESIGNED FOR, WITHOUT THEIR WRITTEN PERMISSION. THE OWNERS AND ENGINEERS OF REEVE & ASSOCIATES, INC. DISCLAIM ANY LIABILITY FOR ANY CHANGES OR MODIFICATIONS MADE TO THESE PLANS ON THE DESIGN THEREON WITHOUT THEIR CONSENT.

Blue Stokes Location Center
Call: Toll Free
1-800-662-4111
Two Working Days Before You Dig

Revised: 2-11-15

Blue Acres Subdivision Phase-4
WEBER COUNTY, UTAH

4075 West Street
19+00.00 - 23+50.00

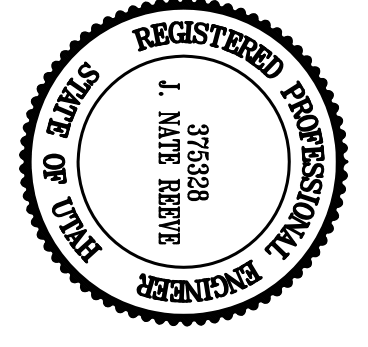

Project Info:
Engineer: J. NATE REEVE, P.E.
Order: R. HANSEN
Begin Date: JUNE 10, 2014
Name: BLUE ACRES SUBDIVISION
Number: 5036-01

REVISIONS	
DATE	DESCRIPTION
9-3-14 RH	Client Changes
1-12-15 RH	County Comments
1-20-15 RH	County Comments
2-11-15 RH	Client Changes

Reeve & Associates, Inc.
920 CHAMBERS STREET, SUITE 14, OGDEN, UTAH 84403
TEL: (801) 621-3100 FAX: (801) 621-2666 www.reeve-associ.com
LAND PLANNERS • CIVIL ENGINEERS • LAND SURVEYORS
TRAFFIC ENGINEERS • STRUCTURAL ENGINEERS • LANDSCAPE ARCHITECTS