

**Construction Notes:**

1) ALL CONSTRUCTION IS TO CONFORM TO THE STANDARD DRAWINGS AND SPECIFICATIONS OF WEBER COUNTY.

**CULINARY WATER**

W/10 - 10" PVC C-900 CLASS 200 WATER

**STORM DRAIN**

SD/15 - 15" RCP STORM DRAIN  
SD/15 ARCH - 15" ARCH RCP STORM DRAIN

**SANITARY SEWER**

SS/8 - 8" PVC C-900 SEWER LINE  
SS/12 - 12" PVC C-900 SEWER LINE

**SECONDARY WATER**

SW/8 - 8" PVC C-900 SECONDARY WATER LINE

**LAND DRAIN**

LD/8 - 8" PERFORATED PVC C-900 LAND DRAIN WRAPPED IN FABRIC

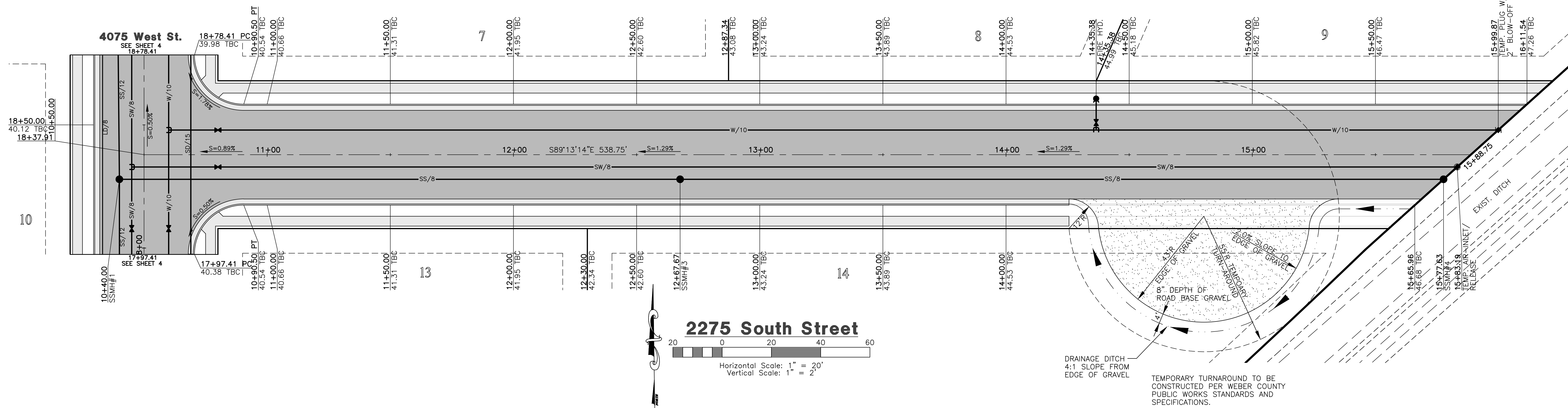

**2275 South Street**

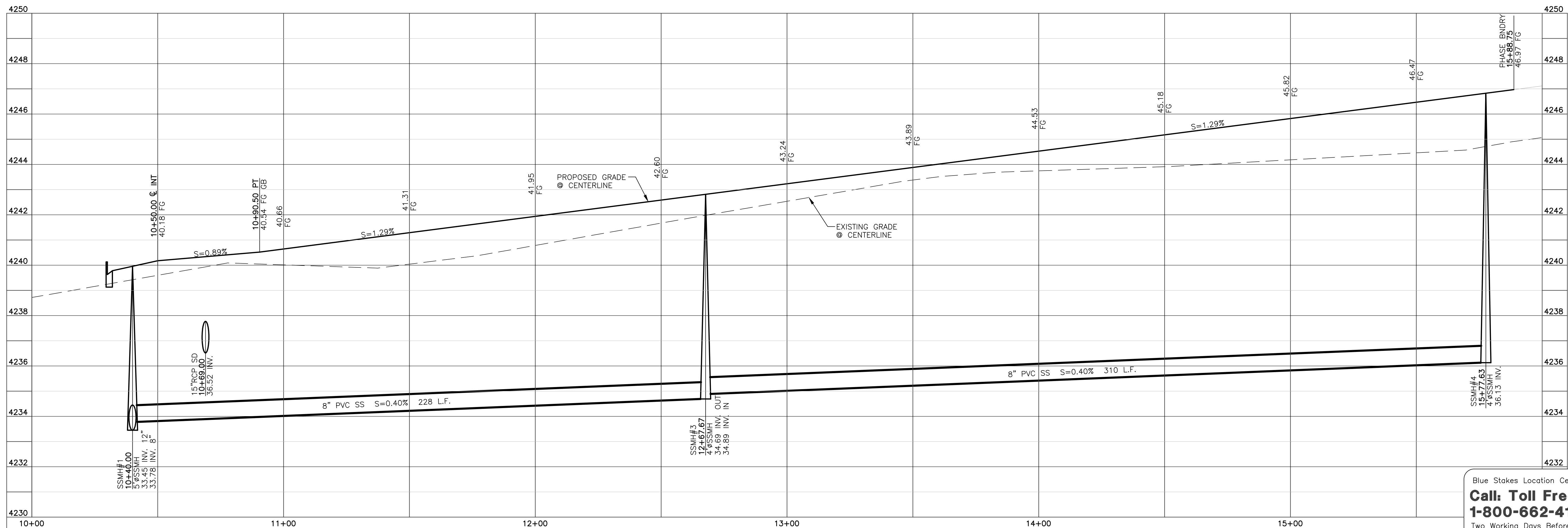
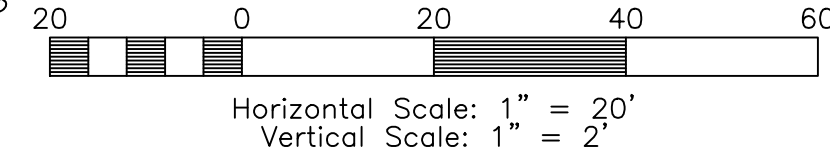

Blue Stakes Location Center  
**Call: Toll Free 1-800-662-4111**  
Two Working Days Before You Dig

**Reeve & Associates, Inc.**  
920 CHAMBERS STREET, SUITE 14, OGDEN, UTAH 84403  
TEL: (801) 621-2100 FAX: (801) 621-2666 www.reeve-assoc.com

**IRA**  
LAND PLANNERS • CIVIL ENGINEERS • LAND SURVEYORS  
TRAFFIC ENGINEERS • STRUCTURAL ENGINEERS • LANDSCAPE ARCHITECTS

DATE	DESCRIPTION
9-3-14	RRH Client Changes
1-12-15	RRH County Comments
1-20-15	RRH County Comments
2-11-15	RRH Client Changes
3-17-15	TP County Comments

**Blue Acres Subdivision Phase-4**  
WEBER COUNTY, UTAH  
**2275 South Street**  
**10+00.00 - 15+50.00**

Revised: 3-17-15



**Project Info.**

Engineer:	J. NATE REEVE, P.E.
Drafter:	R. HANSEN
Begin Date:	JUNE 10, 2014
Name:	BLUE ACRES SUBDIVISION PHASE-4
Number:	5036-01

Sheet **8**  
5 Sheets