



Land Use Permit

Weber County Planning Commission

2380 Washington Blvd. STE 240

Ogden, UT 84401

Phone: 801-399-8374 FAX: 801-399-8862

webercountyutah.gov/planning

Permit Number: LUP287-2023

Permit Type: Structure

Permit Date: 09/12/2023

Applicant

Name: Bronson Archuleta

Business:

Address:

, UT

Phone: 801-689-3630

Owner

Name: Marcus Naylor

Business:

Address: 4602 N 3300 E

Eden, UT 84310

Phone: 801-430-1877

Parcel

Parcel: 220070008

Zoning: AV-3 **Area:** 13.39 **Sq Ft:**

Address: , UT

Parcel: 220070007

Zoning: AV-3 **Area:** 1.72 **Sq Ft:**

Address: 4602 N 3300 E LIBERTY, UT 84310

Lot(s):

Subdivision:

T - R - S - QS: 7N - 1E - 17 -

Lot(s):

Subdivision:

T - R - S - QS: 7N - 1E - 17 -

Proposal

Proposed Structure: Rebuild Structure

Proposed Structure Height: 27

of Dwelling Units:

Off Street Parking Reqd:

Building Footprint: 2109

Max Structure Height in Zone:

of Accessory Bldgs:

***Is Structure > 1,000 Sq. Ft?** N/A

***If True Need Certif. Statement**

Permit Checklist

Access Type: Front lot line

Greater than 4218 ft above sea level? N/A

Additional Setback Reqd. ? N/A

> 200 ft from paved Road? N/A

Culinary Water District:

Alternative Access File #

Wetlands/Flood Zone? N/A

Meet Zone Area Frontage? N/A

Hillside Review Reqd? N/A

Waste Water System:

Comments

Per 108-12-6 Restoration Of Damaged Buildings A noncomplying structure which is damaged or partially destroyed by fire, flood, wind, earthquake, or other calamity, act of God, or the public enemy, may be restored and the occupancy or use of such structure or part thereof, may be continued or resumed, provided that such restoration is started within a period of one year, by obtaining a land use permit, and is diligently pursued to completion.

the land owner may place the structure in the same place as long it is rebuilt within a year of the damage occurring.

The footprint and configuration must be the same and it must be placed in the same spot.

Land Use Permit

Structure Setback Graphic: Storage Shed, Detached Garage, Etc.

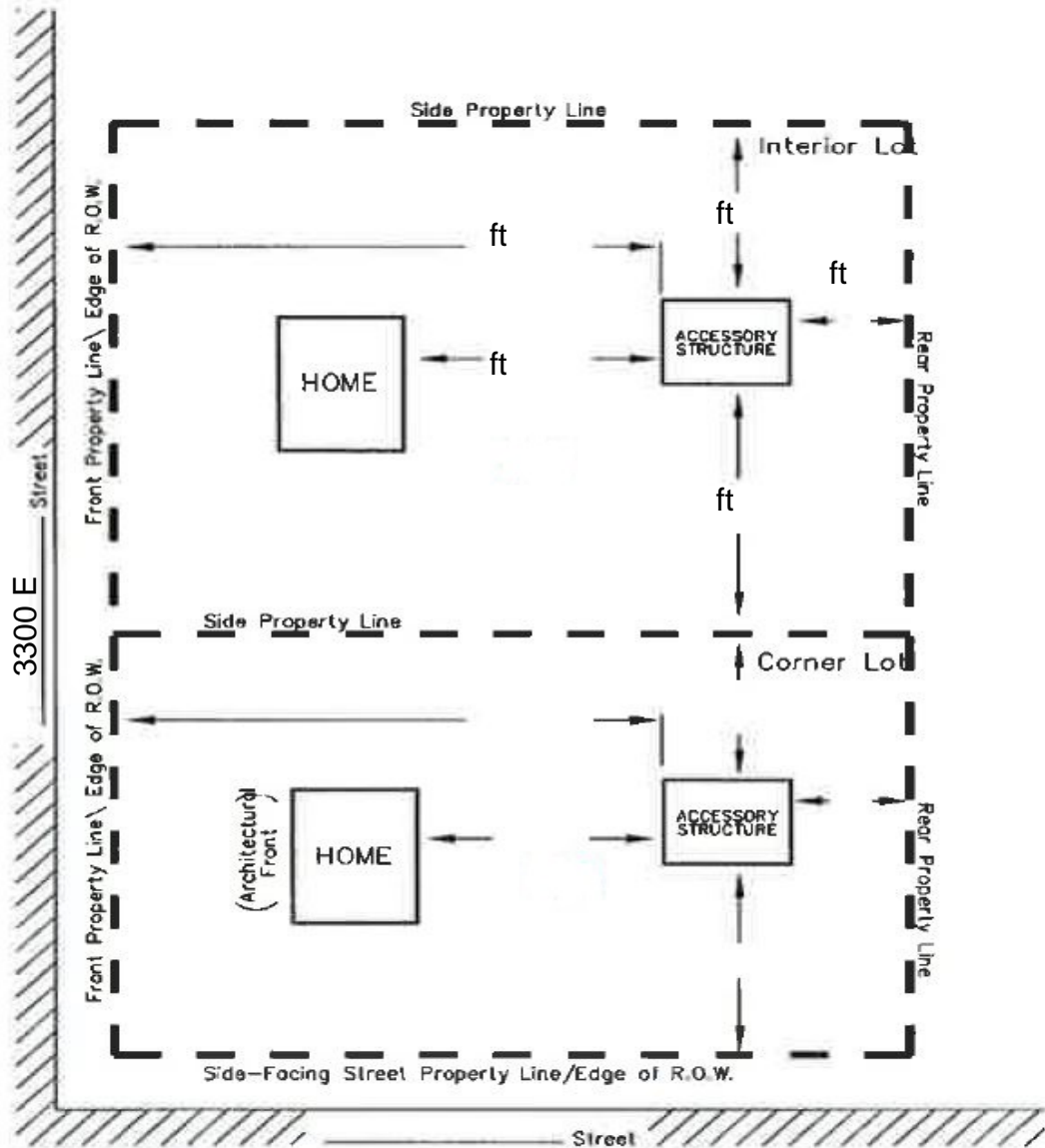

MINIMUM YARD SETBACKS Storage Shed, Detached Garage, Etc.

NOTICE FOR APPLICANT (Please Read Before Signing)

Proposals for the installation of an individual water supply and for a sanitary waste disposal system (septic tank) for any structure designed for human occupation must be approved by Weber County Health Department prior to installation.

Felix Lleverino

09/12/2023

Planning Dept. Signature of Approval

Date

I hereby certify that I have read and examined this application and know the same to be true and correct. All provisions of laws and ordinances governing this land use will be complied with whether specified herein or not. I make this statement under penalty of perjury.

Contractor/Owner Signature of Approval

Date