

ARROWLEAF

PART OF THE NORTH AND EAST HALF OF SECTION 18, TOWNSHIP 7 NORTH, RANGE 1 EAST, SALT LAKE BASE AND MERIDIAN, U.S. SURVEY
WEBER COUNTY, UTAH
MARCH, 2024

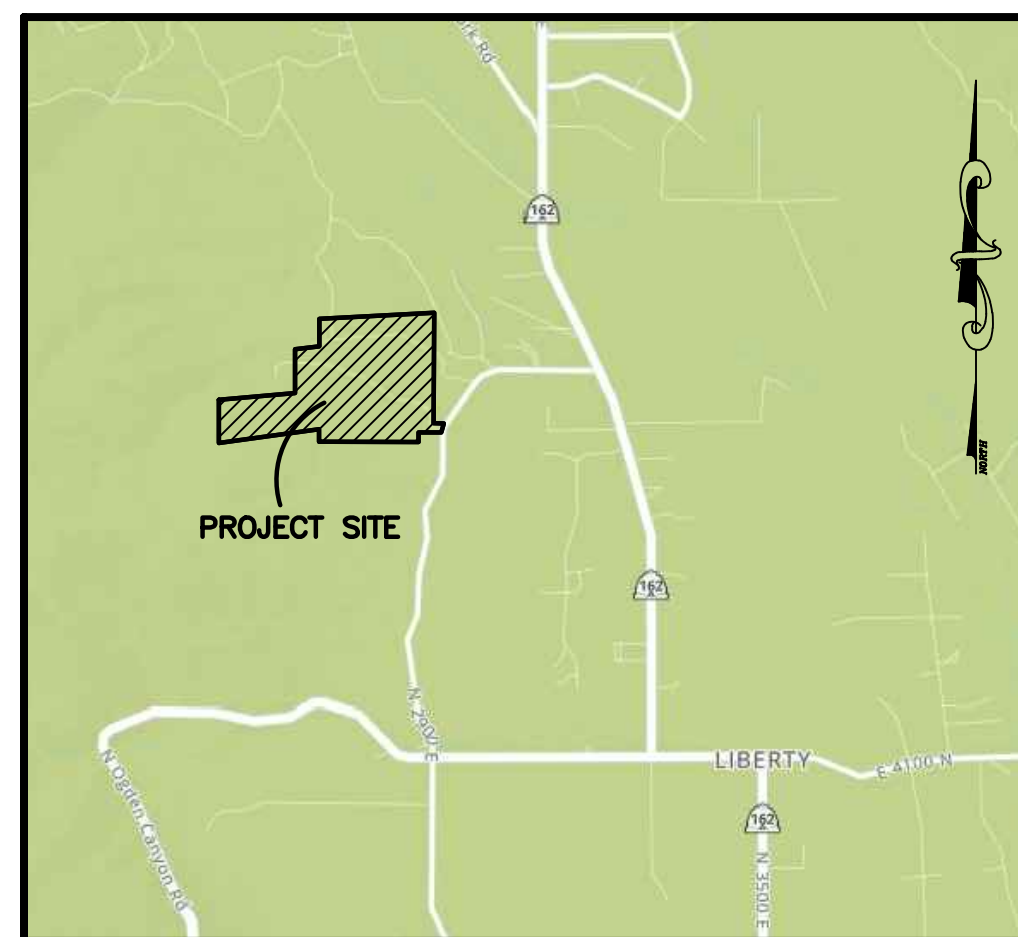

VICINITY MAP
SCALE: NONE

SOIL TEST PIT INFORMATION

EXPLORATION PIT #1 (UTM ZONE 12 NAD 83 42470 E 4577534 N)
0-11" LOAM, GRANULAR STRUCTURE
11-28" SANDY CLAY LOAM, BLOCKY STRUCTURE
28-40" CLAY LOAM, MASSIVE STRUCTURE, 5% GRAVEL
40-65" SANDY CLAY LOAM, MASSIVE STRUCTURE, 10% GRAVEL,
COMMON RED/GRAY MOTTLING
65-115" GRAVELLY SANDY CLAY LOAM, MASSIVE STRUCTURE, 40% GRAVEL

EXPLORATION PIT #2 (UTM ZONE 12 NAD 83 42640 E 4577534 N)
0-18" SANDY LOAM, GRANULAR STRUCTURE
18-64" CLAY LOAM, BLOCKY STRUCTURE, COMMON RED MOTTLING
FINE, DENSE, MOTTLES COMMON BELOW 19"
64-95" SANDY CLAY LOAM, MASSIVE STRUCTURE, 2-5% COBBLE-STONE,
MANY RED MOTTLES

EXPLORATION PIT #3 (UTM ZONE 12 NAD 83 426320 E 4577610 N)
0-18" LOAM, GRANULAR STRUCTURE, <5% GRAVEL
18-44" ANDY LOAM, GRANULAR STRUCTURE, <5% COBBLE
44-85" SAND LOAM MASSIVE STRUCTURE

EXPLORATION PIT #1 (4A) (UTM ZONE 12 NAD 83 426297 E 4577388 N)
0-26" LOAM, GRANULAR STRUCTURE, 5% GRAVEL
26-50" SANDY CLAY LOAM, GRANULAR STRUCTURE TO MASSIVE STRUCTURE,
COMMON RED MOTTLING
50-84" SANDY CLAY LOAM, MASSIVE STRUCTURE, COMMON RED MOTTLES
GROUND WATER ENCOUNTERED AT 90"

EXPLORATION PIT #5A (UTM ZONE 12 NAD 83 426421 E 4577388 N)
0-15" LOAM, GRANULAR STRUCTURE
15-28" LOAM (NEAR SANDY LOAM), BLOCKY STRUCTURE
28-49" LOAM (NEAR SANDY LOAM), MASSIVE STRUCTURE
49-80" GRAVELLY SANDY LOAM, MASSIVE STRUCTURE, 50% GRAVEL &
<5% COBBLE

EXPLORATION PIT #6 (UTM ZONE 12 NAD 83 426194 E 4577463 N)
0-19" GRAVELLY LOAM, GRANULAR STRUCTURE, 15-20% COBBLE STONE
19-55" SANDY LOAM, BLOCKY STRUCTURE, 10-15% GRAVEL, COMMON
RED MOTTLING @36" AND BELOW
55-109" CLAY LOAM, MASSIVE STRUCTURE, MANY RED/GRAY MOTTLES
GROUND WATER ENCOUNTERED AT 109"

EXPLORATION PIT #7 (UTM ZONE 12 NAD 83 426120 E 4577518 N)
0-17" SANDY LOAM, GRANULAR STRUCTURE
17-36" GRAVELLY SANDY LOAM, BLOCKY STRUCTURE, 40-50% GRAVEL
36-64" CLAY LOAM, MASSIVE STRUCTURE, COMMON RED MOTTLING
64-100" SANDY CLAY LOAM, MASSIVE STRUCTURE, 5-10% GRAVEL,
COMMON RED MOTTLING

EXPLORATION PIT #8 (UTM ZONE 12 NAD 83 426211 E 4577641 N)
0-20" GRAVELLY SANDY LOAM, GRANULAR STRUCTURE, 15% GRAVEL
21-123" GRAVELLY SANDY LOAM, MASSIVE STRUCTURE, 45%
GRAVEL-COBBLE

EXPLORATION PIT #9 (UTM ZONE 12 NAD 83 426073 E 4577608 N)
0-30" FINE SANDY LOAM, GRANULAR STRUCTURE, 5% GRAVEL
31-126" GRAVELLY FINE SANDY LOAM, MASSIVE STRUCTURE, 25% GRAVEL
COBBLE

DEVELOPER:

DAVID CHUGG
1648 FARR WEST DR.
OGDEN, UT 84404

WEBER COUNTY PLANNING COMMISSION APPROVAL

THIS IS TO CERTIFY THAT THIS SUBDIVISION PLAT WAS DULY APPROVED BY THE WEBER COUNTY PLANNING COMMISSION.
SIGNED THIS _____ DAY OF _____, 20____.

CHAIRMAN, WEBER COUNTY PLANNING COMMISSION

WEBER COUNTY ENGINEER

I HEREBY CERTIFY THAT THE REQUIRED PUBLIC IMPROVEMENT STANDARDS AND DRAWINGS FOR THIS SUBDIVISION CONFORM WITH THE COUNTY STANDARDS AND THE AMOUNT OF THE FINANCIAL GUARANTEE IS SUFFICIENT FOR THE INSTALLATION OF THESE IMPROVEMENTS.

WEBER COUNTY ENGINEER

WEBER COUNTY COMMISSION ACCEPTANCE

THIS IS TO CERTIFY THAT THIS SUBDIVISION PLAT, THE DEDICATION OF STREETS AND OTHER PUBLIC WAYS AND FINANCIAL GUARANTEE OF PUBLIC IMPROVEMENTS ASSOCIATED WITH THIS SUBDIVISION, THEREON ARE HEREBY APPROVED AND ACCEPTED BY THE COMMISSIONERS OF WEBER COUNTY, UTAH.
SIGNED THIS _____ DAY OF _____, 20____.

CHAIRMAN, WEBER COUNTY COMMISSION

ATTEST TITLE

WEBER COUNTY SURVEYOR

I HEREBY CERTIFY THAT THE WEBER COUNTY SURVEYOR'S OFFICE HAS REVIEWED THIS PLAT AND ALL CONDITIONS FOR APPROVAL BY THIS OFFICE HAVE BEEN SATISFIED. THE APPROVAL OF THIS PLAT BY THE WEBER COUNTY SURVEYOR DOES NOT RELIEVE THE LICENSED LAND SURVEYOR WHO EXECUTED THIS PLAT FROM THE RESPONSIBILITIES AND/OR LIABILITIES ASSOCIATED THEREWITH

SIGNED THIS _____ DAY OF _____, 20____.

WEBER COUNTY SURVEYOR

WEBER COUNTY ATTORNEY

I HAVE EXAMINED THE FINANCIAL GUARANTEE AND OTHER DOCUMENTS ASSOCIATED WITH THIS SUBDIVISION PLAT, AND IN MY OPINION THEY CONFORM WITH THE COUNTY ORDINANCE APPLICABLE THERETO AND NOW IN FORCE AND EFFECT.
SIGNED THIS _____ DAY OF _____, 20____.

WEBER COUNTY ATTORNEY

WEBER-MORGAN HEALTH DEPARTMENT

I HEREBY CERTIFY THAT THE SOILS, PERCOLATION RATES, AND SITE CONDITIONS FOR THIS SUBDIVISION HAVE BEEN INVESTIGATED BY THIS OFFICE AND ARE APPROVED FOR ON-SITE WASTEWATER DISPOSAL SYSTEMS.
SIGNED THIS _____ DAY OF _____, 20____.

DIRECTOR, WEBER-MORGAN HEALTH DEPARTMENT

Weber County Recorder

Entry No. _____ Fee Paid _____
And Recorded, _____
At _____ in Book _____
Of The Official Records, Page _____
Recorded For: _____
Weber County Recorder _____
Deputy: _____

CURVE TABLE

CURVE	RADIUS	ARC LTH	CHD LTH	CHD BEARING	DELTA
C1	530.06'	107.31'	107.13'	S15°28'07"W	11°36'
C2	530.06'	69.55'	69.50'	S17°30'36"W	7°31'03"
C3	530.06'	37.77'	37.76'	S11°42'36"W	4°04'57"
C4	100.00'	91.87'	86.67'	N51°42'39"W	52°38'08"
C5	100.00'	128.01'	119.44'	N31°41'31"W	73°20'30"
C6	150.00'	69.19'	68.57'	N55°08'57"W	26°29'37"
C7	150.00'	68.66'	68.07'	N55°14'56"W	26°13'40"
C8	150.00'	0.52'	0.52'	N42°02'07"W	0°11'56"
C9	500.00'	71.10'	71.04'	N46°00'37"W	8°08'51"
C10	300.00'	94.80'	94.41'	N59°08'12"W	18°06'20"
C11	300.00'	93.91'	93.53'	N59°13'19"W	17°56'07"
C12	300.00'	49.47'	49.42'	N63°27'54"W	9°26'56"
C13	300.00'	44.43'	44.39'	N54°29'51"W	8°29'11"
C14	88.45'	163.04'	140.91'	S76°56'16"W	105°36'57"
C15	88.45'	83.72'	80.63'	N77°22'16"W	5°41'41"
C16	88.45'	79.32'	76.69'	S49°49'16"W	51°22'56"
C17	84.25'	303.77'	164.00'	N86°32'59"E	206°34'35"
C18	84.25'	140.78'	124.97'	S38°01'50"E	95°44'13"
C19	84.25'	162.99'	138.74'	N38°40'53"E	110°50'23"
C20	90.00'	190.38'	156.82'	S84°43'51"W	121°12'07"
C21	90.00'	165.77'	143.31'	S76°53'51"W	105°32'06"
C22	90.00'	24.61'	24.53'	N42°30'06"W	15°40'01"
C23	30.00'	23.61'	23.01'	N57°13'04"W	45°05'57"
C24	30.00'	23.61'	23.01'	N12°07'07"W	45°05'57"
C25	545.54'	176.85'	176.08'	N70°20'35"E	18°34'25"
C26	1060.36'	122.23'	122.17'	N75°57'55"E	8°36'17"
C27	240.15'	117.96'	116.78'	N87°42'58"E	28°08'37"
C28	295.67'	192.38'	189.00'	N82°24'54"E	37°16'46"
C29	497.46'	59.81'	59.77'	S48°33'06"W	6°53'18"
C30	435.96'	134.04'	133.51'	S42°38'09"W	17°36'58"
C31	183.49'	62.01'	61.71'	S40°46'32"W	19°21'44"
C32	1209.63'	224.65'	224.32'	N60°41'23"E	10°38'27"
C33	320.66'	276.79'	268.28'	N85°20'38"E	49°27'30"
C34	160.14'	103.72'	101.91'	S54°39'32"E	37°06'29"
C35	327.08'	147.34'	146.10'	S49°35'16"E	25°43'39"
C36	216.99'	114.24'	112.93'	S75°01'53"E	30°09'51"
C37	557.26'	68.21'	68.17'	N86°34'53"E	7°00'48"
C38	106.42'	112.83'	107.62'	S69°02'07"E	60°44'41"
C39	176.85'	91.34'	90.33'	S56°40'49"E	29°35'33"
C40	246.57'	85.14'	84.72'	S68°14'56"E	19°47'02"
C41	912.30'	154.92'	154.73'	S62°31'27"E	9°43'46"
C42	201.54'	26.06'	26.04'	N73°42'20"W	7°24'29"
C43	258.70'	47.93'	47.86'	N73°24'54"W	10°36'53"
C44	123.57'	62.55'	61.89'	N84°57'07"W	29°00'12"
C45	87.53'	67.27'	65.63'	N76°38'21"W	44°02'14"
C46	162.51'	114.22'	111.88'	N73°18'57"W	40°16'15"
C47	147.87'	60.30'	59.88'	N82°12'31"W	23°21'49"
C48	127.86'	77.94'	76.74'	N84°58'57"W	34°55'40"
C49	245.20'	108.91'	108.02'	N84°10'40"W	25°26'58"
C50	99.78'	73.34'	71.70'	S87°25'40"W	42°06'39"
C51	71.56'	45.89'	45.11'	S84°38'52"W	36°44'36"
C52	62.17'	59.10'	56.90'	S77°13'52"W	54°27'39"
C53	193.47'	157.66'	153.33'	S79°58'03"W	46°41'20"

LINE TABLE

#	BEARING	DISTANCE	#	BEARING	DISTANCE
L1	N68°21'46"W	112.84'	L49	S87°11'36"W	94.09'
L2	N68°21'46"W	94.87'	L50	S37°05'24"W	151.94'
L3	N68°21'46"W	17.98'	L51	N48°48'47"W	152.46'
L4	N41°56'12"W	63.50'	L52	N63°44'43"E	150.85'
L5	N50°15'16"W	56.89'	L53	S57°08'05"E	84.63'
L6	N50°15'16"W	22.52'	L54	S62°37'32"E	33.49'
L7	N50°15'16"W	34.37'	L55	S51°42'56"E	80.20'
L8	N52°10'58"W	70.74'	L56	N37°08'39"E	134.41'
L9	S74°21'37"W	66.86'	L57	N55°01'27"W	81.15'
L10	S46°02'09"W	267.44'	L58	S36°44'33"W	129.75'
L11	S28°38'47"W	15.87'	L59	N62°37'32"W	72.35'
L12	S57°51'18"W	22.00'	L60	S44°23'52"W	134.41'
L13	S57°51'18"W	1.25'	L61	N44°27'43"W	80.20'
L14	SOUTH	298.29'	L62	N43°59'46"E	129.75'
L15	S73°35'31"W	80.89'	L63	S47°46'14"E	81.15'
L16	S05°02'27"E	9.35'	L64	N14°29'16"W	104.04'
L17	S16°24'29"E	75.00'	L65	S81°23'41"W	143.00'
L18	S73°35'31"W	71.68'	L66	N09°56'53"W	83.50'
L19	N16°24'29"W	75.00'	L67	N83°36"E	144.65'
L20	N73°35'31"E	71.68'	L68	S08°54'33"E	77.91'
L21	N60°46'55"E	381.02'	L69	S79°36'17"E	20.00'
L22	N81°59'19"E	55.29'	L70	N10°23'43"E	104.16'
L23	S51°59'45"W	24.28'	L71	S86°08'33"E	213.87'
L24	S33°49'39"W	36.49'	L72	S28°34'23"W	132.57'
L25	S50°27'24"W	78.02'	L73	N80°27'32"W	171.14'
L26	N68°13'39"E	156.07'	L74	S64°20'59"E	19.95'
L27	S34°21'30"E	43.15'	L75	S64°20'04"E	141.42'
L28	S41°20'28"E	47.12'	L76	N25°39'56"E	141.42'
L29	S75°09'33"E	52.18'	L77	N64°20'04"W	141.42'
L30	S21°38'14"W	70.82'	L78	S25°39'56"W	141.42'
L31	S25°32'06"W	121.79'	L79	S65°59'18"E	50.21'
L32	N65°22'52"W	87.41'	L80	N28°21'53"E	141.42'
L33	N25°32'06"E	121.79'	L81	S61°38'07"E	141.42'
L34	S65°22'52"E	87.41'	L82	S28°21'53"W	141.42'
L35	S84°47'24"W	95.03'	L83	N61°38'07"W	141.42'
L36	S50°55'12"W	75.78'	L84	N77°25'53"W	18.37'
L37	N34°38'11"W	73.39'	L85	N68°47'27"W	41.03'
L38	N47°24'45"W	48.04'	L86	S83°04'54"W	32.79'
L39	N32°38'07"E	30.64'	L87	N55°19'55"W	39.54'
L40	N36°47'46"E	42.60'	L88	S86°33'15"W	51.12'
L41	S48°38'21"E	37.62'	L89	N69°52'05"W	23.57'
L42	S39°18'27"E	103.60'	L90	S80°50'30"W	58.08'
L43	S02°48'24"E	159.35'	L91	N72°42'05"W	105.88'
L44	N87°11'36"E	19.79'	L92	S66°28'24"W	28.81'
L45	N25°02'52"E	66.02'	L93	N75°44'41"W	43.17'
L46	S64°51'51"E	76.06'	L94	S51°13'41"W	48.65'
L47	S25°02'52"W	66.02'	L95	N08°24'26"W	104.96'
L48	N64°51'51"W	76.06'	L96	N76°46'03"W	10.76'

BOUNDARY DESCRIPTION

PART OF THE NORTH AND EAST HALF OF SECTION 18, TOWNSHIP 7 NORTH, RANGE 1 EAST, SALT LAKE BASE AND MERIDIAN, U.S. SURVEY. MORE PARTICULARLY DESCRIBED AS FOLLOWS:

BEGINNING AT A POINT AT THE CENTER OF SAID SECTION 18 (SAID CENTER BEING SOUTH 88°01'57" WEST 2659.58 FEET FROM THE EAST QUARTER CORNER OF SAID SECTION 18); THENCE SOUTH 82°09'13" WEST 1175.70 FEET; THENCE NORTH 00°21'59" EAST 502.70 FEET; THENCE NORTH 84°57'33" EAST 883.90 FEET; THENCE NORTH 00°20'46" EAST 506.53 FEET; THENCE NORTH 83°12'04" EAST 282.87 FEET; THENCE NORTH 00°10'35" EAST 319.97 FEET; THENCE NORTH 86°57'23" EAST 1331.42 FEET; THENCE SOUTH 00°12'34" WEST 1280.84 FEET; THENCE SOUTH 88°30'02" EAST 116.43 FEET; THENCE SOUTH 14°58'48" WEST 106.65 FEET; THENCE NORTH 89°46'36" WEST 264.32 FEET; THENCE SOUTH 00°00'58" WEST 113.10 FEET; THENCE NORTH 89°48'51" WEST 1153.75 FEET; THENCE NORTH 00°11'16" EAST 144.72 FEET TO THE POINT OF BEGINNING.

CONTAINING 2628646 SQUARE FEET OR 60.345 ACRES.

BASIS OF BEARINGS

THE BASIS OF BEARINGS FOR THIS PLAT IS BETWEEN THE CENTER AND THE EAST QUARTER CORNER OF SECTION 18, TOWNSHIP 7 NORTH, RANGE 1 EAST, SALT LAKE BASE AND MERIDIAN, U.S. SURVEY, SHOWN HEREON AS: S88°01'57"E

NARRATIVE

THE PURPOSE OF THIS PLAT IS TO DIVIDE THE BELOW DESCRIBED PROPERTY INTO LOTS AND STREETS AS SHOWN. ALL BOUNDARY CORNERS AND REAR LOT CORNERS WERE SET WITH A 5/8" X 24" REBAR AND PLASTIC CAP STAMPED "REEVE & ASSOCIATES". THE BOUNDARY WAS DETERMINED FROM FOUND SECTION CORNER MONUMENTS AS SHOWN.

NOTES

DUE TO THE TOPOGRAPHY AND THE LOCATION OF THIS SUBDIVISION ALL OWNERS WILL ACCEPT RESPONSIBILITY FOR ANY STORM WATER RUNOFF FROM THE ROAD ADJACENT TO THIS PROPERTY UNTIL CURB AND GUTTER IS INSTALLED.

WELL LOCATIONS Delineated ON PLAT AND PER WELL APPROVAL DOCUMENTS WITH WEBER COUNTY.

A GEO HAZARDOUS STUDY MAY BE REQUIRED AT THE TIME OF A BUILDING PERMIT OF EACH LOT.

STRUCTURES ARE REQUIRED TO BE BUILT WITHIN THE BUILDABLE AREAS SHOWN ON EACH LOT

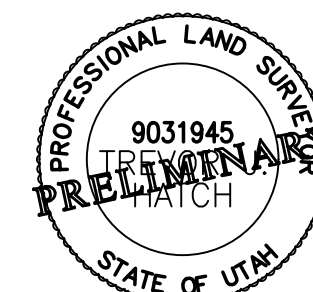

SIGNED THIS _____ DAY OF _____, 20____.

9031945
UTAH LICENSE NUMBER

OWNERS DEDICATION AND CERTIFICATION

WE THE UNDERSIGNED OWNERS OF THE HEREIN DESCRIBED TRACT OF LAND, DO HEREBY SET APART AND SUBDIVIDE THE SAME INTO LOTS AND STREETS AS SHOWN ON THE PLAT AND NAME SAID TRACT **ARROWLEAF**. I HEREBY DEDICATE TO THE OWNERS OF ARROWLEAF ALL THOSE PARTS OR PORTIONS OF SAID TRACT OF LAND DESIGNATED AS PRIVATE STREETS, THE SAME TO BE USED AS PRIVATE ACCESS FOR THE INDIVIDUAL LOT OWNERS; AND DO HEREBY GRANT AND DEDICATE TO THE OWNERS OF ARROWLEAF, PARCEL 'A', PARCEL 'B', AND PARCEL 'C' TO BE OPERATED AND MAINTAINED BY THE HOMEOWNERS ASSOCIATION OF ARROWLEAF; AND TO HEREBY GRANT AND DEDICATE A 20-FOOT W

