

Date:

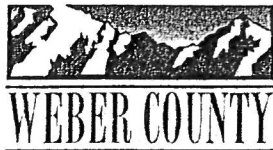

# Planning Commission Land Use Permit

Page 1 of 2

Printed: 3/12/2012

Permit Number: LUP5-2012

### Applicant

Name: Wayne Isaacs  
Address: 2021 N 1225 W  
CLINTON, UTAH  
Phone: 84015

### Owner

Name: Mr. Wayne Isaacs  
Address: 2021 N 1225 W  
Phone:

### Parcel

Parcel Number: 230690008

Zoning:

Total Parcel Area:

(\*If Zoned S-1, See Specific Height Requirements)

Address: 11620 JIM BRIDGER DR E

\*\*See Diagram on Back Side for Setbacks

Section:

Township:

Range:

Subdivision:

Lot(s):

Proposed Structure: RV Pad

Structure Area Used:

Is Structure > 1,000 Sq. Ft.?

\*If True, Need Certif. Statement

# of Dwelling Units: 0

# of Accessory Bldgs: 0

# Off-Street Parking Req'd:



### Permit Checklist:

Public by/Right of Use Road?

> 200 ft. from Paved Road?

No

< 4218 ft. above Sea Level?

No

Wetlands/Flood Zone?

No

Culvert Required?

No

If Yes, Culvert Size:

**\*Any Work in the Right of Way requires an Excavation Permit**

Additional Frontage Req'd.?

no

OR Special Exception?

Case #

Meet Zone Area & Frontage?

True

Hillside Review Req'd.?

Case #

Culinary Water District:

Sunridge

Waste Water System:

Individual

Comments: Approved for the Sunridge Subdivision

5/28/2014 4/22/13  
RE-NEWED  
  
AM  
Renewed

← JIM BRISGER →  
DRIVE

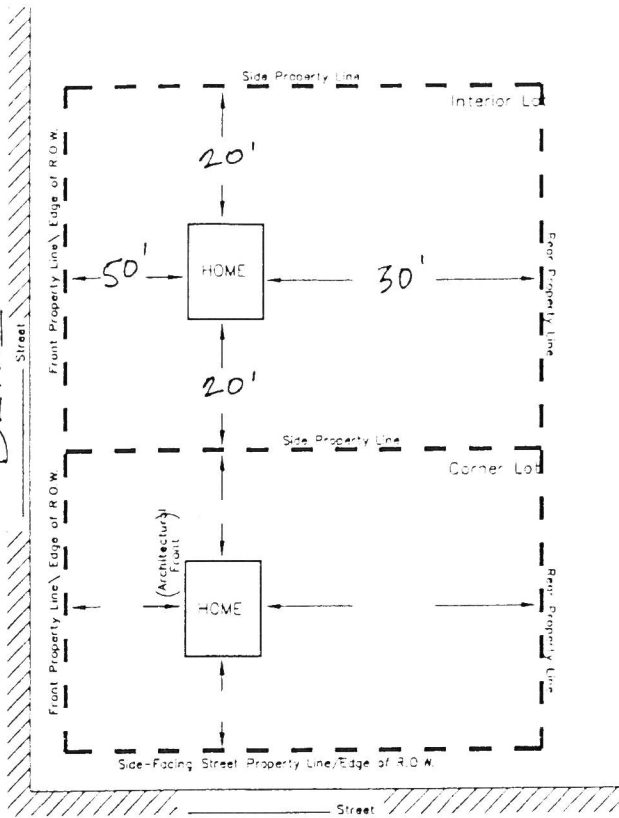

MINIMUM YARD SETBACKS  
New Dwelling, Addition, Etc.

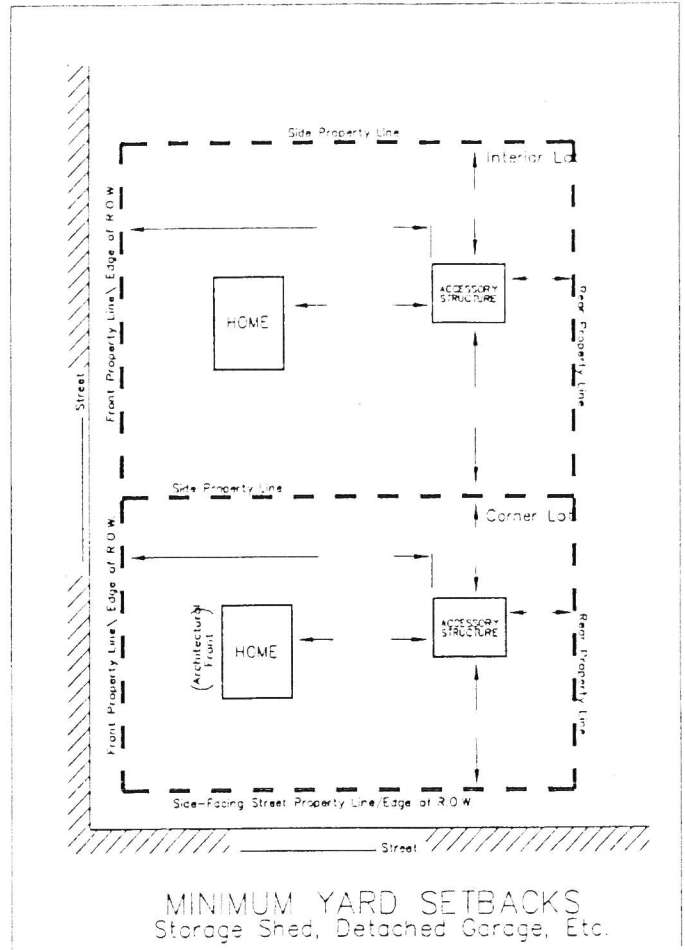

MINIMUM YARD SETBACKS  
Storage Shed, Detached Garage, Etc.

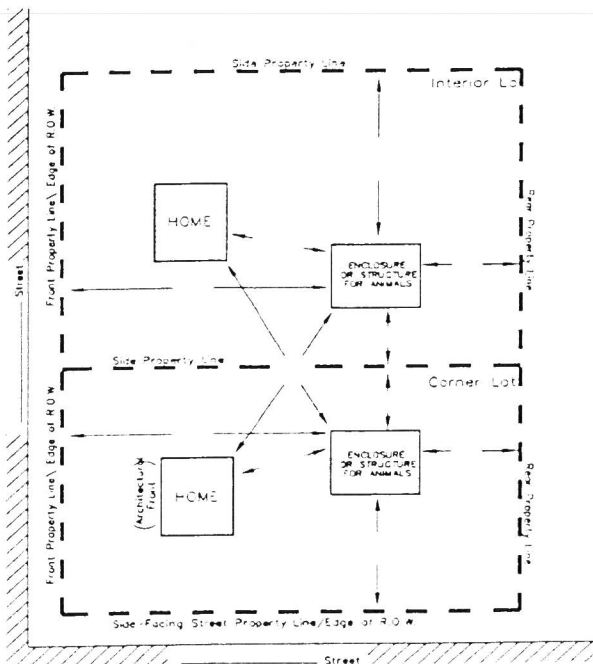

MINIMUM YARD SETBACKS  
Barn, Corral, or Stable

NOTICE FOR APPLICANT (Please Read Before Signing)

Proposals for the installation of an individual water supply and for a sanitary waste disposal system (septic tank) for any structure designed for human occupation must be approved by the Weber County Health Department prior to installation.

*[Signature]* 3/12/2012  
Planning Dept. Signature of Approval Date

This permit becomes null and void if use or construction authorized has not commenced within 180 days or if there is a zone change affecting this property. I hereby certify that I have read and examined this application and know the same to be true and correct. All provisions of laws and ordinances governing this land use will be complied with whether specified herein or not. I make this statement under penalty of perjury. I hereby agree to make the requirements as specified on this permit issued to the owner of land as signed below.

*[Signature]*  
Contractor/Owner Signature of Approval Date

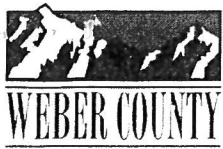

**WEBER COUNTY CMS RECEIPTING SYSTEM  
OFFICIAL RECEIPT**

\*\*\* Save this receipt for your records \*\*\*

Date: 12-MAR-2012

Receipt Nbr: 649

ID# 2489

Employee / Department: CRAIG BROWNE - 4181 - PLANNING  
 Monies Received From: WAYNE ISAACS  
 Template: PUBLIC WORKS  
 Description: LAND USE PERMIT

*The following amount of money has been received and allocated to the various accounts listed below:*

Total Currency	\$	_____	.00
Total Coin	\$	_____	.00
Total Debit/Credit Card	\$	_____	.00
Pre-deposit	\$	_____	.00
Total Checks	\$	_____	50.00
Grand Total	\$	=====	50.00

Account Number	Account Name	Comments	Total
2012-01-4181-3419-0550-000	ZONING FEES		50.00
TOTAL \$			50.00

Check Amounts

50.00

Total Checks: 1

Total Check Amounts: \$ 50.00

\*\*\* SAVE THIS RECEIPT FOR YOUR RECORDS \*\*\*