

UTAH

Received A.G. letter Oct 15-71

Plat per Report of 21/74

TOWNSHIP N° 6 North RANGE N° 1 East Salt Lake MERIDIAN

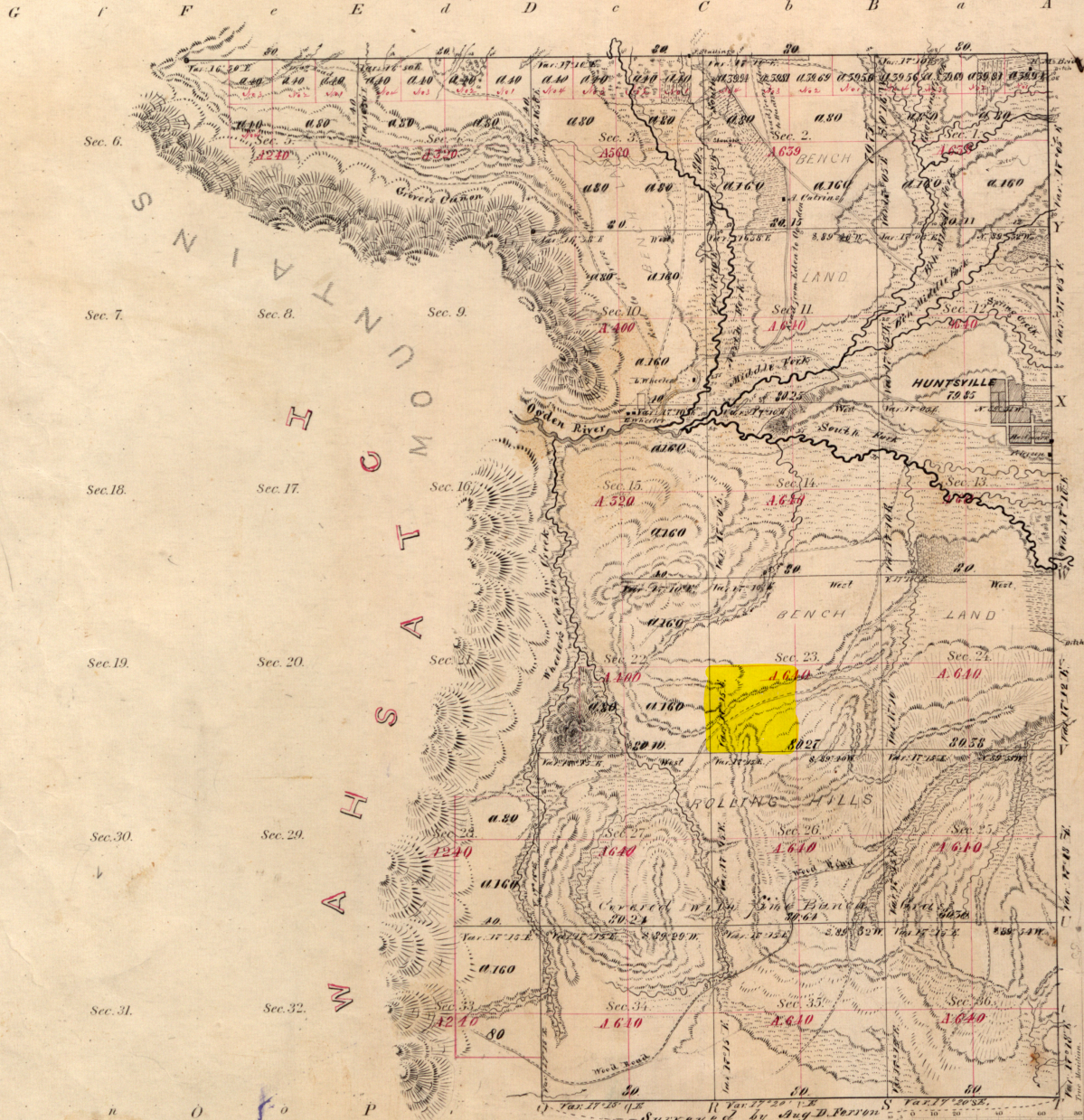

Total number of Acres 11673.

Surveys Designated	By Whom Surveyed	Date of Contract	Amount of Surveys in A.C.	When Surveyed
Township lines	J. Korten Smith	June 5th 1871	11 - 00 - 00	June 22 <sup>nd</sup> 1871
Subdivisions	d.o.	do.	29 - 42 - 04	Sept 26 <sup>th</sup> 1871
South Boundary	A. D. Ferron		3 - 00 - 00	

Plat filed with Register Index 1873  
asper Record in Surveying Division

Meanders of

Posts	Courses	Ch. Lk.	Posts	Courses	Ch. Lk.	Posts	Courses	Ch. Lk.

Vol. 7.  
Entered in Plat Book July 13 1871  
Wm. Drummond Jr.

The above Map of Township N° 6 North of Range N° 1 East Salt Lake, Newban Utah Territory is strictly conformable to the field notes of the survey thereof on file in this Office, which have been examined and approved.

Surveyor General's Office Salt Lake City, Utah.  
November 14<sup>th</sup> 1871.  
C. C. Clements, Jr. Sur. Gen.