

EXISTING WOLF CREEK PARCEL

L1.6

L1.1a

L1.2

L1.4a

L1.1b

EXISTING OPEN SPACE PARCEL

L1.4b

L1.3

L1.5b

L1.5a

**THE RIDGE TOWNHOMES**

WEBER COUNTY, UT

P.R.U.D APPROVAL  
WEBER COUNTY, UT



DATE:	NOVEMBER 2013
PROJECT:	.028
DRAWN BY:	MP
REVIEW BY:	EL
VERSION:	P.R.U.D
REVISIONS:	

SHEET TITLE:  
**OVERALL LANDSCAPE PLAN**

SHEET NUMBER:

**L1.0**

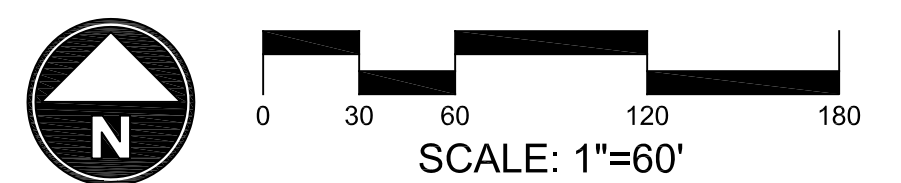

MATCHLINE SEE L1.1b

MATCHLINE SEE L1.2b

### Plant Schedule

SYMBOL BOTANICAL/COMMON NAME

#### EVERGREEN TREES

- Abies lasiocarpa  
Sub-Alpine Fir
- Picea abies 'Cupressina' Columnar  
Columnar Norway Spruce

- Picea pungens  
Colorado Spruce

- Pinus flexilis glauca 'Vanderwolf's Pyramid'  
Vanderwolf Limber Pine

- Pinus ponderosa  
Ponderosa Pine

#### DECIDUOUS TREES

- Acer tartarian 'GarAnn'  
Hot Wings Tartarian

- Crataegus lavallei 'Carriere'  
Carriere Hawthorn

- Malus x 'Perfect Purple'  
Perfect Purple Crabapple

- Populus deltoides 'Siouxland'  
Siouxland Plains Cottonwood

- Populus tremuloides  
Quaking Aspen

- Populus tremula 'erecta' Swedish Columnar  
Swedish Columnar Aspen

- Sorbus aucuparia 'Cardinal Royal'  
Cardinal Royal Mtn. Ash

- Tilia mongolica 'Harvest Gold'  
Harvest Gold Mongolian Linden

#### EVERGREEN SHRUBS

- Buxus x 'Green Velvet'  
Green Velvet Boxwood

- Juniperus horizontalis 'Bar Harbor'  
Bar Harbor Juniper

- Mahonia aquifolium  
Oregon Grape

- Mahonia aquifolium 'compacta'  
Compact Oregon Grape

- Pinus sylvestris 'Hillside Creeper'  
Hillside Creeper Scotch Pine

- Yucca filamentosa  
Yucca

#### LARGE SHRUBS 7-9' SPREAD

- Cornus alba 'Argenteo marginata'  
Variegated Dogwood

- Rhus aromatica 'Grow Low'  
Grow Low Sumac

#### MEDIUM SHRUBS 5-7' SPREAD

- Cornus sericea 'Alleman's Compact'  
Alleman's Red Osier Dogwood

- Physocarpus opulifolius 'Dart's Gold'  
Ninebark

- Physocarpus opulifolius nanus dwarf  
Dwarf Ninebark

- Ribes alpinum  
Alpine Currant

- Salix purpurea nana  
Blue Arctic Willow

a L1.1a

b L1.1b

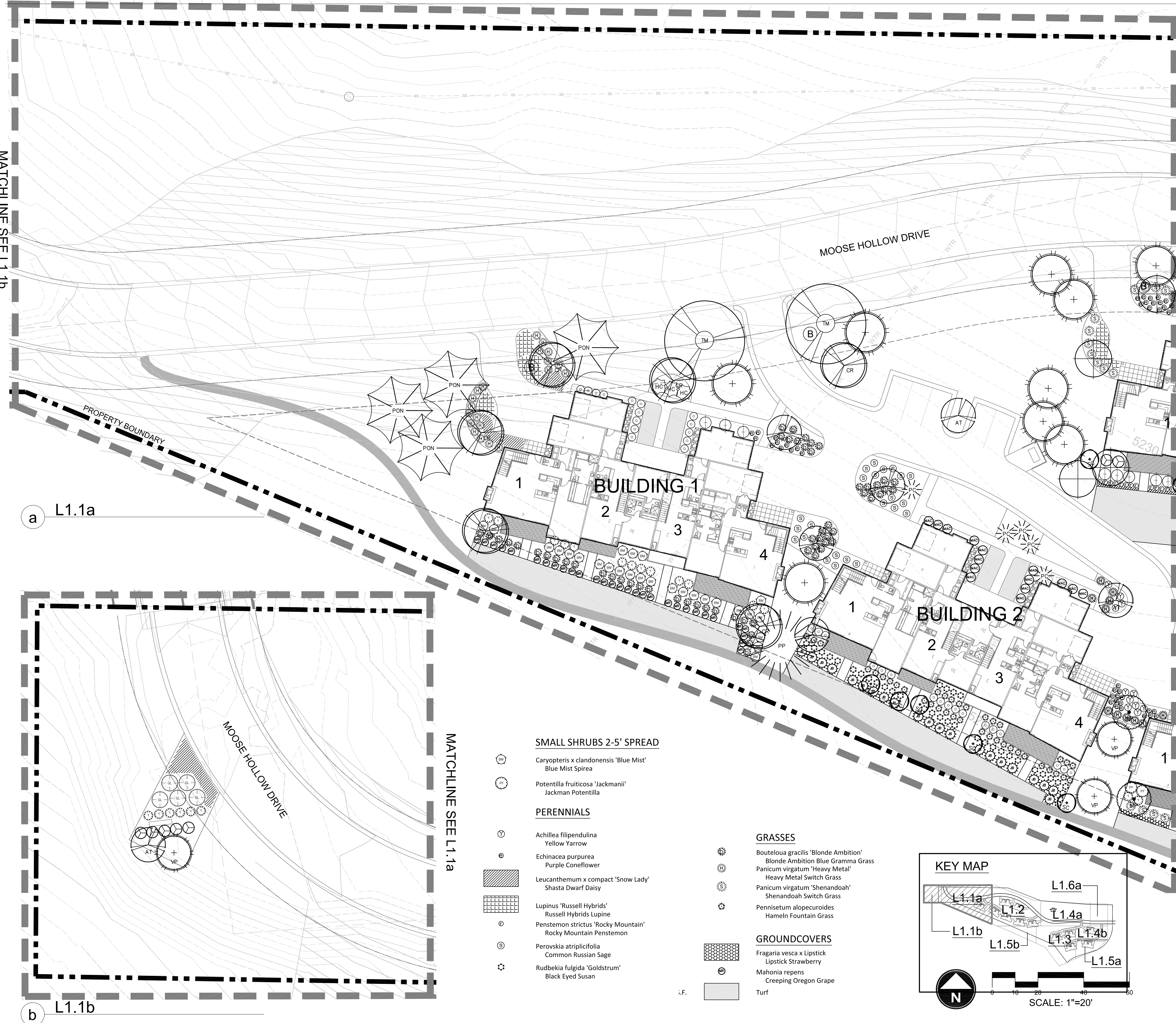

#### SMALL SHRUBS 2-5' SPREAD

- Caryopteris x clandonensis 'Blue Mist'  
Blue Mist Spirea
- Potentilla fruticosa 'Jackmanii'  
Jackman Potentilla

#### PERENNIALS

- Achillea filipendulina  
Yellow Yarrow
- Echinacea purpurea  
Purple Coneflower
- Leucanthemum x compact 'Snow Lady'  
Shasta Dwarf Daisy
- Lupinus 'Russell Hybrids'  
Russell Hybrids Lupine
- Penstemon strictus 'Rocky Mountain'  
Rocky Mountain Penstemon
- Perovskia atriplicifolia  
Common Russian Sage
- Rudbeckia fulgida 'Goldstrum'  
Black Eyed Susan

#### GRASSES

- Bouteloua gracilis 'Blonde Ambition'  
Blonde Ambition Blue Gramma Grass
- Panicum virgatum 'Heavy Metal'  
Heavy Metal Switch Grass
- Panicum virgatum 'Shenandoah'  
Shenandoah Switch Grass
- Pennisetum alopecuroides  
Hamel Fountain Grass

#### GROUNDCOVERS

- Fragaria vesca x Lipstick  
Lipstick Strawberry
- Mahonia repens  
Creeping Oregon Grape
- Turf

i.f.

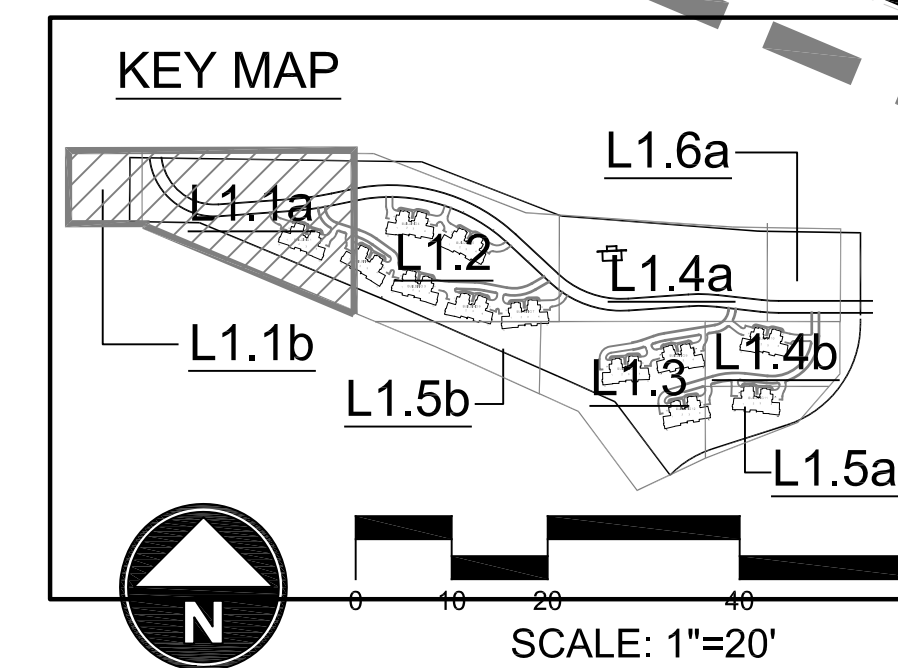

# THE RIDGE TOWNHOMES

WEBER COUNTY, UT

P.R.U.D APPROVAL  
WEBER COUNTY, UT



DATE:	NOVEMBER 2013
PROJECT:	.028
DRAWN BY:	MP
REVIEW BY:	EL
VERSION:	P.R.U.D
REVISIONS:	

SHEET TITLE:  
LANDSCAPE PLAN

SHEET NUMBER:

# L1.1

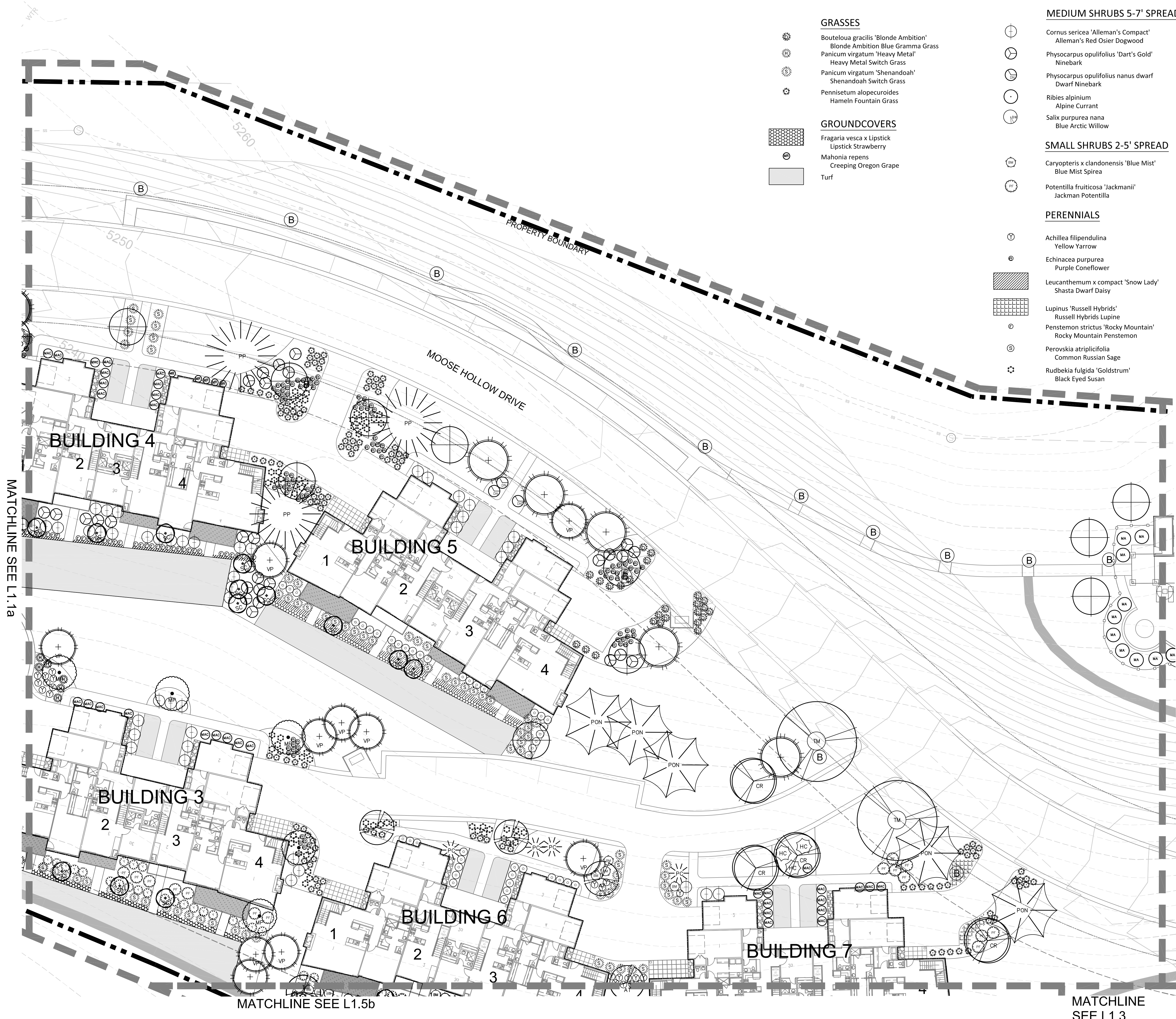

**GRASSES**

- Bouteloua gracilis 'Blonde Ambition'
- Blonde Ambition Blue Gramma Grass
- Panicum virgatum 'Heavy Metal'
- Heavy Metal Switch Grass
- Panicum virgatum 'Shenandoah'
- Shenandoah Switch Grass
- Pennisetum alopecuroides
- Hameln Fountain Grass

**GROUNDCOVERS**

- Fragaria vesca x Lipstick
- Lipstick Strawberry
- Mahonia repens
- Creeping Oregon Grape
- Turf

**MEDIUM SHRUBS 5-7' SPREAD**

- Cornus sericea 'Alleman's Compact'
- Alleman's Red Osier Dogwood
- Physocarpus opulifolius 'Dart's Gold'
- Ninebark
- Physocarpus opulifolius nanus dwarf
- Dwarf Ninebark
- Ribes alpinum
- Alpine Currant
- Salix purpurea nana
- Blue Arctic Willow

**SMALL SHRUBS 2-5' SPREAD**

- Caryopteris x clandonensis 'Blue Mist'
- Blue Mist Spirea
- Potentilla fruticosa 'Jackmanii'
- Jackman Potentilla

**PERENNIALS**

- Achillea filipendulina
- Yellow Yarrow
- Echinacea purpurea
- Purple Coneflower
- Leucanthemum x compact 'Snow Lady'
- Shasta Dwarf Daisy
- Lupinus 'Russell Hybrids'
- Russell Hybrids Lupine
- Penstemon strictus 'Rocky Mountain'
- Rocky Mountain Penstemon
- Perovskia atriplicifolia
- Common Russian Sage
- Rudbeckia fulgida 'Goldstrum'
- Black Eyed Susan

**Plant Schedule**

SYMBOL	BOTANICAL/COMMON NAME
<b>EVERGREEN TREES</b>	
	Abies lasiocarpa Sub-Alpine Fir
	Picea abies 'Cupressina' Columnar Columnar Norway Spruce
	Picea pungens Colorado Spruce
	Pinus flexilis glauca 'Vanderwolf's Pyramid' Vanderwolf Limber Pine
	Pinus ponderosa Ponderosa Pine
<b>DECIDUOUS TREES</b>	
	Acer tartarian 'GarAnn' Hot Wings Tartarian
	Crataegus lavalleyi 'Carriere' Carriere Hawthorn
	Malus x 'Perfect Purple' Perfect Purple Crabapple
	Populus deltoides 'Siouxland' Siouxland Plains Cottonwood
	Populus tremuloides Quaking Aspen
	Populus tremula 'erecta' Swedish Columnar Swedish Columnar Aspen
	Sorbus aucuparia 'Cardinal Royal' Cardinal Royal Mtn. Ash
	Tilia mongolica 'Harvest Gold' Harvest Gold Mongolian Linden
<b>EVERGREEN SHRUBS</b>	
	Buxus x 'Green Velvet' Green Velvet Boxwood
	Juniperus horizontalis 'Bar Harbor' Bar Harbor Juniper
	Mahonia aquifolium Oregon Grape
	Mahonia aquifolium 'compacta' Compact Oregon Grape
	Pinus sylvestris 'Hillside Creeper' Hillside Creeper Scotch Pine
	Yucca filamentosa Yucca
<b>LARGE SHRUBS 7-9' SPREAD</b>	
	Cornus alba 'Argenteo marginata' Variegated Dogwood
	Rhus aromatica 'Grow Low' Grow Low Sumac

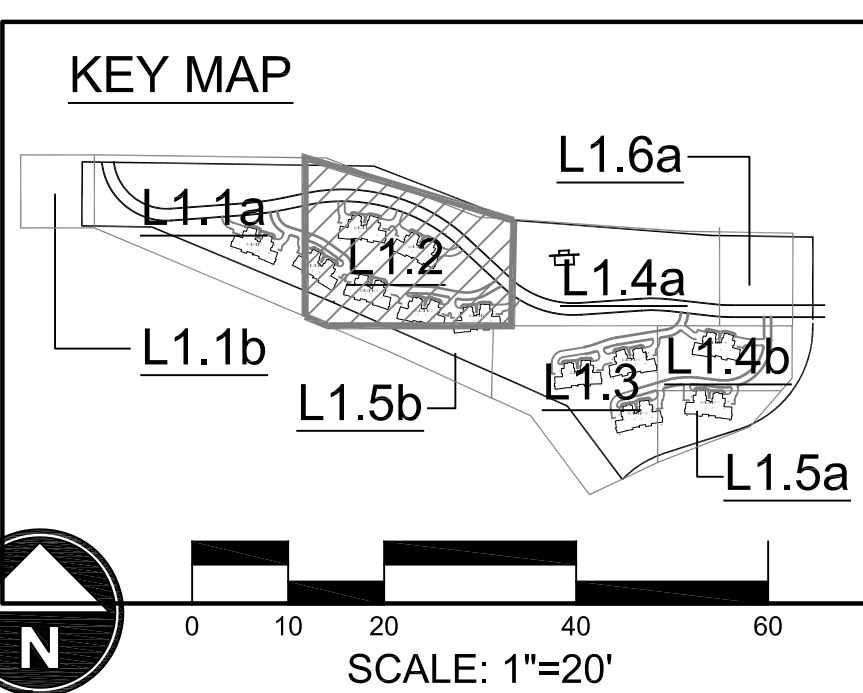

**THE RIDGE TOWNHOMES**  
WEBER COUNTY, UT

P.R.U.D APPROVAL  
WEBER COUNTY, UT



DATE:	NOVEMBER 2013
PROJECT:	.028
DRAWN BY:	MP
REVIEW BY:	EL
VERSION:	P.R.U.D
REVISIONS:	

SHEET TITLE:  
**LANDSCAPE PLAN**

SHEET NUMBER:  
**L1.2**

MATCHLINE  
SEE L1.2

MATCHLINE SEE L1.4a

MATCHLINE SEE L1.5b

MATCHLINE SEE L1.4b

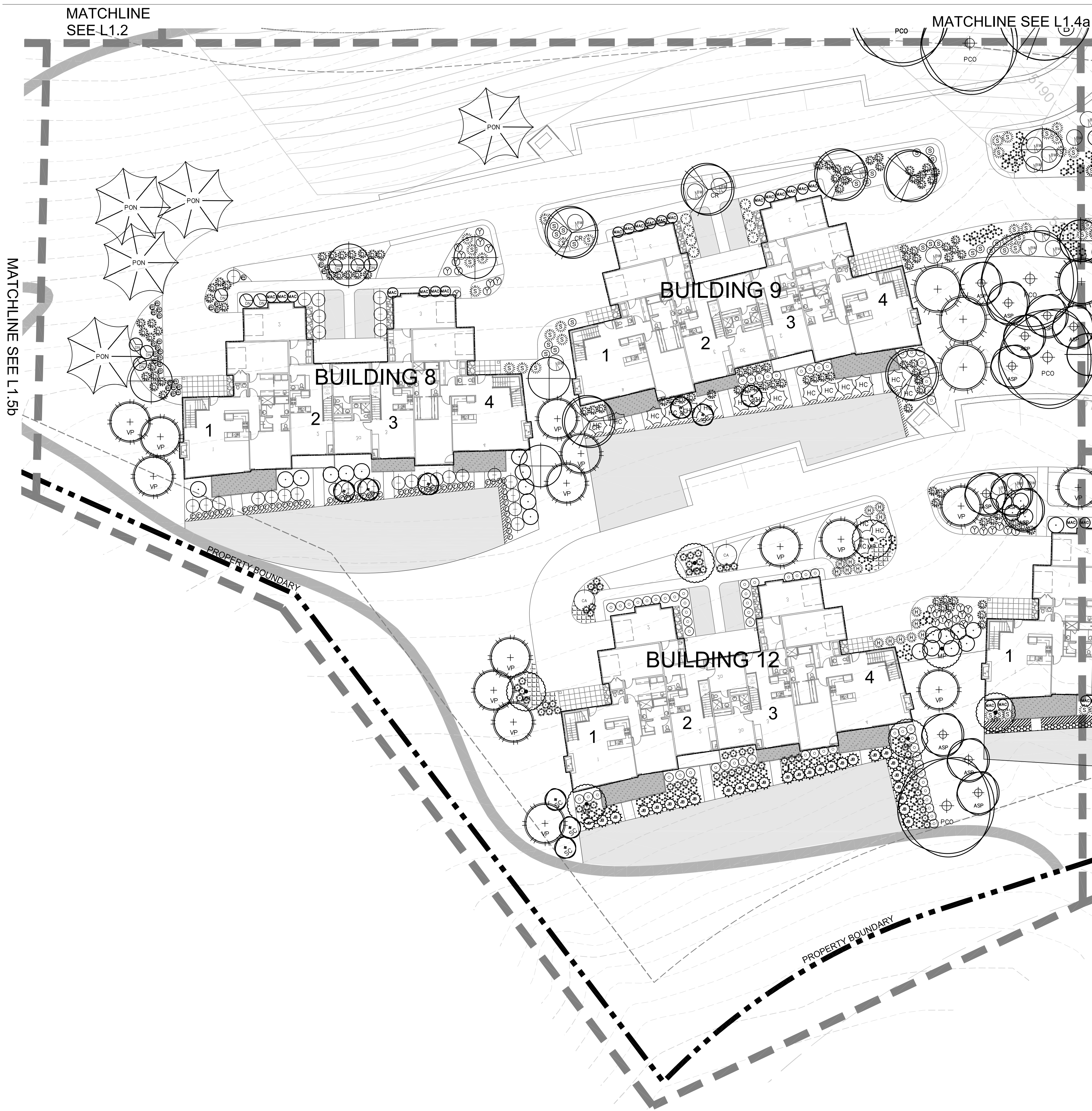

**Plant Schedule**

SYMBOL BOTANICAL/Common Name

**LARGE SHRUBS 7-9' SPREAD**

- CA Cornus alba 'Argenteo marginata' Variegated Dogwood
- DL Rhus aromatica 'Grow Low' Grow Low Sumac

**MEDIUM SHRUBS 5-7' SPREAD**

- CS Cornus sericea 'Alleman's Compact' Alleman's Red Osier Dogwood
- DL Physocarpus opulifolius 'Dart's Gold' Ninebark
- DL Physocarpus opulifolius nanus dwarf Dwarf Ninebark
- AL Ribies alpinium Alpine Currant
- VP Salix purpurea nana Blue Arctic Willow

**SMALL SHRUBS 2-5' SPREAD**

- BM Caryopteris x clandonensis 'Blue Mist' Blue Mist Spirea
- JP Potentilla fruticosa 'Jackmanii' Jackman Potentilla

**PERENNIALS**

- Y Achillea filipendulina Yellow Yarrow
- E Echinacea purpurea Purple Coneflower
- SL Leucanthemum x compact 'Snow Lady' Shasta Dwarf Daisy
- LP Lupinus 'Russell Hybrids' Russell Hybrids Lupine
- PM Penstemon strictus 'Rocky Mountain' Rocky Mountain Penstemon
- RS Perovskia atriplicifolia Common Russian Sage
- SS Rudbeckia fulgida 'Goldstrum' Black Eyed Susan

**GRASSES**

- BA Bouteloua gracilis 'Blonde Ambition' Blonde Ambition Blue Gramma Grass
- PM Panicum virgatum 'Heavy Metal' Heavy Metal Switch Grass
- PM Panicum virgatum 'Shenandoah' Shenandoah Switch Grass
- PM Pennisetum alopecuroides Hameln Fountain Grass

**GROUNDCOVERS**

- FR Fragaria vesca x Lipstick Lipstick Strawberry
- MG Mahonia repens Creeping Oregon Grape
- T Turf

**EVERGREEN TREES**

- AB Abies lasiocarpa Sub-Alpine Fir
- CA Picea abies 'Cupressina' Columnar Columnar Norway Spruce
- PP Picea pungens Colorado Spruce
- VP Pinus flexilis glauca 'Vanderwolf's Pyramid' Vanderwolf Limber Pine
- VP Pinus ponderosa Ponderosa Pine

**DECIDUOUS TREES**

- AT Acer tartarian 'GarAnn' Hot Wings Tartarian
- CR Crataegus lavalley 'Carriere' Carriere Hawthorn
- MP Malus x 'Perfect Purple' Perfect Purple Crabapple
- PCO Populus deltoides 'Siouxland' Siouxland Plains Cottonwood
- ASP Populus tremuloides Quaking Aspen
- SC Populus tremula 'erecta' Swedish Columnar Swedish Columnar Aspen
- CR Sorbus aucuparia 'Cardinal Royal' Cardinal Royal Mtn. Ash
- TM Tilia mongolica 'Harvest Gold' Harvest Gold Mongolian Linden

**EVERGREEN SHRUBS**

- GV Buxus x 'Green Velvet' Green Velvet Boxwood
- JB Juniperus horizontalis 'Bar Harbor' Bar Harbor Juniper
- MA Mahonia aquifolium Oregon Grape
- MA Mahonia aquifolium 'compacta' Compact Oregon Grape
- HC Pinus sylvestris 'Hillside Creeper' Hillside Creeper Scotch Pine
- YU Yucca filamentosa Yucca

**KEY MAP**

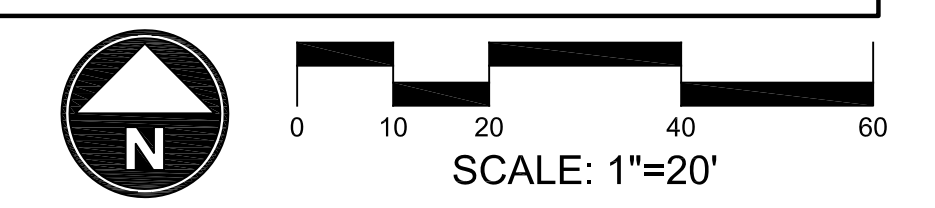
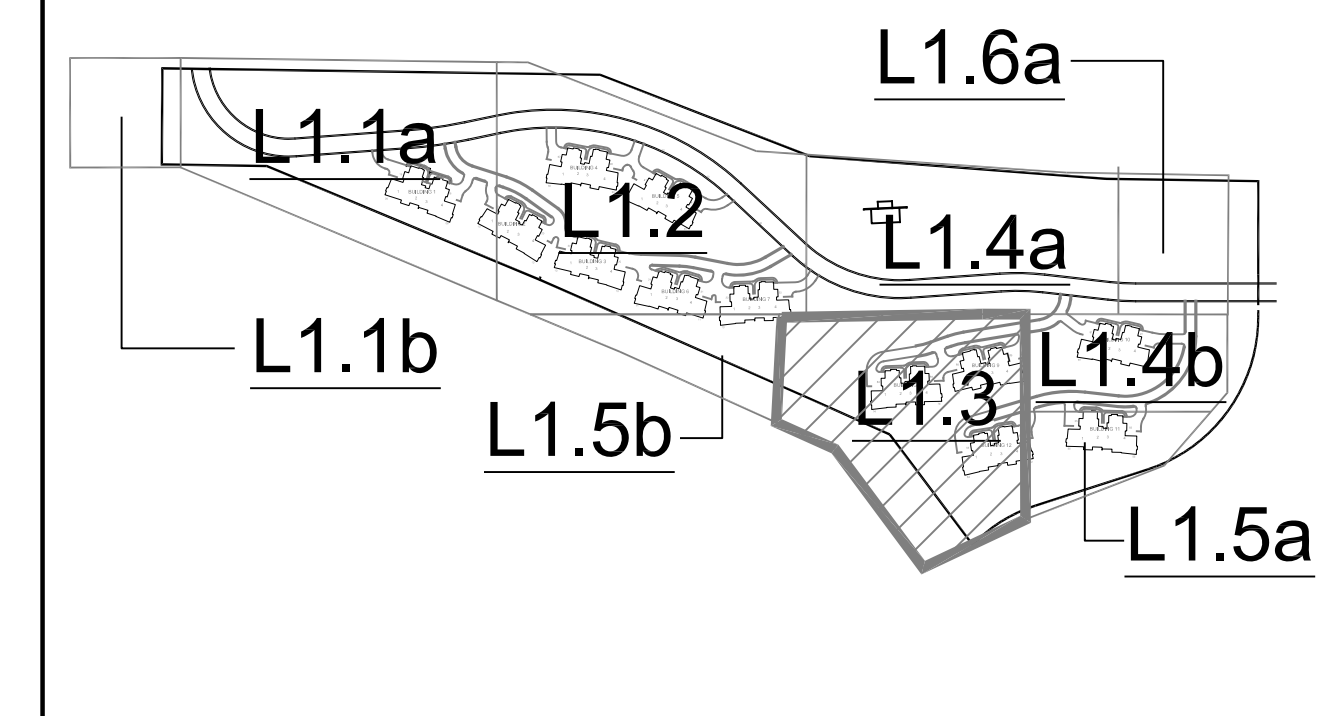

**THE RIDGE TOWNHOMES**  
WEBER COUNTY, UT

P.R.U.D APPROVAL  
WEBER COUNTY, UT



DATE:	NOVEMBER 2013
PROJECT:	.028
DRAWN BY:	MP
REVIEW BY:	EL
VERSION:	P.R.U.D
REVISIONS:	

SHEET TITLE:  
**LANDSCAPE PLAN**

SHEET NUMBER:  
**L1.3**

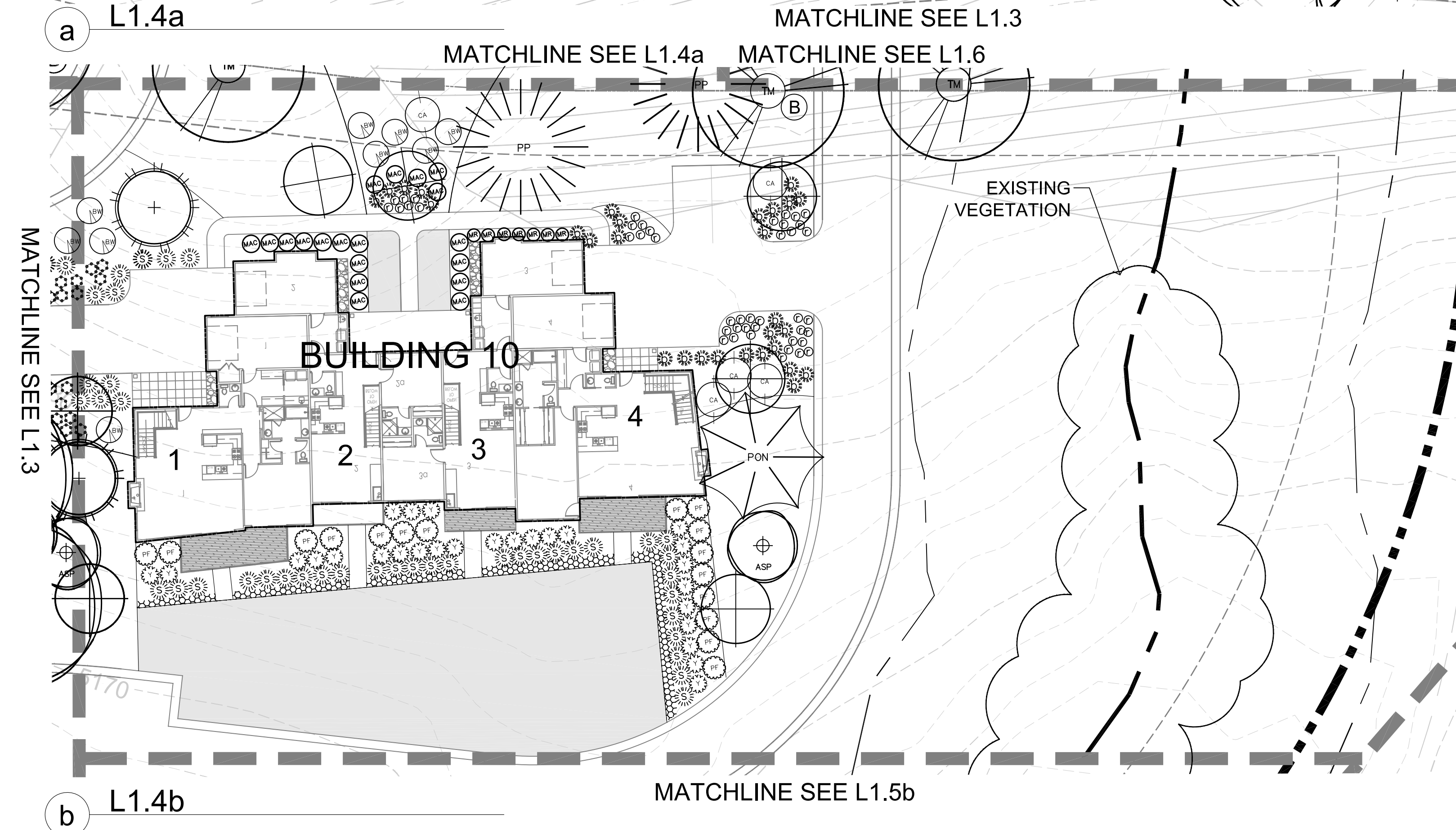
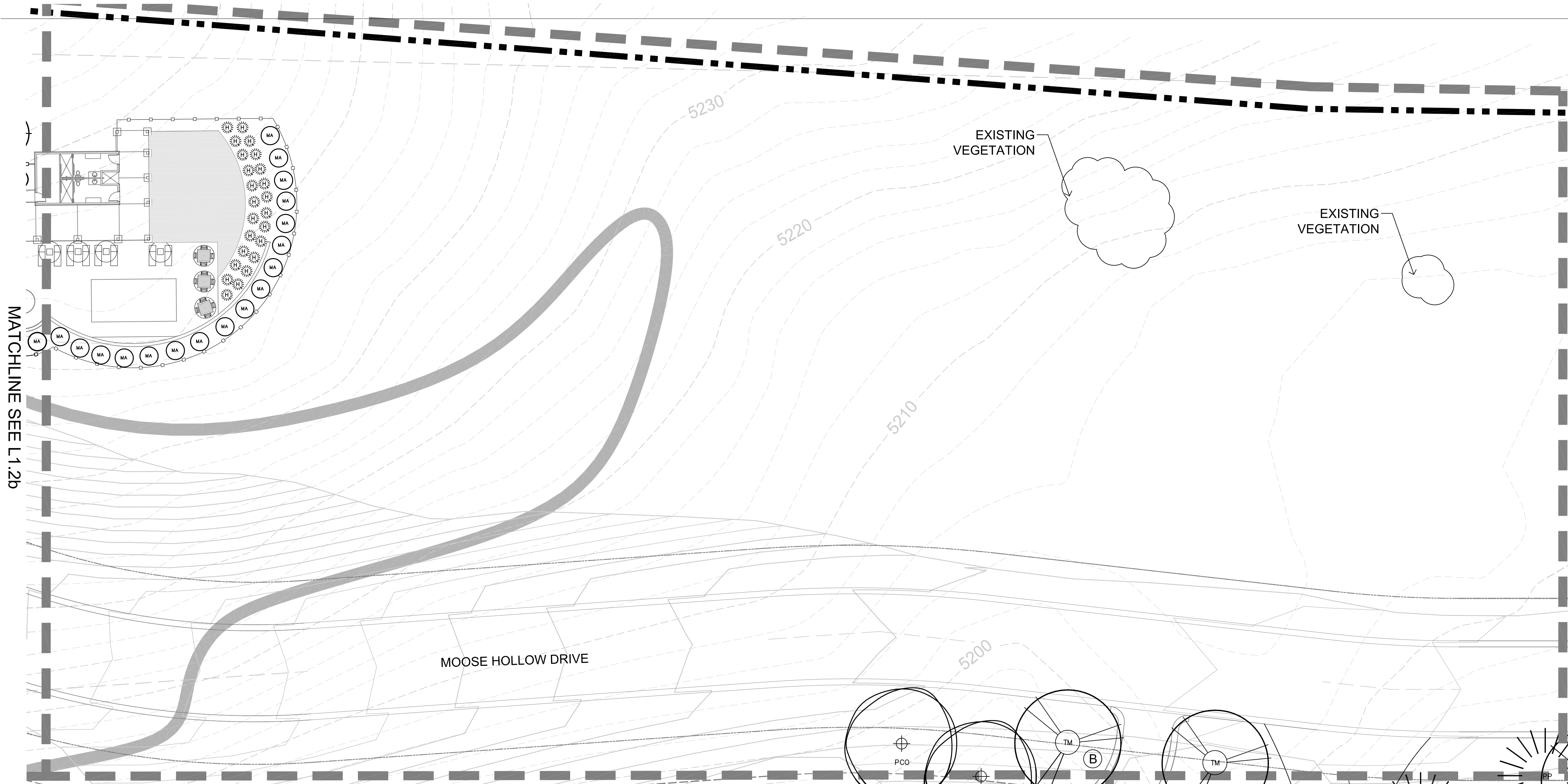

Plant Schedule	
SYMBOL	BOTANICAL/COMMON NAME
<b>EVERGREEN TREES</b>	
	<i>Abies lasiocarpa</i> Sub-Alpine Fir
	<i>Picea abies</i> 'Cupressina' Columnar Norway Spruce
	<i>Picea pungens</i> Colorado Spruce
	<i>Pinus flexilis glauca</i> 'Vanderwolf's Pyramid' Vanderwolf Limber Pine
	<i>Pinus ponderosa</i> Ponderosa Pine
<b>DECIDUOUS TREES</b>	
	<i>Acer tartarian</i> 'GarAnn' Hot Wings Tartarian
	<i>Crataegus lavalley</i> 'Carriere' Carriere Hawthorn
	<i>Malus</i> 'Perfect Purple' Perfect Purple Crabapple
	<i>Populus deltoides</i> 'Siouxland' Siouxland Plains Cottonwood
	<i>Populus tremuloides</i> Quaking Aspen
	<i>Populus tremula</i> 'erecta' Swedish Columnar Swedish Columnar Aspen
	<i>Sorbus aucuparia</i> 'Cardinal Royal' Cardinal Royal Mtn. Ash
	<i>Tilia mongolica</i> 'Harvest Gold' Harvest Gold Mongolian Linden
<b>EVERGREEN SHRUBS</b>	
	<i>Buxus</i> 'Green Velvet' Green Velvet Boxwood
	<i>Juniperus horizontalis</i> 'Bar Harbor' Bar Harbor Juniper
	<i>Mahonia aquifolium</i> Oregon Grape
	<i>Mahonia aquifolium</i> 'compacta' Compact Oregon Grape
	<i>Pinus sylvestris</i> 'Hillside Creeper' Hillside Creeper Scotch Pine
	<i>Yucca filamentosa</i> Yucca
<b>LARGE SHRUBS 7-9' SPREAD</b>	
	<i>Cornus alba</i> 'Argenteo marginata' Variegated Dogwood
	<i>Rhus aromatica</i> 'Grow Low' Grow Low Sumac
<b>MEDIUM SHRUBS 5-7' SPREAD</b>	
	<i>Cornus sericea</i> 'Alleman's Compact' Alleman's Red Osier Dogwood
	<i>Physocarpus opulifolius</i> 'Dart's Gold' Ninebark
	<i>Physocarpus opulifolius nanus</i> dwarf Dwarf Ninebark
	<i>Ribes alpinum</i> Alpine Currant
	<i>Salix purpurea nana</i> Blue Arctic Willow
<b>SMALL SHRUBS 2-5' SPREAD</b>	
	<i>Caryopteris x clandonensis</i> 'Blue Mist' Blue Mist Spirea
	<i>Potentilla fruticosa</i> 'Jackmanii' Jackman Potentilla
<b>PERENNIALS</b>	
	<i>Achillea filipendulina</i> Yellow Yarrow
	<i>Echinacea purpurea</i> Purple Coneflower
	<i>Leucanthemum x compact</i> 'Snow Lady' Shasta Dwarf Daisy
	<i>Lupinus</i> 'Russell Hybrids' Russell Hybrids Lupine
	<i>Penstemon strictus</i> 'Rocky Mountain' Rocky Mountain Penstemon
	<i>Perovskia atriplicifolia</i> Common Russian Sage
	<i>Rudbeckia fulgida</i> 'Goldstrum' Black Eyed Susan
<b>GRASSES</b>	
	<i>Bouteloua gracilis</i> 'Blonde Ambition' Blonde Ambition Blue Gramma Grass
	<i>Panicum virgatum</i> 'Heavy Metal' Heavy Metal Switch Grass
	<i>Panicum virgatum</i> 'Shenandoah' Shenandoah Switch Grass
	<i>Pennisetum alopecuroides</i> Hameln Fountain Grass
<b>GROUNDCOVERS</b>	
	<i>Fragaria vesca</i> x Lipstick Lipstick Strawberry
	<i>Mahonia repens</i> Creeping Oregon Grape
	Turf

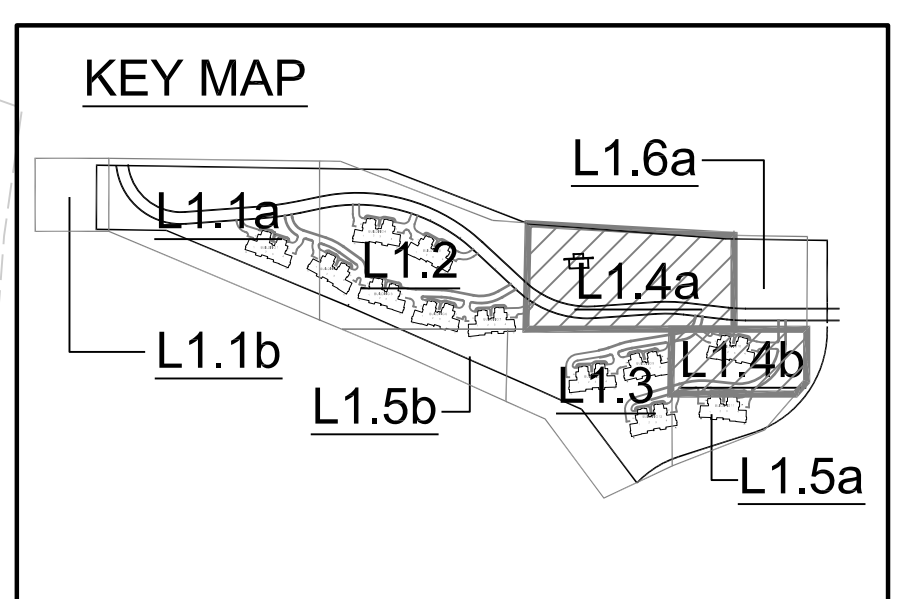

**THE RIDGE TOWNHOMES**  
WEBER COUNTY, UT

P.R.U.D APPROVAL  
WEBER COUNTY, UT



DATE:	NOVEMBER 2013
PROJECT:	.028
DRAWN BY:	MP
REVIEW BY:	EL
VERSION:	P.R.U.D
REVISIONS:	

SHEET TITLE:  
**LANDSCAPE PLAN**

SHEET NUMBER:

**L1.4**

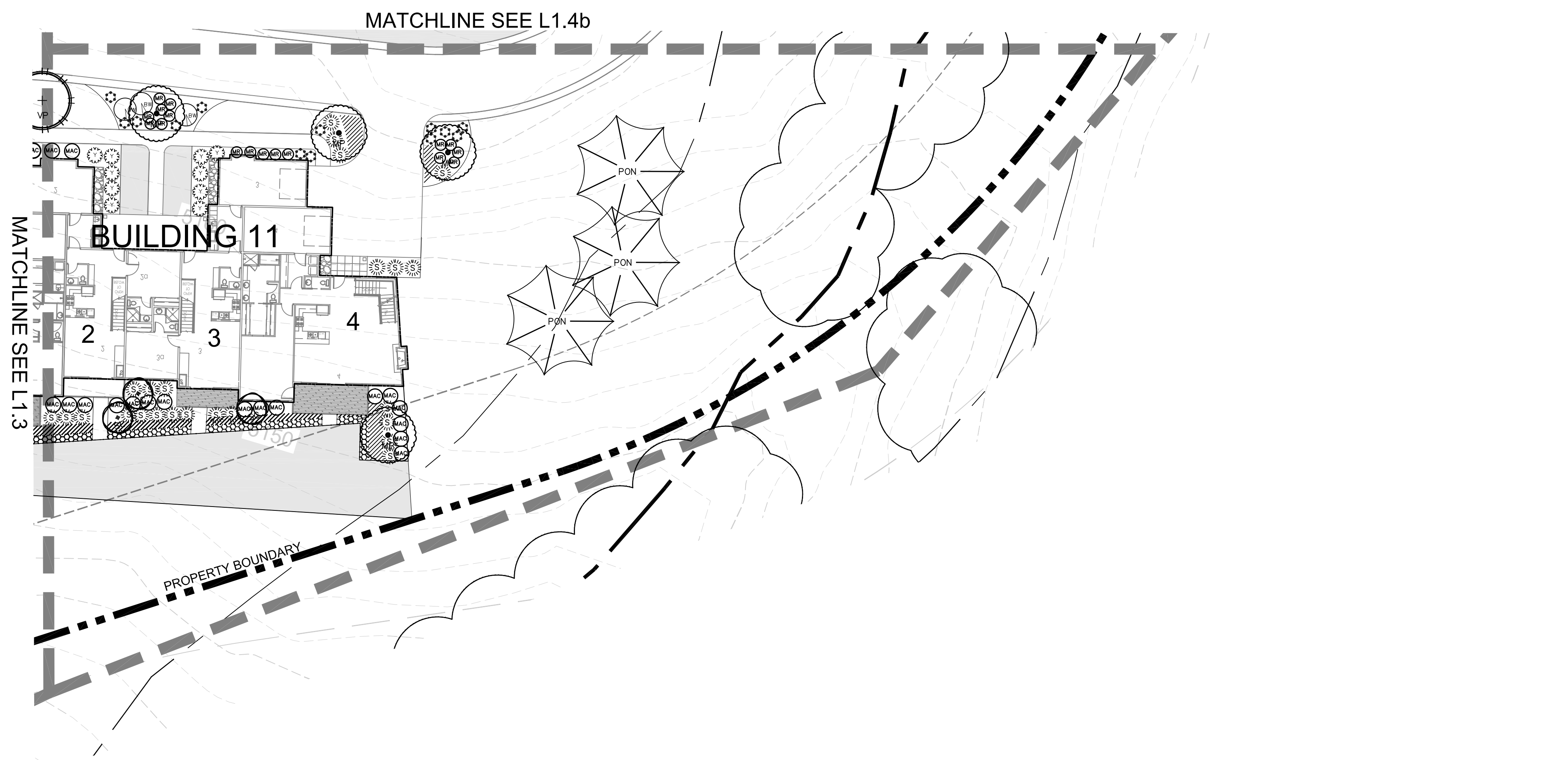

a L1.5a

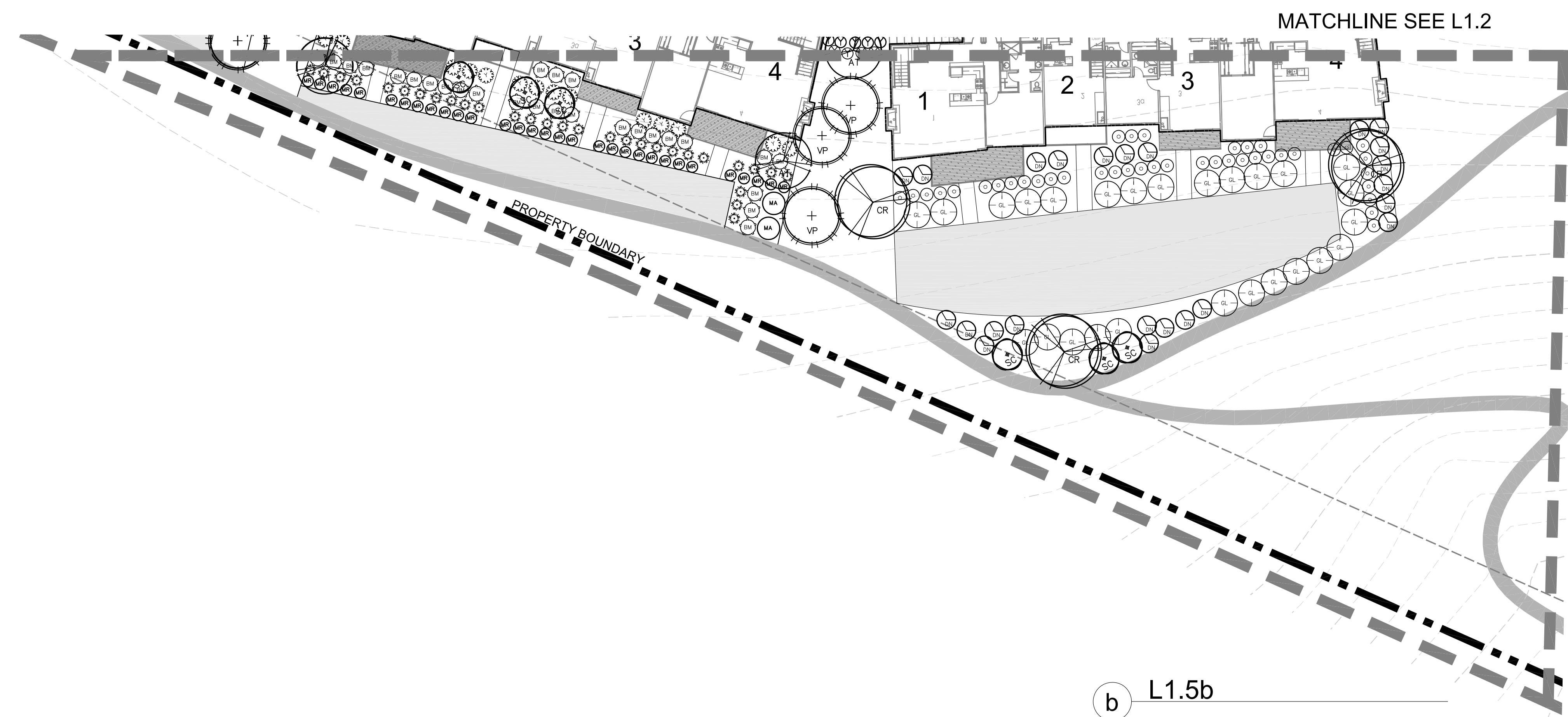

b L1.5b

- LARGE SHRUBS 7-9' SPREAD**
  - CA Cornus alba 'Argenteo marginata' Variegated Dogwood
  - GL Rhus aromatica 'Grow Low' Grow Low Sumac
- MEDIUM SHRUBS 5-7' SPREAD**
  - CS Cornus sericea 'Alleman's Compact' Alleman's Red Osier Dogwood
  - DT Physocarpus opulifolius 'Dart's Gold' Ninebark
  - DN Physocarpus opulifolius nanus dwarf Dwarf Ninebark
  - RI Ribies alpinum Alpine Currant
  - SA Salix purpurea nana Blue Arctic Willow
- SMALL SHRUBS 2-5' SPREAD**
  - BM Caryopteris x clandonensis 'Blue Mist' Blue Mist Spirea
  - PF Potentilla fruticosa 'Jackmanii' Jackman Potentilla
- PERENNIALS**
  - Y Achillea filipendulina Yellow Yarrow
  - E Echinacea purpurea Purple Coneflower
  - LD Leucanthemum x compact 'Snow Lady' Shasta Dwarf Daisy
  - LH Lupinus 'Russell Hybrids' Russell Hybrids Lupine
  - PM Penstemon strictus 'Rocky Mountain' Rocky Mountain Penstemon
  - PS Perovskia atriplicifolia Common Russian Sage
  - RS Rudbeckia fulgida 'Goldstrum' Black Eyed Susan
- GRASSES**
  - BA Bouteloua gracilis 'Blonde Ambition' Blonde Ambition Blue Gramma Grass
  - PV Panicum virgatum 'Heavy Metal' Heavy Metal Switch Grass
  - SH Panicum virgatum 'Shenandoah' Shenandoah Switch Grass
  - HA Pennisetum alopecuroides Hameln Fountain Grass
- GROUNDCOVERS**
  - FS Fragaria vesca x Lipstick Lipstick Strawberry
  - MA Mahonia repens Creeping Oregon Grape
  - T Turf

**Plant Schedule**

SYMBOL	BOTANICAL/COMMON NAME
<b>EVERGREEN TREES</b>	
(Symbol: Circle with cross)	Abies lasiocarpa Sub-Alpine Fir
(Symbol: Circle with star)	Picea abies 'Cupressina' Columnar Columnar Norway Spruce
(Symbol: Circle with radiating lines)	Picea pungens Colorado Spruce
(Symbol: Circle with cross and vertical lines)	Pinus flexilis glauca 'Vanderwolf's Pyramid' Vanderwolf Limber Pine
(Symbol: Circle with cross and horizontal lines)	Pinus ponderosa Ponderosa Pine
<b>DECIDUOUS TREES</b>	
(Symbol: Circle with cross and diagonal lines)	Acer tartarian 'GarAnn' Hot Wings Tartarian
(Symbol: Circle with cross and horizontal lines)	Crataegus lavalley 'Carriere' Carriere Hawthorn
(Symbol: Circle with cross and vertical lines)	Malus x 'Perfect Purple' Perfect Purple Crabapple
(Symbol: Circle with cross and diagonal lines)	Populus deltoides 'Siouxland' Siouxland Plains Cottonwood
(Symbol: Circle with cross and horizontal lines)	Populus tremuloides Quaking Aspen
(Symbol: Circle with cross and vertical lines)	Populus tremula 'erecta' Swedish Columnar Swedish Columnar Aspen
(Symbol: Circle with cross and diagonal lines)	Sorbus aucuparia 'Cardinal Royal' Cardinal Royal Mtn. Ash
(Symbol: Circle with cross and horizontal lines)	Tilia mongolica 'Harvest Gold' Harvest Gold Mongolian Linden
<b>EVERGREEN SHRUBS</b>	
(Symbol: Circle with cross)	Buxus x 'Green Velvet' Green Velvet Boxwood
(Symbol: Circle with cross and horizontal lines)	Juniperus horizontalis 'Bar Harbor' Bar Harbor Juniper
(Symbol: Circle with cross and vertical lines)	Mahonia aquifolium Oregon Grape
(Symbol: Circle with cross and diagonal lines)	Mahonia aquifolium 'compacta' Compact Oregon Grape
(Symbol: Circle with cross and horizontal lines)	Pinus sylvestris 'Hillside Creeper' Hillside Creeper Scotch Pine
(Symbol: Circle with cross and vertical lines)	Yucca filamentosa Yucca

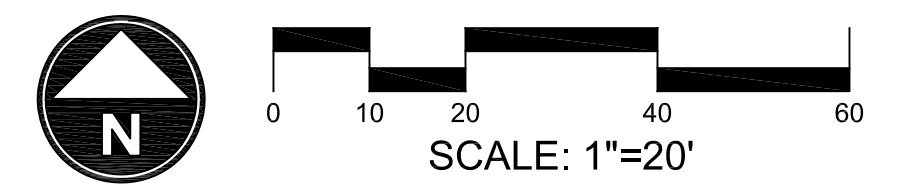
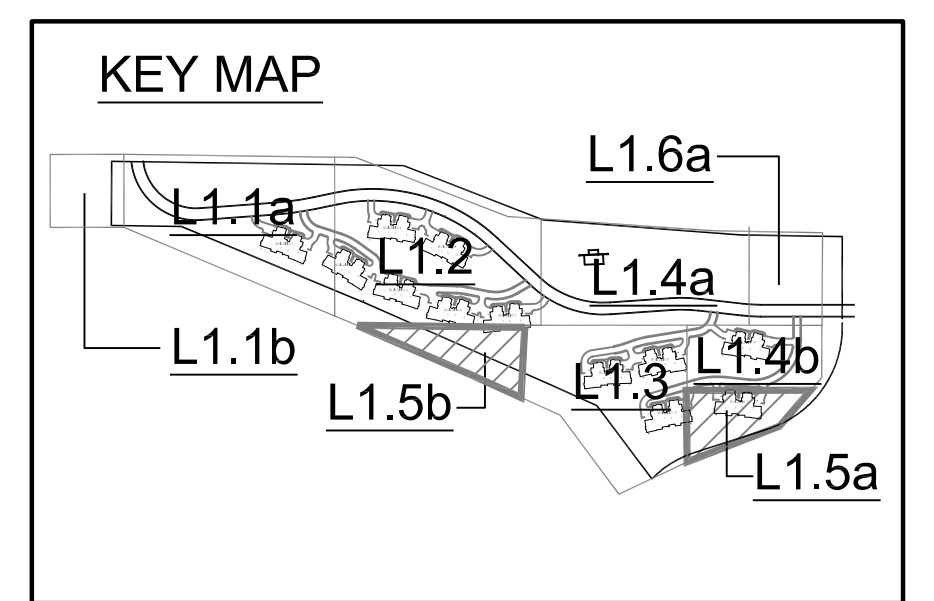

**THE RIDGE TOWNHOMES**  
WEBER COUNTY, UT

P.R.U.D APPROVAL  
WEBER COUNTY, UT



DATE:	NOVEMBER 2013
PROJECT:	.028
DRAWN BY:	MP
REVIEW BY:	EL
VERSION:	P.R.U.D
REVISIONS:	

SHEET TITLE:  
**LANDSCAPE PLAN**

SHEET NUMBER:  
**L1.5**

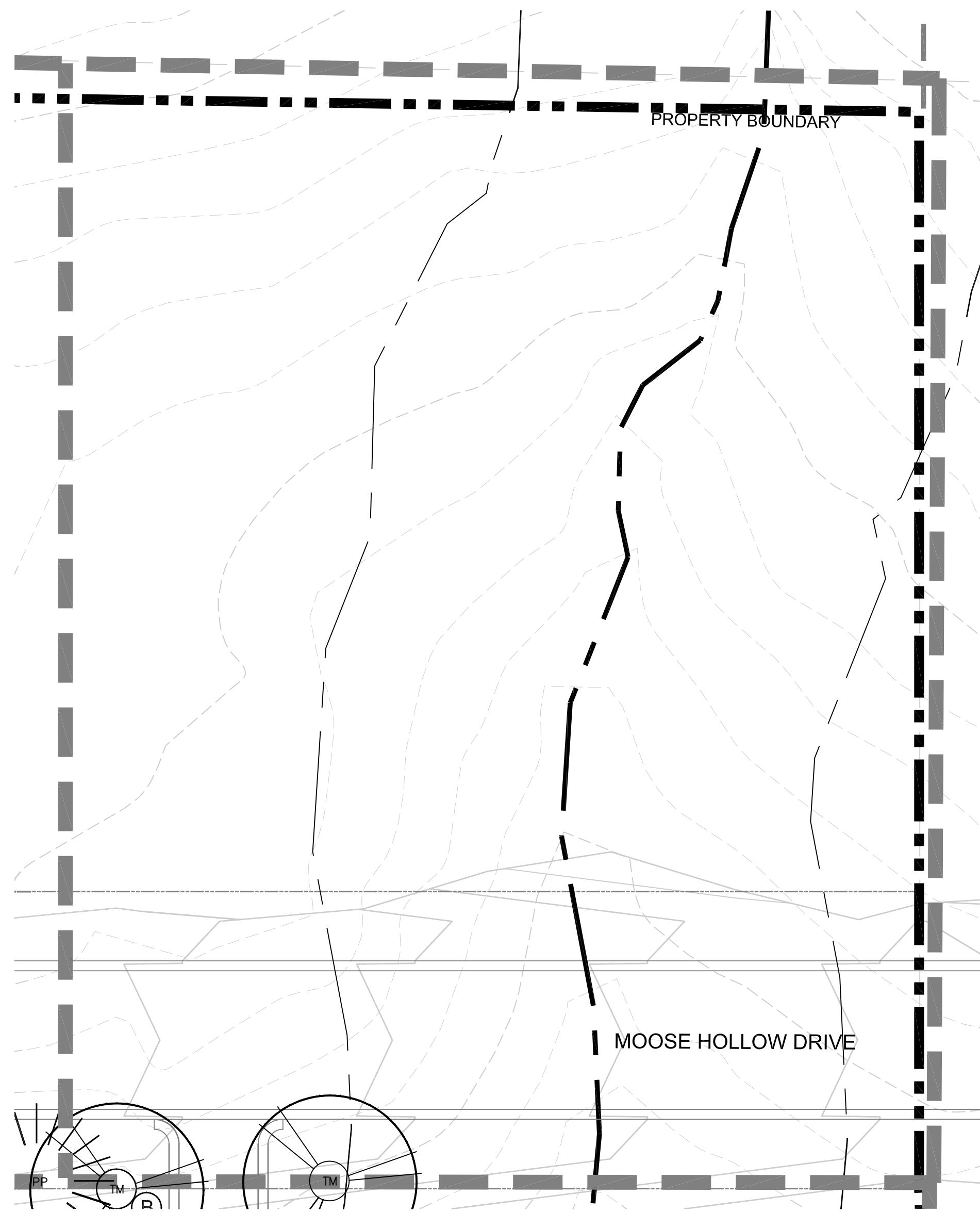

a L1.6

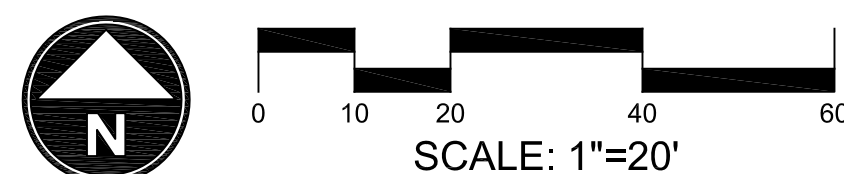
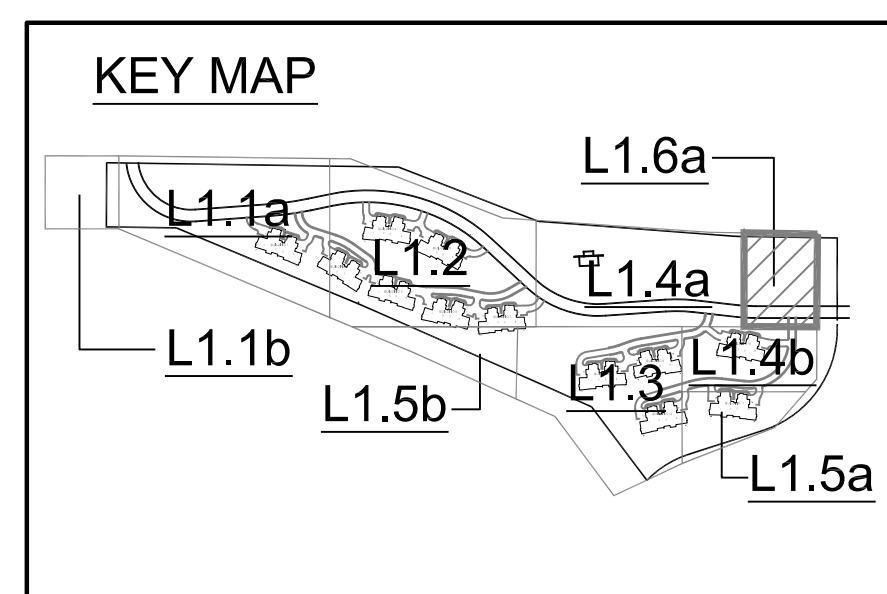

### Plant Schedule

QUANTITY	SYMBOL	BOTANICAL/COMMON NAME	HEIGHT	SPREAD	QUANTITY	SYMBOL	BOTANICAL/COMMON NAME	HEIGHT	SPREAD
<b>EVERGREEN TREES</b>									
19		<i>Abies lasiocarpa</i> Sub-Alpine Fir	6-8' Hgt.	50'x18'	7		<i>Cornus alba</i> 'Argenteo marginata' Variegated Dogwood	5 Gal.	8'x8'
9		<i>Picea abies</i> 'Cupressina' Columnar Norway Spruce	6-8' Hgt.	15-20' x 8'	31		<i>Rhus aromatica</i> 'Grow Low' Grow Low Sumac	5 Gal	30"x7"
6		<i>Picea pungens</i> Colorado Spruce	6-8' Hgt.	50'x30'	<b>MEDIUM SHRUBS 5-7' SPREAD</b>				
31		<i>Pinus flexilis glauca</i> 'Vanderwolf's Pyramid' Vanderwolf Limber Pine	6-8' Hgt.	25'x15'	81		<i>Cornus sericea</i> 'Alleman's Compact' Alleman's Red Osier Dogwood	5 Gal.	5'x5'
18		<i>Pinus ponderosa</i> Ponderosa Pine	6-8' Hgt.	50'x40'	36		<i>Physocarpus opulifolius</i> 'Dart's Gold' Ninebark	5 Gal.	5'x5'
<b>DECIDUOUS TREES</b>									
13		<i>Acer tartarian</i> 'GarAnn' Hot Wings Tartarian	2" CAL.	20'x15'	36		<i>Physocarpus opulifolius nanus</i> Dwarf Ninebark	5 Gal.	5'x5'
28		<i>Crataegus lavallei</i> 'Carriere' Carriere Hawthorn	2" CAL.	28'x20'	25		<i>Ribes alpinum</i> Alpine Currant	5 Gal.	5'x6'
19		<i>Malus x 'Perfect Purple'</i> Perfect Purple Crabapple	2" CAL.	15'x15'	27		<i>Salix purpurea nana</i> Blue Arctic Willow	5 Gal.	5'x6'
5		<i>Populus deltoides</i> 'Siouxland' Siouxland Plains Cottonwood	2" CAL.	75'x35'	<b>SMALL SHRUBS 2-5' SPREAD</b>				
13		<i>Populus tremuloides</i> Quaking Aspen	2" CAL.	35'x20'	58		<i>Caryopteris x clandonensis</i> 'Blue Mist' Blue Mist Spirea	5 Gal.	4'x4'
37		<i>Populus tremula</i> 'erecta' Swedish Columnar Swedish Columnar Aspen	2" CAL.	35'x8'	33		<i>Potentilla fruticosa</i> 'Jackmanii' Jackman Potentilla	5 Gal.	5'x5'
19		<i>Sorbus aucuparia</i> 'Cardinal Royal' Cardinal Royal Mtn. Ash	2" CAL.	35'x20'	<b>PERENNIALS</b>				
8		<i>Tilia mongolica</i> 'Harvest Gold' Harvest Gold Mongolian Linden	2" CAL.	40'x25'	64		<i>Achillea filipendulina</i> Yellow Yarrow	1 Gal.	4'x3'
<b>EVERGREEN SHRUBS</b>									
185		<i>Buxus x 'Green Velvet'</i> Green Velvet Boxwood	5 Gal.	4'x4'	170		<i>Echinacea purpurea</i> Purple Coneflower	1 Gal.	30"x24"
48		<i>Juniperus horizontalis</i> 'Bar Harbor' Bar Harbor Juniper	5 Gal.	12"x6'	416		<i>Leucanthemum x compact</i> 'Snow Lady' Shasta Dwarf Daisy	1 Gal.	12"x12"
28		<i>Mahonia aquifolium</i> Oregon Grape	5 Gal.	6'x6'	136		<i>Lupinus</i> 'Russell Hybrids' Russell Hybrids Lupine	1 Gal.	36"x15"
107		<i>Mahonia aquifolium</i> 'compacta' Compact Oregon Grape	5 Gal.	3'x4'	149		<i>Penstemon strictus</i> 'Rocky Mountain' Rocky Mountain Penstemon	1 Gal.	36"x24"
24		<i>Pinus sylvestris</i> 'Hillside Creeper' Hillside Creeper Scotch Pine	5 Gal.	2'x6'	45		<i>Perovskia atriplicifolia</i> Common Russian Sage	1 Gal.	3.5'x3'
103		<i>Yucca filamentosa</i> Yucca	5 Gal.	3'x4'	197		<i>Rudbeckia fulgida</i> 'Goldstrum' Black Eyed Susan	1 Gal.	3'x2'
<b>LARGE SHRUBS 7-9' SPREAD</b>									
<b>GRASSES</b>									
<b>GROUNDCOVERS</b>									
<b>MATERIALS</b>									

b Plant Schedule

**THE RIDGE TOWNHOMES**  
 WEBER COUNTY, UT

P.R.U.D APPROVAL  
WEBER COUNTY, UT



DATE: NOVEMBER 2013  
 PROJECT: .028  
 DRAWN BY: MP  
 REVIEW BY: EL  
 VERSION: P.R.U.D

REVISIONS:

SHEET TITLE:  
**LANDSCAPE PLAN & SCHEDULE**

SHEET NUMBER:

**L1.6**

**BACKFILL:**  
ONE PART MULCH TO THREE PARTS NATIVE SOIL.

**PLANTING PIT SIZES:**  
1 GAL. OR 5 GAL. - 2X WIDTH OF ROOT BALL, DEPTH = ROOT BALL + 6"  
15 GAL. OR LARGER - 3X WIDTH OF ROOT BALL, DEPTH = ROOT BALL + 12"

**FERTILIZER TABLETS (21 GRAM AGRIFORM TABLETS)**  
1 PER 1 GAL., 3 PER 5 GAL., 5 PER 15 GAL., 1 PER 3" OF BOX SIZE (24" BOX OR LARGER)

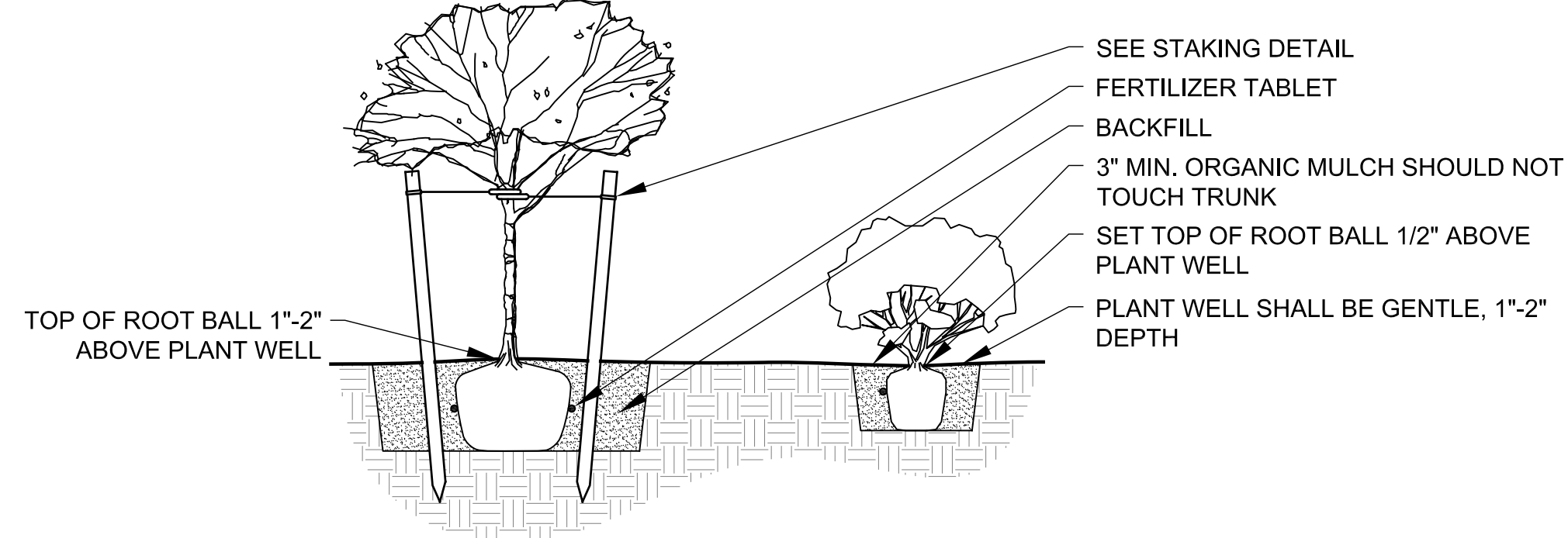

**1 DECIDUOUS TREE AND SHRUB PLANTING**

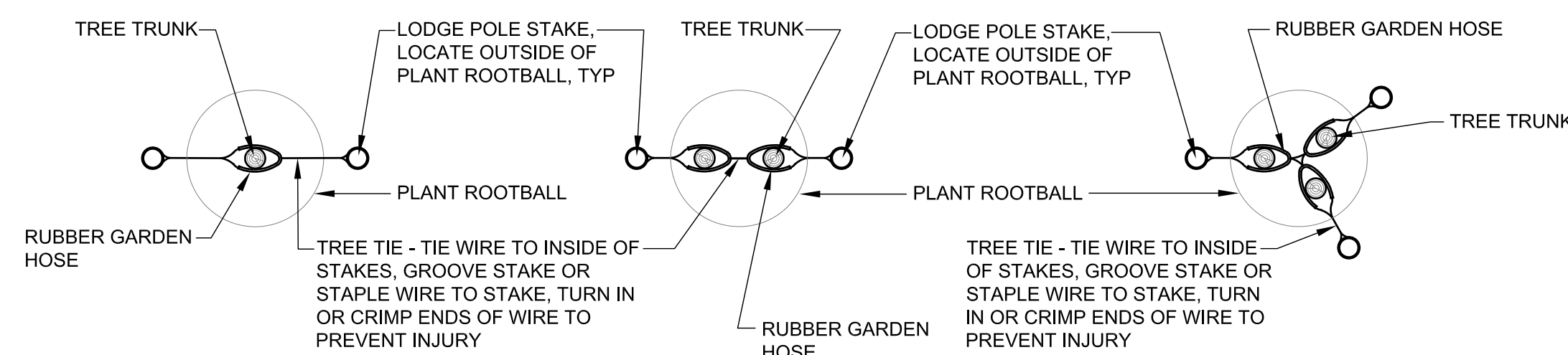

TREE STAKING PLAN - STANDARD      TREE STAKING PLAN - MULTIPLE      TREE STAKING PLAN - MULTIPLE

**2 DECIDUOUS TREE STAKING**

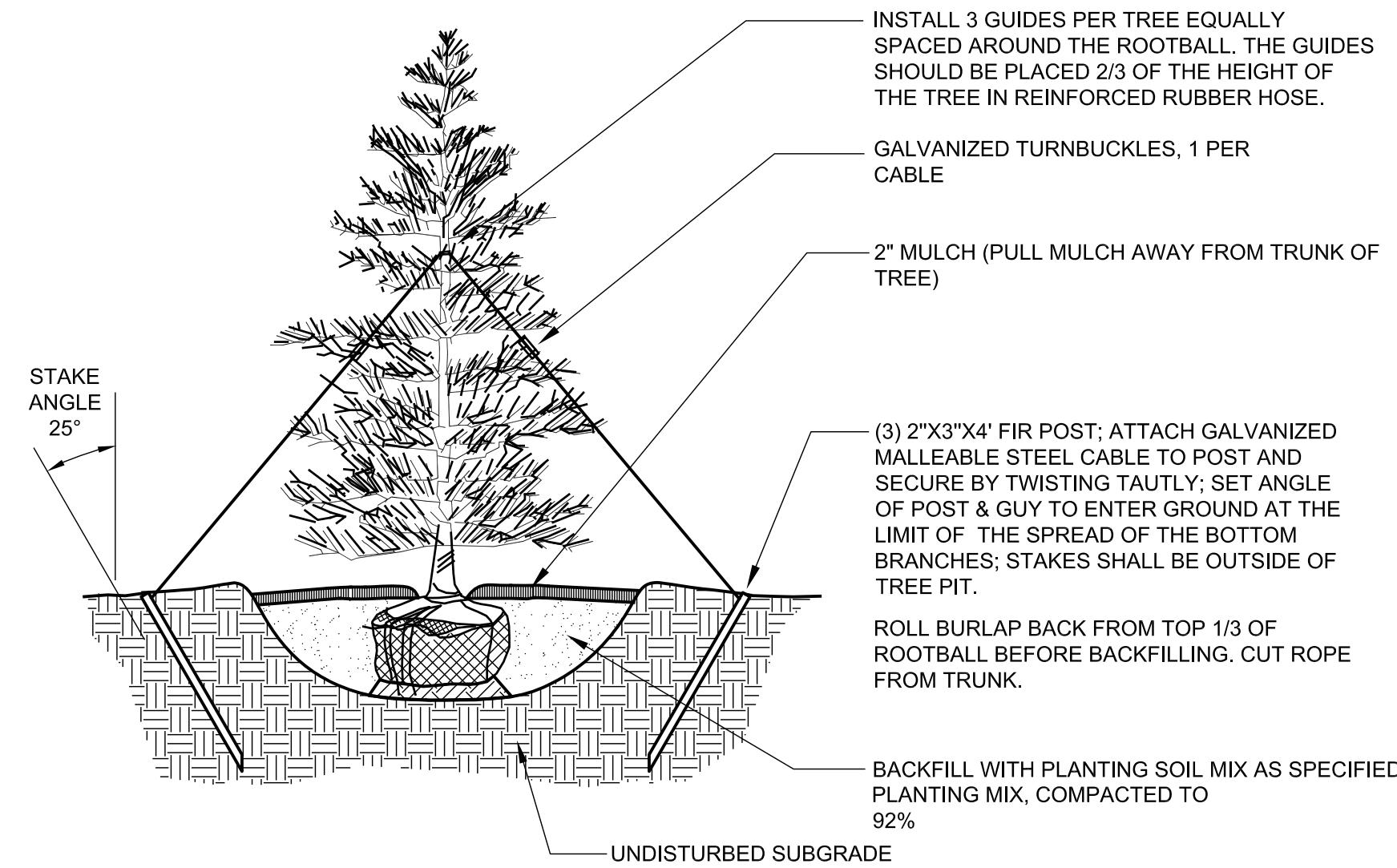

**3 EVERGREEN TREE PLANTING AND STAKING**

NOTE:  
ALL GROUNDCOVERS TO BE PLANTED ON CENTER (SEE PLANT LEGEND) IN A TRIANGULAR PATTERN.

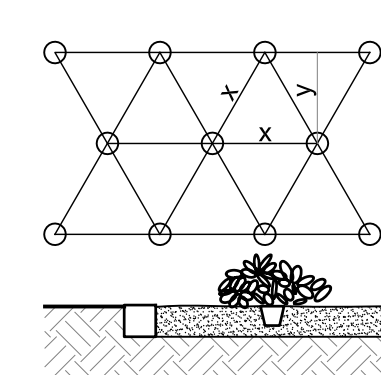

**4 GROUNDCOVER SPACING**

MULCH SOIL TO A DEPTH OF 2" IN DIAMETER. KEEP MULCH 2" AWAY FROM PLANT BASE  
PREPARE SOIL PER SPECIFICATIONS AND ROTOTILL TO A DEPTH OF 6" PRIOR TO ANY SPRINKLER WORK  
BACKFILL WITH NATIVE SOIL. APPLY FERTILIZER TO SURFACE AWAY FROM TRUNK PER SPECIFICATIONS

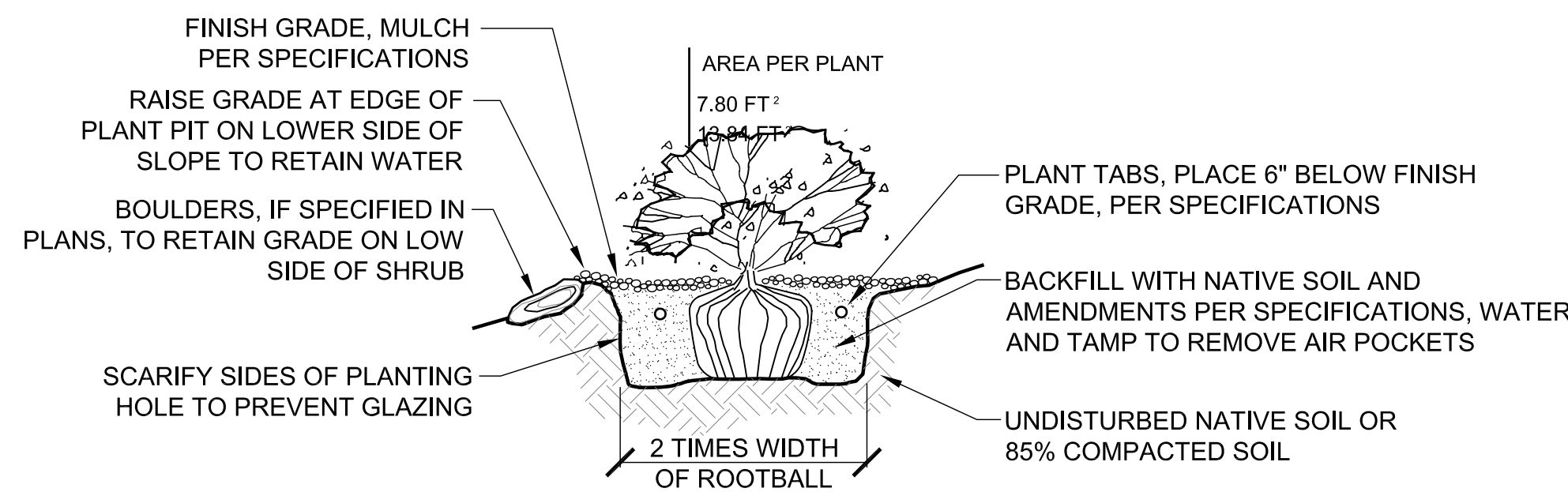

**5 SHRUB PLANTING ON A SLOPE**

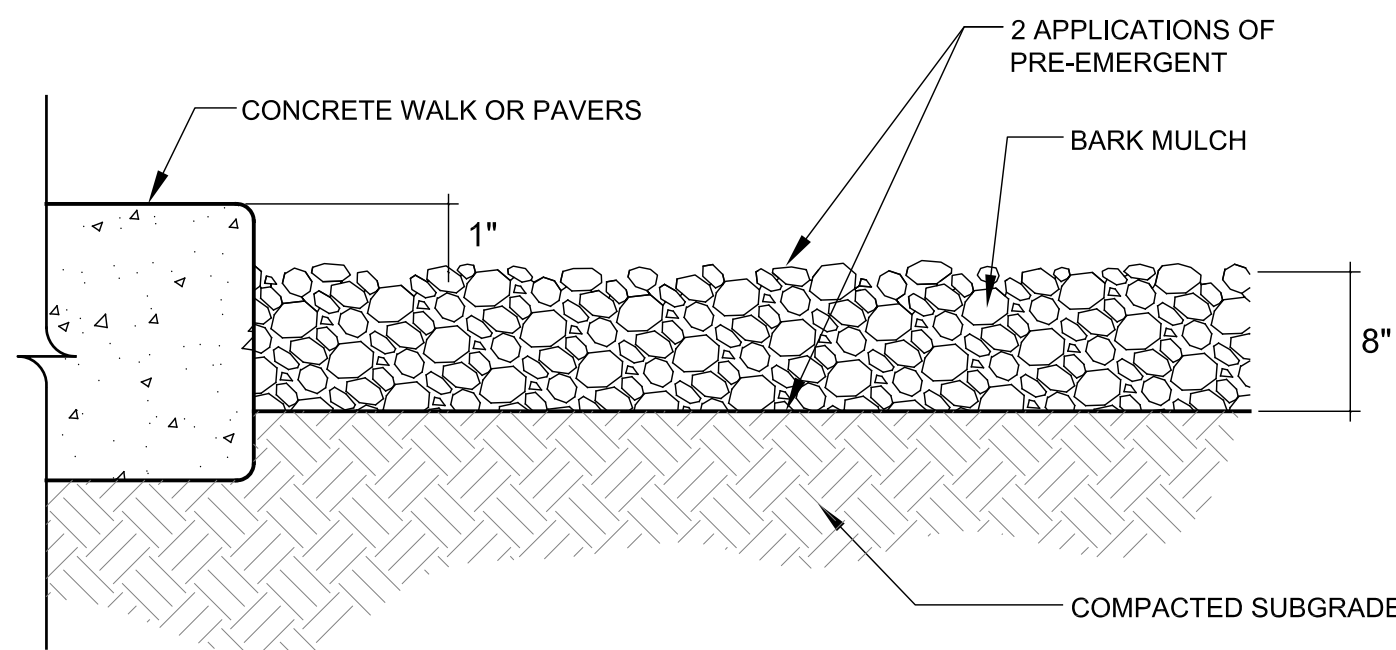

NOTES:  
1. SIZE AND COLOR OF MULCH IS SHOWN ON THE SITE PLAN AND LANDSCAPE PLAN.  
2. PRE-EMERGENT SHALL BE APPLIED TO FINISH GRADE BEFORE INSTALLATION OF MULCH.  
3. FINAL APPLICATION OF PRE-EMERGENT SHALL BE APPLIED TO FINISH GRADE AFTER INSTALLATION OF MULCH IS RAKED SMOOTH AND UNIFORM.

**6 LANDSCAPE MULCH**

**GENERAL LANDSCAPE NOTES**

1. THE CONTRACTOR SHALL VERIFY THE EXACT LOCATION OF ALL EXISTING AND PROPOSED UTILITIES, AND ALL SITE CONDITIONS PRIOR TO BEGINNING CONSTRUCTION. THE CONTRACTOR SHALL COORDINATE HIS WORK WITH THE PROJECT MANAGER AND ALL OTHER CONTRACTORS WORKING ON THE SITE.
2. THE FINISH GRADE OF ALL PLANTING AREAS SHALL BE SMOOTH, EVEN AND CONSISTENT, FREE OF ANY HUMPS, DEPRESSIONS OR OTHER GRADING IRREGULARITIES. THE FINISH GRADE OF ALL LANDSCAPE AREAS SHALL BE GRADED CONSISTENTLY 3/4" BELOW THE TOP OF ALL SURROUNDING WALKS, CURBS, ETC.
3. THE CONTRACTOR SHALL STAKE THE LOCATION OF ALL PLANTS FOR APPROVAL PRIOR TO PLANTING. TREES SHALL BE LOCATED EQUIDISTANT FROM ALL SURROUNDING PLANT MATERIAL. SHRUBS AND GROUND COVERS SHALL BE TRIANGULAR AND EQUALLY SPACED.
4. THE PLANT MATERIALS LIST IS PROVIDED AS AN INDICATION OF THE SPECIFIC REQUIREMENTS OF THE PLANTS SPECIFIED, WHEREVER IN CONFLICT WITH THE PLANTING PLAN, THE PLANTING PLAN SHALL GOVERN.
5. THE CONTRACTOR SHALL PROVIDE ALL MATERIALS, LABOR AND EQUIPMENT REQUIRED FOR THE PROPER COMPLETION OF ALL LANDSCAPE WORK AS SPECIFIED AND SHOWN ON THE DRAWINGS.
6. ALL PLANT MATERIALS SHALL BE APPROVED PRIOR TO PLANTING. THE OWNER/LANDSCAPE ARCHITECT HAS THE RIGHT TO REJECT ANY AND ALL PLANT MATERIAL NOT CONFORMING TO THE SPECIFICATIONS. THE OWNER/LANDSCAPE ARCHITECTS DECISION WILL BE FINAL.
7. THE CONTRACTOR SHALL KEEP THE PREMISES, STORAGE AREAS AND PAVING AREAS NEAT AND ORDERLY AT ALL TIMES. REMOVE TRASH, SWEEP, CLEAN, HOSE, ETC. DAILY.
8. THE CONTRACTOR SHALL PLANT ALL PLANTS PER THE PLANTING DETAILS. STAKE/GUY AS SHOWN. TOP OF ROOT BALLS SHALL BE PLANTED FLUSH WITH FINISH GRADE.
9. THE CONTRACTOR SHALL NOT IMPEDE DRAINAGE IN ANY WAY. THE CONTRACTOR SHALL ALWAYS MAINTAIN POSITIVE DRAINAGE AWAY FROM THE BUILDING, WALLS, ETC.
10. THE CONTRACTOR SHALL MAINTAIN ALL WORK UNTIL ALL WORK IS COMPLETE AND ACCEPTED BY THE OWNER. UPON COMPLETION OF LANDSCAPE WORK AN INSPECTION FOR ACCEPTANCE OF THE WORK SHALL BE HELD. THE CONTRACTOR SHALL NOTIFY THE OWNER/LANDSCAPE ARCHITECT FOR SCHEDULING OF INSPECTION AT LEAST SEVEN (7) DAYS IN ADVANCE.
11. THE CONTRACTOR SHALL MAINTAIN AND GUARANTEE ALL WORK FOR A PERIOD OF ONE YEAR FROM THE DATE OF FINAL ACCEPTANCE BY THE OWNER. REPLACEMENT PLANTS SHALL BE GUARANTEED FOR AN ADDITIONAL 90 DAYS. MAINTENANCE SHALL INCLUDE MOWING, WEEDING, FERTILIZING, CLEANING, INSECTICIDES, HERBICIDES, ETC.
12. NATIVE GRASS SEEDDED AREAS TO BE A MIXTURE OF:  
40% BIG HORN BLUE HARD FESCUE  
40% DEFIANT HARD FESCUE  
20% JAMESTOWN 4 CHEWINGS FESCUE  
SEEDING RATE: 35 LBS PLS/ACRE
13. ALL DISTURBED AREAS OUTSIDE MULCHED LANDSCAPE BEDS ARE TO BE SEEDDED WITH NATIVE GRASS MIXTURE.
14. ALL LANDSCAPE BEDS TO BE MULCHED WITH A MINIMUM 3" SHREDDED BARK.

**IRRIGATION NOTE:**

1. ALL PLANT MATERIALS SHOWN ON THE DRAWING SHALL BE SERVICED BY AN AUTOMATIC UNDERGROUND IRRIGATION SYSTEM. ALL SHRUB BED AREAS, INCLUDING TREES SHALL BE IRRIGATED WITH A LOW PRESSURE DRIP IRRIGATION SYSTEM. ALL GRASS AREAS, EITHER NATIVE OR MANICURED SHALL BE IRRIGATED WITH A BROADCAST IRRIGATION SYSTEM.
2. THE CONTRACTOR IS TO HAVE A QUALIFIED IRRIGATION SYSTEM SPECIALIST PREPARE A DESIGN FOR AN AUTOMATIC UNDERGROUND IRRIGATION SYSTEM AND SUBMIT DRAWINGS TO THE ENGINEER FOR APPROVAL AT LEAST 30 DAYS PRIOR TO THE SYSTEM INSTALLATION.
3. UNDERGROUND IRRIGATION SYSTEM DRAWINGS SHALL BE PREPARED ON 24"X 36" SHEETS, NEATLY DRAWN AND VERY LEGIBLE. DRAWINGS ARE TO INCLUDE HEAD SPACING, TYPES OF HEADS, PIPING WITH SIZES, VALVES, FITTINGS AND ALL OTHER ITEMS REQUIRED FOR PROPER INSTALLATION OF THE SYSTEM.
4. THE LANDSCAPE CONTRACTOR SHALL BE RESPONSIBLE FOR THE INSTALLATION OF ALL IRRIGATION SLEEVES PRIOR TO PLACEMENT OF HARD IMPROVEMENTS. COORDINATE WITH THE GENERAL CONTRACTOR.
5. THE UTILITY CONTRACTOR IS TO PROVIDE AN IRRIGATION SYSTEM CONNECTION TO EITHER THE CULINARY OR SECONDARY WATER LINE WITH A BACK FLOW PREVENTION DEVICE, AS APPLICABLE, WITHIN STATE AND LOCAL JURISDICTIONAL CODES. THE IRRIGATION CONTRACTOR IS RESPONSIBLE TO COORDINATE THIS ITEM WITH THE UTILITY CONTRACTOR. IF SECONDARY WATER IS USED, THE SYSTEM SHALL BE FILTERED WITH A CLEANABLE FILTER SYSTEM.
6. THE IRRIGATION CONTROL BOX SHALL BE LOCATED AT THE DIRECTION OF THE PROJECT MANAGER/OWNER.

P.R.U.D APPROVAL  
WEBER COUNTY, UT



DATE:	NOVEMBER 2013
PROJECT:	.028
DRAWN BY:	MP
REVIEW BY:	EL
VERSION:	P.R.U.D
REVISIONS:	

SHEET TITLE:  
**LANDSCAPE DETAILS**

SHEET NUMBER:  
**L1.7**