

**2475 South Street**

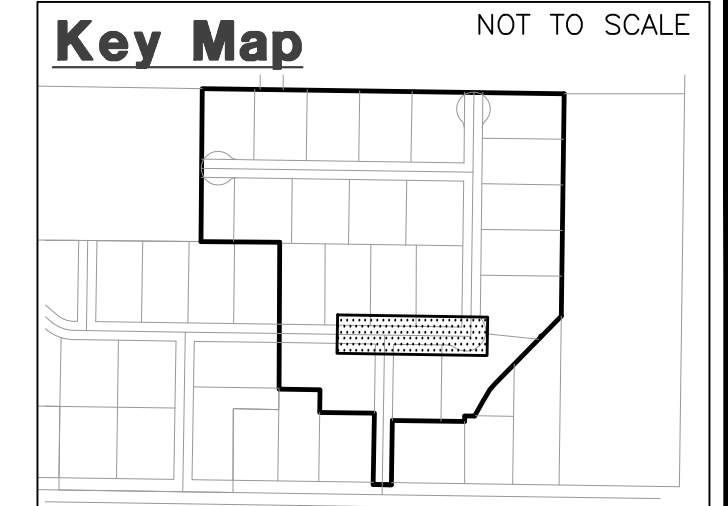
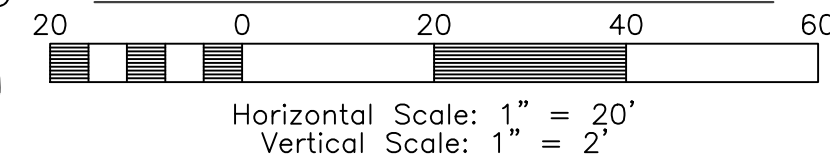

- Construction Notes:**
- 1) ALL CONSTRUCTION IS TO CONFORM TO THE STANDARD DRAWINGS AND SPECIFICATIONS OF WEBER COUNTY.
- CULINARY WATER**  
W/8 - 8" PVC C-900 CLASS 200 WATER
- SANITARY SEWER**  
SS/8 - 8" PVC C-900 SEWER LINE  
SS/10 - 10" PVC C-900 SEWER LINE
- STORM DRAIN**  
SD/15 - 15" RCP STORM DRAIN
- SECONDARY WATER**  
SW/8 - 8" PVC C-900 SECONDARY WATER LINE

**Reeve & Associates, Inc.**  
920 CHAMBERS STREET, SUITE 14, OGDEN, UTAH 84403  
TEL: (801) 621-1100 FAX: (801) 621-2668 www.reeve-assoc.com  
LAND PLANNERS • CIVIL ENGINEERS • LAND SURVEYORS  
TRAFFIC ENGINEERS • STRUCTURAL ENGINEERS • LANDSCAPE ARCHITECTS

REVISIONS	DESCRIPTION

Mallard Springs Subdivision  
WEBER COUNTY, UTAH

**2475 South Street**  
**20+00.00 - 25+00.00**

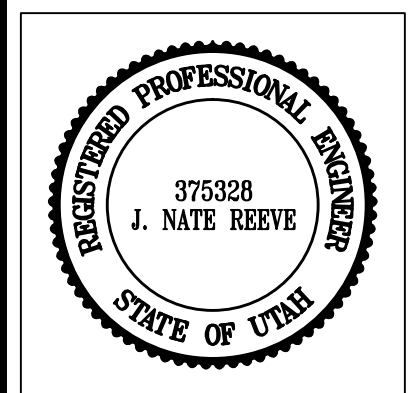

**Project Info.**  
Engineer: J. NATE REEVE, P.E.  
Draftsman: R. HANSEN  
Begin Date: NOVEMBER 4, 2013  
Name: MALLARD SPRINGS SUBDIVISION  
Number: 3442-A30

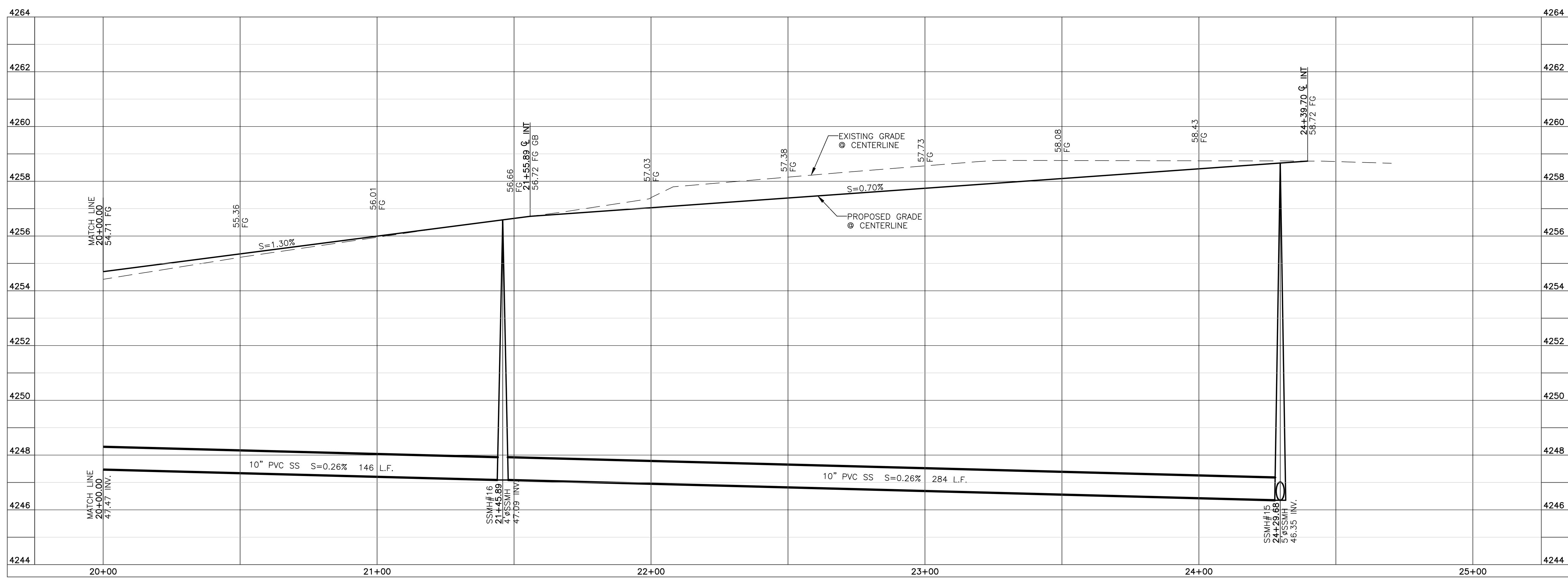

Blue Stakes Location Center  
**Call: Toll Free 1-800-662-4111**  
Two Working Days Before You Dig