

# LEGEND

- SS — LIFT STATION #1
- SS — LIFT STATION #2
- SS — LIFT STATION #3
- SS — LIFT STATION #4
- SS — LIFT STATION #5
- SS — SOUTH LIFT STATION (SLS)
- SS — PROPOSED GRAVITY TRUNK LINE
- SS — EXISTING GRAVITY TRUNK LINE
- SS — SYSTEM IMPROVEMENT LINE
- SS — PROPOSED FORCE MAIN (8" PVC)
- SS — LIFT STATION AREA ADJUSTMENTS
- SS — SOUTH LIFT STATION (CWSID)
- SS — NORTH LIFT STATION (CWSID)
- SS — WET WELL ELEVATION

SLS

NLS

W.W.E.

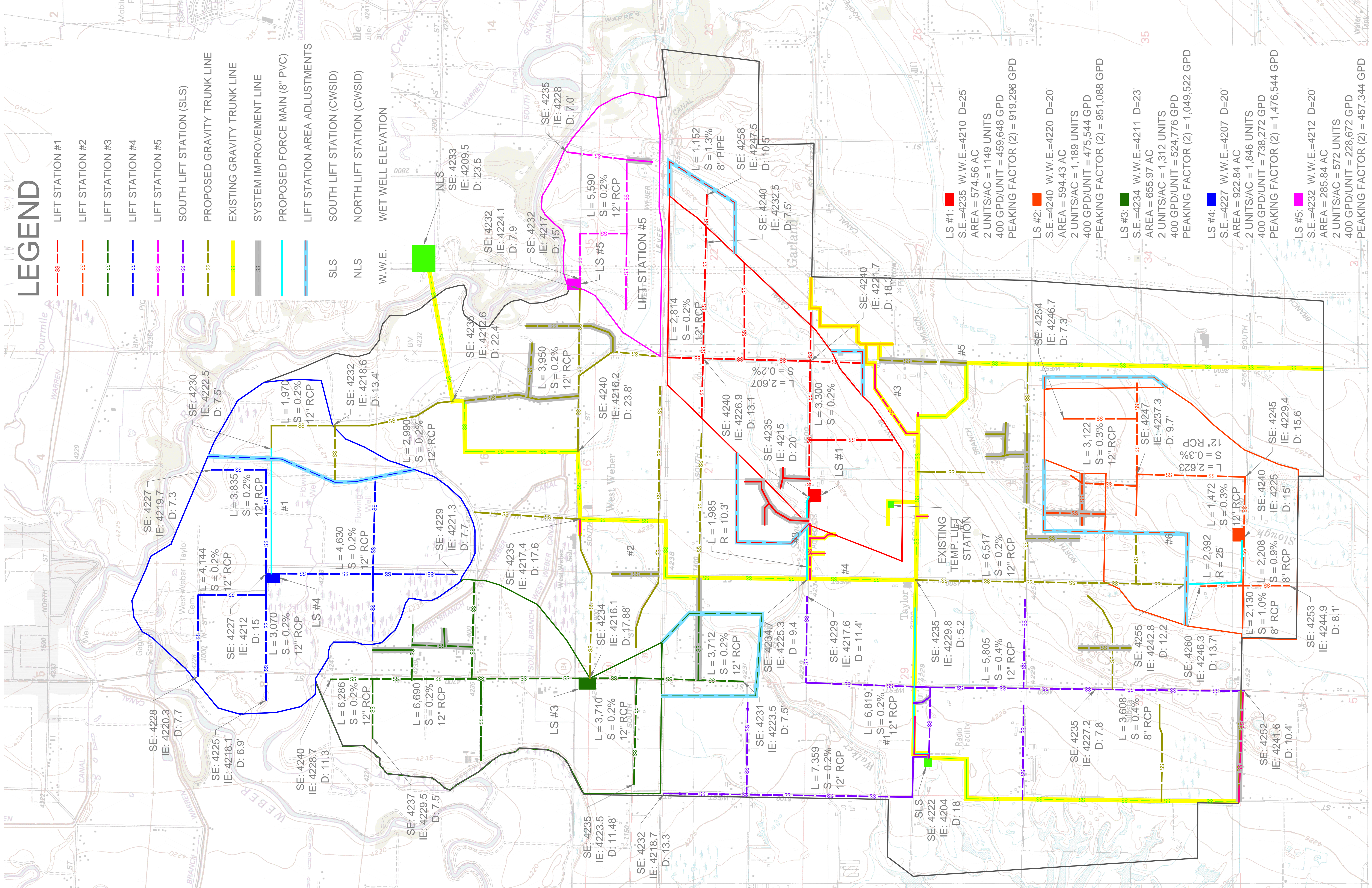

**LS #1:**  
S.E.=4235 W.W.E.=4210 D=25'  
AREA = 574.56 AC  
2 UNITS/AC = 1149 UNITS  
400 GPD/UNIT = 459,648 GPD  
PEAKING FACTOR (2) = 919,296 GPD

**LS #2:**  
S.E.=4240 W.W.E.=4220 D=20'  
AREA = 594.43 AC  
2 UNITS/AC = 1,189 UNITS  
400 GPD/UNIT = 475,544 GPD  
PEAKING FACTOR (2) = 951,088 GPD

**LS #3:**  
S.E.=4234 W.W.E.=4211 D=23'  
AREA = 655.97 AC  
2 UNITS/AC = 1,312 UNITS  
400 GPD/UNIT = 524,776 GPD  
PEAKING FACTOR (2) = 1,049,522 GPD

**LS #4:**  
S.E.=4227 W.W.E.=4207 D=20'  
AREA = 922.84 AC  
2 UNITS/AC = 1,846 UNITS  
400 GPD/UNIT = 738,272 GPD  
PEAKING FACTOR (2) = 1,476,544 GPD

**LS #5:**  
S.E.=4232 W.W.E.=4212 D=20'  
AREA = 285.84 AC  
2 UNITS/AC = 572 UNITS  
400 GPD/UNIT = 228,672 GPD  
PEAKING FACTOR (2) = 457,344 GPD