



# Weber County Parcel Search

2380 Washington Blvd Ogden, Utah

[Weber County Home](#) - [Parcel Search](#) - [Interactive Maps](#)

[Print this page](#)

[Current Taxes](#)

[Ownership Info](#)

[Tax History](#)

[Property Characteristics](#)

[Delinquent Taxes](#)

Today's Date: 05/13/2021

[<--Back to Search](#)

**Parcel #: 220110020**

### Building Characteristics

Property Type: Residential  
Built As Desc.: CB  
Stories: 1  
Above Grade Square Feet: 1,089  
Basement Square Feet: 1,089  
Total Square Feet: 2,178  
Basement Percent Complete: 100%  
Garage Sq. Feet: 294  
Percent Complete: 100%  
Exterior: Frame Masonry Veneer  
Roof Cover: Formed Seam Metal  
Year Built: 1948  
Lot Size: 0.3 Acres

### Building Sketches - Click on Image to enlarge

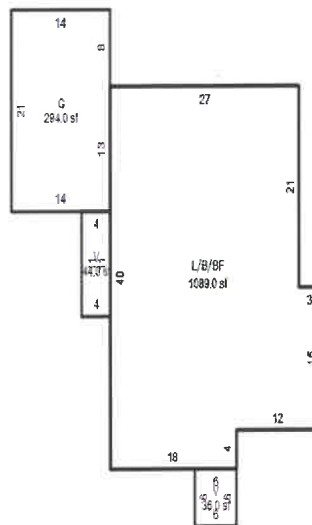

Search by Aerial Satellite\*

### MAPS

[View in Geo-Gizmo](#)

22-011  [View PDF](#)

PROPERTY DESCRIPTION

Date Time: 13-MAY-2021 12:57 PM

Serial No. 22 011 0020

As of 02-DEC-1978

Change Year and Code 1976 ORIG

Acres 0.3053

+ -

\* The following description \*

SQ FT 13300

\* for taxation purposes only\*

Remember

Enter/Edit

Nbr. Description

11	PART OF THE NORTHWEST QUARTER OF SECTION 20, TOWNSHIP 7 NORTH,
12	RANGE 1 EAST, SALT LAKE BASE AND MERIDIAN, U.S. SURVEY:
13	BEGINNING AT A POINT WHICH IS NORTH 333.59 FEET AND WEST 44.77
14	FEET FROM THE CENTER OF SAID SECTION 20, (SAID POINT IS ON AN
15	OLD FENCE ON THE WEST LINE OF 3500 EAST STREET); RUNNING
16	THENCE SOUTH 0D17' EAST 100.00 FEET ALONG SAID WEST LINE OF
17	STREET; THENCE SOUTH 89D03' WEST 133.00 FEET; THENCE NORTH
18	0D17' WEST 100.00 FEET; THENCE NORTH 89D03' EAST 133.00 FEET
19	ALONG A CHAINLINK FENCE TO THE POINT OF BEGINNING.

Prior #  
22-011-0001  
Year built  
1948