

Land Use Permit

Structure Setback Graphic: Storage Shed, Detached Garage, Etc.

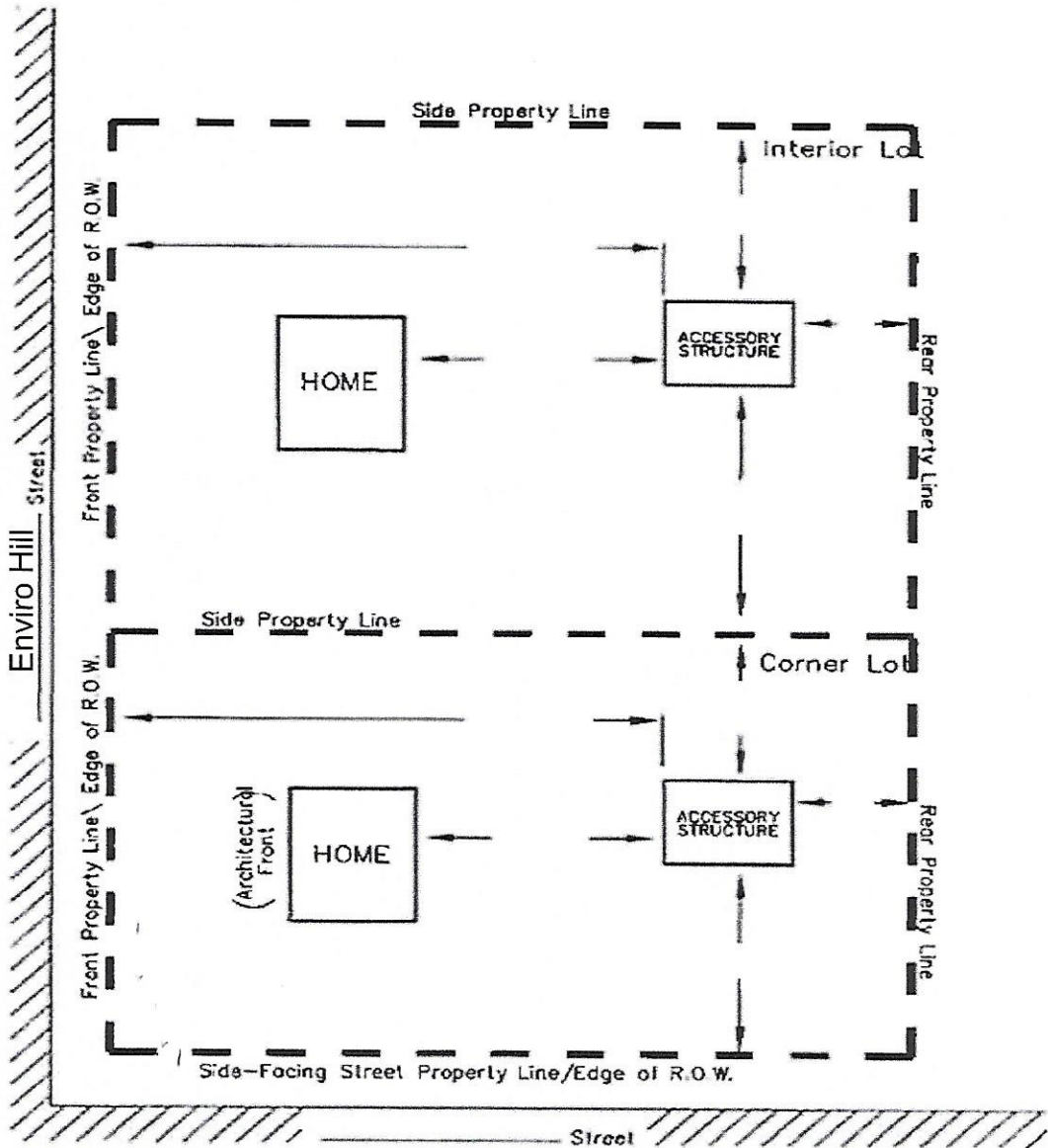

MINIMUM YARD SETBACKS
Storage Shed, Detached Garage, Etc.

NOTICE FOR APPLICANT (Please Read Before Signing)

Proposals for the installation of an individual water supply and for a sanitary waste disposal system (septic tank) for any structure designed for human occupation must be approved by Weber County Health Department prior to installation.

Tammy Aydelotte 02/05/2021
Planning Dept. Signature of Approval Date

I hereby certify that I have read and examined this application and know the same to be true and correct. All provisions of laws and ordinances governing this land use will be complied with whether specified herein or not. I make this statement under penalty of perjury.

[Signature] 2-8-2021
Contractor/Owner Signature of Approval Date