

APPLICANT/DESIGNER:



architecture • sustainability • design services

255 Crossroad Square
Salt Lake City, UT 84115
P:(801) 961-7070
F:(801) 961-7373

EXISTING ZONING: FV-3
DISCLOSURES:
1- ALL WATER SOURCES AND SEPTIC SYSTEMS ARE EXISTING
2- LOCATION AND TYPE OF NEW LANDSCAPING AND VEGETATION BY LANDSCAPER

THE HARVEST MOON RANCH

325 S.

326'-7"

10000 E ST

PROPERTY LINE

10027 E 325 S = 5.36 ACRES
LOT 21-046-0005
5.36 ACRES

NEIGHBOR HOUSE

NEIGHBOR HOUSE

BERM WITH TREE AND SHRUB SCREENING

GRAVEL DRIVEWAY AND PARKING

BERM WITH TREE AND SHRUB SCREENING

NEIGHBOR BARN

NEIGHBOR BARN

BERM WITH TREE AND SHRUB SCREENING

13' WIDE GRAVEL OR DIRT RESTROOM TRAILER ACCESS AISLE

EXISTING BARN

EXISTING SEPTIC TANK

NEW ADA RESTROOM

EXISTING RESTROOM

EXISTING POOL

TREE SCREENING

POLE STRUCTURE
GLAMPING PAD
PLATFORMS

30'-0" SETBACK

EXISTING VEGETABLE GARDEN

TREE SCREENING

PROJECT NARRATIVE:

"Harvest Moon Ranch"

Conference/Education Center

Kasey Plourde, Property Owner and Business Owner
435-901-3625;
kasey@harvestmoonevents.com
10027 E 325 S Huntsville, UT 84317
Parcel #21-046-0005

Additional property discussed in this application:
394 S 10000 E (Parcel # 21-046-0006) currently owned by Kimbal and Debra Wheatley. Under contract to be owned by Kasey Plourde by mid-January 2021.

10027 E 325 S = 5.36 acres
394 S 10000 E = 7.4 acres
Grand Total = 12.76 acres

180'-0"

30'-0" SETBACK

EXISTING GRAVEL DRIVEWAY

EXISTING GRAVEL DRIVEWAY

EXISTING SEPTIC TANK

EXISTING HOME

GRAVEL PATH

10000 E 394 S = 7.4 ACRES
LOT 21-046-0006
5.36 ACRES

JANUARY 20, 2021

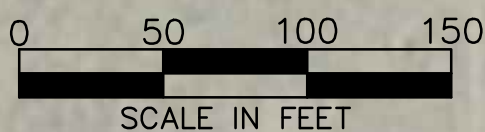

THE HARVEST MOON RANCH ENLARGED

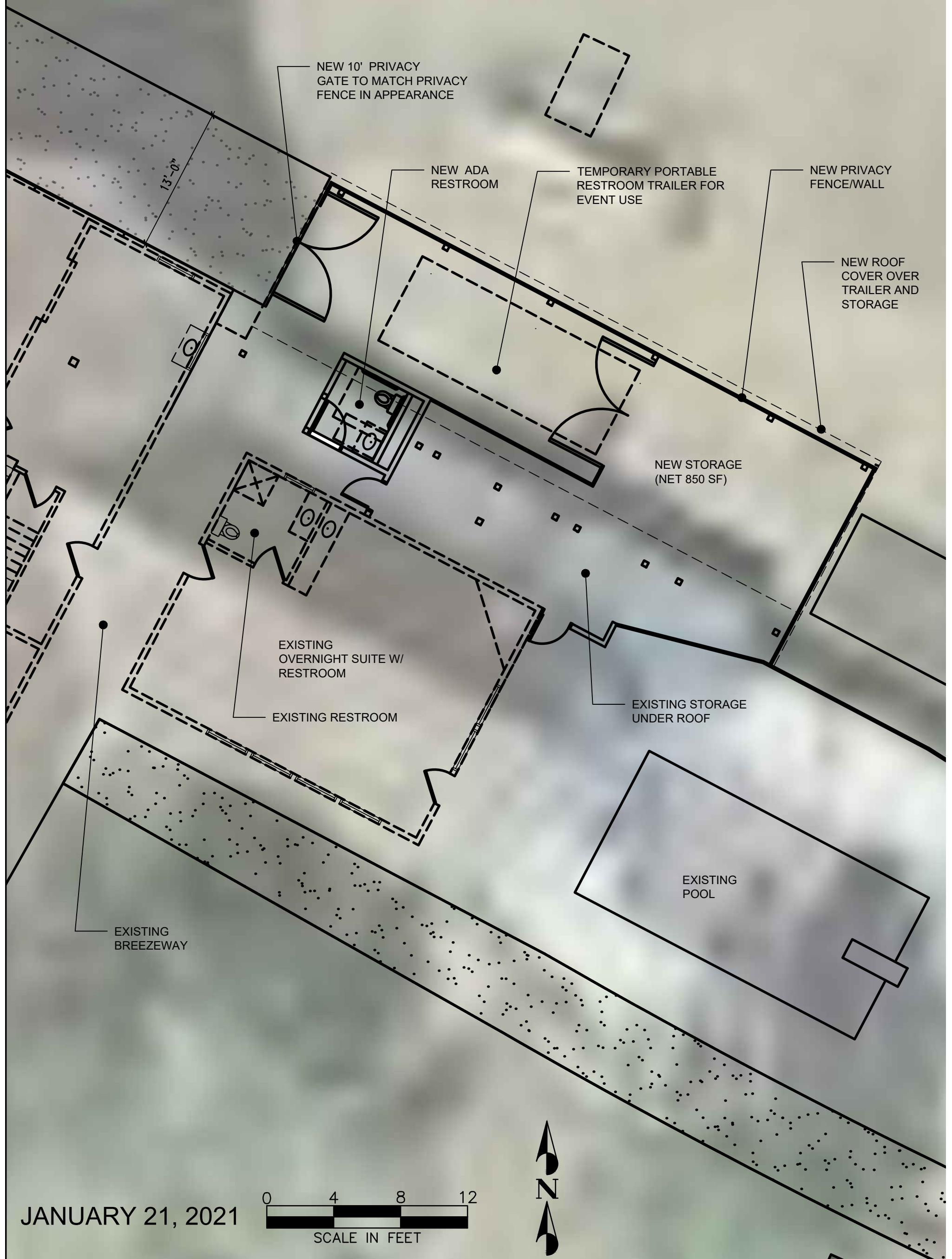

JANUARY 21, 2021

