



**CONCEPT TABULATIONS**

TOTAL STORAGE UNITS	100 UNITS
 12'X26'	49 UNITS
 12'X40'	30 UNITS
 12'X50'	21 UNITS

**GENERAL NOTES**

Due to the nature of the project (boat & rv storage), we do not anticipate needing any dedicated parking spaces

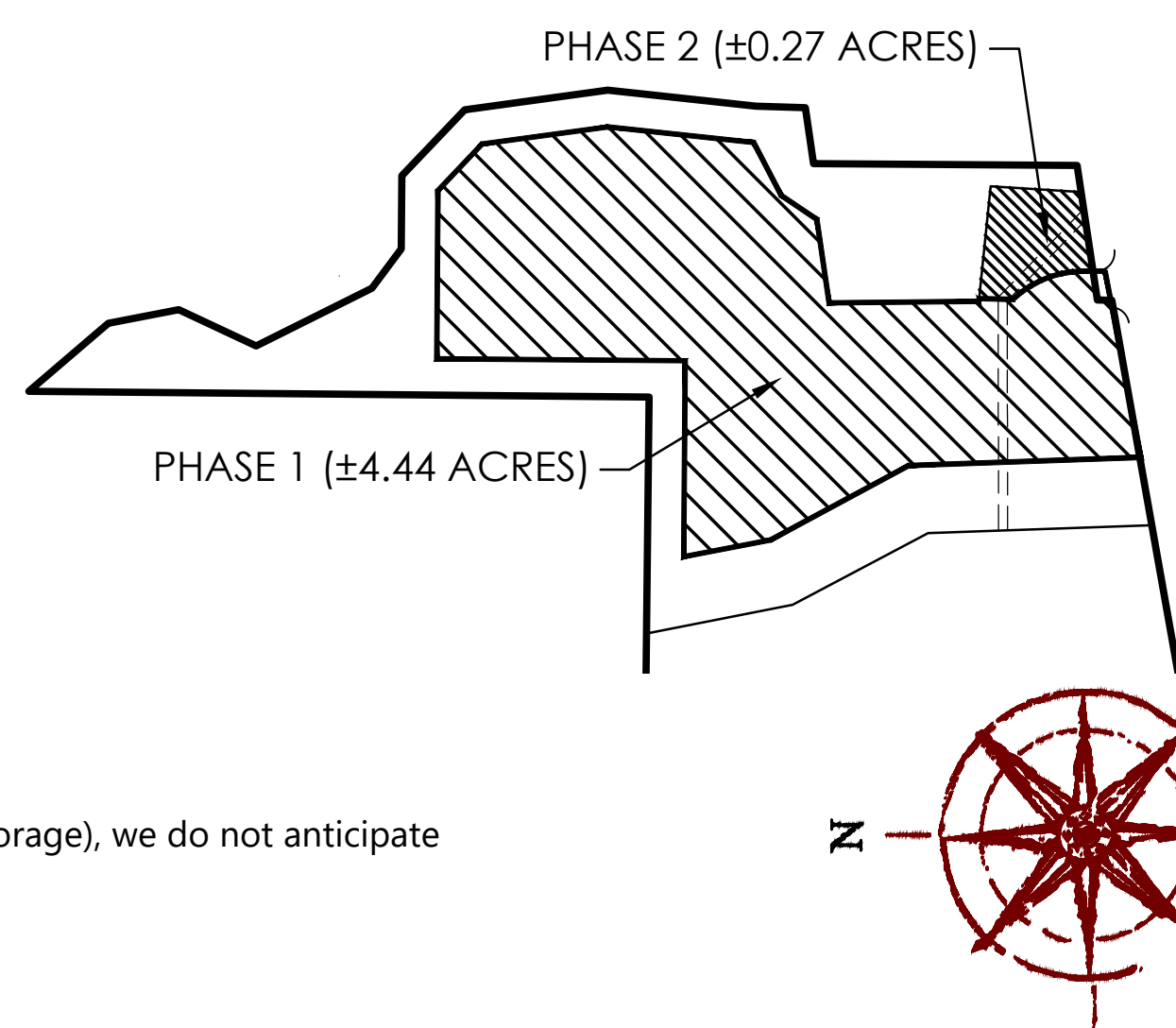

# LAS AMERICAS EDEN BOAT & RV STORAGE PH. 1 conceptual site plan

EDEN, WEBER COUNTY  
6/17/2020  
19-0205

Note: This plan is for illustrative purposes only. Boundaries may be based on parcels obtained through public GIS data. It is recommended that a survey be performed to determine actual boundary size and dimensions as well as other potential boundary conflicts.

