

1. All 15/20 AMP receptacles w/i dwelling unit shall be tamper resistant receptacles.
2. All kitchen, bathrooms, garage, outside and utility outlets to be GFCI protected
3. All outside outlets are bubble outlets.
4. Outlets installed so that no point along wall is more than 6 feet from outside.
5. Outlets above counter spaces located so that no point along wall is more than 24 inches from the outlet.
6. A minimum of two 20 AMP circuits in the kitchen.
7. Exhaust fan vents follow schedule.
8. Branch circuit supplying the receptacle in a garage shall not supply outlets outside the garage.
9. All 125 volt, single phase (15 and 20 AMP) receptacles installed in laundry shall have GFCI protection as well as kitchen and bathrooms.
10. A 250 AMP meter to be provided if house exceeds 5,000 sq. ft.

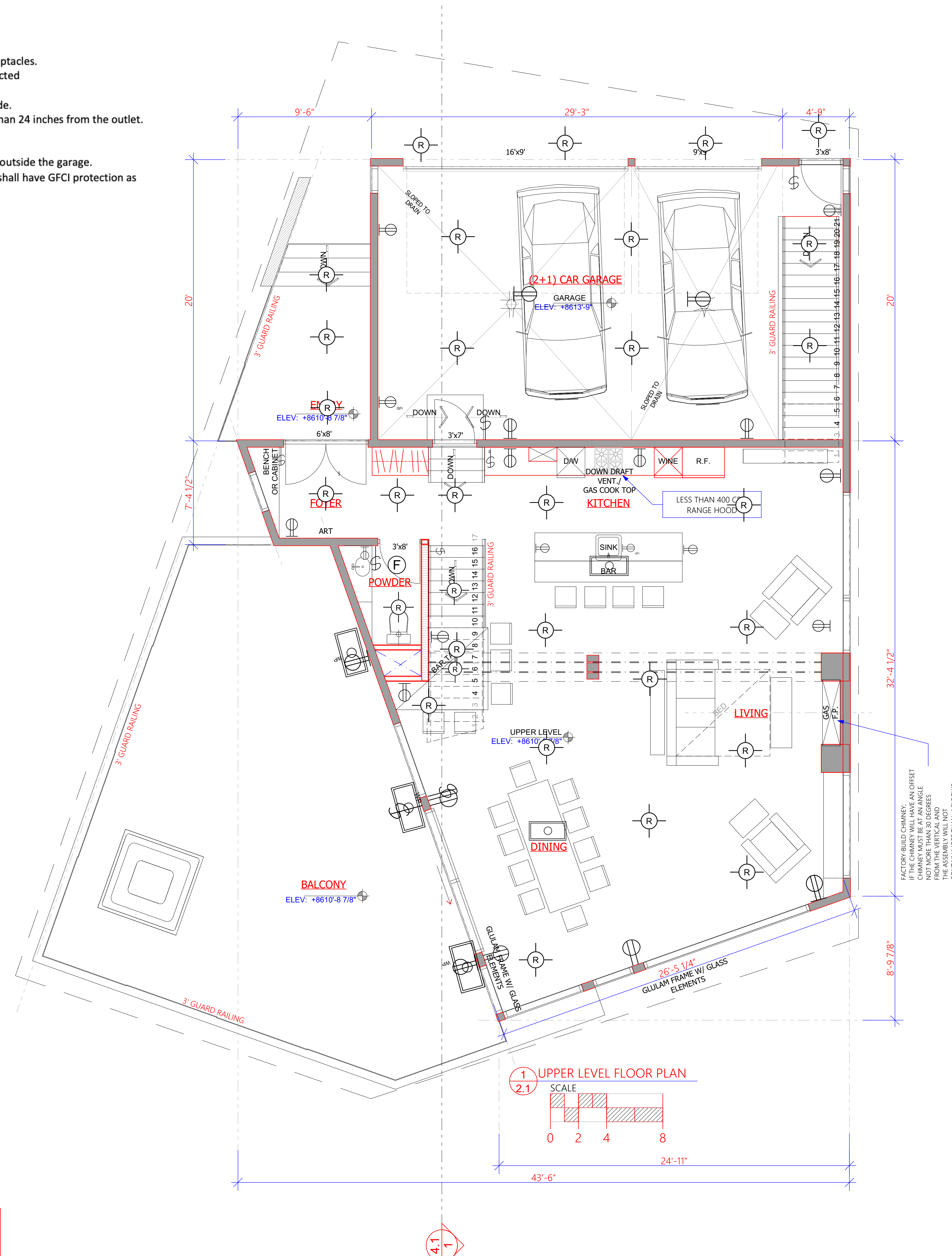

aa | Volume

ARCHITECTURAL OFFICE  
 Company Name: Scandinavian LLC  
 Address: 6410 N. Business Park Loop Rd. Unit E  
 Phone: 435-513-0355  
 Fax:  
 Project No.:  
 Cad File:  
 Drawn:  
 Checked:

A New Residence:  
**BLAKE KINGSBURY**  
 Summit Powder Mountain, Lot # 86R  
 85 49 E. Spring Park, Weber County, Utah

BUILDER  
 Company Name:  
 Address:  
 Park City, Utah 84098  
 Phone:  
 Fax:

Drawing Date: 08-05-2019  
 Scale: 1/4" = 1' - 0"  
 Title No.:  
**UPPER LEVEL FLOOR PLAN**  
 BUILDER/DEALER'S APPROVAL:

Signature and Date



AREA CALCULATION (max. 5500)	
UPPER LEVEL FLOOR PLAN	1 184 sqft
(3) CAR GARAGE	683 sqft
MAIN LEVEL FLOOR PLAN	1 729 sqft
GARAGE ENTRY	21 sqft
LOWER LEVEL FLOOR PLAN	1 797 sqft
MECHANICAL / STORAGE	85 sqft
TOTAL HEATED AREA 5 499 sqft	
UNHEATED AREAS - sqft	
TOTAL BUILDING AREA 5 499 sqft	

NOTE:  
ROOM AREAS SHOWN BELOW  
ROOM NAMES ARE APPROXIMATE  
ALL FRAMING STUDS ARE 16"

WALL LEGEND:

- WALL 1:**  
6 1/2" - RECTANGULAR LAMINATED PROFILE WALL 6 1/2" [164x260]
- WALL 2:**  
8 5/8" - RECTANGULAR LAMINATED PROFILE WALL 6 1/2"  
- 2"x2" FURRING WALL @16" O.C.  
\* SLIDING CONNECTORS, (INSULATION)  
- GYP. BOARD 1/2"  
- DAMP-PROOF COURSE  
- TILE
- WALL 3:**  
7 5/8" - 3 1/2" CONCRETE VENEER or 3/4" CEDAR SHIPLAP CLADDING or WEATHERED STEEL PANELS  
- TYVEK  
- PLYWOOD 7/16"  
- 2"x6" STUD FRAMING @16" O.C.  
- R-19 BATT INSULATION  
- MOISTURE BARRIER  
- GYP. BOARD 1/2"
- WALL 4:**  
1'-2 1/2" - 10" CONCRETE WALL  
- 3/4" FURRING  
- 2"x4" FURRING WALL @16" O.C.  
\* BATT INSULATION  
- MOISTURE BARRIER  
- 1/2" GYP. BOARD
- WALL 5:**  
4 5/8" - GYP. BOARD 1/2"  
- 2"x4" STUD FRAMING @16" O.C.  
- GYP. BOARD 1/2"  
- DAMP-PROOF COURSE  
- TILE
- WALL 6:**  
6 3/4" - GYP. BOARD 1/2"  
- 2"x6" STUD FRAMING @16" O.C.  
- GYP. BOARD 1/2"

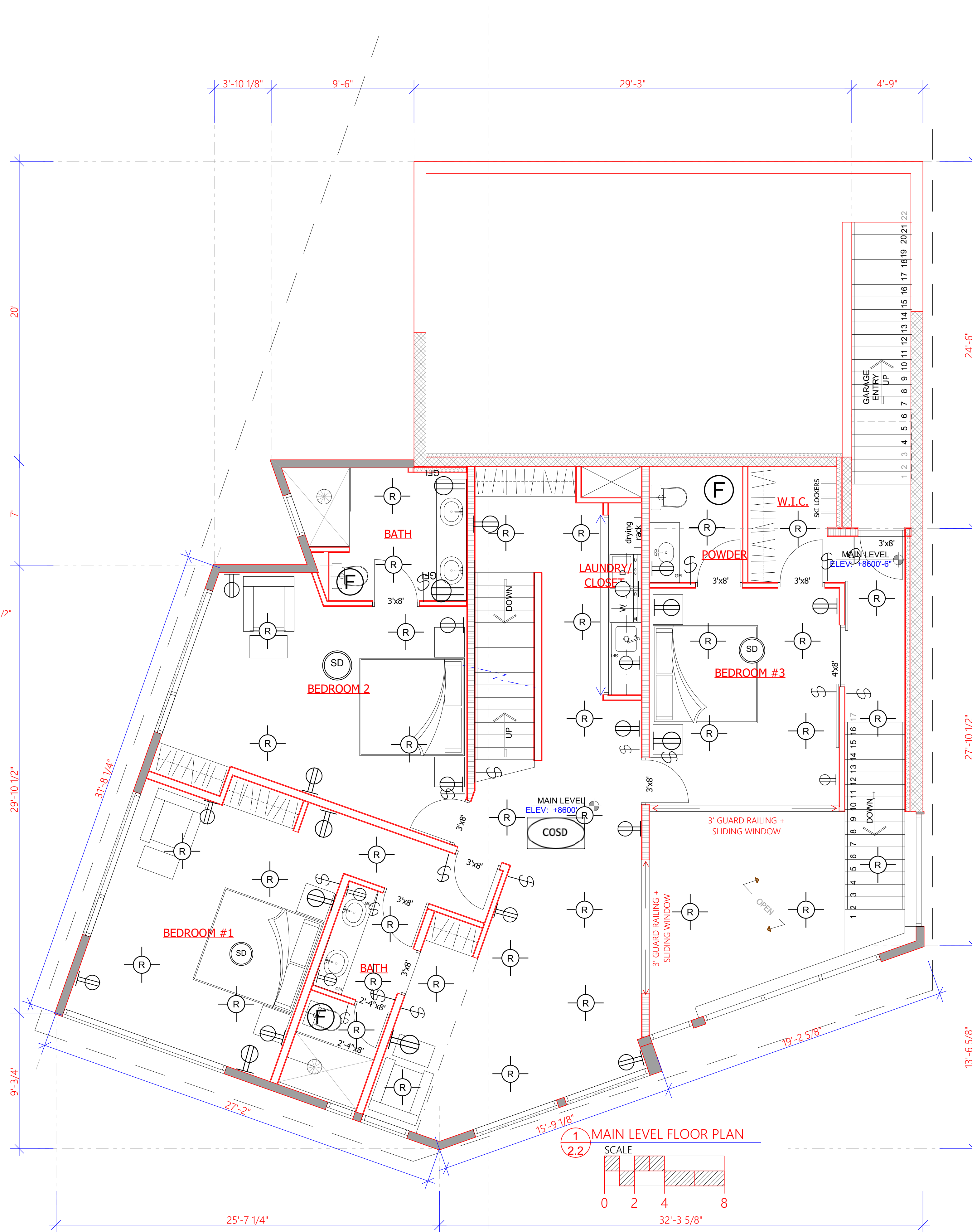

ARCHITECTURAL OFFICE

Company Name  
Scandinavian LLC  
Address  
6410 N. Business  
Park Loop Rd. Unit E  
Phone 435-513-0355  
Fax  
Project No.  
Cad File  
Drawn  
Checked

A New Residence:  
**BLAKE KINGSBURY**  
Summit Powder Mountain, Lot # 86R  
85 49 E. Spring Park, Weber County, Utah

BUILDER

Company Name  
Address  
Park City, Utah 84098  
Phone  
Fax

Drawing Date 08-05-2019

Scale 1/4" = 1'-0"

Title No.  
**MAIN LEVEL FLOOR PLAN**  
BUILDER/DEALER'S APPROVAL:

Signature and Date



© COPYRIGHT 2019  
THIS DRAWING AND ALL INFORMATION CONTAINED HEREIN IS THE EXCLUSIVE PROPERTY OF SCANDINAVIAN LLC.  
NO PART OF THIS DRAWING OR INFORMATION MAY BE REPRODUCED OR TRANSMITTED IN ANY FORM OR BY ANY MEANS WITHOUT THE EXPRESS WRITTEN CONSENT OF SCANDINAVIAN LLC AND MUST BE RETURNED UPON REQUEST.

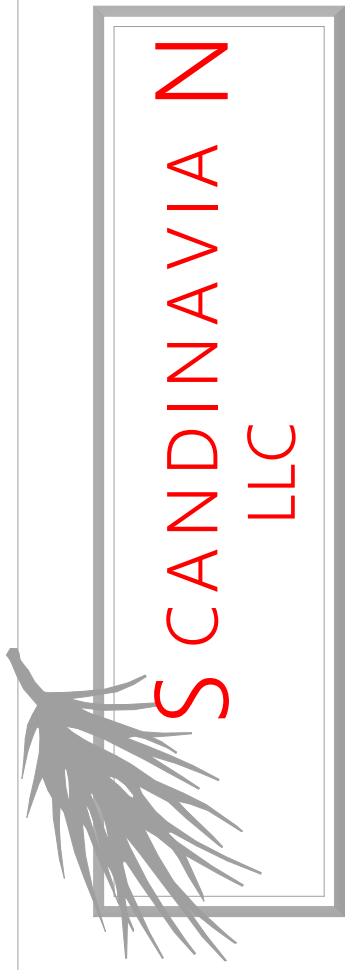
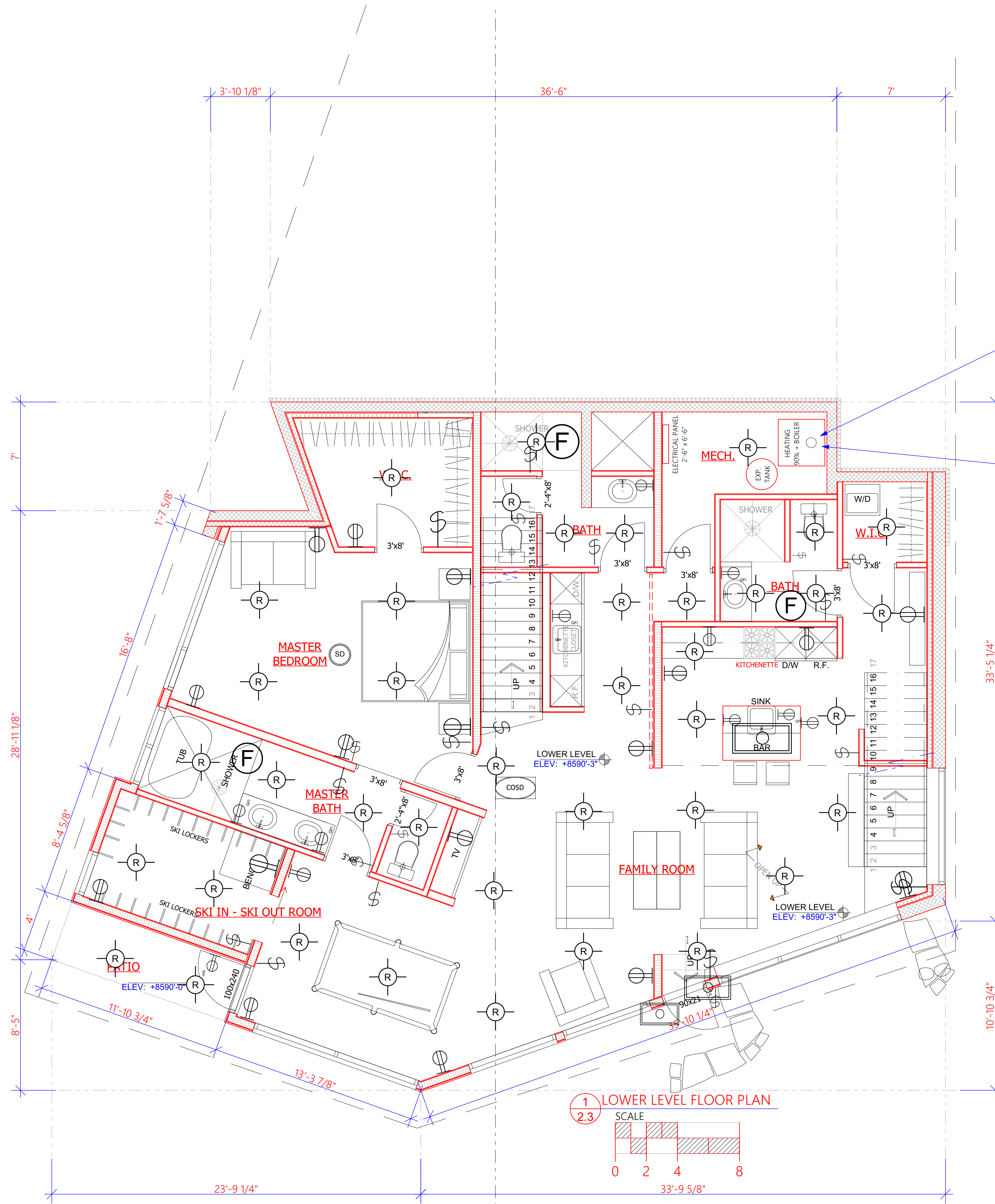

ARCHITECTURAL OFFICE  
 Company Name: Scandinavian LLC  
 Address: 6410 N. Business Park Loop Rd. Unit E  
 Phone: 435-513-0355  
 Fax:  
 Project No.:  
 Drawn:  
 Checked:

A New Residence:  
**BLAKE KINGSBURY**  
 Summit Powder Mountain, Lot # 869  
 85 49 E. Spring Park, Weber County, Utah

BUILDER  
 Company Name:  
 Address:  
 Park City, Utah 84098  
 Phone:  
 Fax:

Drawing Date: 08-05-2019  
 Scale: 1/4" = 1'-0"  
**LOWER LEVEL FLOOR PLAN**  
 BUILDER/DEALER'S APPROVAL:  
 Signature and Date:



© COPYRIGHT 2019  
 THIS DRAWING AND ALL INFORMATION CONTAINED HEREIN IS THE EXCLUSIVE PROPERTY OF SCANDINAVIAN LLC  
 IT MAY NOT BE COPIED OR REPRODUCED IN ANY MANNER WITHOUT THE EXPRESS WRITTEN CONSENT OF SCANDINAVIAN LLC AND MUST BE RETURNED UPON REQUEST.