



Land Use Permit

Weber County Planning Commission

2380 Washington Blvd. STE 240

Ogden, UT 84401

Phone: (801) 399-8791 FAX: (801) 399-8862

webercountyutah.gov/planning

Permit Number: LUP405-2019

Permit Type: Structure

Permit Date: 12/13/2019

Applicant

Name: Ryan Byrne
Business:
Address: 8483 E Spring Park Rd
Eden, UT 84310
Phone: 3233506786

Owner

Name: Same as applicant
Business:
Address: , UT
Phone:

Parcel

Parcel: 231300047

Zoning: DRR-1 **Area:** .3469 **Sq Ft:**

Lot(s): 80

Subdivision: Summit Eden Phase 1C

Address: 8483 E Spring Park Rd Eden, UT 84310

T - R - S - QS: 7N - 2E - 8 - NE

Proposal

Proposed Structure: SFD
Proposed Structure Height: 32
of Dwelling Units: 1
Off Street Parking Reqd: 2

Building Footprint: 3102
Max Structure Height in Zone: 35
of Accessory Bldgs: 0
***Is Structure > 1,000 Sq. Ft?** N/A
***If True Need Certif. Statement**

Permit Checklist

Access Type: Across front lot line
Greater than 4218 ft above sea level? Yes
Additional Setback Reqd. ? No
> 200 ft from paved Road? No
Culinary Water District: PMWSID

Alternative Access File #
Wetlands/Flood Zone? No
Meet Zone Area Frontage? Yes
Hillside Review Reqd? No
Waste Water System: PMWSID

Comments

Outdoor lighting must comply with the Ogden Valley Outdoor Lighting Chapter of the Land Use Code. On the back page of this permit 'BE' means 'building envelope'. The builder must show the location of the building envelope on site for the inspector to verify that the building fits within the building envelope. See attached plat image for building envelope. Development of the lot must follow all recommendations outlined in the geologic hazards and geotechnical reports submitted with this application. A 'natural hazards' notice must be recorded prior to certificate of occupancy for this dwelling.

Land Use Permit

Structure Setback Graphic: New Dwelling, Addition, Etc.

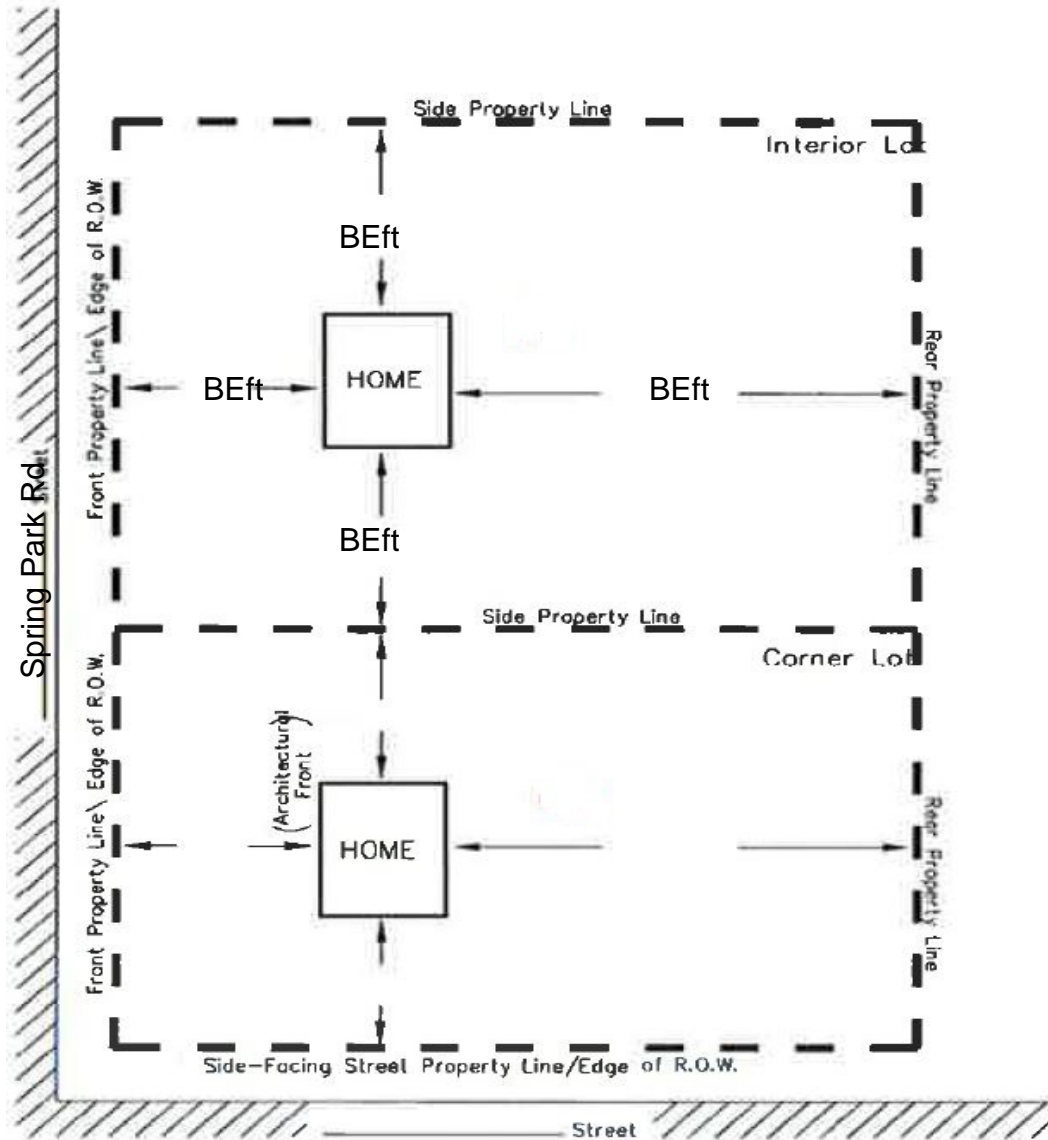

MINIMUM YARD SETBACKS New Dwelling, Addition, Etc.

NOTICE FOR APPLICANT (Please Read Before Signing)

Proposals for the installation of an individual water supply and for a sanitary waste disposal system (septic tank) for any structure designed for human occupation must be approved by Weber County Health Department prior to installation.

Steven Burton

12/13/2019

Planning Dept. Signature of Approval

Date

I hereby certify that I have read and examined this application and know the same to be true and correct. All provisions of laws and ordinances governing this land use will be complied with whether specified herein or not. I make this statement under penalty of perjury.

Contractor/Owner Signature of Approval

Date