

Weber County Stormwater Construction Activity Permit

Application submittals will be accepted by appointment only. (801) 399-8374. 2380 Washington Blvd. Suite 240, Ogden, UT 84401

Date Submitted 11/21/2019	Fees (Office Use) \$150.00	Receipt Number (Office Use)	Priority Site (Office Use) <input type="radio"/> Yes <input type="radio"/> No	Permit Number (Office Use) 2019-219
-------------------------------------	--------------------------------------	-----------------------------	--	---

Property Owner/Authorized Representative Contact Information	Project Information
Name of Property Owner(s)/Authorized Representative(s) Harvest - agriculture & processing	Project Name Harvest
Phone 480 440 5808	Project Address 971 North 9000 West
Fax	
Email Address a.stankiewicz@harvestinc.com	
Mailing Address of Property Owner(s)/Authorized Representative(s) 1155 W Rio Salado Parkway Tempe AZ 85281	Estimated Project Length (mo) 4 months
	Previous Permit No. (if applicable)
	Estimated Start Date 11/25/19
	Actual Start Date

Submittal Checklist

The application shall include a Storm Water Pollution Prevention Plan which meets the criteria set forth in Section 33-3-4 of the county ordinances.

The applicant shall file the application on or before the following dates:

Subdivision: The date that the applicant submits the preliminary subdivision development plat application.

Site Plan: The date that the applicant submits a site plan application or amended site plan.

Building Permit: The date that the applicant submits a building permit application if the applicant proposes to construct a building on an existing lot or parcel.

Land Use Permit: The date that the applicant submits a land use permit application.

Other: At least two (2) weeks before the developer intends to perform any type of work not listed above that would require a Storm Water Construction Activity Permit pursuant to this Chapter.

Failure to acquire a required Storm Water Construction Activity Permit is grounds for tabling a related subdivision application, site plan application, conditional use permit application, or building permit application. It is unlawful to commence work (move dirt) on a development site before obtaining a required Storm Water Construction Activity Permit.

Note: A pre-construction meeting is required before performing any on-site earth work, unless waived by the county engineer.

Applicant Narrative

Please explain your request.

This permit is for site grading including new Asphalt work, includes current SWPPP requirements

Authorization

By signing below the Owner / Representative authorizes the county to enter the property to perform inspections.

Owner or Authorized Representative Signature 	Date 11/22/19
Signature of Approval Tucker Weight	Date 11/22/2019

Harvest Ogden

Storm Water Pollution Prevention Plan Exhibit

OGDEN CITY, WEBER COUNTY, UTAH
SEPTEMBER 2019

Reeve & Associates, Inc. - Solutions You Can Build On

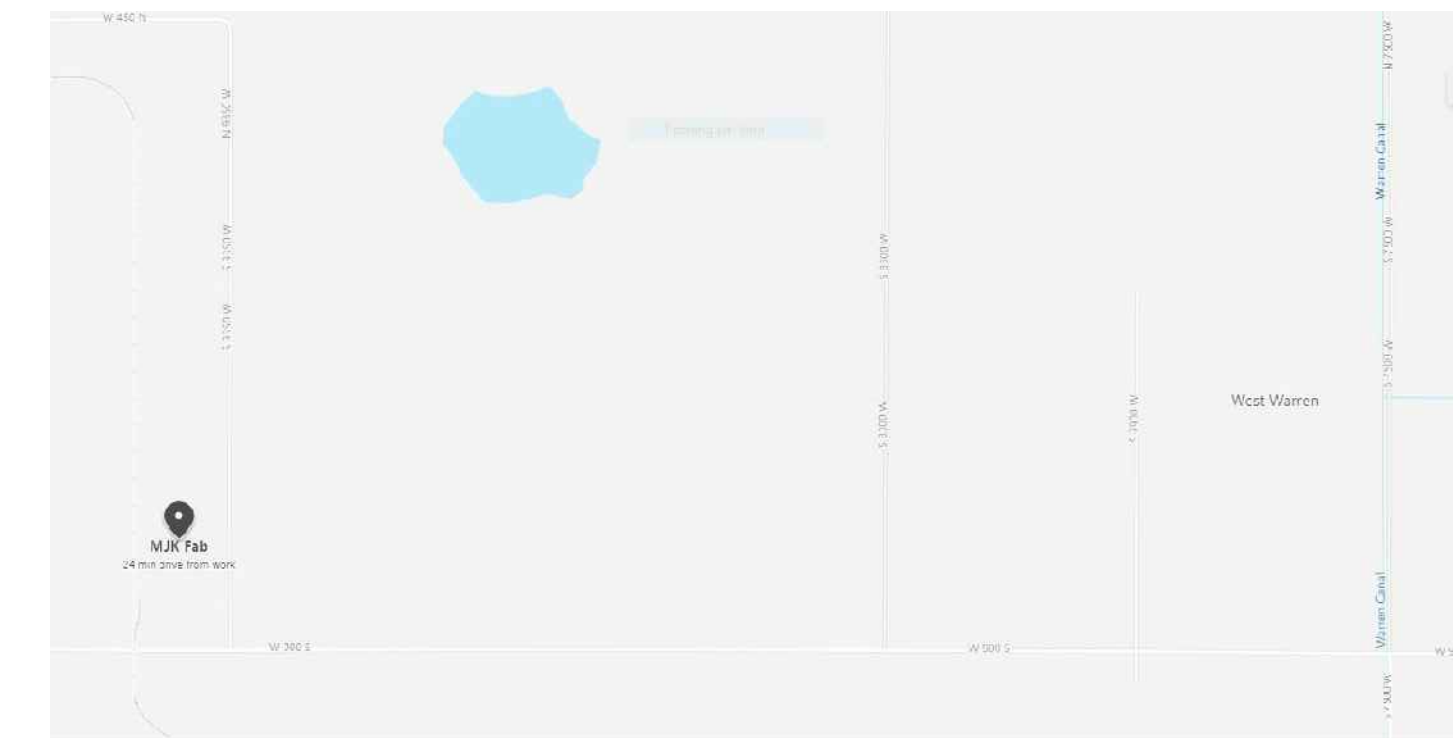
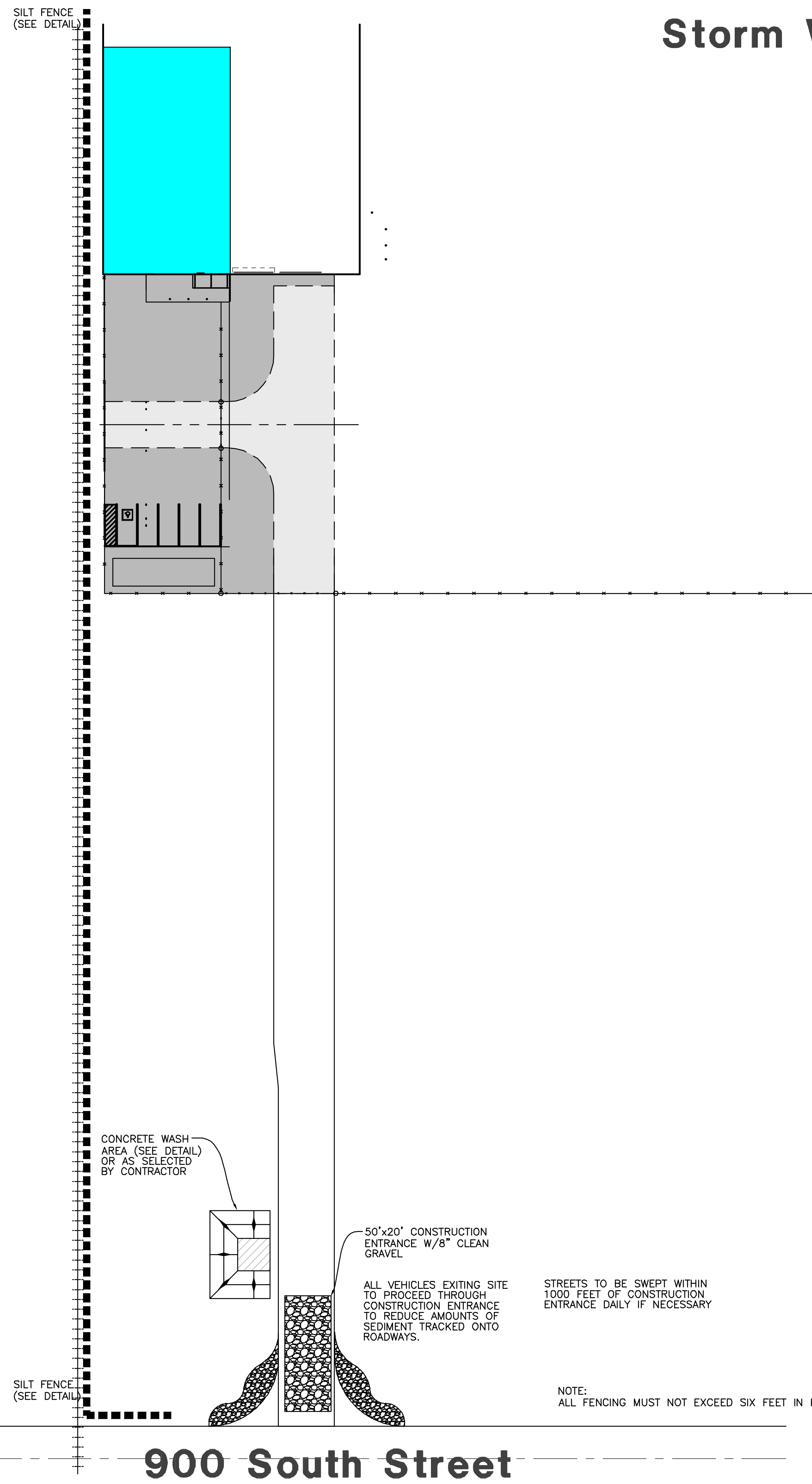

Vicinity Map
NOT TO SCALE

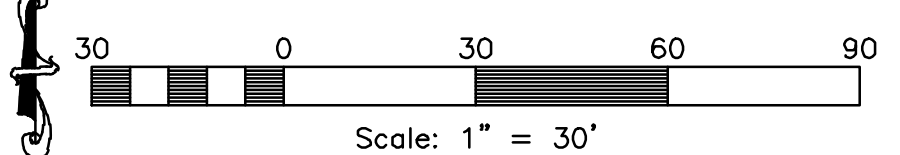

Reeve & Associates, Inc.
5160 SOUTH 1500 WEST RIVERDALE, UTAH 84405
TEL: (801) 821-3100 FAX: (801) 821-2666 WWW.REEVE-ASSOCIATES.COM
LAND PLANNERS • CIVIL ENGINEERS • LAND SURVEYORS
PUBLIC ENGINEERS • STRUCTURAL ENGINEERS • LANDSCAPE ARCHITECTS

REVISIONS	DESCRIPTION
DATE	

Harvest Ogden
OGDEN CITY, WEBER COUNTY, UTAH

Storm Water Pollution Prevention Plan Exhibit

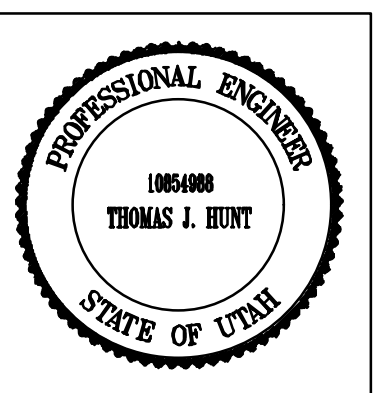

Project Info.

Engineer:	THOMAS J. HUNT, P.E.
Drafter:	C. KINGSLEY
Begin Date:	SEPTEMBER 2019
Name:	OGDEN HARVEST
Number:	7265-01

Construction Activity Schedule

- PROJECT LOCATION.....	OGDEN CITY, WEBER COUNTY, UTAH
- PROJECT BEGINNING DATE.....	SEPTEMBER 2019
- BMP'S DEPLOYMENT DATE.....	SEPTEMBER 2019
- STORM WATER MANAGEMENT CONTACT / INSPECTOR.....	CONTACT NAME (000) 000-0000
- SPECIFIC CONSTRUCTION SCHEDULE INCLUDING BMP CONSTRUCTION SCHEDULE TO BE INCLUDED WITH SWPPP BY OWNER/DEVELOPER	

Sheet	5
4	Sheets

