



WEBER COUNTY SURVEYOR'S OFFICE

2380 Washington Blvd. Rm 370 Ogden,
Utah 84401 (801) 399-8020

Appox. Address:

900 South, 7900 West, Weber County, Ut

Directions: Monument is near the intersection of 900 South and 7900 West

Type: Weber County

Size: 3" Brass in concrete column

Location: Below road surface

Condition: Good

Date: 1963

**History:**

- Marked as Reference in 2018 by Weber County
- Tied in 2015 by DW & JM
- Visited in 2009 by Weber County
- Tied in 1989 by Weber County
- Set Brass Cap 1963 (**Incorrectly identified as PLSS section corner**)

REFERENCE MONUMENT
TO THE NORTH QUARTER
SECTION 22
TOWNSHIP 6 NORTH
RANGE 3 WEST

MON#:6N3W22NRM2
REFERENCE

$\frac{15}{22}$

» THIS REF. MONUMENT WAS INCORRECTLY IDENTIFIED AS THE PLSS CORNER BETWEEN 1963 AND 2018. DURING THAT TIME IT MAY HAVE BEEN RELIED UPON AND USED AS THE PLSS CORNER. SEE COUNTY SURVEYOR REPORT. «

Horizontal Datum: State Plane, Utah North Zone, NAD83 Feet

Northing:

3615526.1

Easting:

1455965.0

Latitude:

N 41° 15' 00.06"

Longitude:

W 112° 10' 14.87"

Correction Source: Collected with GPS on the TURN GPS Network per Weber County and NGS RT1 standards.

Vertical Datum:

Geoid: GEOID 2009

Elevation:

NA

Method: NA

Ortho Height:

4223.2

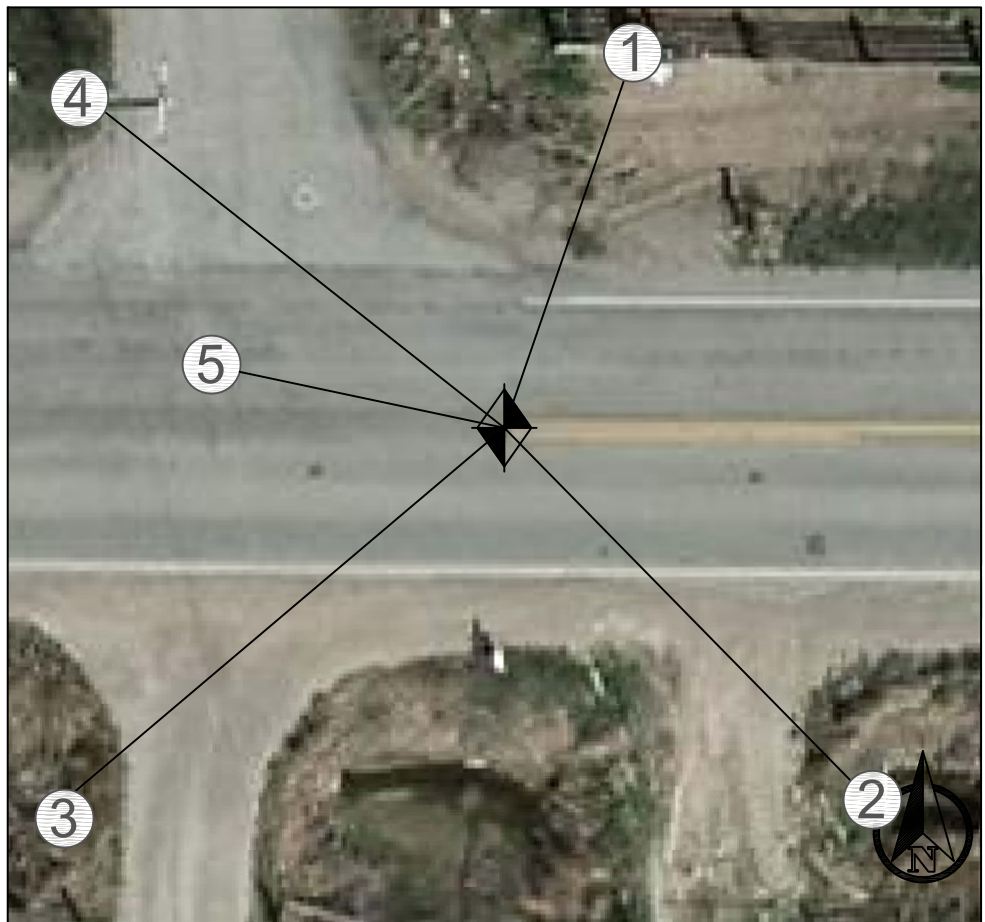
**Reference Ties:**

1. Southwesterly 35.3' from nail & washer in power pole
2. Northwesterly 53.3' from shiner on fence post
3. Northeasterly 58.7' from gate post
4. Southeasterly 48.01' from power pole
5. S78°03'51.93"E 25.667' from North Quarter Corner Section 22