



# Land Use Permit

## Weber County Planning Commission

2380 Washington Blvd. STE 240

Ogden, UT 84401

Phone: (801) 399-8791 FAX: (801) 399-8862

webercountyutah.gov/planning

**Permit Number: LUP272-2019**

Permit Type: Structure

Permit Date: 08/14/2019

### Applicant

**Name:** Karen Archibald  
**Business:**  
**Address:** Ogden, UT 84401  
**Phone:**

### Owner

**Name:** Karen Archibald  
**Business:**  
**Address:** 446 North 3600 west  
Ogden, UT 84401  
**Phone:**

### Parcel

**Parcel:** 152610002

**Zoning:** A-2 **Area:** 3 **Sq Ft:**

**Address:** 446 N 3600 W OGDEN, UT 84404

**Lot(s):** 2

**Subdivision:** McFarland

**T - R - S - QS:** 6N - 2W - 09 - SE

### Proposal

**Proposed Structure:** accessory Structure

**Proposed Structure Height:** 14

**# of Dwelling Units:** 1

**# Off Street Parking Reqd:** 2

**Building Footprint:** 1680

**Max Structure Height in Zone:** 25

**# of Accessory Bldgs:** 2

**\*Is Structure > 1,000 Sq. Ft?** Yes

**\*If True Need Certif. Statement**

### Permit Checklist

**Access Type:** front of property

**Greater than 4218 ft above sea level?** N/A

**Additional Setback Reqd. ?** N/A

**> 200 ft from paved Road?** N/A

**Alternative Access File #**

**Wetlands/Flood Zone?** N/A

**Meet Zone Area Frontage?** N/A

**Hillside Review Reqd?** N/A

**Culinary Water District:** Taylor West Weber wat **Waste Water System:** Septic

### Comments

This is a Land Use Permit for a Large Accessory Building, this building is one hundred (100) feet from the property line, forty (40) feet adjacent to the dwelling on an adjacent lot, and as this is a corner lot must be forty (40) feet on the left side the side facing street and may be ten (10) feet on the right side of property.

**Structure Setback Graphic: Storage Shed, Detached Garage, Etc.**

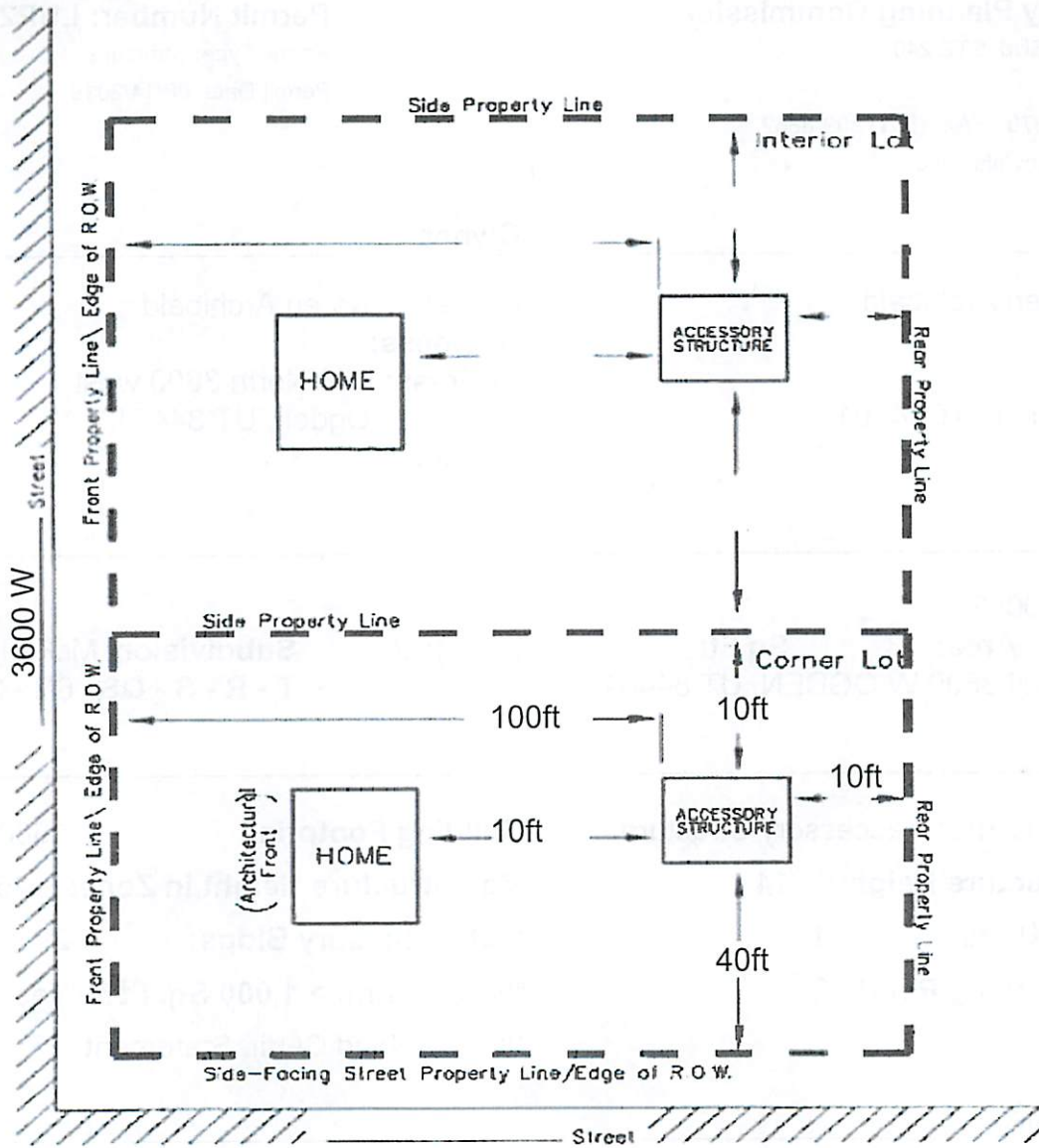

**MINIMUM YARD SETBACKS**  
Storage Shed, Detached Garage, Etc.

**NOTICE FOR APPLICANT (Please Read Before Signing)**

Proposals for the installation of an individual water supply and for a sanitary waste disposal system (septic tank) for any structure designed for human occupation must be approved by Weber County Health Department prior to installation.

*Jessie Herrera*                      08/14/2019  
 Planning Dept. Signature of Approval                      Date

I hereby certify that I have read and examined this application and know the same to be true and correct. All provisions of laws and ordinances governing this land use will be complied with whether specified herein or not. I make this statement under penalty of perjury.

*Karen [Signature]*                      8/14/19  
 Contractor/Owner Signature of Approval                      Date