

~~-4800-~~

4840

4840

3/8

5150
BACK

Omega metals

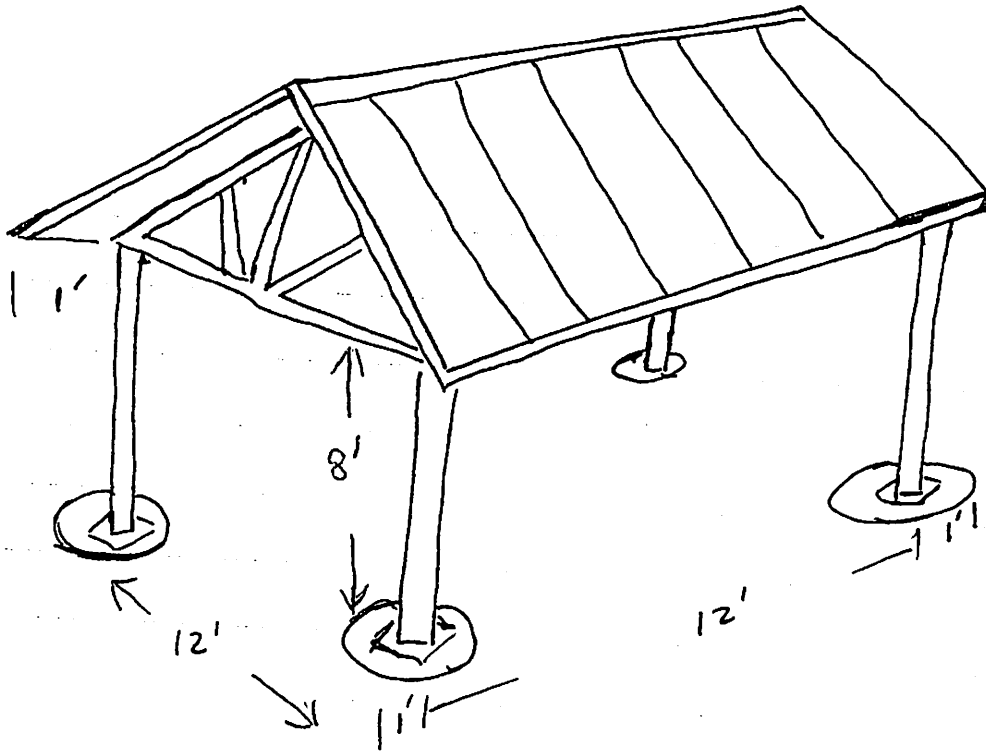

- 4 STEEL POSTS
- 2 12" GLUE LAM BEAMS
- 7 Pre FAB 6/12 TRUSSES
- 10 SHEETS 5/8 PLY
- 28' 2x4 FASCIA BOARD

- 60' DRIP/RAKE METAL
- 15' RIDGE
- 60' CLEAT / FINISH
- 30' Z CLOSURE
- 20 18" x 24 GA. ROOF PANELS WITH CLIPS

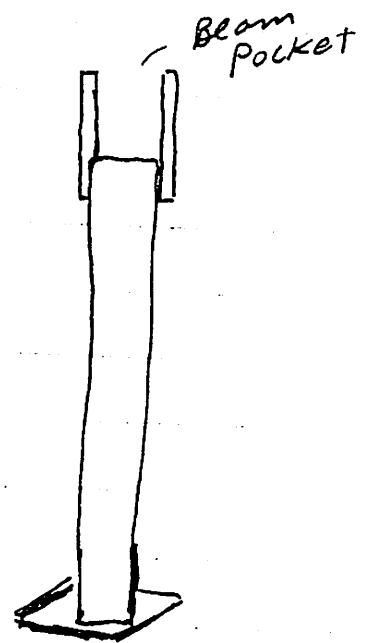

POST DETAIL
4" x 4" x 1/8" WALL TUBE