

PLOT PLAN
LOT 8

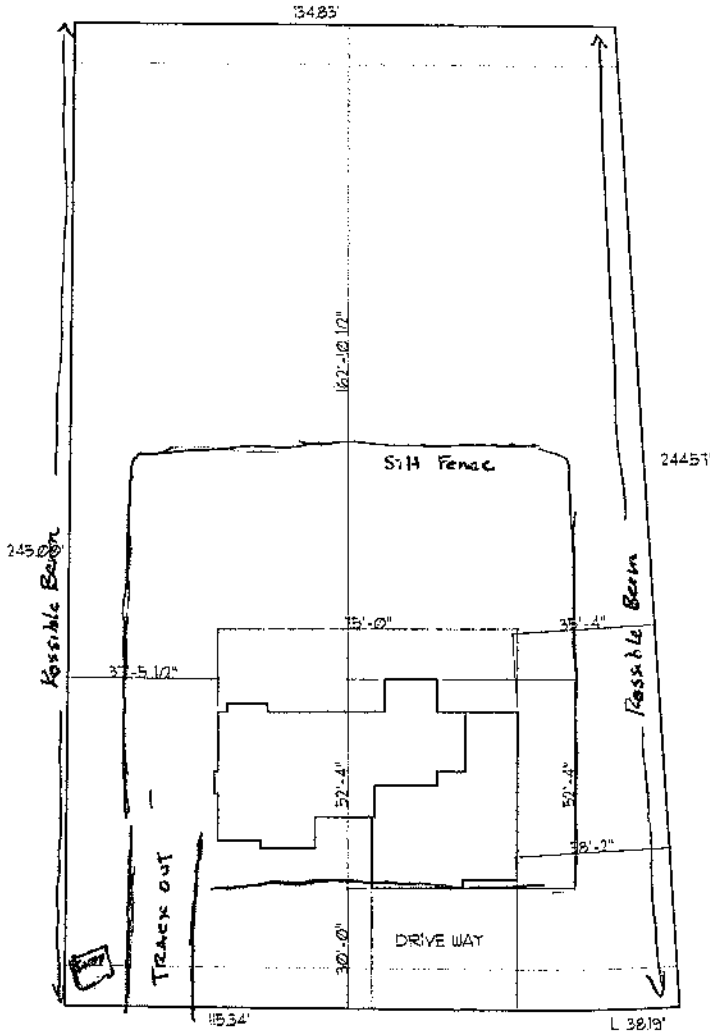

SITE PLAN NOTES:

OWNER/CONTRACTOR SHALL FIELD VERIFY THE LOT DIMENSIONS, SETBACKS, AND ALL EASEMENTS.

DIMENSIONS ON ANGLED LOT LINES ARE SHOWN PERPENDICULAR TO THE HOME.

DRAINAGE - OWNER/CONTRACTOR SHALL PROVIDE 5% SLOPE (6" IN 10'-0") AWAY FROM THE BUILDING TO INSURE PROPER DRAINAGE.

BERMS OR SWALES MAY BE REQUIRED ALONG THE PROPERTY LINES TO PREVENT STORM WATER FROM FLOWING TO ADJACENT PROPERTIES AND OR LOTS.

ALL STORM WATER AND DIRT WILL BE KEPT ON SITE DURING CONSTRUCTION UNTIL FINAL LANDSCAPING IS DONE. OWNER/CONTRACTOR SHALL BE RESPONSIBLE FOR KEEPING DIRT/FIELD ON SITE DURING BAD WEATHER AND FOR CLEANING UP AFTER SUBCONTRACTORS.

STREET, CURB, AND GUTTERS WILL BE INSPECTED AND CLEANED OF MUD AND DIRT EACH DAY PER CITY ORDINANCE.

GRAVEL BAGS TO BE PLACED AND MAINTAINED AROUND ANY STORM DRAIN NLET ADJACENT TO OR IMMEDIATELY DOWNSTREAM FROM SITE DURING CONSTRUCTION.

SURFACE DRAINAGE SHALL BE DIVERTED TO A STORM SEWER CONVEYANCE OR OTHER APPROVED POINT OF COLLECTION SO AS TO NOT CREATE A HAZARD.

LAND DRAIN - IF A LAND DRAIN IS AVAILABLE IN THE SUBDIVISION, THE LAND DRAIN SHALL BE EXTENDED TO AND CONNECTED TO A FOOTING DRAIN SYSTEM.

CURBS AND GUTTER ARE NOT SHOWN FOR CLARITY. PROPERTY LINE GENERALLY STARTS 10'-0" FROM BACK OF CURB. FIELD VERIFY.

OWNER/CONTRACTOR TO FIELD LOCATE AND IDENTIFY POWER, SEWER AND WATER CONNECTION LOCATIONS.

ELEVATIONS INDICATED ON PLANS ARE APPROXIMATED. OWNER/CONTRACTOR SHALL BE REQUIRED TO FIELD VERIFY EXACT ELEVATION.

5225 NORTH STREET

LOT 8 - NORTH FORK MEADOWS

SCALE 1" = 30' 3279 EAST

TYPE B GRADING 5% GRADE 10' AWAY FROM HOUSE

Weber County Stormwater Construction Activity Permit

Application submittals will be accepted by appointment only. (801) 399-8374. 2380 Washington Blvd. Suite 240, Ogden, UT 84401

Date Submitted 6-13-2019	Fees (Office Use) 450.00	Receipt Number (Office Use)	Priority Site (Office Use) <input type="radio"/> Yes <input checked="" type="radio"/> No	Permit Number (Office Use) 2019-62
Property Owner/Authorized Representative Contact Information			Project Information	
Name of Property Owner(s)/Authorized Representative(s) Michael Dove			Project Name Dove - SFD	
Phone 801 668 9399		Fax		
Email Address Dovemb11@gmail.com			Project Address 3229 E 5225 N. Eden, UT 84310	
Mailing Address of Property Owner(s)/Authorized Representative(s) 4855 S. 250.W. Ogden UT 84405			Estimated Project Length (mo) 9 mos.	
			Previous Permit No. (if applicable)	
			Estimated Start Date 6-18-2019	
			Actual Start Date	

Submittal Checklist

The application shall include a Storm Water Pollution Prevention Plan which meets the criteria set forth in Section 33-3-4 of the county ordinances.

The applicant shall file the application on or before the following dates:

Subdivision: The date that the applicant submits the preliminary subdivision development plat application.

Site Plan: The date that the applicant submits a site plan application or amended site plan.

Building Permit: The date that the applicant submits a building permit application if the applicant proposes to construct a building on an existing lot or parcel.

Land Use Permit: The date that the applicant submits a land use permit application.

Other: At least two (2) weeks before the developer intends to perform any type of work not listed above that would require a Storm Water Construction Activity Permit pursuant to this Chapter.

Failure to acquire a required Storm Water Construction Activity Permit is grounds for tabling a related subdivision application, site plan application, conditional use permit application, or building permit application. It is unlawful to commence work (move dirt) on a development site before obtaining a required Storm Water Construction Activity Permit.

Note: A pre-construction meeting is required before performing any on-site earth work, unless waived by the county engineer.

Applicant Narrative

Please explain your request.

Submitting a SWPPP for a residential build in Eden UT

Authorization

By signing below the Owner / Representative authorizes the county to enter the property to perform inspections.

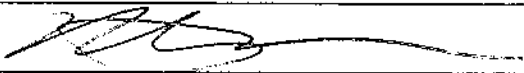
Owner or Authorized Representative Signature 	Date 6-13-2019
Signature of Approval Braden Felix	Date 6/13/2019