

GENERAL IRRIGATION NOTES:

1. THE INTENTION OF THE OWNER AND CONSULTANT IS TO HAVE CONSTRUCTED UNDER THE CONSTRUCTION CONTRACT, A COMPLETE PROJECT READY FOR USE. THE GENERAL LANDSCAPE CONTRACTOR AND HIS SUB-CONTRACTORS SHOULD VIEW THESE DOCUMENTS ACCORDINGLY. ANY APPARENT QUESTION, INCOMPLETE AREA, AREAS OF DISCREPANCY OR CONTRADICTION IN THESE DOCUMENTS IS TO BE BROUGHT TO THE ATTENTION OF THE LANDSCAPE ARCHITECT AND OWNER PRIOR TO BIDDING. BY SUBMITTING A BID ON THIS PROJECT THE BIDDER CERTIFIES THAT HE HAS FULLY INFORMED HIMSELF OF THE REQUIREMENTS OF THE CONSTRUCTION DRAWINGS AS THEY RELATE TO HIS WORK AND HAS READ AND UNDERSTANDS THE NOTES AND SPECIFICATIONS. ALSO, THAT ANY QUESTIONS, INCOMPLETE AREAS, DISCREPANCIES OR CONTRADICTIONS HAVE BEEN BROUGHT TO THE ATTENTION OF THE LANDSCAPE ARCHITECT AND THE OWNER AND THAT THEY ARE ALL RESOLVED.
2. WILLFUL INSTALLATION OF THIS WORK WHEN IT IS OBVIOUS THERE EXISTS JOB/SITE CONDITIONS OR DISCREPANCIES ON PLANS THAT ARE DETRIMENTAL TO THE PROJECT AND THAT SHOULD BE BROUGHT TO THE ATTENTION OF THE OWNER OR THE LANDSCAPE ARCHITECT WILL BE BACK CHARGED TO THE INSTALLER. THE INSTALLER ASSUMES FULL RESPONSIBILITY TO CORRECT THE WORK AT HIS OWN EXPENSE IF HE FAILS TO GIVE THE REQUIRED NOTIFICATION FOR RESOLUTION.
3. THIS PLAN IS DIAGRAMMATIC. SYSTEM COMPONENTS MAY BE SHOWN IN PAVED AREAS, BUILDINGS AND OUTSIDE PROPERTY LINES FOR PLAN CLARITY.
4. IRRIGATION CONTRACTOR SHALL LOCATE ALL EXISTING UTILITIES ON SITE PRIOR TO CONSTRUCTION. COORDINATE WORK W/ GENERAL CONTRACTOR AND OTHER UTILITIES AND PLANTING PLANS TO AVOID CONFLICTING LOCATIONS BETWEEN IRRIGATION PIPING, OTHER UTILITIES AND PLANT PITS. SOME UTILITIES NOT SHOWN FOR PLAN CLARITY.
5. TRENCHING WITHIN THE DRIPLINE OF EXISTING TREES SHALL BE DONE BY HAND.
6. CONNECT DRIP EMITTER ASSEMBLY TO NEAREST LATERAL LINE.
7. AS INSTALLATION OCCURS, CONTRACTOR IS REQUIRED TO PREPARE ACCURATE RECORD DRAWINGS PER THE SPECIFICATIONS. RECORD DRAWINGS TO BE SUBMITTED BEFORE FINAL INSPECTION.
8. SEE DETAILS AND SPECIFICATIONS FOR ADDITIONAL INFORMATION.
9. ALL LINES RUN UNDER SIDEWALKS. PATIO AND PAVED AREAS SHALL BE RUN THROUGH A PVC SLEEVE

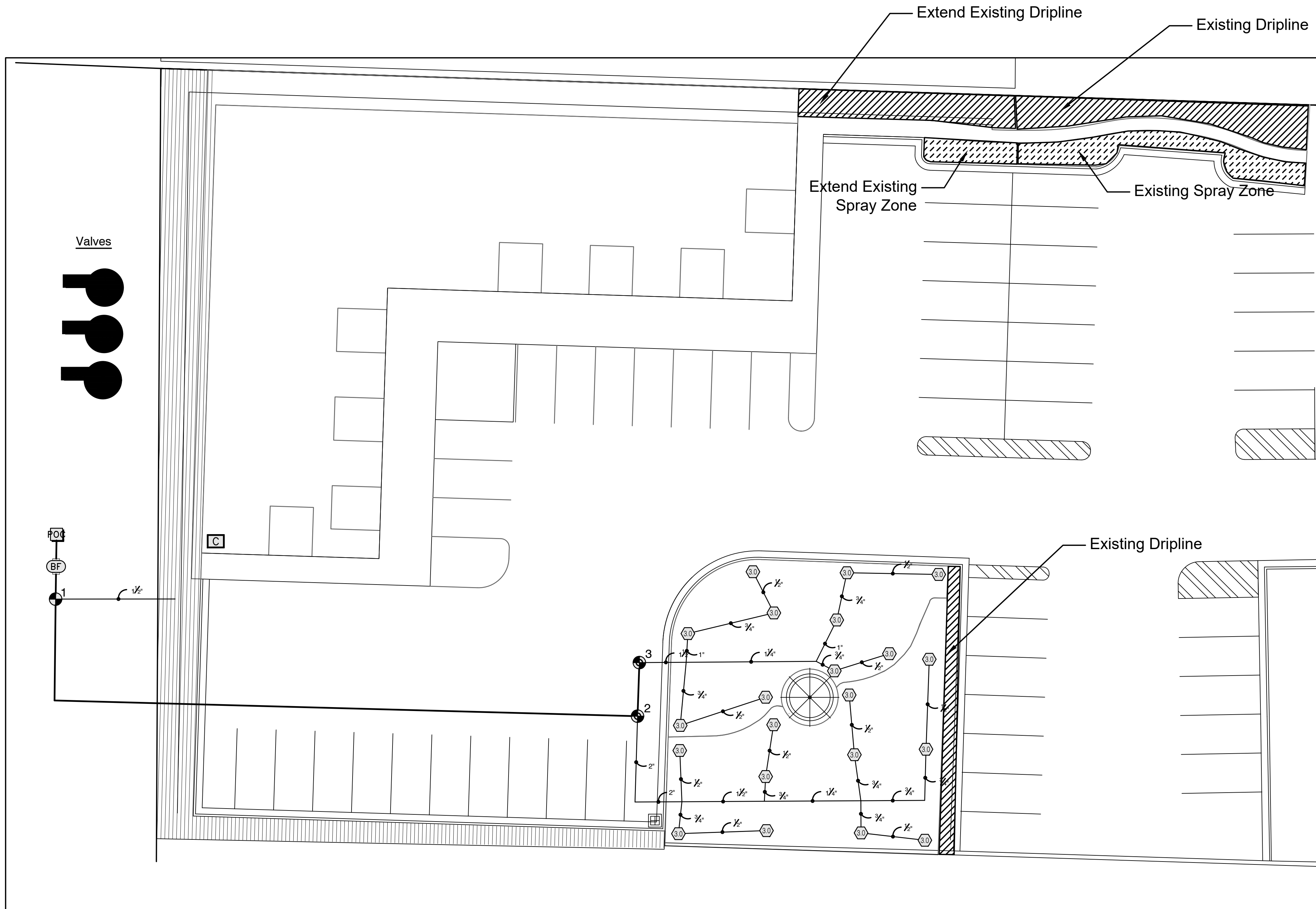

IRRIGATION SCHEDULE

SYMBOL	MANUFACTURER/MODEL/DESCRIPTION	QTY	PSI	GPM	RADIUS
	Rain Bird 3500-S-PC-SAM Shrub Rotor, Fixed Riser, Adjustable and Full Circle. With Seal-A-Matic Check Valve.	21	45	3.00	31'
	Area to Receive Dripline Netafim TLCV-04-12 Techline Pressure Compensating Landscape Dripline with Check Valve. 0.4 GPH emitters at 12" O.C. Dripline laterals spaced at 12" apart, with emitters offset for triangular pattern. 17mm.	4,376 l.f.			
	Rain Bird PEB 1-1/2" 1", 1-1/2", 2" Plastic Industrial Valves. Low Flow Operating Capability, Globe Configuration.	3			
	Watts 800M4QT 1" An anti-siphon pressure vacuum breaker shall be installed where indicated on the plans to prevent the back-siphonage of contaminated water. See specification sheet for more information.	1			
	Rain Bird TBOS2-CM6 and TBOS2-FTUS Battery-Operated Controller available in 4 models: 1, 2, 4, and 6. 6 stations, with TBOS2-FTUS field transmitter.	1			
	Water Meter 1-1/2"	1			
	Irrigation Lateral Line: PVC Schedule 40 1/2"	236.1 l.f.			
	Irrigation Lateral Line: PVC Schedule 40 3/4"	160.7 l.f.			
	Irrigation Lateral Line: PVC Schedule 40 1"	26.4 l.f.			
	Irrigation Lateral Line: PVC Schedule 40 1 1/4"	72.6 l.f.			
	Irrigation Lateral Line: PVC Schedule 40 1 1/2"	79.7 l.f.			
	Irrigation Lateral Line: PVC Schedule 40 2"	42.5 l.f.			
	Irrigation Mainline: PVC Schedule 40 2"	17.2 l.f.			
	Irrigation Mainline: PVC Schedule 40 2 1/2"	240.2 l.f.			

Valve Callout

STAMP

CRITICAL ANALYSIS

Generated: 2018-11-16 15:31

P.O.C. NUMBER: 01
Water Source Information:

FLOW AVAILABLE
Water Meter Size: 1-1/2"
Flow Available: 75.00 gpm

PRESSURE AVAILABLE
Static Pressure at POC: 60.00 psi
Elevation Change: 0.00 ft
Service Line Size: 4"
Length of Service Line: 20.00 ft
Pressure Available: 59.00 psi

DESIGN ANALYSIS
Maximum Station Flow: 33.00 gpm
Flow Available at POC: 75.00 gpm
Residual Flow Available: 42.00 gpm

Pressure Req. at Critical Station: 52.59 psi
Loss for Fittings: 0.09 psi
Loss for Main Line: 0.86 psi
Loss for POC to Valve Elevation: 0.00 psi
Loss for Backflow: 5.10 psi
Loss for Water Meter: 2.28 psi
Critical Station Pressure at POC: 60.92 psi
Pressure Available: 59.00 psi
Residual Pressure Available: -1.92 psi

CONSULTANTS



PROJECT
EDEN BLACKSMITH
EDEN, UT

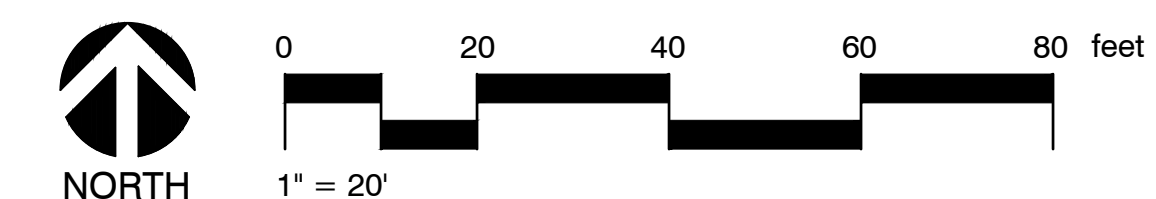

PROJECT NUMBER: 18.043
DATE: November 16, 2018

SHEET:
IR-201
IRRIGATION PLAN