



## Land Use Permit

### Weber County Planning Commission

2380 Washington Blvd. STE 240  
Ogden, UT 84401  
Phone: (801) 399-8791 FAX: (801) 399-8862  
webercountyutah.gov/planning

**Permit Number: LUP230-2018**

Permit Type: Structure  
Permit Date: 08/17/2018

### Applicant

**Name:** Mike Favero  
**Business:**  
**Address:**  
, UT  
**Phone:** 801-710-2488

### Owner

**Name:** Richard & Andrea Favero  
**Business:**  
**Address:** 3122 S 4700 W  
Ogden, UT 84401  
**Phone:** 801-710-2488

### Parcel

**Parcel:** 150840014  
**Zoning:** A-1 **Area:** 13.17 **Sq Ft:**  
**Address:** 3122 S 4700 W Ogden, UT 84404

**Lot(s):** N/A **Subdivision:** N/A  
**T - R - S - QS:** 6N - 2W - 32 - S

### Proposal

**Proposed Structure:** Agricultural Bldg  
**Proposed Structure Height:** 23  
**# of Dwelling Units:**  
**# Off Street Parking Reqd:**

**Building Footprint:** 1500  
**Max Structure Height in Zone:** 25  
**# of Accessory Bldgs:**  
**\*Is Structure > 1,000 Sq. Ft?** N/A  
**\*If True Need Certif. Statement**

### Permit Checklist

**Access Type:** Front lot line  
**Greater than 4218 ft above sea level?** Yes  
**Additional Setback Reqd. ?** No  
**> 200 ft from paved Road?** Yes  
**Culinary Water District:**

**Alternative Access File #**  
**Wetlands/Flood Zone?** No  
**Meet Zone Area Frontage?** Yes  
**Hillside Review Reqd?** No  
**Waste Water System:**

### Comments

The proposed structure is considered ag-exempt, therefore, no engineered plans need to be submitted for building inspection. Permit for building used to store and repair farm equipment. Accessory building. Maximum height allowed in A-1 zone for accessory bldg is 25'.



# Land Use Permit

## Structure Setback Graphic: Barn, Corral, or Stable

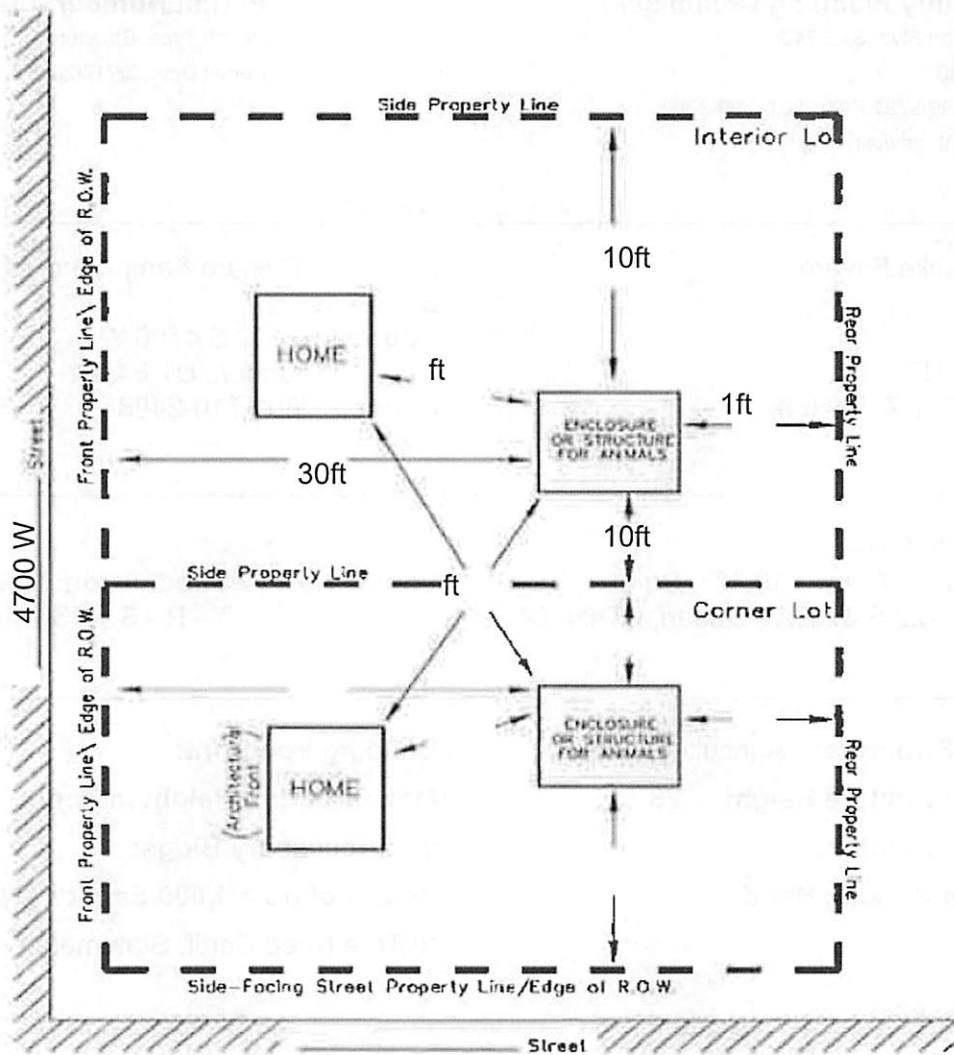

### MINIMUM YARD SETBACKS Barn, Corral, or Stable

#### NOTICE FOR APPLICANT (Please Read Before Signing)

Proposals for the installation of an individual water supply and for a sanitary waste disposal system (septic tank) for any structure designed for human occupation must be approved by Weber County Health Department prior to installation.

Tammy Aydelotte

08/17/2018

Planning Dept. Signature of Approval

Date

I hereby certify that I have read and examined this application and know the same to be true and correct. All provisions of laws and ordinances governing this land use will be complied with whether specified herein or not. I make this statement under penalty of perjury.

Contractor/Owner Signature of Approval

Date