

STORM WATER POLLUTION PREVENTION PLAN

1. AREA OF DISTURBANCE: \approx 4000 S.F.
2. RESPONSIBLE FOR SITE CONDITIONS: FORM POOLS, CHIP GALLOWAY 801-300-2549, ALT. 801-673-0141
EMAIL: info@formpools.com
3. CONSTRUCTION ACTIVITIES: POOL CONSTRUCTION DURING WORKING HOURS. (M-F 8:00 AM - 6:00 PM).
4. EXCAVATED MATERIAL TO BE STOCKPILED FOR BACKFILL AND GRADING. EXCESS MATERIAL WILL BE REMOVED FROM SITE. STOCKPILES TO BE WATERED TO FORM CRUST FOR DUST CONTROL. DUST CONTROLLED OF ANY LOADING OF MATERIAL INTO TRUCKS BY WATERING OR OTHER CONSTRUCTION PRACTICES.
5. CONCRETE WASH OUT TO BE LOCATED NEXT TO EXISTING DRIVE IN EXISTING CLEAR AREA.
6. IF RESTROOM FACILITIES ARE NOT AVAILABLE FOR CONSTRUCTION WORKERS ON SITE PORTA POTTY TO BE PROVIDED AND LOCATED NEXT TO EXISTING DRIVE IN EXISTING CLEAR AREA
7. CONSTRUCTION VEHICLE ENTRANCE WILL BE ON EXISTING DRIVE.
8. ANY TRACK OUT ONTO DRIVE OR STREET WILL BE CLEANED AND CLEARED AT END OF ANY WORK SHIFT.
9. ANY EXISTING SWALES OR DITCHES TO BE PROTECTED WITH STRAW WATTLE OR SILT FENCE.
10. THE EXISTING LOT IS FLAT AND TYPICAL STORM WATER IS RETAINED ON THE LOT. BERM TO BE LOCATED ALONG WEST PROPERTY LINE TO PREVENT STORM WATER FROM ENTERING ADJACENT LOT.
11. THE EXISTING LOT IS A SINGLE FAMILY DWELLING.

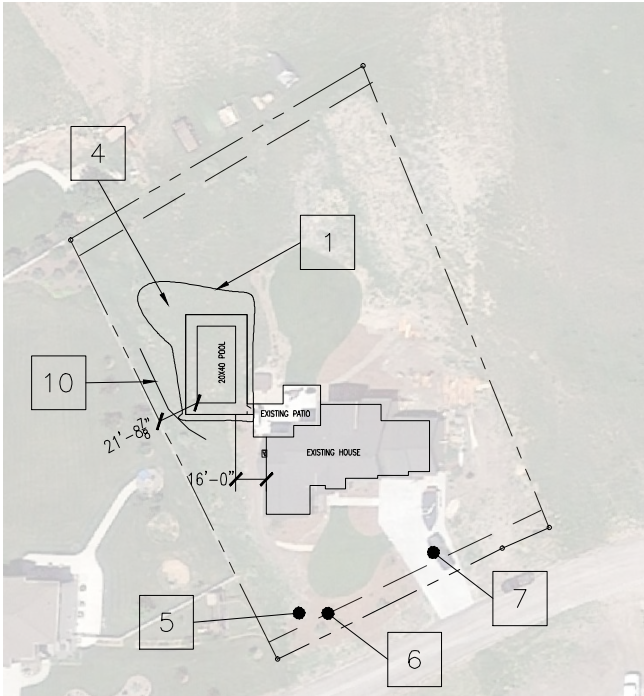

TAVENNER SITE PLAN

1"=64'