

**Common Plan SWPPP for  
Bone Residence  
1505 S. Basinview Rd. Lot 5**

Huntsville, UT 84317

---

Fred Bone

PO Box 1236

Huntsville, Utah 84317

---

Owner/Builder

PO Box 1236

Huntsville, UT 84317

---

Date

07/11/18



1. Project Information

Project: Bone Residence

Address: 1505 S. Basinview Road - Lot 5

City: Huntsville

State: UT

Zip: 84317

Latitude: 41° 41.2402910

Longitude: -111.8193938

UPDES Permit Tracking Number: Click here to enter text. UTRHS7671

Owner: Fred Bone

Contact Person: Fred Bone

Address: PO Box 1236

City: Eden

State: UT

Zip: 84310

Phone number 801-430-0398

Email Address: [niecybone@gmail.com](mailto:niecybone@gmail.com)

Contractor: Owner/ Fred Bone

Contact person: Fred Bone

Address: PO Box 1236

City: Eden

State: UT

Zip: 84310

Telephone number: 801-430-0398

Email: [niecybone@gmail.com](mailto:niecybone@gmail.com)

## 2. Pollution Sources/Best Management Practices

Answer yes or no whether the following features are located at your site. If yes, select the BMP(s) that will be used to protect each feature. If no, continue to the next question. Attach necessary illustrated details for proper installation in Appendix L, and show locations of all controls on Site Map in Appendix B.

- 2.1 Is there a SWPPP sign on site? (see permit part 1.10)

Yes  No

The sign must include the UPDES tracking number, the owner or general contractor name, phone number and email, and if the SWPPP is on-line, instructions on how to view it.

- 2.2 Will there be non-stormwater discharges on the site? (see permit part 1.3) Yes  No

Construction Dewatering (if discharged offsite) must be covered by UPDES Permit UTG070000 (see permit part 2.7). Further, cleaning of tools and equipment must be contained in a plastic lined pit (see permit part 2.4.5 & 2.9).

2.5 Are surface waters located within 30 feet of your project's earth disturbances? Yes  No

Note: A 30' natural vegetative buffer MUST be used if possible. If a buffer less than 30' is used, you must demonstrate that the additional controls offer the same protection as a 30' natural vegetative buffer, and select the reason for exemption below. (see permit part 2.3.5)

- BMP(s):  30' Natural Vegetative Buffer  Less than 1 acre Disturbance  
 2 Silt Fence Barrier  2 Straw Wattle Barriers (Fiber Roll)  
 Less than 30' Natural Vegetative Buffer. Additional Controls: [Click here to enter text.](#)

2.6 Does your site have steep slopes (greater than 70%)? (see permit part 2.3.2) Yes  No

- BMP(s):  Erosion Control Blanket  Minimum Disturbance  Seeding  
 Hydroseed  Mulch  Takifiers  
 Other: [Click here to enter text.](#)

2.7 What perimeter and sediment controls will be used on the site? ~~None~~ (see permit part 2.1.2 & 2.3)

- BMP(s):  Silt Fence  Straw Wattles (Fiber Rolls)  Sediment Trap  
 Sediment Basin  Swales  Berms  
 Vegetative Buffer  Cut-Back-Curb  
 Other: [Click here to enter text.](#)

2.8 What storm drain inlet protection will be used on this site? NONE (see permit part 2.1.3)

Where is/are the nearest downstream inlet(s): HWY 39 No downstream inlet protection will be needed.

- BMP(s):  Rock/Sand-filled Bags  Drop Inlet Bags  Inlet Wattles  
 Filter Fabric  
 Other: [Click here to enter text.](#)

2.9 Will curb ramps be used at the site? Yes No

Note: If curb ramps are used it must be done with material that will not wash away in stormwater. (see permit part 2.4.2)

- BMP(s):  Crushed Rock  Wood Dunnage  
 Other: 15" concrete culvert in the swell by the road

2.10 What dust control BMP(s) will be used? ~~None N/A~~ *No*

BMP(s):  Wetting with Water

Other: Click here to enter text.

2.11 What track out control will be used on the site? (see permit part 2.4.1)

BMP(s):  Track Out Pad 4" gravel  Cobble  Gravel

Rumble Strips  Wash Down Pad  Delivery Pad

Limited Site Access.  Selective Access During Dry Weather

Only access is to be the driveway.

Other: Click here to enter text.

2.12 How will solid waste be dealt with on the site? (see permit part 2.4.3)

BMP(s):  Bag Lightweight Trash  Leak Proof Dumpsters  Receptacles with Lids

Other: Click here to enter text.

2.13 How will non-aqueous liquid waste (oil, solvent, fuel) be dealt with on the site?

BMP(s):  Contained and Removed from the site.  Collected for Reuse

Other: Click here to enter text.

2.14 How will spoils (extra or left over dirt) be contained/managed?

BMP(s):  Cover Erodible Material  Runoff Containment  Haul Off Policy

~~X Other: NA~~

**2.15 How will sanitary waste be handled on the site?** (see permit part 2.4.4)

**BMP(s):**  Portable Toilet(s) *(must be staked down & 10' from curb)*

- Onsite or Adjacent Indoor Bathrooms
- Portable Toilet Secondary Containment
- Other: [Click here to enter text.](#)

**2.16 How will concrete wash water be contained on the site?** (see permit part 2.4.5 & 2.9.1)

**BMP(s):**  Lined Depression  Steel Dumpster

- Regional Washout (per development)
- Other: [Click here to enter text.](#)

**2.17 What controls will be used for construction materials stored on site?**

**BMP(s):**  Covering Erodible or Liquid Materials  Secondary Containment

- Strategic Storage and Staging
- Other: [Click here to enter text.](#)

**2.18 What controls will be in place for equipment fueling, maintenance, and washing?**

**BMP(s):**  Fueling w/Mobile Track w/Spill Kit  Offsite O+M

- Other: Not allowed on site

**2.19 How will sediment be contained on site until home owner completes landscaping?**

**BMP(s):**  Landscaping  Swales  Rock Filters  
 Perimeter Controls  Vegetated Buffer  Native Vegetative Barriers

- Cut-Back-Curb  Leave Front-Yard Lower than Sidewalk
- Other: [Click here to enter text.](#)

*Note that any maintenance required to ensure proper BMP functioning must be done within 72 hours of becoming aware of compromised BMP.*

### 3. Site Map

On a blank page (or include a page from the architectural drawings that show site layout and dimensions), please draw a chart (and place this chart in Appendix B) showing the layout of the site including locations of:

1. boundaries of project/property

2. boundaries of disturbance (including areas outside of property boundaries)
3. show slopes on site
4. location of structures/facilities
5. locations of :
  - a. stockpiles for soils and materials
  - b. construction supplies
  - c. portable toilets
  - d. garbage/trash containers
  - e. egress points/track out pads
  - f. concrete washout pits or containers
6. water bodies, wetlands, natural vegetative buffers
7. placement of all BMPs, perimeter, erosion control, sediment control, inlet, etc.
8. storm water inlets and storm water discharge points (where storm water drains off the site)
9. areas that will be temporarily or permanently stabilized on the site

## 4. Spill Prevention and Response Plan

Describe the spill prevention and control plan to include ways to reduce the chance of spills, stop the source of spills, contain and cleanup spills, dispose of materials contaminated by spills, and train personnel responsible for spill prevention and control. Additionally, fill in all BLUE fields below.

### Spill Plan:

To Reduce the chance of spills taking place vehicle/equipment maintenance and re-fueling will not be allowed on site. In the event of a spill SWPPP plan including contact info for project manager will be posted by the road near construction entrance. Project manager will have a spill kit on his person and can clean up the spill. If the spill is too big PM can contact one of the agencies listed below.

Any discharges in 24 hours equal to or in excess of the reportable quantities listed in 40 CFR 117, 40 CFR 110, and 40 CFR 302 will be reported to the National Response Center and the Division of Water Quality (DWQ) as soon as practical after knowledge of the spill is known to the permittee. The permittee shall submit within 14 calendar days of knowledge of the release a written description of: the release (including the type and estimate of the amount

of material released), the date that such release occurred, the circumstances leading to the release, and measures taken and/or planned to be taken to the Division of Water Quality (DWQ), 288 North 1460 West, P.O. Box 144870, Salt Lake City, Utah 84114-4870. The Storm Water Pollution Prevention Plan must be modified within 14 calendar days of knowledge of the release to provide a description of the release, the circumstances leading to the release, and the date of the release. In addition, the plan must be reviewed to identify measures to prevent the reoccurrence of such releases and to respond to such releases, and the plan must be modified where appropriate.

Agency	Phone Number
National Response Center	(800) 424-8802
Division of Water Quality ( DWQ) 24-Hr Reporting	(801) 538-6146; (801) 536-4123
Utah Department of Health Emergency Response	(801) 580-6681
Huntsville Fire Department	801-782-3580

Minimum spill quantities requiring reporting:

Material	Media Released To	Reportable Quantity
Engine oil, fuel, hydraulic & brake fluid	Land	25 gallons
Paints, solvents, thinners	Land	100 lbs (13 gallons)
Engine oil, fuel, hydraulic & brake fluid	Water	Visible Sheen
Refrigerant	Air	1 lb
Antifreeze, battery acid, gasoline, engine degreasers	Air, Land, Water	100 lbs (13 gallons)

Emphasis to:

- 1<sup>st</sup> Priority: Protect all people (including onsite staff)
- 2<sup>nd</sup> Priority: Protect equipment and property
- 3<sup>rd</sup> Priority: Protect the environment

1. Make sure the spill area is safe to enter and that it does not pose an immediate threat to health or safety of any person.
2. Check for hazards (flammable material, noxious fumes, cause of spill) - if flammable liquid, turn off engines and nearby electrical equipment. If serious hazards are present leave area and call 911. **LARGE SPILLS ARE LIKELY TO PRESENT A HAZARD.**
3. Stop the spill source and contain flowing spills immediately with spill kits, dirt or other material that will achieve containment.
4. Call co-workers and supervisor for assistance and to make them aware of the spill and potential dangers
5. If spilled material has entered a storm sewer, regardless of containment; contact the City Stormwater Division.
6. Cleanup all spills (flowing or non-flowing) immediately following containment. Clean up spilled material according to manufacturer specifications, for liquid spills use absorbent materials **AND DO NOT FLUSH AREA WITH WATER.**
7. Properly dispose of cleaning materials and used absorbent material according to manufacturer specifications.

8. Report the reportable quantity to the Saratoga Springs City Stormwater Division.

**Emergency Numbers**

Utah Hazmat Response Officer 24 hrs	(801)-538-3745
City Police Department	801-778-6600
City Engineering Division	801-399-8374



## 5. SWPPP, Inspections and Corrective Action Reports

**Inspection Schedule and Procedures:** The permit requires inspections once a week (see permit Part 3). You must list and provide details of your BMPs in Appendix L. Inspection reports require reporting on BMPs and how effective they are. You may be required to maintain, modify, remove, or apply/install more or different BMPs to control pollutants on the site. Please number your BMPs in Appendix L and refer to those numbers on your inspection reports and corrective action reports when you inspect or report on them.

Describe the general procedures for correcting problems when they are identified. Include responsible staff and time frames for making corrections:

Fred Bone shall conduct inspections of SWPPP. When problems are identified, he shall arrange for repairs to be made within a reasonable time. He shall make notes in the SWPPP inspections report found in this document.

**Corrective Actions:** All corrective actions must be logged using the “Correction Action Log” attached in Appendix F. The log should be filled out completely for each corrective action.

## 6. Changes to the SWPPP

All changes to this SWPPP must be logged in the “Amendment Log” in Appendix G. The log should be filled out completely for each amendment to the SWPPP.

## 7. Record Keeping

The following items should be kept at the project site available for inspectors to review:

1. Dates of grading, construction activity, and stabilization
2. A copy of the construction general permit (Appendix C)
3. The signed and certified NOI form (Appendix D)
4. Inspection reports (Appendix E)

## 8. Delegation of Authority (if any)

Duly Authorized Representatives or Positions:

Company/ Organization: N/A

Name N/A  
:

Position N/A  
:

Address N/A  
:

City N/A State: State Zip: Zip Code  
:

Telephone (XXX) XXX-XXXX Fax/ (XXX) XXX-XXXX  
: Email:

**Note:** Any additional information (i.e. memoranda, agreements, etc.) should be attached in Appendix H.

## 9. Discharge Information

Does your project/site discharge storm water into a Municipal Separate Storm Sewer System (MS4)?

Yes       No

MS4 receiving the discharge from the construction project: Unincorporated Weber County

**Receiving Waters** (look up <http://wq.deq.utah.gov> to identify your receiving water body)

Enter the name(s) of the first surface water(s) that receives stormwater directly from your site and/or from the MS4 listed above. **Note:** multiple rows provided in the case that your site has more than one point of discharge in which each flows to different surface waters.

1. Pineview reservoir
2. Click here to enter name of receiving waters.
3. Click here to enter name of receiving waters.
4. Click here to enter name of receiving waters.

**Impaired Waters** (refer to <http://wq.deq.utah.gov> in the left hand column to determine status of receiving water body).

Select any impaired surface water(s) that your site will discharge to, either directly or through the MS4 selected above.

Impaired Surface Water	Is this surface water impaired?	Pollutant(s) causing the impairment	Has a TMDL been completed?	Pollutant(s) for which there is a TMDL
Pineview Reservoir	X Yes <input type="checkbox"/> No	Dissolved oxygen, phosphorus	X Yes <input type="checkbox"/> No	Temperature, Algae, Phosphorus
Click here to enter text.	<input type="checkbox"/> Yes <input type="checkbox"/> No	Click here to enter text.	<input type="checkbox"/> Yes <input type="checkbox"/> No	Click here to enter text.

## 10. Certification and Notification

I, Fred Bone, certify under penalty of law that this document and all attachments were prepared under my direction or supervision in accordance with a system designed to assure that qualified personnel properly gathered and evaluated the information submitted. Based on my inquiry of the person or persons who manage the system, or those persons directly responsible for gathering the information, the information submitted is, to the best of my knowledge and belief true, accurate, and complete. I am aware that there are significant penalties for submitting false information, including the possibility of fine and imprisonment for knowing violations.

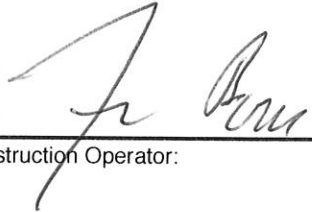
X   
\_\_\_\_\_  
Construction Operator:

This SWPPP should be signed and certified by the construction operator(s). Attach certifications in Appendix H.

---

## **SWPPP Appendices**

Ensure the following documentation is attached to the SWPPP:

**Appendix A: General Location Map**

**Appendix B: SWPPP Site Maps**

**Appendix C: Construction General Permit Regulation**

**Appendix D: Acknowledgement Letter from Weber County**

**Appendix E: Inspection Reports**

**Appendix F: Corrective Action Log**

**Appendix G: SWPPP Amendment Log**

**Appendix H: Grading and stabilization Activities Log**

**Appendix I: Construction Plans**

**Appendix J: BMP Specifications and Details (label BMPs to match the sections identified in this document.)**

# APPENDIX A: Site Map

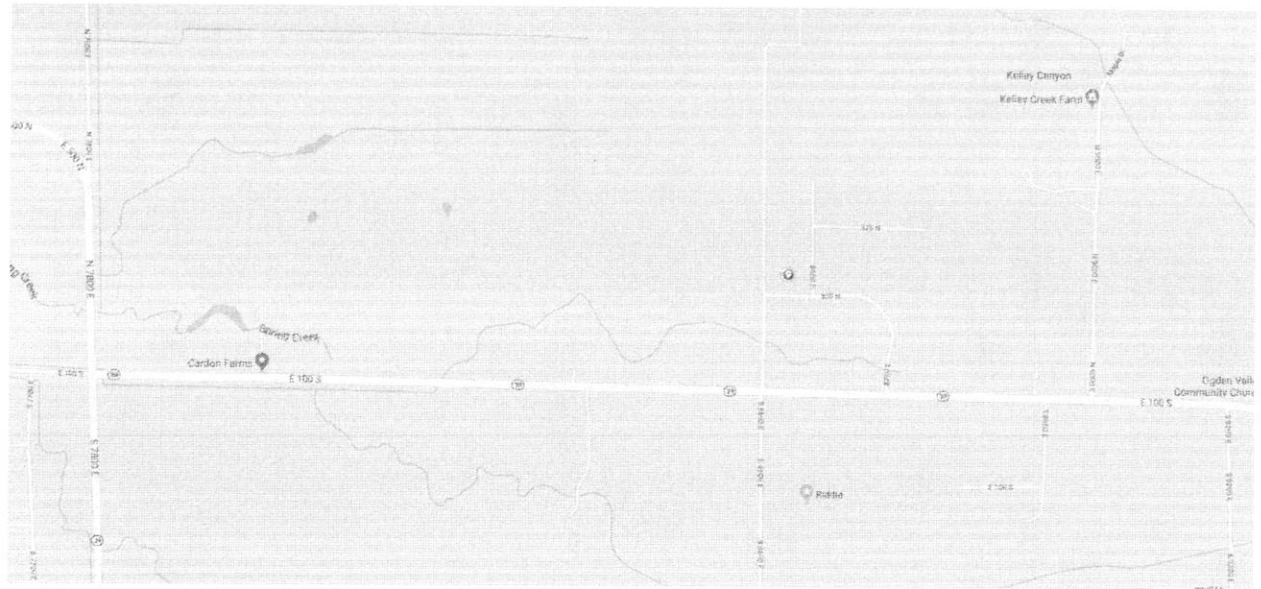

---

APPENDIX B: SWPPP Site Maps

No site map

---

APPENDIX C: Construction General Permit Regulation

No CGP

---

**APPENDIX D: Acknowledgement Letter from Unincorporated Weber County**



---

NOI Paid to state attached to this document

No NOI a Haduc.  
we do have NOI #.

## Credit Card Payment Receipt

---

Your payment was successfully processed.

Please print this page as a receipt for your records.

Item	Quantity	Item Amount	Total
Common Plan Permit <i>Fred Bone</i>	1	\$150.00	\$150.00
<b>Total Amount:</b>			<b>\$150.00</b>

## Payment Processing Details

---

**Order Number:** UTRH87671  
**Date of Transaction:** 07/12/2018  
**Amount Charged:** \$150.00  
**Name on Card:** Denise C. Bone  
**Credit Card Number:** \*\*\*\*\*0491  
**Credit Card Type:** Visa

# APPENDIX E: Inspection Reports

## STORMWATER CONSTRUCTION SITE INSPECTION REPORT

**GENERAL INFORMATION**

Project Name: \_\_\_\_\_

Location: \_\_\_\_\_

Date of Inspection: \_\_\_\_\_ Start/End Time: \_\_\_\_\_

Inspector's Name: \_\_\_\_\_

Inspector's Title: \_\_\_\_\_

Inspector's Contact Information: \_\_\_\_\_

Describe present phase of construction: \_\_\_\_\_

Type of Inspection:  
 Regular     Pre-storm event     During storm event     Post-storm event

**WEATHER INFORMATION**

Has there been a storm event since the last inspection?  Yes  No

If yes, provide:  
 Storm Start Date & Time: \_\_\_\_\_ Storm Duration (hrs): \_\_\_\_\_ Approximate Amount of Precipitation (in): \_\_\_\_\_

Weather at time of this inspection?  
 Clear     Cloudy     Rain     Sleet     Fog     Snowing     High Winds  
 Other: \_\_\_\_\_ Temperature: \_\_\_\_\_

Have any discharges occurred since the last inspection?  Yes  No

If yes, describe: \_\_\_\_\_

Are there any discharges at the time of inspection?  Yes  No

If yes, describe: \_\_\_\_\_

**CERTIFICATION STATEMENT**

"I certify under penalty of law that this document and all attachments were prepared under my direction or supervision in accordance with a system designed to assure that qualified personnel properly gathered and evaluated the information submitted. Based on my inquiry of the person or persons who manage the system, or those persons directly responsible for gathering the information, the information submitted is, to the best of my knowledge and belief, true, accurate, and complete. I am aware that there are significant penalties for submitting false information, including the possibility of fine and imprisonment for knowing violations."

Signature of Inspector: \_\_\_\_\_ Printed Name and Title: \_\_\_\_\_ Date: \_\_\_\_\_

**OVERALL SITE ISSUES**

*Below are some general site issues that should be assessed during inspections. Customize this list as needed for conditions at your site.*

BMP/activity	Implemented?	Maintenance Required?	Corrective Action Needed and Notes
1. All inactive slopes and disturbed areas have been stabilized.	<input type="checkbox"/> Yes <input type="checkbox"/> No	<input type="checkbox"/> Yes <input type="checkbox"/> No	
2. Are natural resource areas (e.g., streams, wetlands, mature trees, etc.) protected with barriers or similar BMPs?	<input type="checkbox"/> Yes <input type="checkbox"/> No	<input type="checkbox"/> Yes <input type="checkbox"/> No	
3. Are all sanitary waste receptacles placed in secondary containment and free of leaks?	<input type="checkbox"/> Yes <input type="checkbox"/> No	<input type="checkbox"/> Yes <input type="checkbox"/> No	
4. Are perimeter controls and sediment barriers adequately installed (keyed into substrate) and maintained?	<input type="checkbox"/> Yes <input type="checkbox"/> No	<input type="checkbox"/> Yes <input type="checkbox"/> No	
5. Are discharge points and receiving waters free of any sediment deposits?	<input type="checkbox"/> Yes <input type="checkbox"/> No	<input type="checkbox"/> Yes <input type="checkbox"/> No	
6. Are storm drain inlets properly protected?	<input type="checkbox"/> Yes <input type="checkbox"/> No	<input type="checkbox"/> Yes <input type="checkbox"/> No	
7. In the construction exit preventing sediment from being tracked into the street?	<input type="checkbox"/> Yes <input type="checkbox"/> No	<input type="checkbox"/> Yes <input type="checkbox"/> No	
8. Is trash/litter from work areas collected and placed in covered dumpsters?	<input type="checkbox"/> Yes <input type="checkbox"/> No	<input type="checkbox"/> Yes <input type="checkbox"/> No	
9. Are washout facilities (e.g., paint, stucco, concrete) available, clearly marked, and maintained?	<input type="checkbox"/> Yes <input type="checkbox"/> No	<input type="checkbox"/> Yes <input type="checkbox"/> No	
10. Are vehicle and equipment fueling, cleaning, and maintenance areas free of spills, leaks, or any other deleterious material?	<input type="checkbox"/> Yes <input type="checkbox"/> No	<input type="checkbox"/> Yes <input type="checkbox"/> No	
11. Are materials that are potential stormwater contaminants stored inside or under cover?	<input type="checkbox"/> Yes <input type="checkbox"/> No	<input type="checkbox"/> Yes <input type="checkbox"/> No	
12. Are non-stormwater discharges (e.g., wash water, dewatering) properly controlled?	<input type="checkbox"/> Yes <input type="checkbox"/> No	<input type="checkbox"/> Yes <input type="checkbox"/> No	
13. (Other)	<input type="checkbox"/> Yes <input type="checkbox"/> No	<input type="checkbox"/> Yes <input type="checkbox"/> No	

---



