

CALCULATION SUMMARY

AREA NAME	GRID / TYPE	SPEC	GROUP	AVE	MAX	MIN	MAX/AVE	MIN/AVE
PARKING	0-30' / H-H	1000	<>	5.6	51.0	0.0	N/A	N/A

MASTER LUMINAIRE SCHEDULE

TYPE	MANUFACTURER	CATALOG NUMBER	NO.ITS	MOUNTING	LAMPS	BALLAST (WATTS)	MAKE
REPERT. LOW PROFILE, FULL CUTOFF WALL PACK, LED, BLACK, 4K, 7700 LUMENS	LITHONIA	DSWV LED 200 1000 40K TLM WOLC DDBX0	120	WALL	INCLUDED	82	
REPT. CANOPY MOUNTED, CUTOFF LUMINAIRE, 149W LED, FLAT LENS, FOR SINGLE DECK CANOPIES (17200 LUMENS)	ISI	D444-80-40K-UV-13-5C9A	BY ARCHITECT				
REPT. 4FT LED STRIP LUMINAIRE, COOL WHITE (37), 3000 LUMENS, DAMP LISTED, LENS (1.25" WDP), 4K	ISI	CRU SC LED HO NW UE WH	UNV	CANOPY	INCLUDED	149	
REPT. 4FT LED STRIP LUMINAIRE, COOL WHITE (37), 3000 LUMENS, DAMP LISTED, LENS (1.25" WDP), 4K	ISI	MS4 LED HO NW UE	UNV	EXTENSION CODE	INCLUDED	40	
REPT. LOW PROFILE, FULL CUTOFF WALL PACK, LED, BLACK, 4K, 11120 LUMENS	LITHONIA	DSWV LED 300 1000 40K TLM WOLC DDBX0	120	WALL	INCLUDED	109	
REPT. POLE MOUNTED, CUTOFF LUMINAIRE SINGLE HEAD, LED, 16000 LUMENS, 28FT SQUARE POLE (4" T1 0A), 4K	LITHONIA	DSV1 LED 600 700 40K TLM WOLC SPA DDBX0/SS	208	25'-0" POLE	INCLUDED	131	
REPT. XCOM 3 LED, SS 40 UE, BLK, 45983 SFG, 24S	ISI	ARC-ED-3M-D4E-10-E-UL-S8A-S25MA-40K/RR90-25-4-11-5-GREENISH	BY ARCHITECT				
REPT. SAME AS T-14 EXCEPT WITH THE IV DISTRIBUTION (FORWARD THROU)	ISI	ARC-ED-3M-D4E-10-E-UL-S8A-S25MA-40K/RR90-25-4-11-5-GREENISH	BY ARCHITECT				
REPT. CRU SC LED HO NW UE WH	ISI	CRU SC LED HO NW UE WH	UNV	CANOPY	INCLUDED	149	
REPT. MS4 LED HO NW UE	ISI	MS4 LED HO NW UE	UNV	EXTENSION CODE	INCLUDED	40	

LUMINAIRES ARE PROVIDED BY OWNER, INSTALLED BY E.C. (REFERENCE SCHEDULE ON E-140)

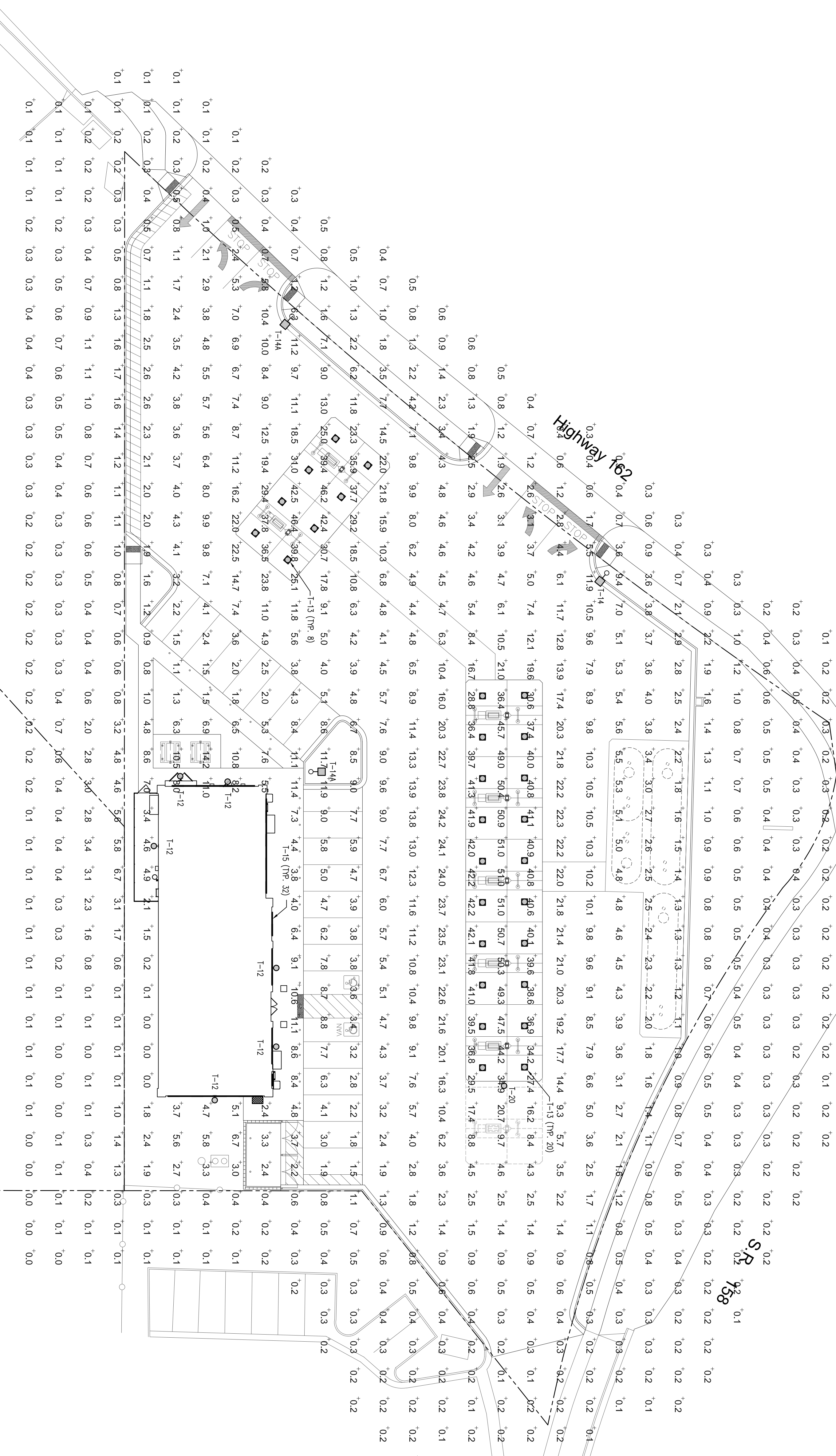

1 SITE PHOTOMETRIC PLAN

SCALE: 1"=20'-0"

1351 EAST CENTER STREET, NORTH SALT LAKE, UTAH 84004

PHONE: (801) 938-1343

G:\Maverik\Eden, UT - 18313\Elec\EDEN MODULAR E-1.2.dwg April 27 2018 12:14pm By: jll

SHEET TITLE  
PHOTOMETRIC PLAN

MAVERIK, INC.  
STORE #250  
5100 EAST & 2500 NORTH  
EDEN, UT



PROJECT NUMBER  
18313  
ISSUE DATE:  
April 25, 2018  
REVISIONS:  
No. Date Description

Nielson Engineering, Inc.  
Consulting Engineers  
156 North Twelfth Avenue  
Pocahontas, Idaho 83201  
Ph (208) 232-2377  
FAX (208) 234-0918

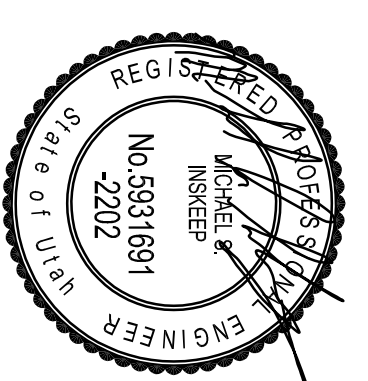

E1.2

OWNERSHIP OF DOCUMENTS  
This document, including the ideas and designs incorporated herein, is the property of Nielson Engineering, Inc. and shall not be used, in whole or in part, for any other project without the written permission of an authorized representative of Nielson Engineering, Inc. Unclassified use will be prosecuted to the fullest extent of the law.  
Copyright © 2018  
By: NIELSON ENGINEERING, INC.

