



Land Use Permit

Weber County Planning Commission

2380 Washington Blvd. STE 240
Ogden, UT 84401
Phone: (801) 399-8791 FAX: (801) 399-8862
webercountyutah.gov/planning

Permit Number: LUP164-2018

Permit Type: Structure
Permit Date: 06/28/2018

Applicant

Name: Tim Deltaan
Business:
Address:
, UT
Phone: 801-687-6196

Owner

Name: Tim Deltaan
Business:
Address:
, UT
Phone: 801-687-6196

Parcel 23-013-0010

Parcel: 23-013-0010
Zoning: Area: Sq Ft:
Address: ~~HT~~ 3465 N HWY 39
Huntsville UT 84317

Lot(s): 147 **Subdivision:** Sourdough Wilderness R:
T - R - S - QS: 7N - 3E - 18 - SE

Proposal

Proposed Structure: Shed
Proposed Structure Height:
of Dwelling Units:
Off Street Parking Reqd:

Building Footprint: 100
Max Structure Height in Zone:
of Accessory Bldgs:
***Is Structure > 1,000 Sq. Ft?** N/A
***If True Need Certif. Statement**

Permit Checklist

Access Type:
Greater than 4218 ft above sea level? N/A
Additional Setback Reqd. ? N/A
> 200 ft from paved Road? N/A
Culinary Water District:

Alternative Access File #
Wetlands/Flood Zone? N/A
Meet Zone Area Frontage? N/A
Hillside Review Reqd? N/A
Waste Water System:

Comments

100 sq. ft. shed



Land Use Permit

Structure Setback Graphic: Storage Shed, Detached Garage, Etc.

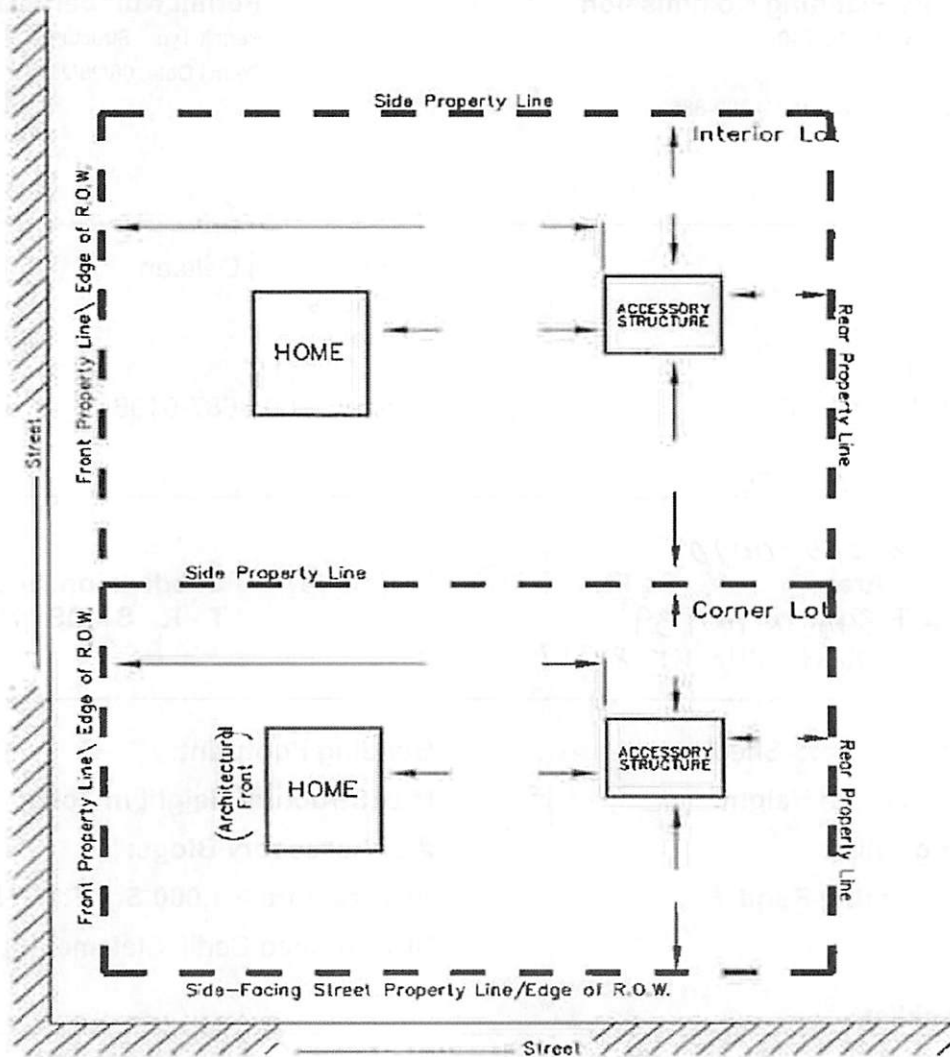

MINIMUM YARD SETBACKS Storage Shed, Detached Garage, Etc.

NOTICE FOR APPLICANT (Please Read Before Signing)

Proposals for the installation of an individual water supply and for a sanitary waste disposal system (septic tank) for any structure designed for human occupation must be approved by Weber County Health Department prior to installation.

Tammy Aydelotte

06/28/2018

Planning Dept. Signature of Approval

Date

I hereby certify that I have read and examined this application and know the same to be true and correct. All provisions of laws and ordinances governing this land use will be complied with whether specified herein or not. I make this statement under penalty of perjury.

[Handwritten Signature]

6/28/18

Contractor/Owner Signature of Approval

Date