



# Land Use Permit

## Weber County Planning Commission

2380 Washington Blvd. STE 240

Ogden, UT 84401

Phone: (801) 399-8791 FAX: (801) 399-8862

webercountyutah.gov/planning

**Permit Number: LUP96-2018**

Permit Type: Structure

Permit Date: 05/01/2018

### Applicant

**Name:** Weston Loegering

**Business:**

**Address:** PO Box 1195  
Eden, UT 84310

**Phone:** 801-214-9227

### Owner

**Name:** Weston Loegering

**Business:**

**Address:** 1958 N 3850  
Eden, UT 84310

**Phone:** 801-214-9227

### Parcel

**Parcel:** 200090001

**Zoning:** S-1 **Area:** 18.46 **Sq Ft:**

**Address:** 1958 N. 3850 E Eden, UT 84310

\*If Zoned S-1, See Specific Height Requirements

**Lot(s):** 1

**Subdivision:** LOEGERING SUBD  
T - R - S - QS: 6N - 1E - 12 - NW

### Proposal

**Proposed Structure:** Agriculture

**Proposed Structure Height:** 35

**# of Dwelling Units:** 1

**# Off Street Parking Reqd:** 2

**Building Footprint:** 1152

**Max Structure Height in Zone:** 35

**# of Accessory Bldgs:** 2

**\*Is Structure > 1,000 Sq. Ft?** No

\*If True Need Certif. Statement

### Permit Checklist

**Access Type:** Across front lot line

**Greater than 4218 ft above sea level?** Yes

**Additional Setback Reqd. ?** No

**> 200 ft from paved Road?** Yes

**Culinary Water District:** N/A

**Alternative Access File #**

**Wetlands/Flood Zone?** No

**Meet Zone Area Frontage?** Yes

**Hillside Review Reqd?** No

**Waste Water System:** N/A

### Comments

All exterior lighting must adhere to Ogden Valley Outdoor Lighting LUC 108-16-6. The exterior lighting will be inspected prior to final occupancy to ensure compliance.



# Land Use Permit

## Structure Setback Graphic: Storage Shed, Detached Garage, Etc.

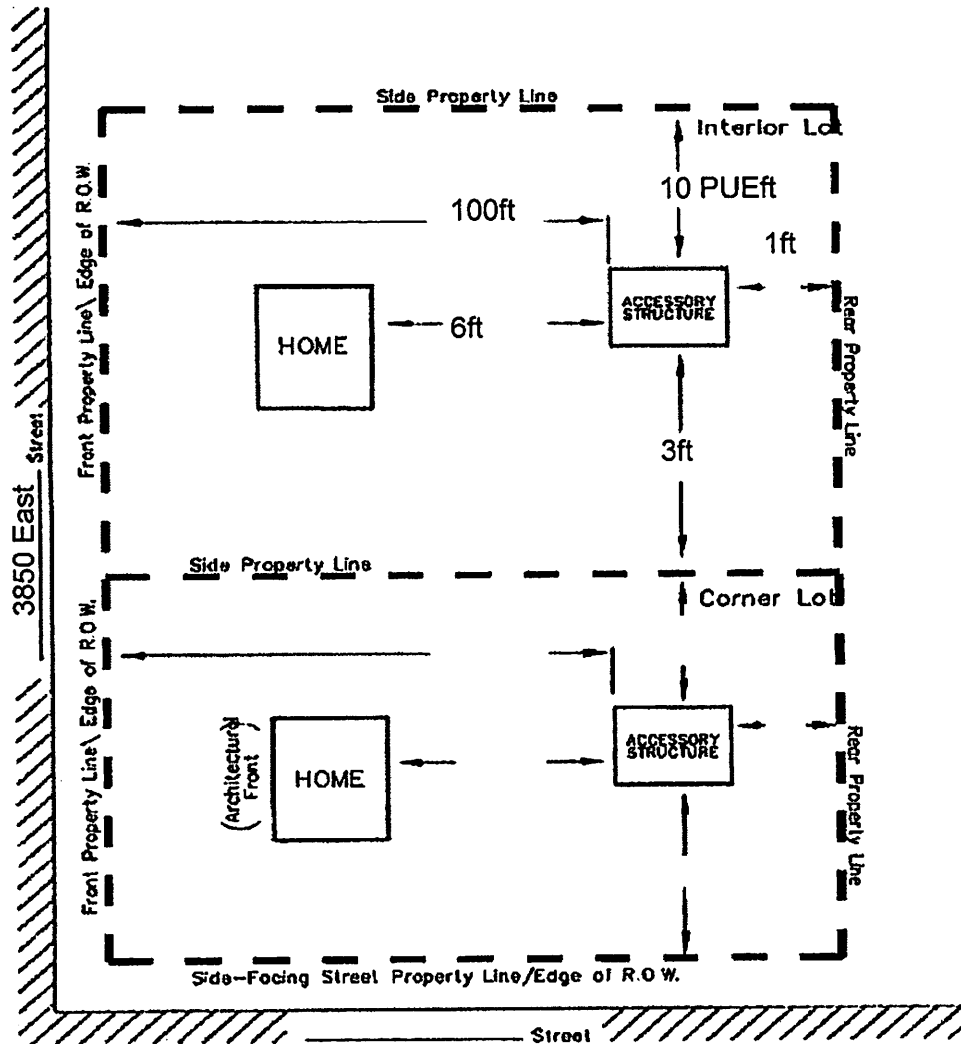

### MINIMUM YARD SETBACKS Storage Shed, Detached Garage, Etc.

#### NOTICE FOR APPLICANT (Please Read Before Signing)

Proposals for the installation of an individual water supply and for a sanitary waste disposal system (septic tank) for any structure designed for human occupation must be approved by Weber County Health Department prior to installation.

Ronda Kippen  
Planning Dept. Signature of Approval

05/01/2018  
Date

I hereby certify that I have read and examined this application and know the same to be true and correct. All provisions of laws and ordinances governing this land use will be complied with whether specified herein or not. I make this statement under penalty of perjury.

WChas  
Contractor/Owner Signature of Approval

5/3/2018  
Date

# Untitled Map

Write a description for your map.



Legend

Google Earth

200 ft



westonolclark@gmail.com