



Mad Moose Doors/Windows Design Review



3.) Change 3 of 4: East Facing Wall new panel door and windows installation: To enhance customer comfort and Mad Moose Café curb appeal. To be completed within 18 months of Design Review approval.



Mad Moose Café

New Wall / Sliding Panel Door Window Layout

Specifications: 1. Install two sliding door systems 8'h x 14' w marked in green on east facing wall. 2. Add ~225 SF additional space indicated by "dotted" area in SW corner of café.

1. New Sliding Panel Window / Doors
(Location depicted by two solid green lines on east facing wall.)

2. Additional Space
West of Hood "dotted" ~225 SF. Includes new doors in red, new windows depicted in green. Windows added for customer viewing from within café. No walls removed, only 1 wall, 2 doors, 4 windows added to new room (New wall indicated by hash marks).

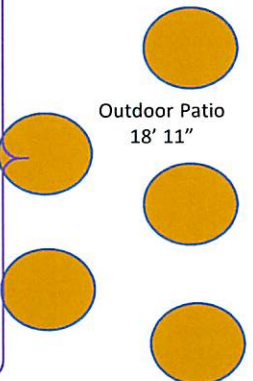
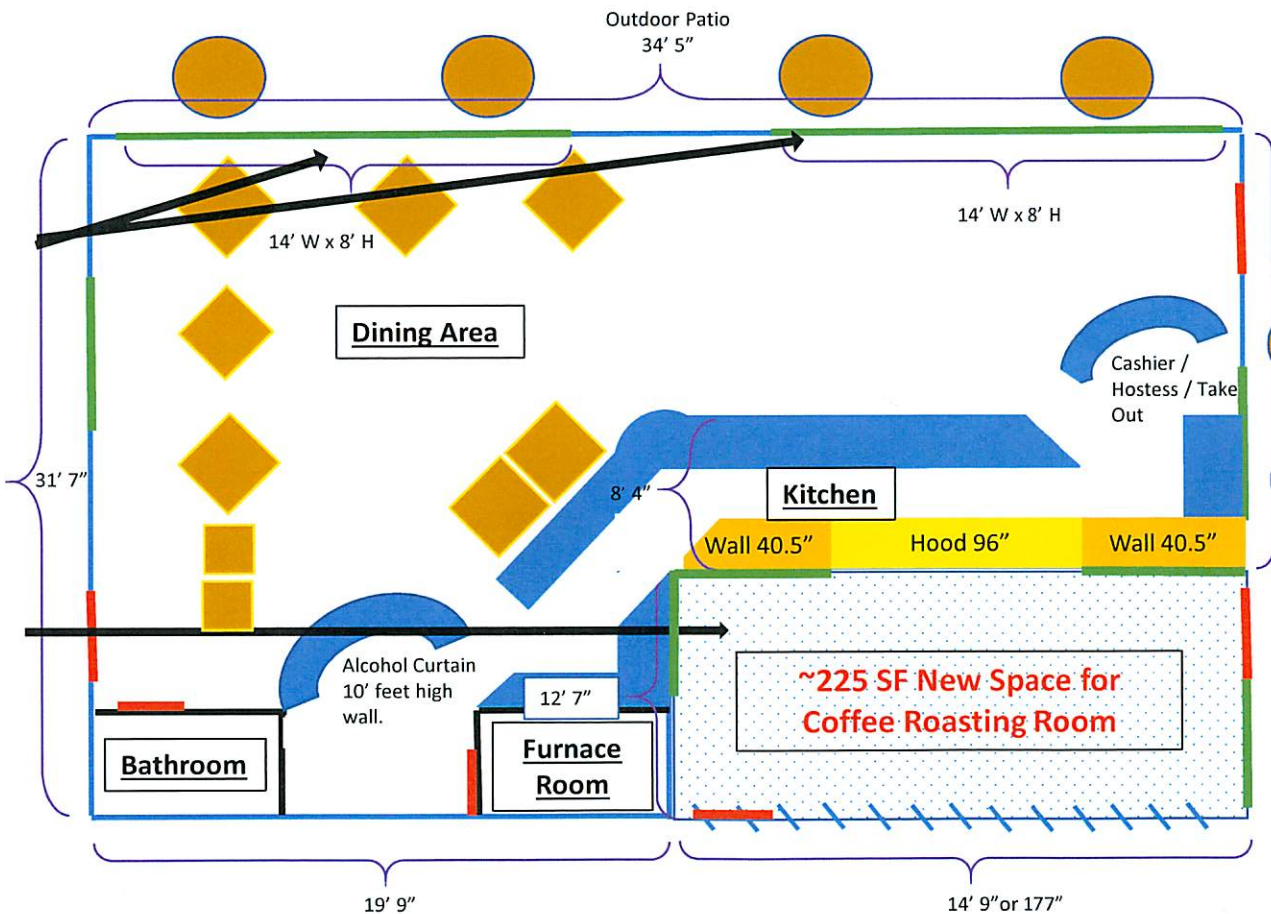

BLUE = Counter Space / Kitchen
RED = Door
BROWN = Tables (Square Indoor, Round Outdoor)
GREEN = Windows
PURPLE = Dimensions (Total Interior SF: 900)
YELLOW = Width of Hood (Centered on 14' 9" wall)
ORANGE = 40.5" distance from edges of wall to edge of Hood

Mad Moose Cafe



Proposed 12' window / door systems (2 each) in place of windows on East facing wall (South side of wall depicted)

Approx 1' thick wall

Proposed 12' window / door systems (North side of wall depicted)



Center of wall where chimney is on outside will remain in place. Chimney approx. 4' wide (behind depicted chalk board).

Present windows dimension is 5'w x 4"h.



Mad Moose Cafe



Location of proposed
12' window / door
systems (two each –
one on each side of
Chimney).





Mad Moose Cafe



Proposed 12' panel window / door systems. Two total systems, one on each side of chimney.

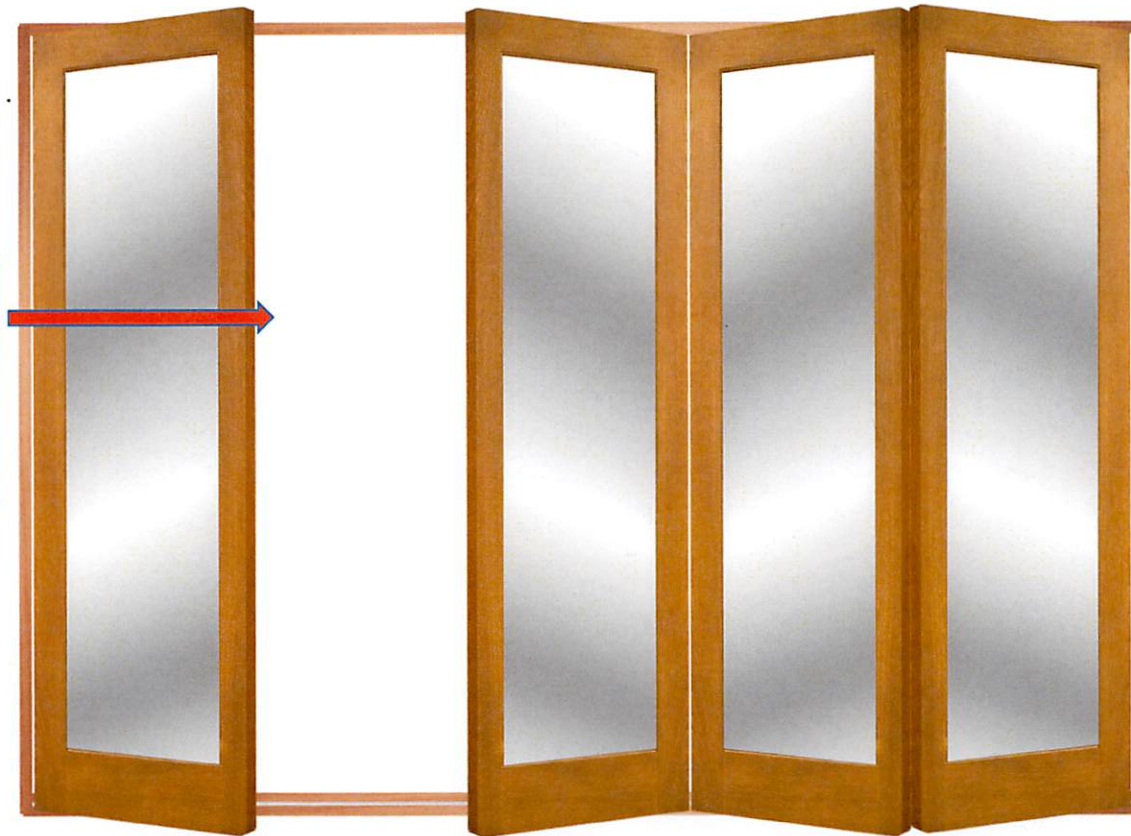



Mad Moose Cafe



Present location of
existing east facing
wall windows – width
of entire wall:
34'6" W x ~30'H

Location of proposed
12' window / door
systems (two each –
one on each side of
Chimney).

