



Mad Moose Wall Design Review



4.) Change 4 of 4: Improvement of internal “non-load bearing wall” to increase Mad Moose space 225 SF. Change involves addition of one non-loadbearing wall, two doors, and four windows for customer viewing, and to permit coffee bean roasting and packaging, and school and customer tours. To be completed within 18 months of Design Review approval. Mad Moose Coffee roasting process complies with Utah Departments of Agriculture and Health requirements for bean roasting & packaging, including periodic regulatory inspections.



Mad Moose Café

New Wall / Sliding Window Layout

Specifications: 1. Install two sliding door systems 8'h x 14' w marked in green on east facing wall. 2. Add ~225 SF add'l space indicated by "dotted" area in SW corner of café.

1. New Sliding Window / Doors
(Location Depicted by two solid green lines on east facing wall.)

2. Additional Space
West of Hood "dotted" ~225 SF. Includes two new doors in red, new windows depicted in green. Windows added for customer viewing from within café. No walls removed, only 1 wall, 2 doors, 4 windows added to new room (New wall indicated by hash marks).

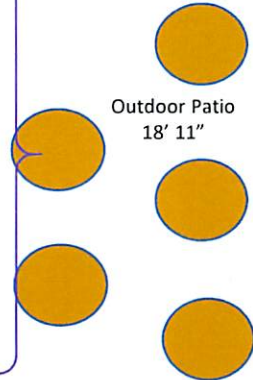
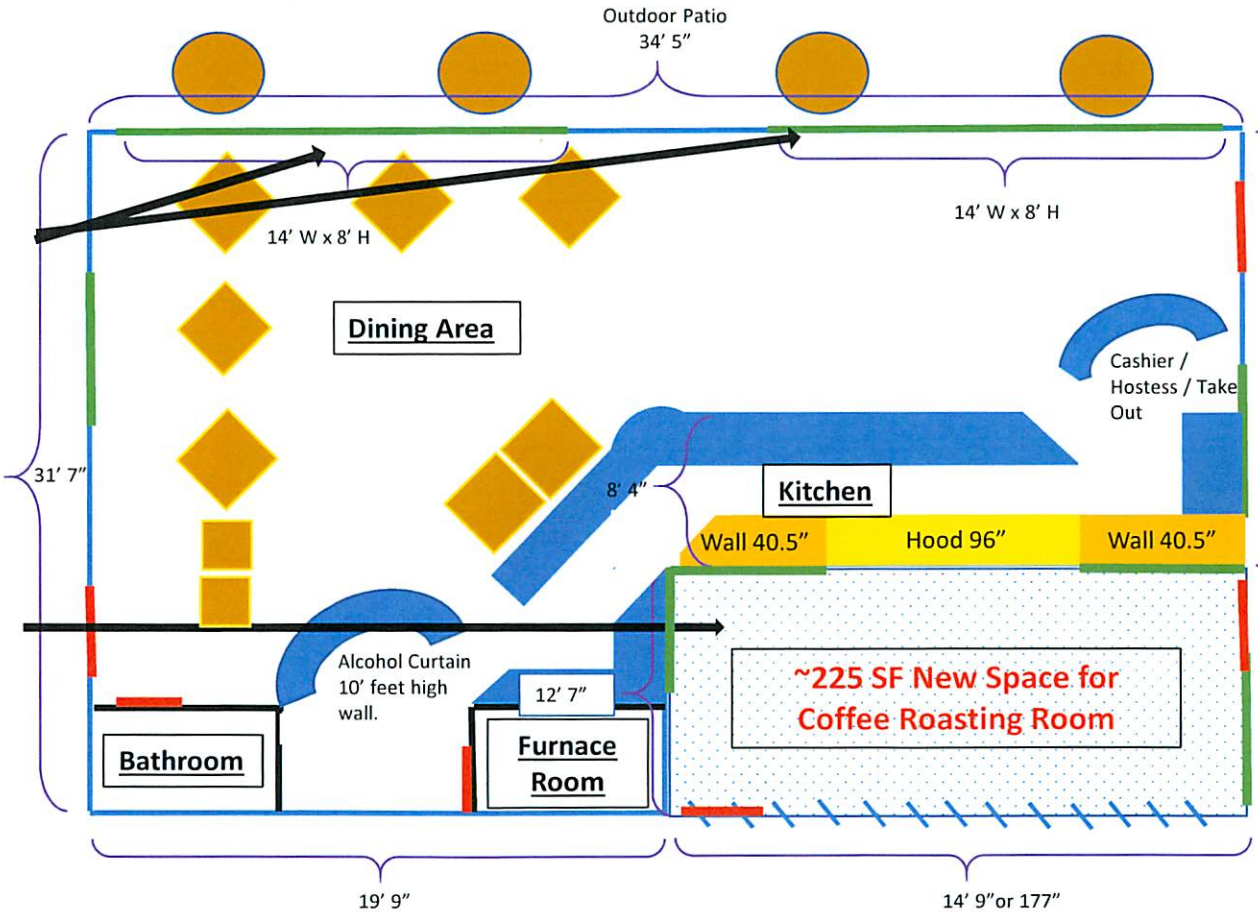

BLUE = Counter Space / Kitchen
RED = Door
BROWN = Tables (Square Indoor, Round Outdoor)
GREEN = Windows
PURPLE = Dimensions (Total Interior SF: 900)
YELLOW = Width of Hood (Centered on 14' 9" wall)
ORANGE = 40.5" distance from edges of wall to edge of Hood