

# POWDER MOUNTAIN LOT 44R CONSTRUCTION DRAWINGS

Located in Sec 01 T7N R1E  
Weber County, Utah

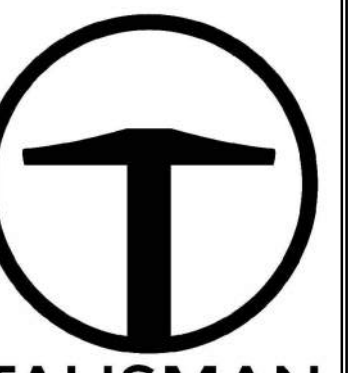

**TALISMAN**  
CIVIL CONSULTANTS  
5217 SOUTH STATE STREET  
SUITE 200  
MURRAY, UT 84107  
801.743.1500

### SHEET INDEX

COVER SHEET	000
GENERAL NOTES AND LEGEND	001
SITE AND HORIZONTAL CONTROL PLAN	200
GRADING PLAN	300
CUT FILL ANALYSIS	301
UTILITY PLAN	400
EROSION CONTROL PLAN	600
DETAILS	700
DETAILS	701
DETAILS	702
DETAILS	703



PROJECT LOCATION

POWDER MOUNTAIN LOT 44R  
COVER SHEET

DATE SUBMITTED: 04.16.2018

TCC JOB NUMBER: 18-009

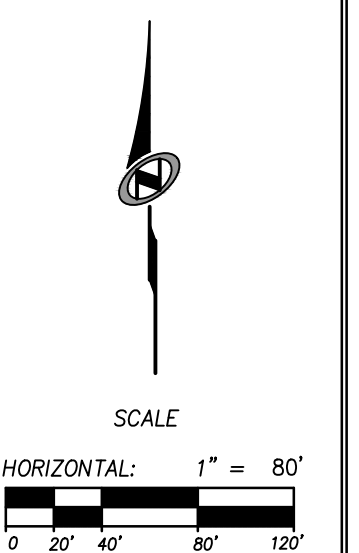
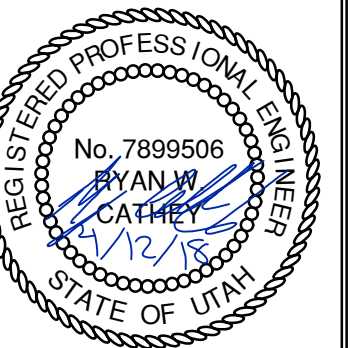

SHEET NUMBER  
**000**  
1 OF 11



DATE: 4/12/2018 5:56 PM

PATH: n:\S\B0793\Cadd\18-009-powder mountain lot 44r\PA\000 COVER SHEET.dwg

GENERAL NOTES

- 1. ALL CONSTRUCTION MUST STRICTLY FOLLOW THE STANDARDS AND SPECIFICATIONS SET FORTH BY: GOVERNING UTILITY MUNICIPALITY, GOVERNING CITY OR COUNTY...
2. CONTRACTOR TO STRICTLY FOLLOW GEOTECHNICAL RECOMMENDATIONS FOR THIS PROJECT. ALL GRADING INCLUDING BUT NOT LIMITED TO CUT, FILL, COMPACTION...
3. TRAFFIC CONTROL, STRIPING & SIGNAGE TO CONFORM TO CURRENT UDOT TRANSPORTATION ENGINEER'S MANUAL AND MANUAL OF UNIFORM TRAFFIC CONTROL DEVICES.

GENERAL NOTES CONT.

- 27. CONTRACTOR SHALL BE SKILLED AND REGULARLY ENGAGED IN THE GENERAL CLASS AND TYPE OF WORK CALLED FOR IN THE PROJECT PLANS AND SPECIFICATIONS...
28. CONTRACTOR SHALL PROVIDE ALL SHORING, BRACING, SLOPING OR OTHER PROVISIONS NECESSARY TO PROTECT WORKMEN FOR ALL AREAS TO BE EXCAVATED...

UTILITY NOTES

- 1. CONTRACTOR SHALL COORDINATE LOCATION OF NEW "DRY UTILITIES" WITH THE APPROPRIATE UTILITY COMPANY, INCLUDING BUT NOT LIMITED TO: TELEPHONE SERVICE, GAS SERVICE, CABLE, POWER, INTERNET.
2. EXISTING UTILITIES HAVE BEEN SHOWN ON THE PLANS USING A COMBINATION OF ON-SITE SURVEYS (BY OTHERS), PRIOR TO COMMENCING ANY WORK, IT SHALL BE THE CONTRACTOR'S RESPONSIBILITY TO HAVE EACH UTILITY COMPANY LOCATE...

LEGEND:

Table with columns: SYMBOL / LINETYPE and DESCRIPTION. Includes symbols for existing water pipe, sanitary sewer manhole, telecommunication conduit, storm drain line, and proposed concrete, water valve, water meter, etc.

NOTE: LEGEND MAY CONTAIN SYMBOLS THAT ARE NOT USED IN PLAN SET.

EROSION CONTROL GENERAL NOTES:

THE CONTRACTOR TO USE BEST MANAGEMENT PRACTICES FOR PROVIDING EROSION CONTROL FOR CONSTRUCTION OF THIS PROJECT. ALL MATERIAL AND WORKMANSHIP SHALL CONFORM TO WEBER COUNTY ORDINANCES AND ALL WORK SHALL BE SUBJECT TO INSPECTION BY THE COUNTIES.

CONTRACTOR SHALL KEEP THE SITE WATERED TO CONTROL DUST. CONTRACTOR TO LOCATE A NEARBY HYDRANT FOR USE AND TO INSTALL TEMPORARY METER. CONSTRUCTION WATER COST TO BE INCLUDED IN BID.
WHEN GRADING OPERATIONS ARE COMPLETED AND THE DISTURBED GROUND IS LEFT "OPEN" FOR 14 DAYS OR MORE, THE AREA SHALL BE FURROWED PARALLEL TO THE CONTOURS.

MAINTENANCE:

ALL BEST MANAGEMENT PRACTICES (BMP'S) SHOWN ON THIS PLAN MUST BE MAINTAINED AT ALL TIMES UNTIL VEGETATION IS RE-ESTABLISHED.
THE CONTRACTOR'S RESPONSIBILITY SHALL INCLUDE MAKING BI-WEEKLY CHECKS ON ALL EROSION CONTROL MEASURES TO DETERMINE IF REPAIR OR SEDIMENT REMOVAL IS NECESSARY.

EXPOSED SLOPES:

- ANY EXPOSED SLOPE THAT WILL REMAIN UNTOUCHED FOR LONGER THAN 14 DAYS MUST BE STABILIZED BY ONE OR MORE OF THE FOLLOWING METHODS:
A) SPRAYING DISTURBED AREAS WITH A TACKIFIER VIA HYDROSEED
B) TRACKING STRAW PERPENDICULAR TO SLOPES
C) INSTALLING A LIGHT-WEIGHT, TEMPORARY EROSION CONTROL BLANKET

ABBREVIATIONS:

- BC - BUILDING
BS - BOTTOM OF STAIRS
BW - BOTTOM OF WALL
EX - EXISTING
FL - FLOWLINE
FG - FINISHED GROUND
MA - MATCH
RIM - RIM OF MANHOLE
TS - TOP OF STAIRS
TW - TOP OF WALL

WEBER COUNTY

2380 WASHINGTON BLVD. #240
OGDEN, UT 84401
(801) 399-8374

ROCKY MOUNTAIN POWER

1438 WEST 2550 SOUTH
OGDEN, UT 84401
(801) 629-4429

POWDER MOUNTAIN WATER & SEWER DISTRICT

PO BOX 270
EDEN, UT 84310
(801) 745-0912

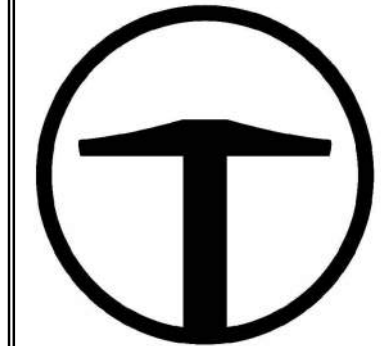

TALISMAN CIVIL CONSULTANTS
5217 SOUTH STATE STREET
SUITE 200
MURRAY, UT 84107
801.743.1500

Revision table with columns: NO., BY, DATE, REVISIONS

POWDER MOUNTAIN LOT 44R
GENERAL NOTES AND LEGEND

TCC JOB NUMBER: 18-009
DATE SUBMITTED: 04.16.2018

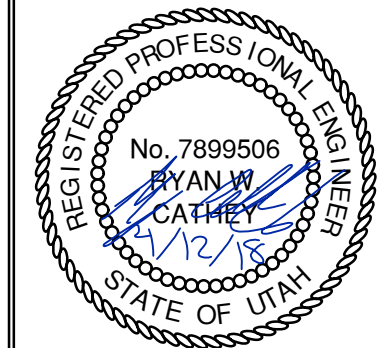

SHEET NUMBER
001
2 OF 11





DATE: 4/12/2018 5:56 PM

PATH: m:\S\B0793\Cadd\18-009-powder mountain lot 44r\PA\_300 GRADING PLAN.dwg

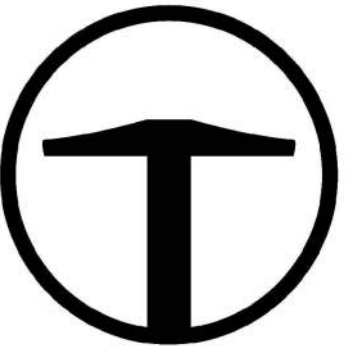

**TALISMAN**  
CIVIL CONSULTANTS  
5217 SOUTH STATE STREET  
SUITE 200  
MURRAY, UT 84107  
801.743.1500

NO.	BY	DATE	REVISIONS

**POWDER MOUNTAIN LOT 44R**  
**GRADING PLAN**

TCC JOB NUMBER: 18-009      DATE SUBMITTED: 04.16.2018

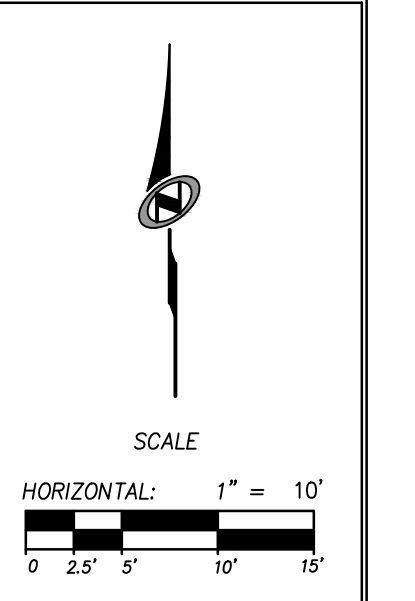
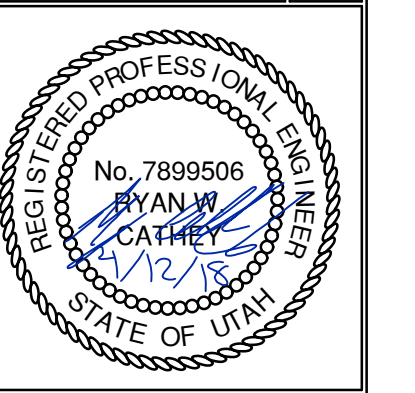

SHEET NUMBER  
**300**  
4 OF 11



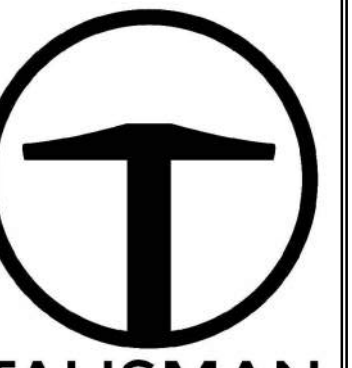
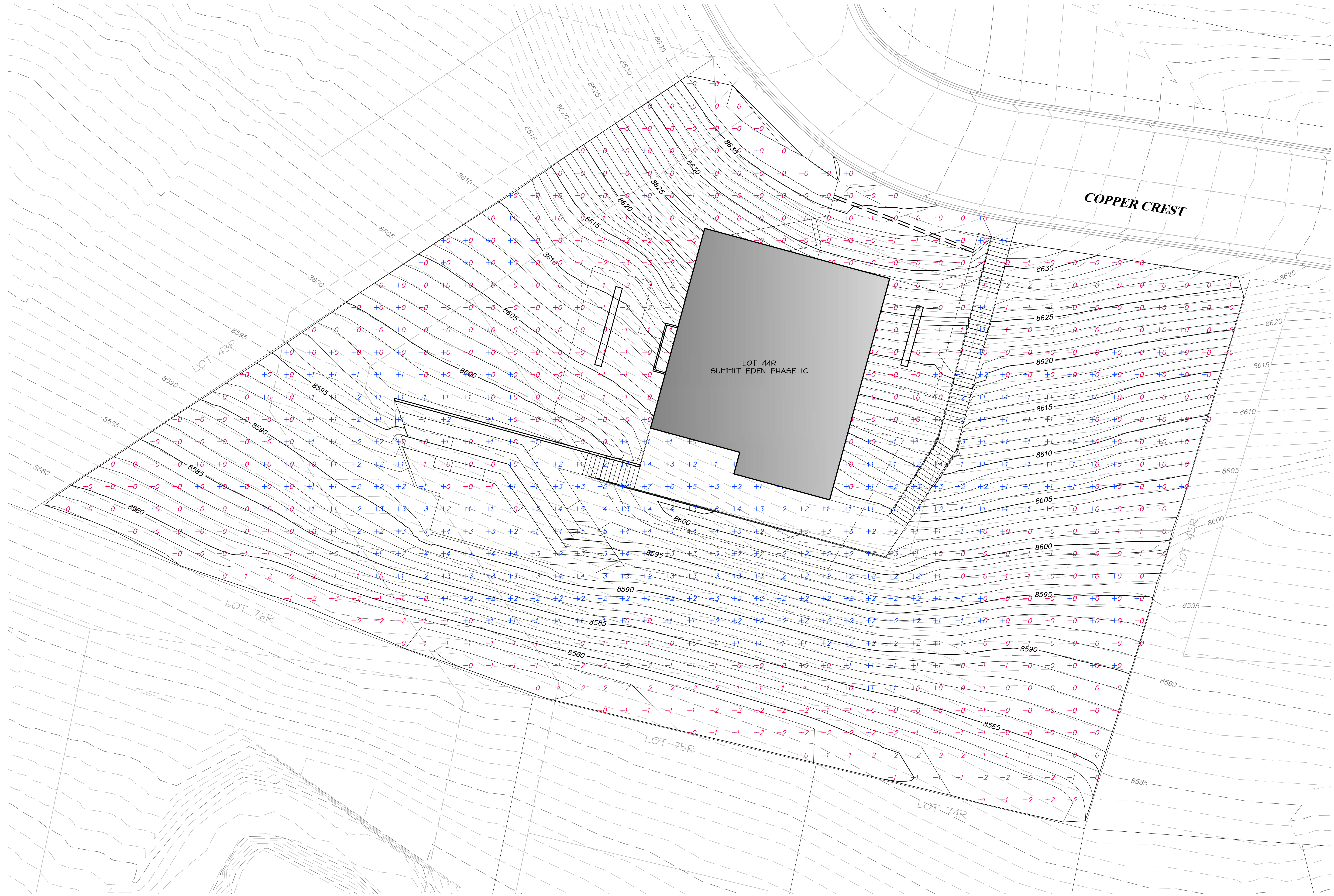

**TALISMAN**  
CIVIL CONSULTANTS  
5217 SOUTH STATE STREET  
SUITE 200  
MURRAY, UT 84107  
801.743.1500

NO.	BY	DATE	REVISIONS

**POWDER MOUNTAIN LOT 44R**  
**CUT FILL ANALYSIS**

DATE SUBMITTED: 04.16.2018

TCC JOB NUMBER: 18-009

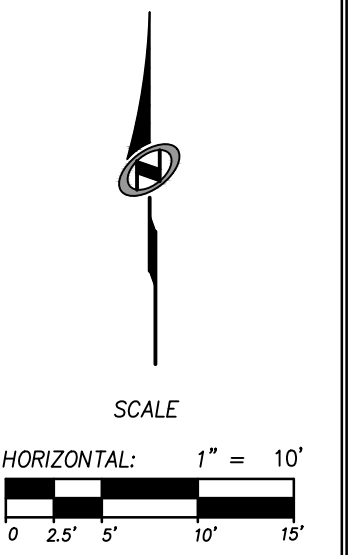
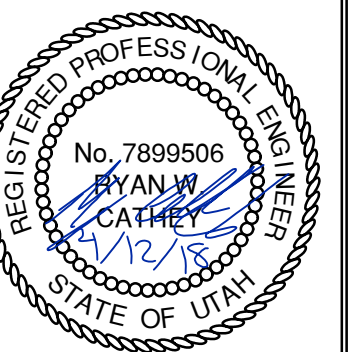

**CUT/FILL ANALYSIS**  
CUT 1149 CU. YD.  
FILL 538 CU. YD.  
NET FILL 611 CU. YD.



DATE: 4/12/2018 5:57 PM

PATH: m:\S\80793\Cadd\18-009-powder mountain lot 44r\IP\400 UTILITY PLAN.dwg

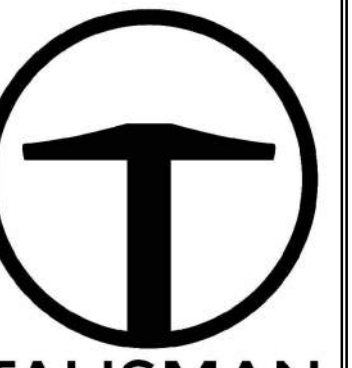

TALISMAN  
CIVIL CONSULTANTS  
5217 SOUTH STATE STREET  
SUITE 200  
MURRAY, UT 84107  
801.743.1500

NO.	DATE	BY	REVISIONS

DATE SUBMITTED: 04.16.2018

# POWDER MOUNTAIN LOT 44R UTILITY PLAN

TCC JOB NUMBER: 18-009

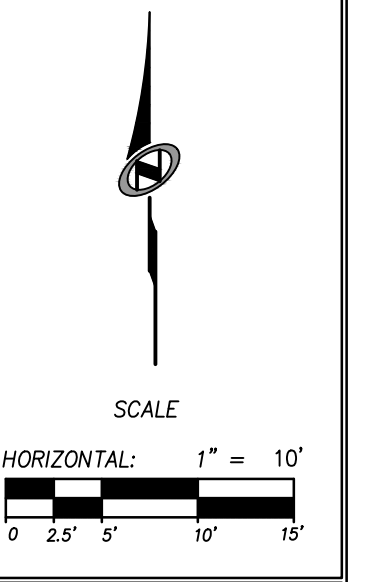
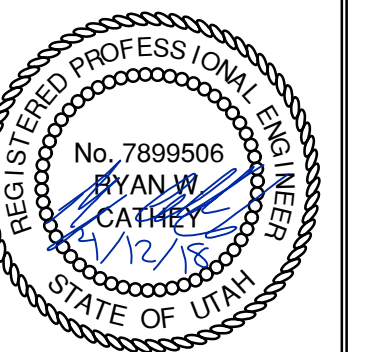

SHEET NUMBER  
**400**  
6 OF 11

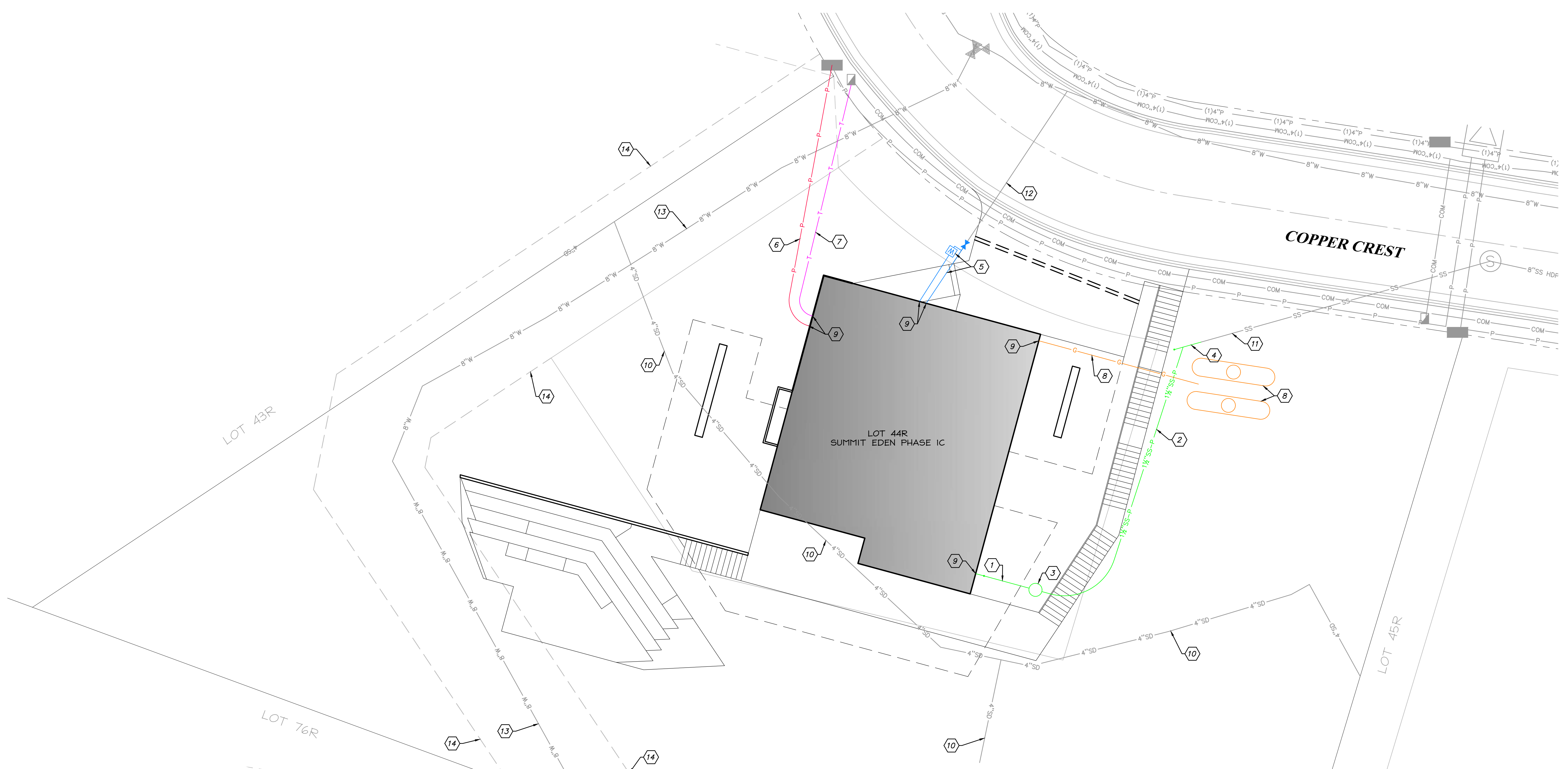

- UTILITIES:**  
ENSURE MINIMUM BURIED DEPTH PER BUILDING CODE FOR ALL BURIED UTILITIES.  
IMPROVEMENTS, INCLUDING LANDSCAPING, SHALL NOT INTERFERE WITH ANY DRAINAGE CULVERT, RIP RAP, AND DRAINAGE PATTERN ASSOCIATED WITH ANY DRAINAGE EASEMENT.
- KEY NOTES:**
- 1 INSTALL 4"Ø SEWER LATERAL WITH CLEANOUT PER APWA PLAN NO. 431.
  - 2 INSTALL 1 1/2"Ø DR-11 IPS PRESSURE SEWER PIPE, MINIMUM COVER OF 72".  
INSTALL E/ONE GRINDER PUMP STATION MODEL DH071, WITH E/ONE SENTRY ALARM PANEL INCLUDING GENERATOR RECEPTACLE WITH AUTO TRANSFER AND GFCI RECEPTACLE. ALARM PANELS SHALL BE INSTALLED WITHIN LINE OF SIGHT OF ENTRY TO UNIT. SEE DETAIL SHEET A/703.
  - 3
  - 4 CONNECT TO EXISTING SANITARY SEWER LATERAL PER DETAIL B/SHEET 703.
  - 5 INSTALL CULINARY WATER AND FIRE LINES PER DETAIL A/SHEET 702.
  - 6 INSTALL ELECTRICAL LINE FROM SERVICE BOX TO BUILDING.
  - 7 INSTALL TELECOMMUNICATIONS LINE FROM SERVICE BOX TO BUILDING.
  - 8 INSTALL PROPANE TANKS PER DETAIL B/SHEET 702. SERVICE LINE TO BUILDING TO BE INSTALLED BY OTHERS.
  - 9 SEE MECHANICAL PLANS FOR CONTINUATION OF UTILITY WITHIN BUILDING.
  - 10 EXISTING SLOPE DRAIN PIPE. DEMO AS NECESSARY FOR CONSTRUCTION. REPAIR AND TIE INTO NEW FOUNDATION DRAIN. SEE STRUCTURAL PLANS FOR FOUNDATION DRAIN DETAILS.
  - 11 EXISTING SEWER LATERAL.
  - 12 EXISTING WATER LATERAL.
  - 13 PROTECT EXISTING 8"Ø WATER PIPE IN PLACE.
  - 14 EXISTING WATER EASEMENT.

DATE: 4/12/2018 6:59 PM

PATH: m:\S\B0793\Cadd\18-009-powder mountain lot 44r\18-009-erosion control plan.dwg



**EROSION CONTROL GENERAL NOTES:**

THE CONTRACTOR TO USE BEST MANAGEMENT PRACTICES FOR PROVIDING EROSION CONTROL FOR CONSTRUCTION OF THIS PROJECT. ALL MATERIAL AND WORKMANSHIP SHALL CONFORM TO WEBER COUNTY ORDINANCES AND ALL WORK SHALL BE SUBJECT TO INSPECTION BY THE COUNTY. ALSO, INSPECTORS WILL HAVE THE RIGHT TO CHANGE THE FACILITIES AS NEEDED.

CONTRACTOR SHALL KEEP THE SITE WATERED TO CONTROL DUST. CONTRACTOR TO LOCATE A NEARBY HYDRANT FOR USE AND TO INSTALL TEMPORARY METER. CONSTRUCTION WATER COST TO BE INCLUDED IN BID.

WHEN GRADING OPERATIONS ARE COMPLETED AND THE DISTURBED GROUND IS LEFT "OPEN" FOR 14 DAYS OR MORE, THE AREA SHALL BE FURROWED PARALLEL TO THE CONTOURS.

THE CONTRACTOR SHALL MODIFY EROSION CONTROL MEASURES TO ACCOMMODATE PROJECT PLANNING.

ALL ACCESS TO PROPERTY WILL BE FROM PUBLIC RIGHT-OF-WAYS.

THE CONTRACTOR IS REQUIRED BY STATE AND FEDERAL REGULATIONS TO PREPARE A STORM WATER POLLUTION PREVENTION PLAN AND FILE A "NOTICE OF INTENT" WITH THE UTAH DIVISION OF WATER QUALITY.

**MAINTENANCE:**

ALL BEST MANAGEMENT PRACTICES (BMP'S) SHOWN ON THIS PLAN MUST BE MAINTAINED AT ALL TIMES UNTIL VEGETATION IS RE-ESTABLISHED.

THE CONTRACTOR'S RESPONSIBILITY SHALL INCLUDE MAKING BI-WEEKLY CHECKS ON ALL EROSION CONTROL MEASURES TO DETERMINE IF REPAIR OR SEDIMENT REMOVAL IS NECESSARY. CHECKS SHALL BE DOCUMENTED AND COPIES OF THE INSPECTIONS KEPT ON SITE.

SEDIMENT DEPOSITS SHOULD BE REMOVED AFTER EACH RAINFALL. THEY MUST BE REMOVED WHEN THE LEVEL OF DEPOSITION REACHES APPROXIMATELY ONE-HALF THE HEIGHT OF BARRIER.

SEDIMENT TRACKED ONTO PAVED ROADS MUST BE CLEANED UP AS SOON AS PRACTICAL, BUT IN NO CASE LATER THAN THE END OF THE NORMAL WORK DAY. THE CLEAN UP WILL INCLUDE SWEEPING OF THE TRACKED MATERIAL, PICKING IT UP, AND DEPOSITING IT TO A CONTAINED AREA.



**EXPOSED SLOPES:**

ANY EXPOSED SLOPE THAT WILL REMAIN UNTOUCHED FOR LONGER THAN 14 DAYS MUST BE STABILIZED BY ONE OR MORE OF THE FOLLOWING METHODS:

- A) SPRAYING DISTURBED AREAS WITH A TACKIFIER VIA HYDROSEED
- B) TRACKING STRAW PERPENDICULAR TO SLOPES
- C) INSTALLING A LIGHT-WEIGHT, TEMPORARY EROSION CONTROL BLANKET

**SCOPE OF WORK:**

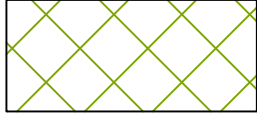
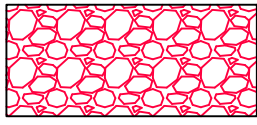
PROVIDE, INSTALL AND/OR CONSTRUCT THE FOLLOWING PER THE SPECIFICATIONS GIVEN OR REFERENCED, THE DETAILS NOTED, AND/OR AS SHOWN ON THE CONSTRUCTION DRAWINGS:

-  HATCHING INDICATES AREAS TO RECEIVE 4" TOPSOIL AND TO BE SEEDED FOR NATURAL VEGETATION. AREAS RECEIVING SEEDING FOR NATURAL VEGETATION ON SLOPES OF 3:1 OR STEEPER MUST BE COVERED WITH AN EROSION CONTROL BLANKET AFTER THE FINAL GRADING AND SEEDING ARE FINISHED. INSTALL NORTH AMERICAN GREEN SC-150 BLANKET OR APPROVED EQUAL. FOLLOW MANUFACTURER'S SPECIFICATIONS.
-  STABILIZED CONSTRUCTION ENTRANCE PER APWA PLAN NO. 126.
-  INSTALL SILT FENCE ALONG DOWN GRADIENT LIMITS OF DISTURBANCE AS SHOWN ON PLAN PER APWA PLAN NO. 122. SEE SHEET 700.
-  INSTALL ORANGE SAFETY FENCING AROUND OUTER LIMITS OF PROJECT PRIOR TO GRADING.

SEE LANDSCAPING PLANS FOR SEED MIXTURE

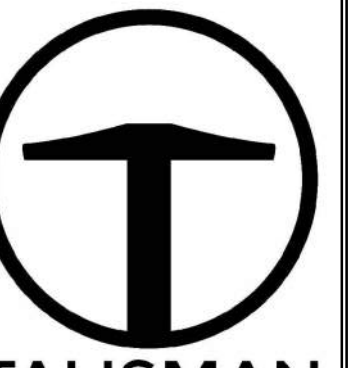

**TALISMAN**  
CIVIL CONSULTANTS  
5217 SOUTH STATE STREET  
SUITE 200  
MURRAY, UT 84107  
801.743.1500

NO.	BY	DATE	REVISIONS

**POWDER MOUNTAIN LOT 44R**  
**EROSION CONTROL PLAN**

DATE SUBMITTED: 04.16.2018

TCC JOB NUMBER: 18-009

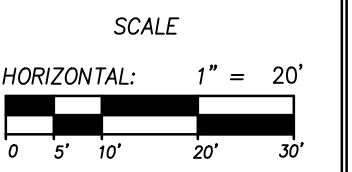
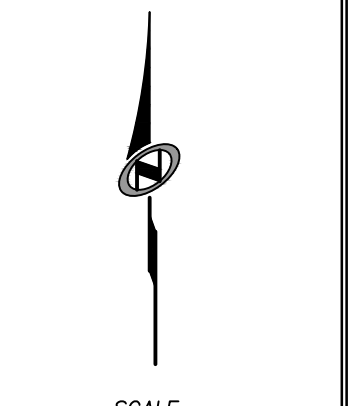
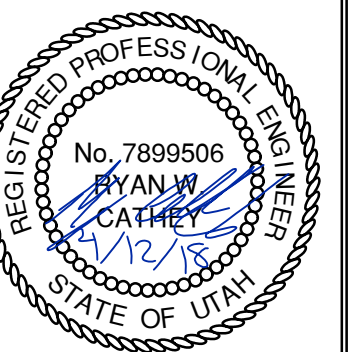

SHEET NUMBER  
**600**  
7 OF 11



Silt fence

- GENERAL**
  - Description. A temporary sediment barrier consisting of a filter fabric stretched across and attached to supporting posts and entrenched.
  - Application. To intercept sediment from disturbed areas of limited extent.
  - Perimeter Control: Place barrier at down gradient limits of disturbance.
  - Sediment Barrier: Place barrier at toe of slope or soil stockpile.
  - Protection of Existing Waterways: Place barrier at top of stream bank.
  - Inlet Protection.
- PRODUCTS**
  - Fabric. Synthetic filter fabric shall be a pervious sheet of propylene, nylon, polyester, or polyethylene yarn. Synthetic filter fabric shall contain ultraviolet ray inhibitors and stabilizers to provide a minimum of 6 months of expected usable construction life at a temperature range of 0 deg F to 120 deg F.
  - Burlap. 10 ounces per square yard of fabric.
  - Posts. Either 2" x 4" diameter wood, or 1.33 pounds per linear foot steel with a minimum length of 5 feet, or steel posts with projections for fastening wire to them.
- EXECUTION**
  - Cut the fabric on site to desired width, unroll, and drape over the barrier. Secure the fabric toe with rocks or dirt and secure the fabric to the mesh with twin, staples or similar devices.
  - When attaching two silt fences together, place the end post of the second fence inside the end post of the first fence. Rotate both posts at least 180 degrees on a clockwise direction to create a tight seal with the filter fabric. Drive both posts into the ground and bury the flap.
  - When used to control sediments from a steep slope, place silt fences away from the toe of the slope for increased holding capacity.
  - Maintenance.
    - Inspect immediately after each rainfall and at least daily during prolonged rainfall.
    - Should the fabric on a silt fence or filter barrier decompose or become ineffective before the end of the expected usable life and the barrier still be necessary, replace the fabric promptly.
    - Remove sediment deposits after each storm event. They must be removed when deposits reach approximately one-half the height of the barrier.
    - Re-anchor fence as necessary to prevent shortcutting.
    - Inspect for runoff bypassing ends of barriers or undercutting barriers.

Stabilized roadway entrance

- GENERAL**
  - Description. A temporary stabilized pad of gravel for controlling equipment and construction vehicle access to the site.
  - Application. At any site where vehicles and equipment enter the public right of way.
- PRODUCT** (Not used)
- EXECUTION**
  - Clear and grub area and grade to provide maximum slope of 1 percent away from paved roadway.
  - Compact subgrade.
  - Place filter fabric under stone if desired (recommended for entrance area that remains more than 3 months).
  - Maintenance.
    - Prevent tracking or flow of mud into the public right-of-way.
    - Periodic top dressing with 2-inch stone may be required, as conditions demand, and repair any structures used to trap sediments.
    - Inspect daily for loss of gravel or sediment buildup.
    - Inspect adjacent area for sediment deposit and install additional controls as necessary.
    - Expand stabilized area as required to accommodate activities.

Trench backfill

- GENERAL**
  - The drawing applies to backfilling the trench above the pipe zone.
- PRODUCTS**
  - Backfill: Common fill, APWA Section 31 05 13. Maximum particle size 3-inches.
  - Flowable Fill: Target is 60 psi in 28 days with 90 psi maximum in 28 days, APWA Section 31 05 15. It must flow easily requiring no vibration for consolidation.
- EXECUTION**
  - Trench Backfill:
    - DO NOT USE sewer rock, pea gravel, or recycled RAP aggregate as trench backfill.
    - Maximum lift thickness is 8-inches before compaction. Compaction is 95 percent or greater relative to a standard proctor density, APWA Section 31 23 26.
    - Water jetting is NOT allowed.
    - Submission of quality control compaction test result data developed for haunching areas may be requested by ENGINEER at any time. Provide results of tests immediately upon request.
  - Flowable Fill: When required, place controlled low strength material in the trench, APWA Section 31 05 15. Cure the fill before placing surface restorations.
  - Surface Restoration:
    - Landscaped Surface: Rake to match existing grade. Replace vegetation to match pre-construction conditions. Follow APWA Section 32 92 00 (turf or grass) or APWA Section 32 93 13 (ground cover) requirements.
    - Paved Surface: Do not install asphalt or concrete surfacing until trench compaction is acceptable to ENGINEER. Follow APWA Section 33 05 25 (asphalt surfacing), or APWA Section 33 05 25 (concrete surfacing).

Pipe zone backfill

- GENERAL**
  - Install the pipe in the center of the trench or no closer than 6-inches from the wall of the pipe to the wall of the trench.
- PRODUCTS**
  - Base Course: Untreated base course, APWA Section 32 11 23. Do not use gravel as a base course without ENGINEER'S permission.
  - Backfill: Common fill, APWA Section 31 05 13. Maximum particle size 2-inches.
  - Concrete: APWA Section 03 30 04.
  - Flowable Fill: Target is 60 psi in 28 days with 90 psi maximum in 28 days, APWA Section 31 05 15. It must flow easily requiring no vibration for consolidation.
  - Stabilization-Separation Geotextile: Moderate or high at CONTRACTOR'S choice, APWA Section 31 05 19.
- EXECUTION**
  - Excavate the Pipe Zone: Width is measured at the pipe spring line and includes any necessary sheathing. Provide width recommended by pipe manufacturer. Follow manufacturer's recommendations when using trench boxes.
  - Foundation Stabilization: Get ENGINEER'S permission before installing common fill. Vibrate to stabilize. Installation of stabilization-separation geotextile will be required to separate backfill material and native subgrade materials if common fill cannot provide a working surface or prevent soils migration.
  - Base Course:
    - Furnish untreated base course material unless specified otherwise by pipe manufacturer.
    - Maximum lift thickness is 8-inches before compaction. Compaction is 95 percent or greater relative to a modified proctor density, APWA Section 31 23 26.
    - When using concrete, provide at least Class 2,000 per APWA Section 03 30 04.
  - Pipe Zone: DO NOT USE sewer rock, pea gravel, or recycled RAP aggregate in the pipe zone. Water jetting is NOT allowed.
    - Maximum lift thickness is 8-inches before compaction. Compaction is 95 percent or greater relative to a modified proctor density, APWA Section 31 23 26 unless pipe manufacturer requires more stringent installation.
    - Submission of quality control compaction test result data developed for the haunch zone may be requested by ENGINEER at any time. CONTRACTOR is to provide results of tests immediately upon request.
  - Flowable Fill (when required and if allowed by pipe manufacturer):
    - Place the controlled low strength material, APWA Section 31 05 15.
    - Prevent pipe flotation by installing in lifts and providing pipe restraints as required by pipe manufacturer.
    - Reset pipe to line and grade if pipe "floats" out of position.

NARRATIVE: THIS PLAN MAY BE USED FOR THE CONSTRUCTION OF A STORM WATER BEST MANAGEMENT PRACTICE (BMP). IT IS NOT INCLUSIVE OF ALL PRACTICES AVAILABLE AND IS ONLY SPECIFIC TO THE CONSTRUCTION OF THIS TYPE. MAINTENANCE OF THIS TYPE OF INSTALLATION IS IMPORTANT AND SHOULD BE CONTINUOUSLY MONITORED BY THE CONTRACTOR AND ENGINEER. DETAILS SHOWN HERE HIGHLIGHT IMPORTANT PARTS OF CONSTRUCTION, AND SHOULD BE MODIFIED AS NEEDED.

NARRATIVE: THIS PLAN MAY BE USED FOR THE CONSTRUCTION OF A STORM WATER BEST MANAGEMENT PRACTICE (BMP). IT IS NOT INCLUSIVE OF ALL PRACTICES AVAILABLE AND IS ONLY SPECIFIC TO THE CONSTRUCTION OF THIS TYPE. MAINTENANCE OF THIS TYPE OF INSTALLATION IS IMPORTANT AND SHOULD BE CONTINUOUSLY MONITORED BY THE CONTRACTOR AND ENGINEER. DETAILS SHOWN HERE HIGHLIGHT IMPORTANT PARTS OF CONSTRUCTION, AND SHOULD BE MODIFIED AS NEEDED.

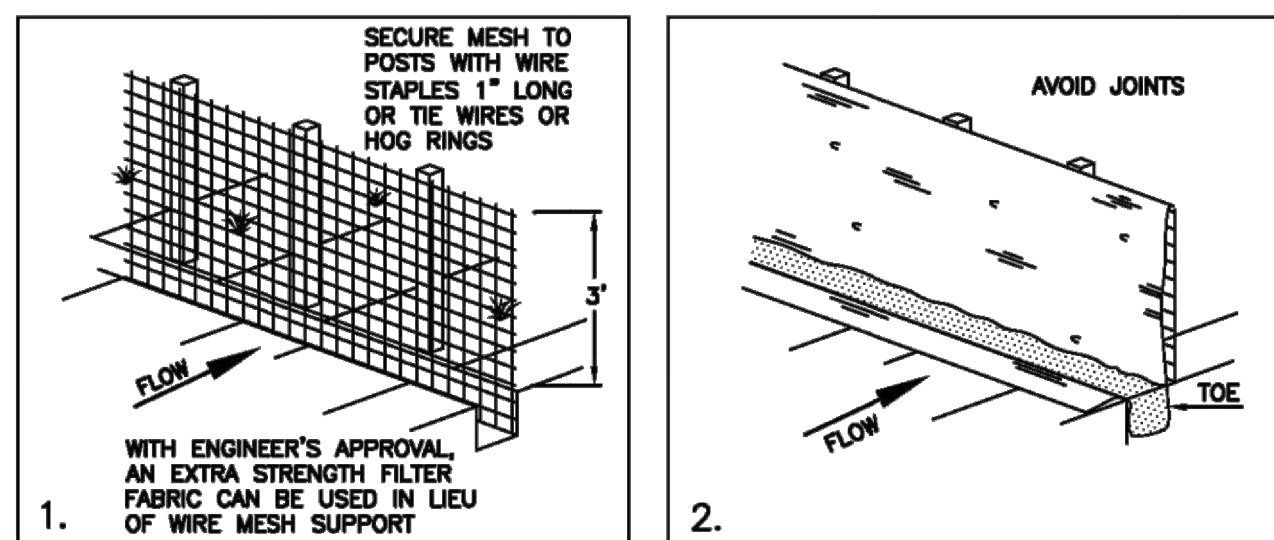

INSTALLATION SEQUENCE

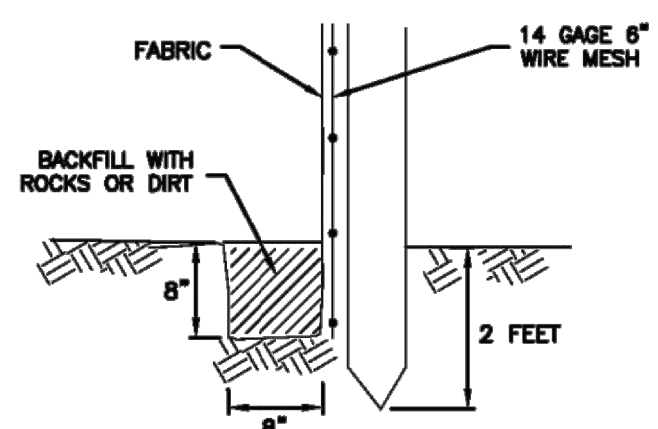

TOE DETAIL

Silt fence

Plan 122

Stabilized roadway entrance

Plan 126

February 2008

February 2008

Trench backfill

Plan 381

January 2011

Pipe zone backfill

Plan 382

January 2011

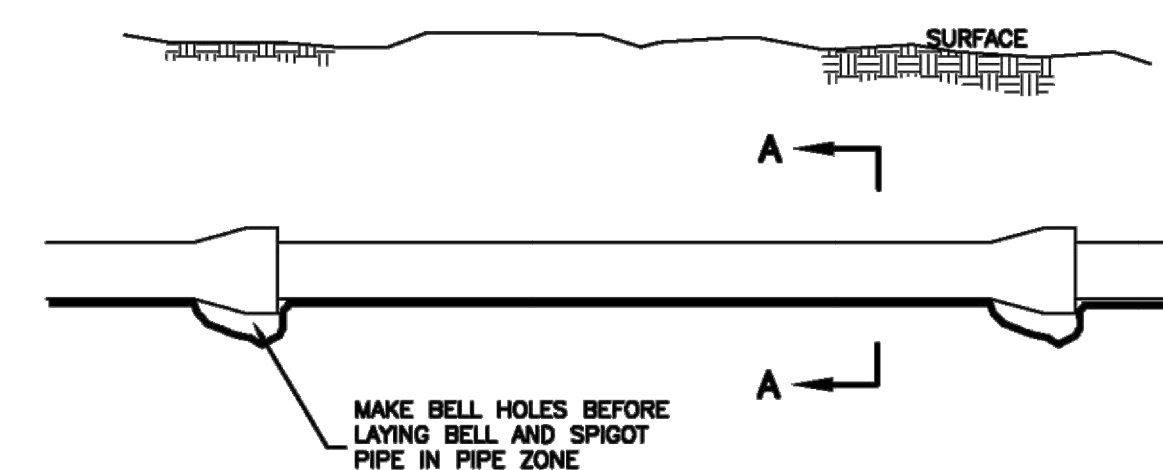

ELEVATION VIEW

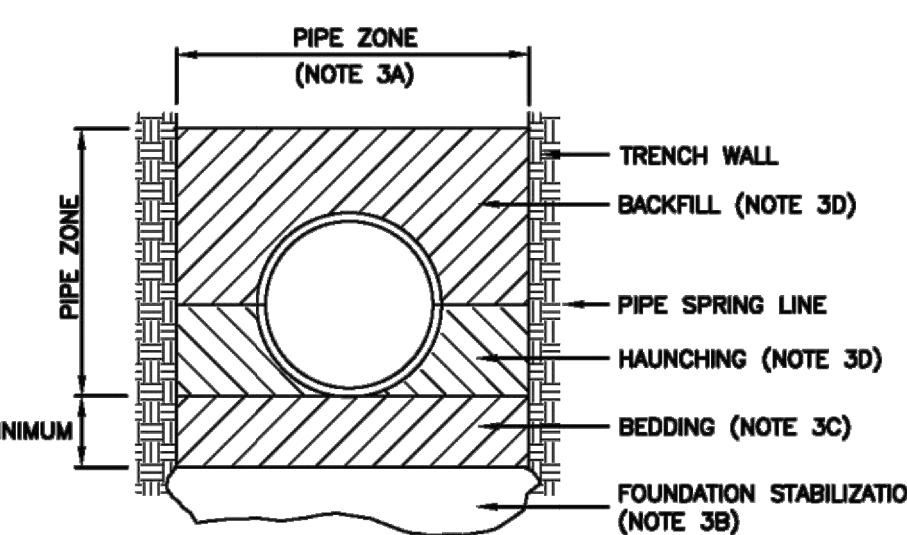

SECTION A-A

INSTALLATION

CONCRETE PIPE: FOLLOW ASTM C 1479  
 "STANDARD PRACTICE FOR INSTALLATION OF PRECAST CONCRETE SEWER, STORM DRAIN, AND CULVERT PIPE USING STANDARD INSTALLATIONS."

PVC AND HDPE PIPE: FOLLOW ASTM D 2321  
 "STANDARD PRACTICE FOR UNDERGROUND INSTALLATION OF THERMOPLASTIC PIPE FOR SEWERS AND OTHER GRAVITY-FLOW APPLICATIONS."

CORRUGATED METAL PIPE: FOLLOW ASTM A 798  
 "STANDARD PRACTICE FOR INSTALLING FACTORY-MADE CORRUGATED STEEL PIPE FOR SEWERS AND OTHER APPLICATIONS."

VITRIFIED CLAY PIPE: FOLLOW ASTM C 12.  
 "STANDARD RECOMMENDED PRACTICE FOR INSTALLING VITRIFIED CLAY PIPE LINES."



NO.	DATE	BY	REVISIONS

POWDER MOUNTAIN LOT 44R

DETAILS

DATE SUBMITTED: 04.16.2018

TCC JOB NUMBER: 18-009

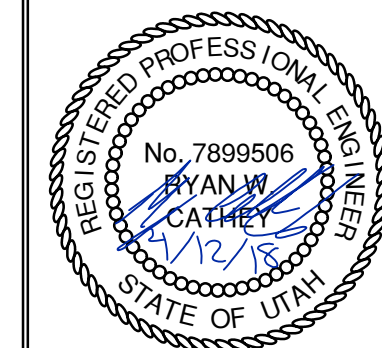

SHEET NUMBER

700

8 OF 11



DATE: 4/12/2018 5:58 PM PATH: m:\SIB0793\Cadd\18-009-powder mountain lot 44r\IP\700 DETAILS.dwg



Sewer lateral connection

1. GENERAL
  - A. Before installation, secure acceptance by ENGINEER for all pipe, fittings, and couplings to be used.
  - B. Before backfilling, secure inspection of installation by ENGINEER. Give at least 24 hours notice.
  - C. Verify if CONTRACTOR or agency is to install the wye.
2. PRODUCTS
  - A. Base Course: Untreated base course, APWA Section 32 11 23. Do not use gravel as a base course without ENGINEER's permission.
  - B. Backfill: Common fill, APWA Section 31 05 13. Maximum particle size 2-inches.
  - C. Provide agency approved wye or tee with appropriate donut.
  - D. Stainless steel straps required.
3. EXECUTION
  - A. Tape wrap pipe as required by soil conditions.
  - B. Remove core plug from sewer main. Do not break into sewer main to make connection.
  - C. Base Course and Backfill Placement: Maximum lift thickness is 8-inches before compaction. Compaction is 95 percent or greater relative to a standard proctor density, APWA Section 31 23 26.

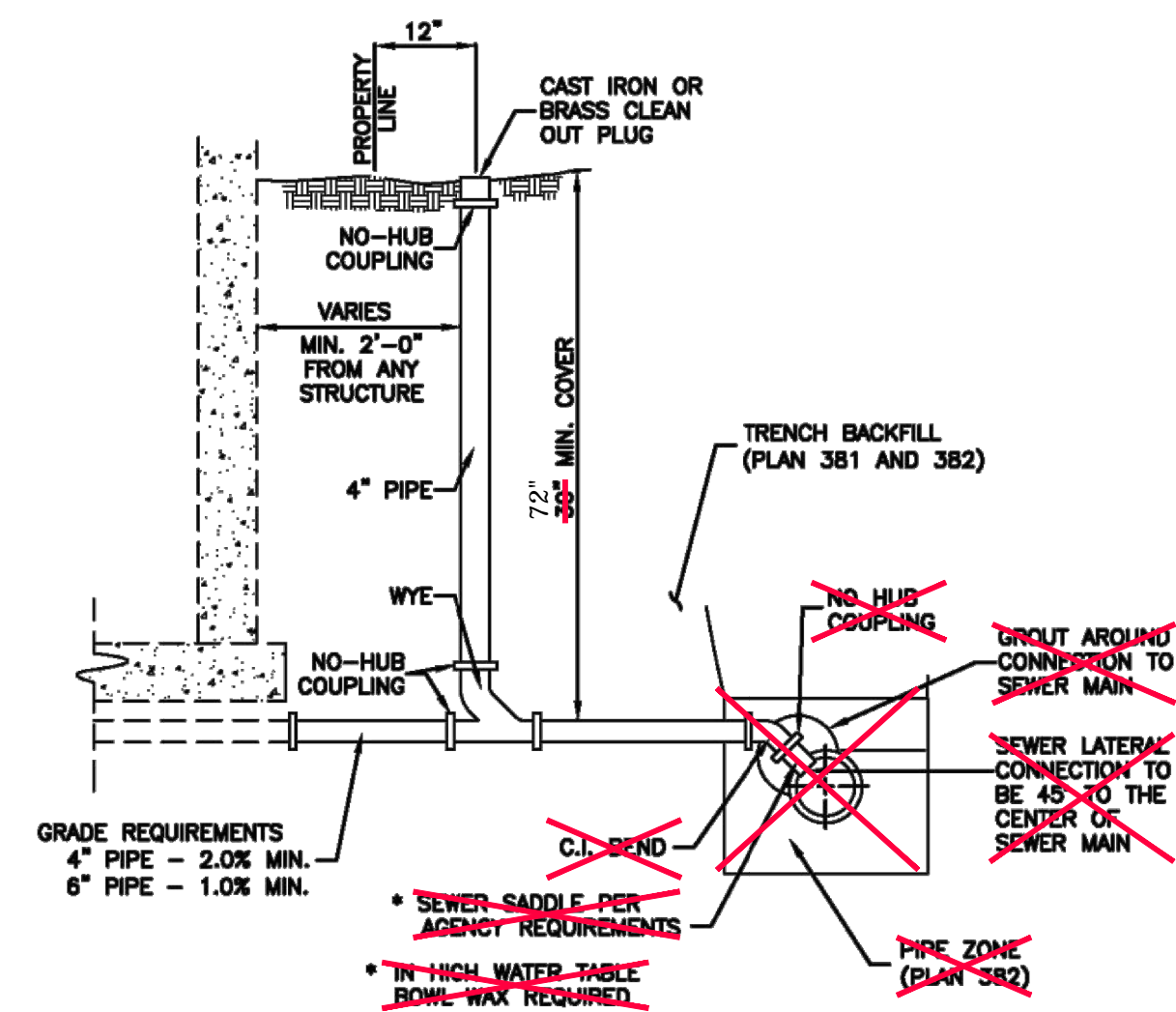

Sewer lateral connection

Plan 431

3/4" and 1" meter

1. GENERAL
  - A. In street surfaces or other vehicular traffic areas (like driveway approaches), install the same type of meter box as required for 1 1/2" and 2" service meters. See Plan 522.
  - B. Before backfilling, secure inspection of installation by ENGINEER.
2. PRODUCTS
  - A. Base Course: Untreated base course, APWA Section 32 11 23. Do not use gravel as a base course without ENGINEER's permission.
  - B. Backfill: Common fill, APWA Section 31 05 13. Maximum particle size 2-inches.
  - C. Castings: Grey iron class 35 minimum per ASTM A 48, coated with asphalt based paint or better.
3. EXECUTION
  - A. Meter Placement:
    - 1) All meters are to be installed in the park strip or within 7 feet of the property line (street side).
    - 2) Do not install meters under driveway approaches, sidewalks, or curb and gutter.
  - B. Meter Box: Set box so grade of the frame and cover matches the grade of the surrounding surface.
  - C. Pipe Outside of Right-of-Way: Coordinate with utility agency or adjacent property owner for type of pipe to be used outside of right-of-way.
  - D. Inspection: Before backfilling around meter box, secure inspection of installation by ENGINEER.
  - E. Base Course and Backfill Placement: Compaction is 95 percent or greater relative to a modified proctor density, APWA Section 31 23 26. Maximum lift thickness before compaction is 8-inches.

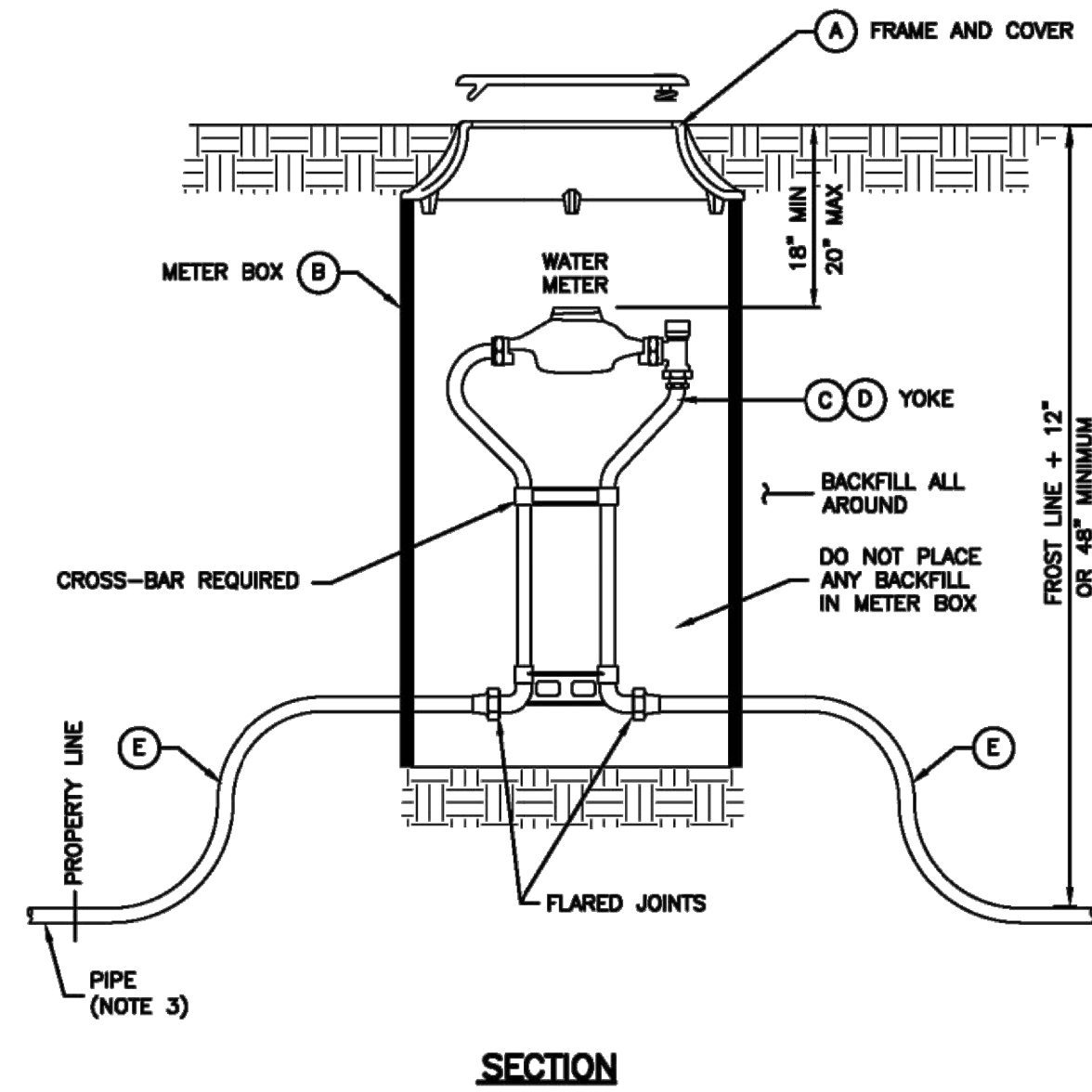

SECTION

No.	* ITEM	DESCRIPTION
A	FRAME AND COVER	CAST IRON COVER (grass) DUCTILE IRON COVER (driveway)
B	METER BOX (18" TO 21" DIAMETER) (30" TO 36" DEEP)	CORRUGATED PE, PVC, CMP OR MATERIAL ACCEPTABLE TO AGENCY
C	3/4" METER YOKE	OPTIONAL BACKFLOW PROTECTION PER AGENCY REQUIREMENTS
D	1" METER YOKE	OPTIONAL BACKFLOW PROTECTION PER AGENCY REQUIREMENTS
E	COPPER PIPE	TYPE K (SOFT)

\* FURNISHED BY UTILITY AGENCY

3/4" and 1" meter

Plan 521

Cover collar for water valve box

1. GENERAL
  - A. In a pavement surface, fill an annular space around a frame and cover casting with concrete. The concrete will support the casting under traffic loadings.
2. PRODUCTS
  - A. Base Course: Untreated base course, APWA Section 32 11 23. Do not use gravel as a base course without ENGINEER's permission.
  - B. Concrete: Class 4000, APWA Section 03 30 04.
  - C. Concrete Curing Agent: Type ID Class A (clear with fugitive dye), membrane forming compound, APWA Section 03 39 00.
3. EXECUTION
  - A. Base Course: Maximum lift thickness is 8-inches before compaction. Compaction is 95 percent or greater relative to a modified proctor density, APWA Section 31 23 26.
  - B. Pavement Preparation: Provide a neat vertical and concentric joint between concrete collar and existing asphalt concrete surface. Clean edges of all dirt, oil, and loose debris.

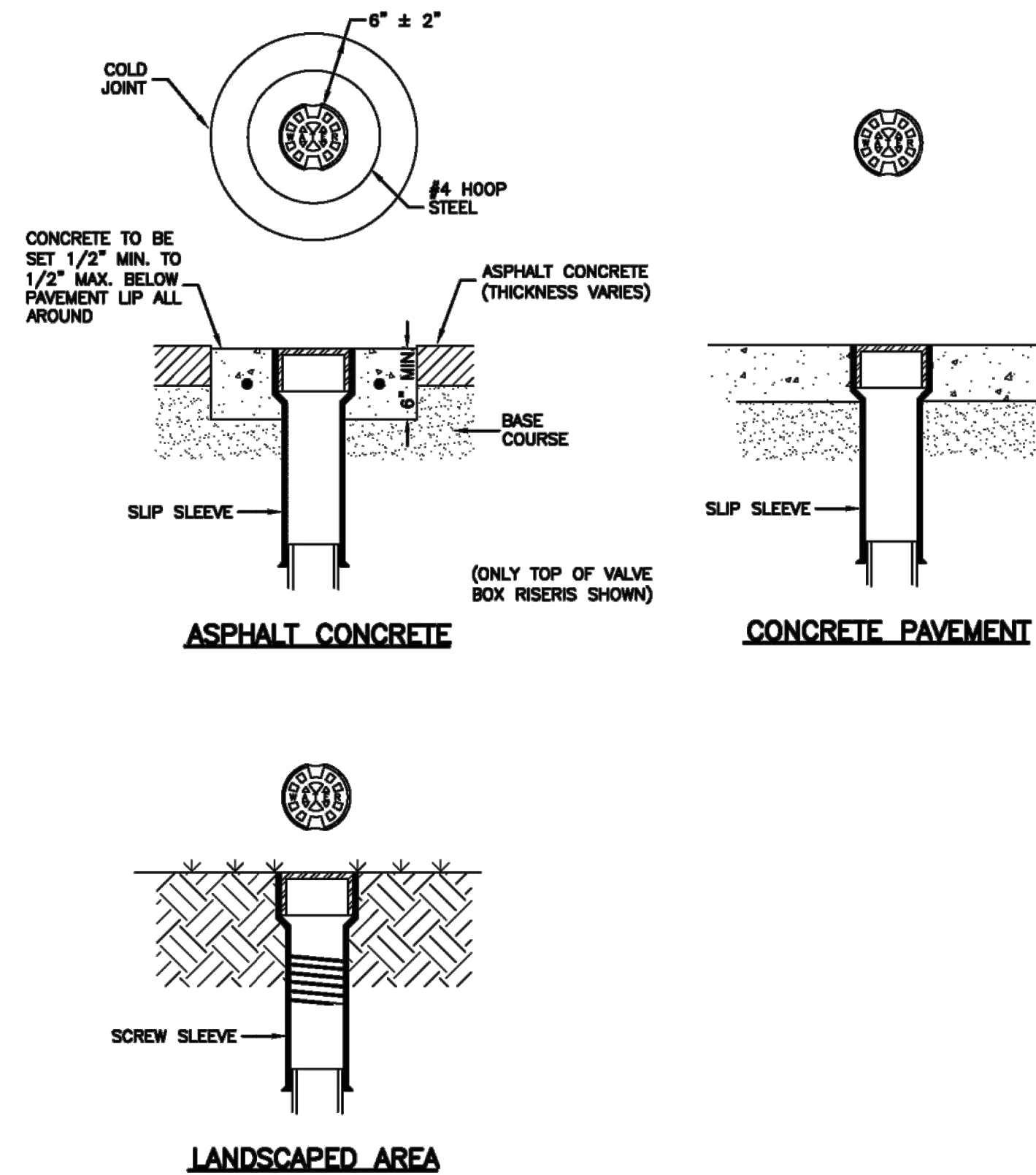

Cover collar for water valve box

Plan 574

DATE: 4/12/2018 5:59 PM PATH: m:\SIB0793\Cadd\18-009-powder mountain lot 44r\IP\701 DETAILS.dwg

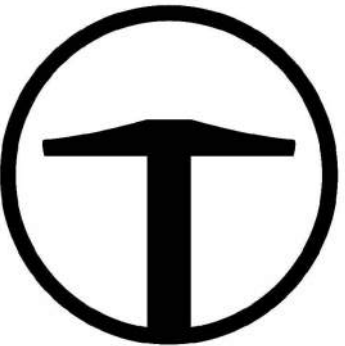

**TALISMAN**  
CIVIL CONSULTANTS  
5217 SOUTH STATE STREET  
SUITE 200  
MURRAY, UT 84107  
801.743.1500

NO.	BY	DATE	REVISIONS

POWDER MOUNTAIN LOT 44R

DETAILS

DATE SUBMITTED: 04.16.2018

TCC JOB NUMBER: 18-009

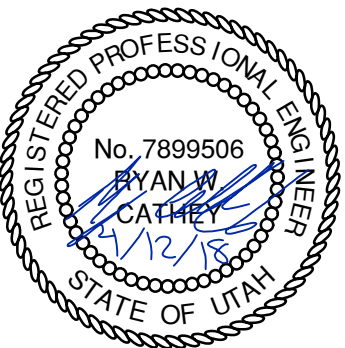

SHEET NUMBER

701

9 OF 11

DATE: 4/12/2018 6:59 PM

PATH: n:\S\B0793\Cadd\18-009-powder mountain lot 44r\18-009-powder mountain lot 44r\18-009-powder mountain lot 44r.dwg

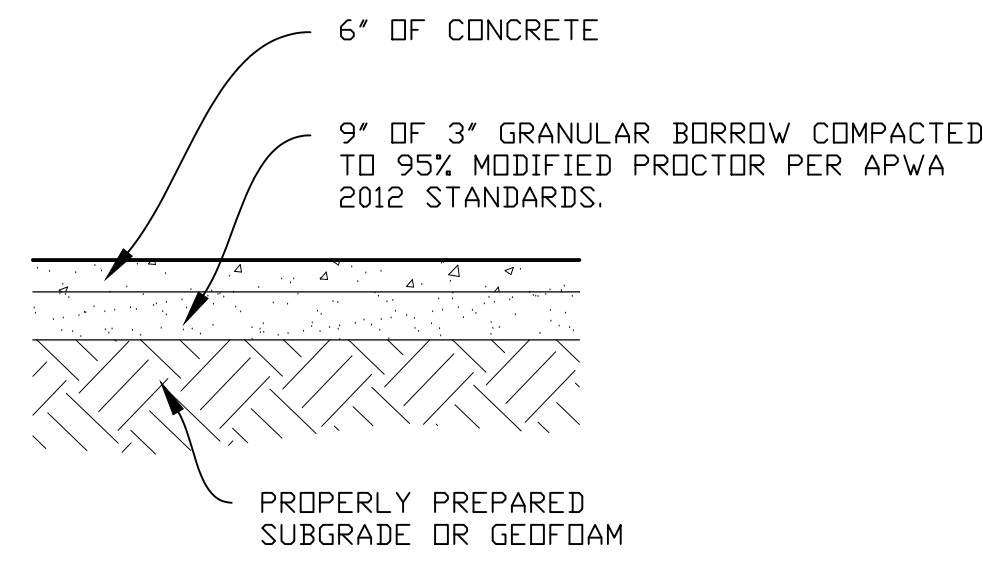

**C** CONCRETE DRIVEWAY PAVEMENT SECTION  
N.T.S.

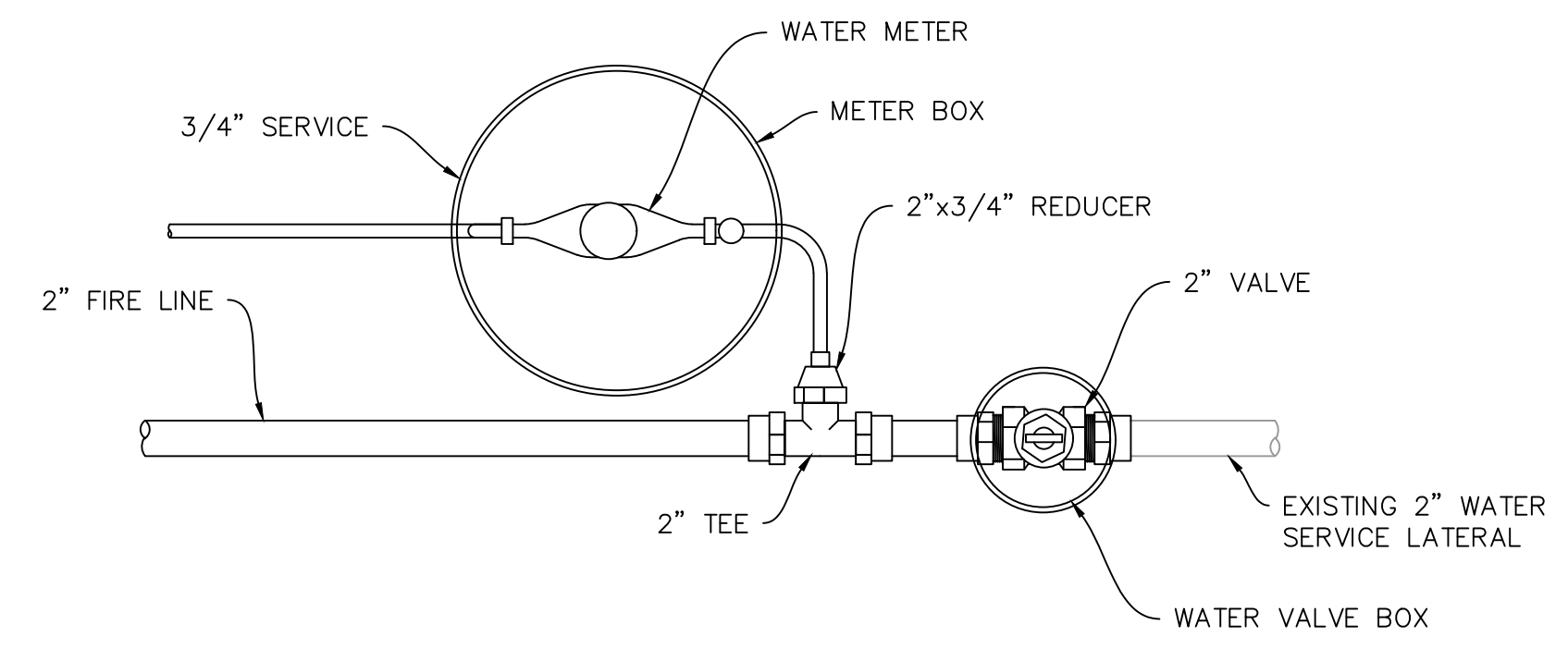

**PLAN**

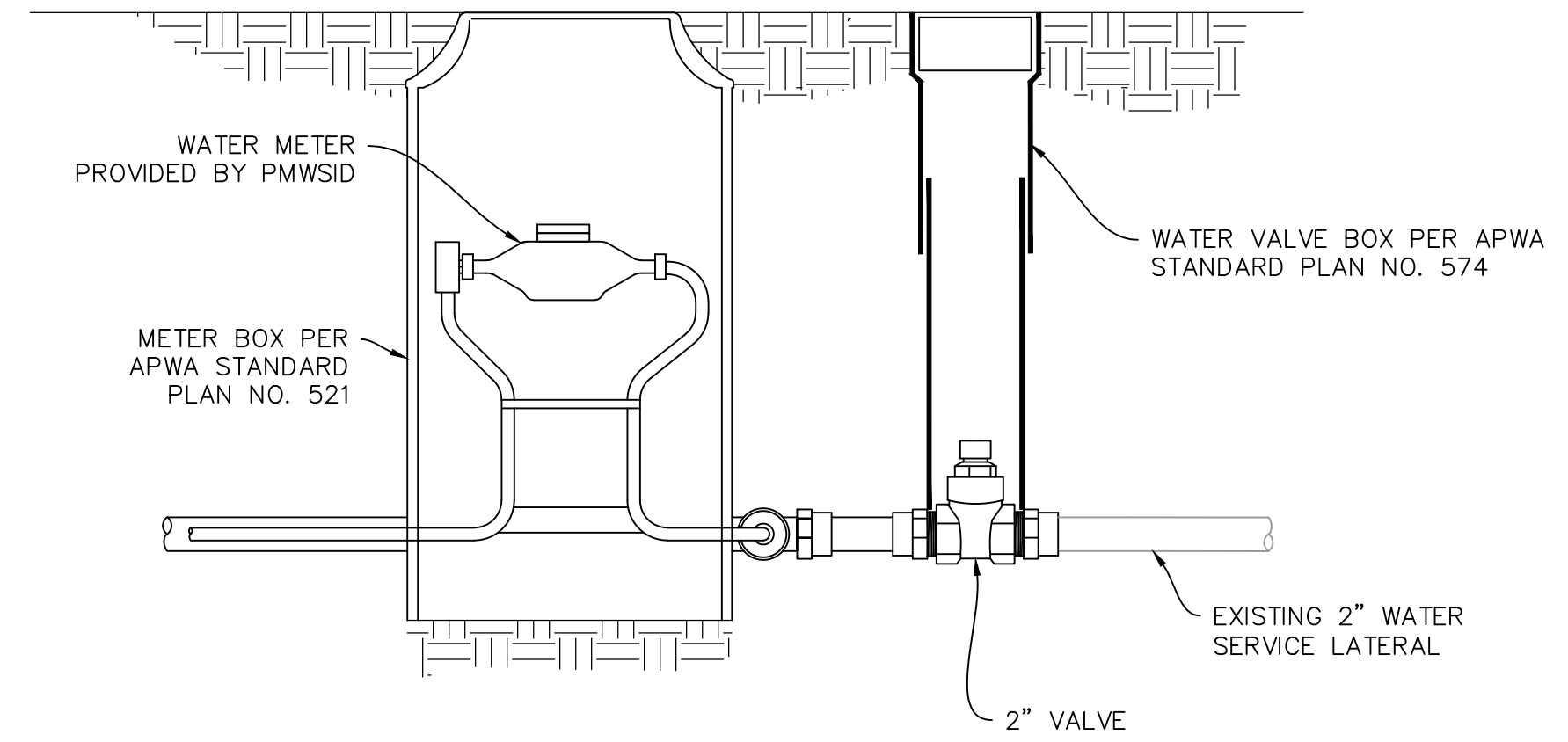

**SECTION**

**A** FIRE LINE AND WATER METER DETAIL  
SCALE: N.T.S.

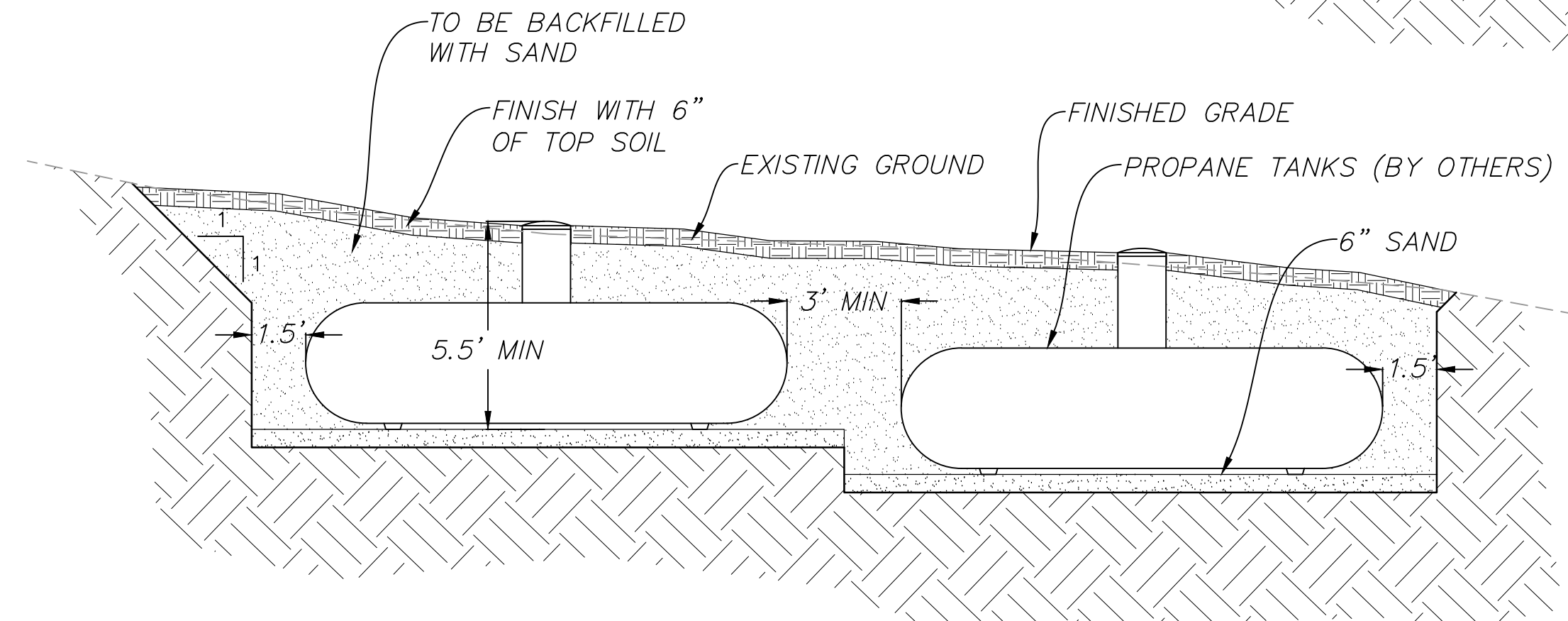
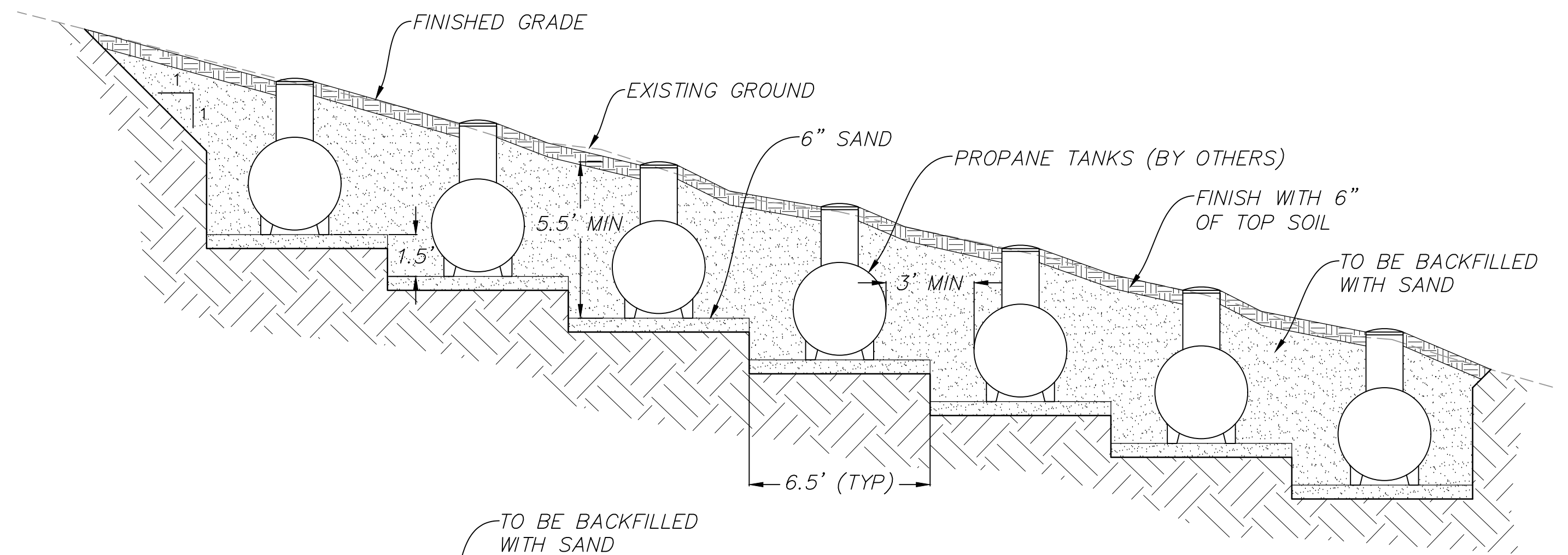

**B** PROPANE TANK PIT TYPICAL DETAIL  
SCALE: N.T.S.

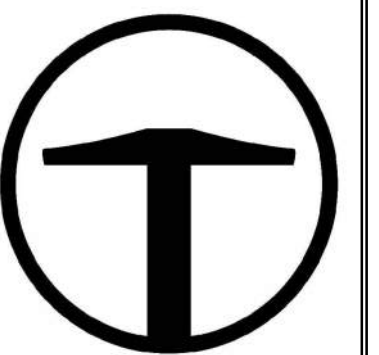

**TALISMAN**  
CIVIL CONSULTANTS  
5217 SOUTH STATE STREET  
SUITE 200  
MURRAY, UT 84107  
801.743.1300

NO.	BY	DATE	REVISIONS

**POWDER MOUNTAIN LOT 44R**  
**DETAILS**

DATE SUBMITTED: 04.16.2018

TCC JOB NUMBER: 18-009

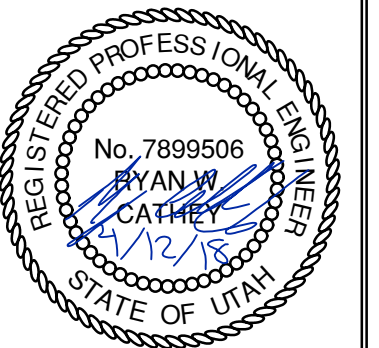

DATE: 4/12/2018 5:59 PM

NO.	BY	DATE	REVISIONS

DATE SUBMITTED: 04.16.2018

**POWDER MOUNTAIN LOT 44R**  
**DETAILS**

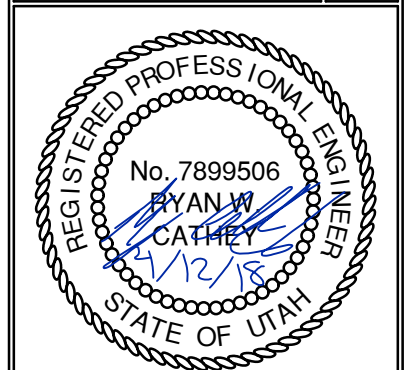

TCC JOB NUMBER: 18-009

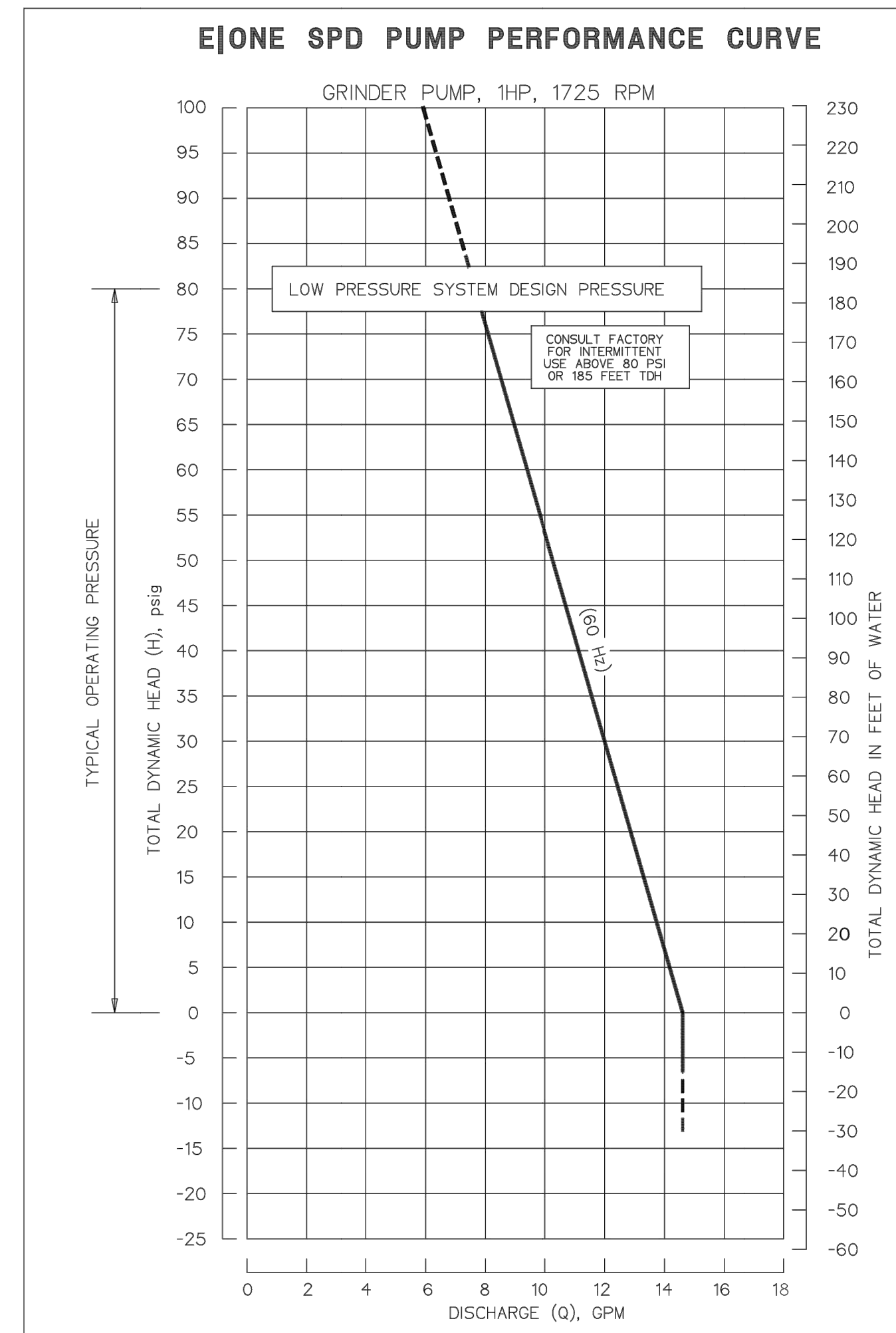

ESD 08-0022 REV. 2, 6/08

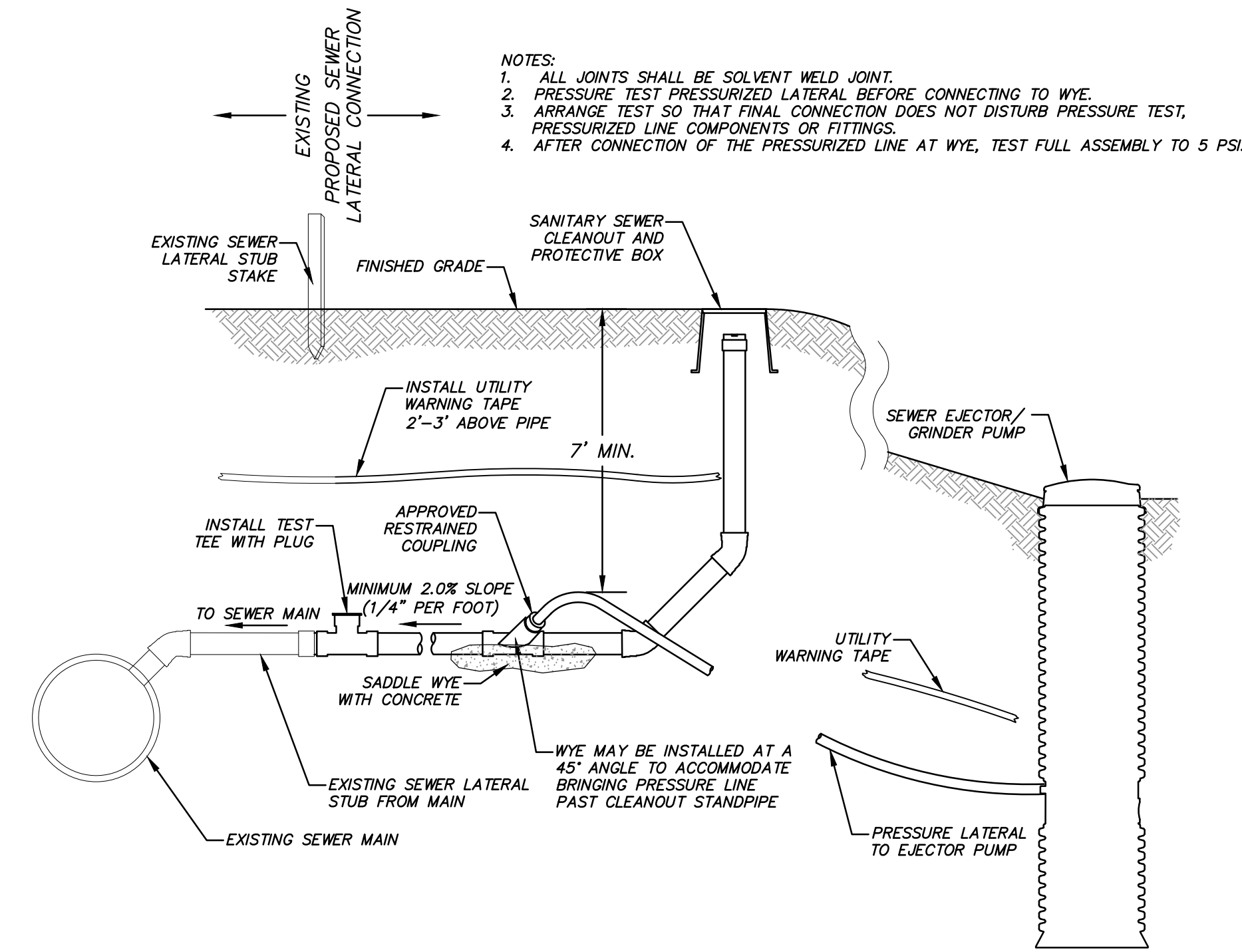
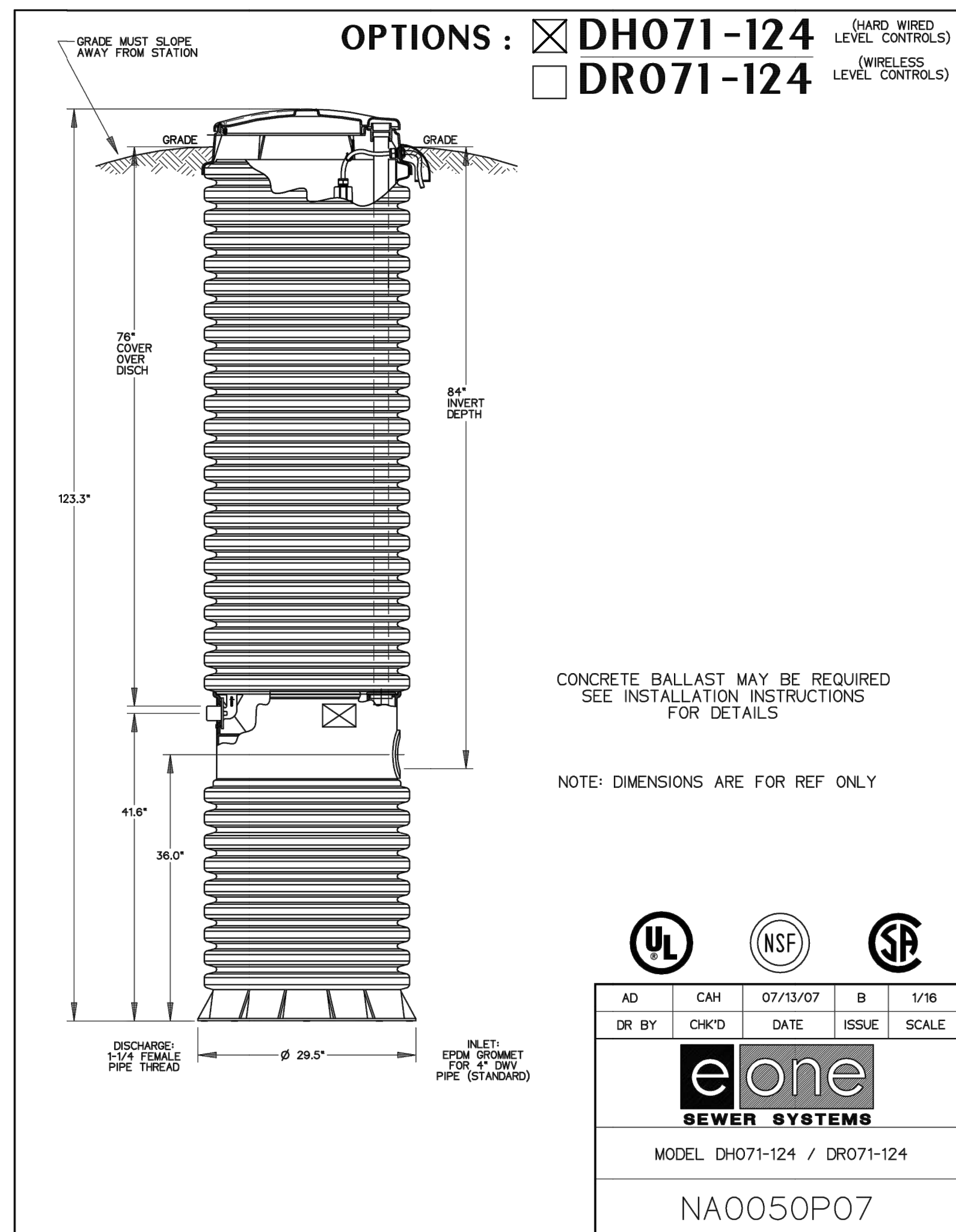
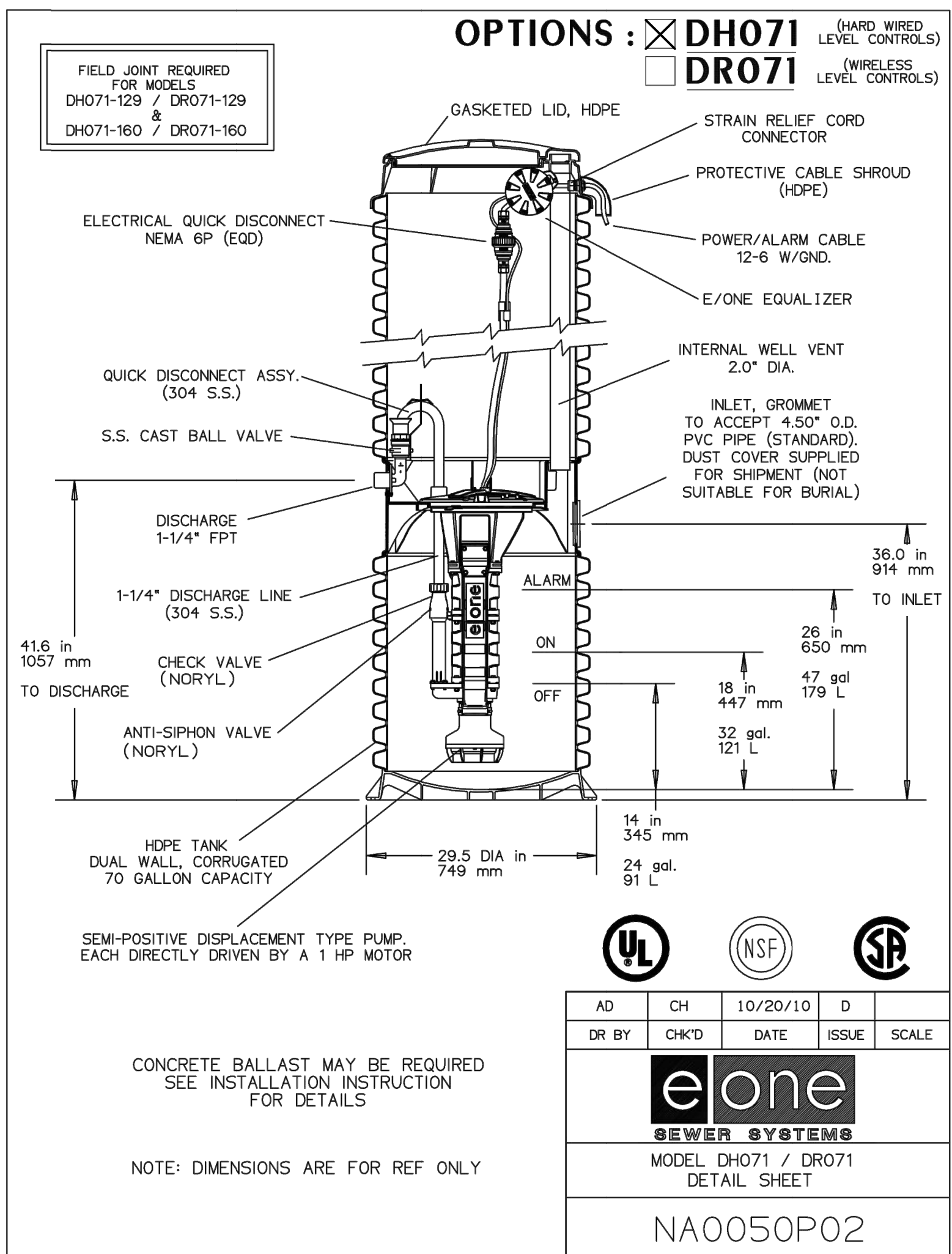

**A GRINDER PUMP STATION DETAIL**  
SCALE: N.T.S.

**B SEWER LATERAL CONNECTION**  
SCALE: N.T.S.



PATH: n:\SIB0793\Cadd\18-009-powder mountain lot 44r\IP\703 DETAIL.Swg