

DEVELOPMENT DATA

Project Area	13.08 Acres
Proposed Uses	5,300 sf Commercial 12,672 sf Storage Barns 3 - 3 Plex Cottages 8 - Duplex Cottages 28 - Single Family Cottages 4 Stall Condo Garage
Parking	
Residential Garage Stalls	107
Residential Surface Stalls	60
Trailer Stalls	10
Commercial Stalls	18
Total Stalls	195
Open Space	6.54 Acres (50%)

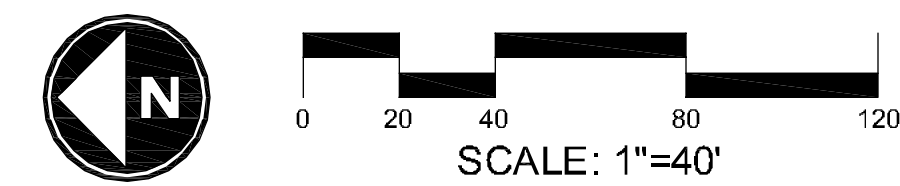

THIS DOCUMENT IS THE PROPERTY OF BERTOLDI ARCHITECTS © 2012

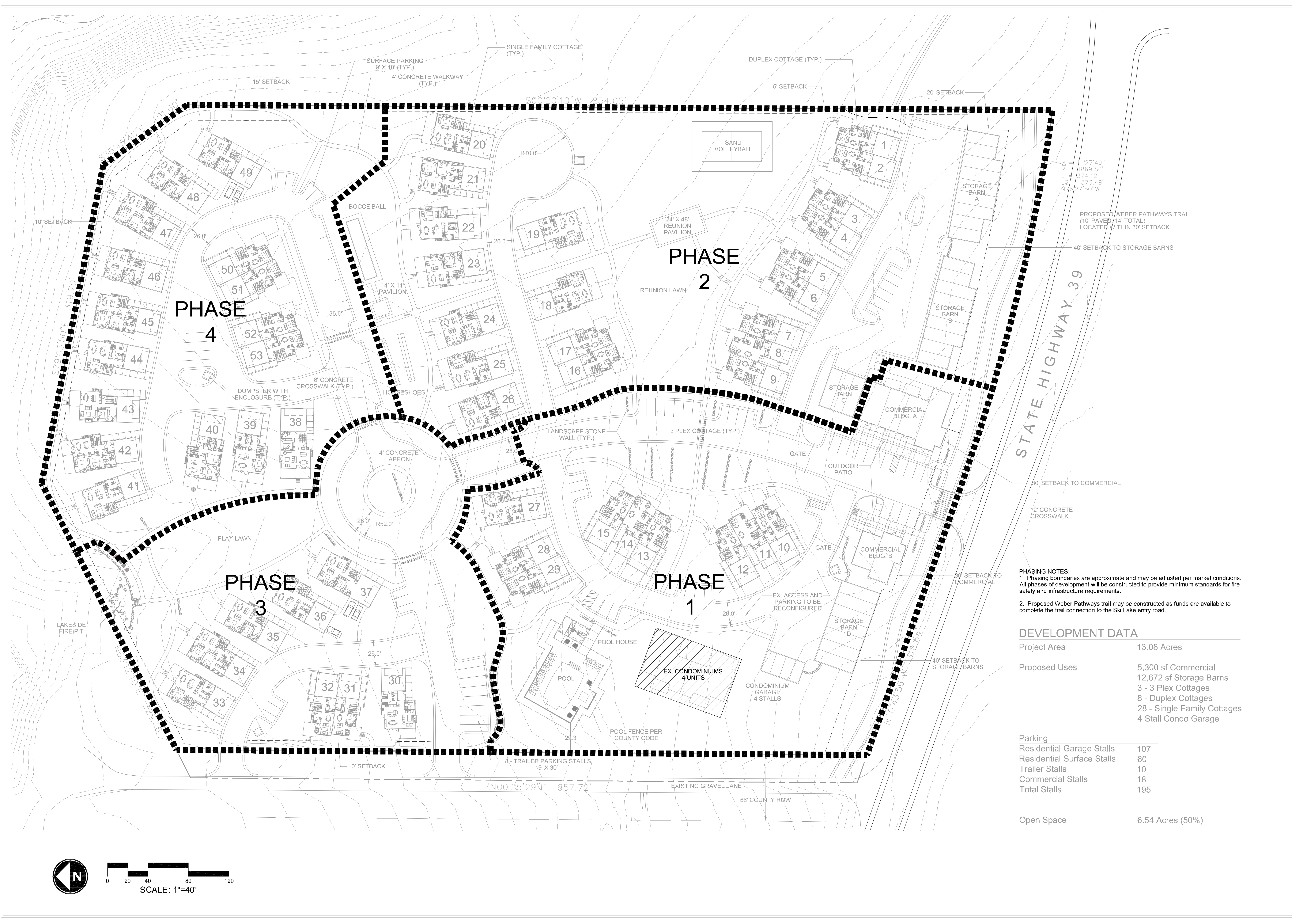

1'27.49"
 1869.86'
 374.12'
 LC = 373.49'
 R = 627.50' W

PROPOSED WEBER PATHWAYS TRAIL
 (10' PAVED, 14' TOTAL)
 LOCATED WITHIN 30' SETBACK

40' SETBACK TO STORAGE BARN

STATE HIGHWAY 39

80' SETBACK TO COMMERCIAL

12' CONCRETE CROSSWALK

PHASING NOTES:
 1. Phasing boundaries are approximate and may be adjusted per market conditions. All phases of development will be constructed to provide minimum standards for fire safety and infrastructure requirements.
 2. Proposed Weber Pathways trail may be constructed as funds are available to complete the trail connection to the Ski Lake entry road.

DEVELOPMENT DATA

Project Area	13.08 Acres
Proposed Uses	5,300 sf Commercial 12,672 sf Storage Barns 3 - 3 Plex Cottages 8 - Duplex Cottages 28 - Single Family Cottages 4 Stall Condo Garage
Parking	Residential Garage Stalls 107 Residential Surface Stalls 60 Trailer Stalls 10 Commercial Stalls 18 Total Stalls 195
Open Space	6.54 Acres (50%)

THIS DOCUMENT IS THE PROPERTY OF BERTOLDI ARCHITECTS © 2012

