



# Land Use Permit

## Weber County Planning Commission

2380 Washington Blvd. STE 240  
Ogden, UT 84401  
Phone: (801) 399-8791 FAX: (801) 399-8862  
webercountyutah.gov/planning

**Permit Number: LUP217-2017**

Permit Type: Structure  
Permit Date: 07/21/2017

### Applicant

**Name:** Kathleen Williams  
**Business:**  
**Address:** 6381 S. Raymond Dr.  
South Weber, UT 84405  
**Phone:** 801-540-7880

### Owner

**Name:**  
**Business:**  
**Address:** , UT  
**Phone:**

### Parcel

**Parcel:** 230710004  
**Zoning:** F-10 **Area:** 2.17 **Sq Ft:** **Lot(s):** 63 **Subdivision:** Sunridge Highlands #1  
**Address:** 11312 E JIM BRIDGER DR HUNTSVILLE, UT 84317 **T - R - S - QS:** 8N - 2E - 36 -

### Proposal

**Proposed Structure:** Shed **Building Footprint:** 192  
**Proposed Structure Height:** 13 **Max Structure Height in Zone:** 25  
**# of Dwelling Units:** **# of Accessory Bldgs:**  
**# Off Street Parking Reqd:** **\*Is Structure > 1,000 Sq. Ft?** N/A  
**\*If True Need Certif. Statement**

### Permit Checklist

**Access Type:** Front Lot Line **Alternative Access File #**  
**Greater than 4218 ft above sea level?** N/A **Wetlands/Flood Zone?** N/A  
**Additional Setback Reqd. ?** N/A **Meet Zone Area Frontage?** N/A  
**> 200 ft from paved Road?** N/A **Hillside Review Reqd?** N/A  
**Culinary Water District:** **Waste Water System:**

### Comments

Proposed structure meets setback requirements, according to site plan submitted with application. Size and height of proposed structure also meet requirements within the F-10 zone, according to Land Use Code: 104-9-4.



# Land Use Permit

## Structure Setback Graphic: Storage Shed, Detached Garage, Etc.

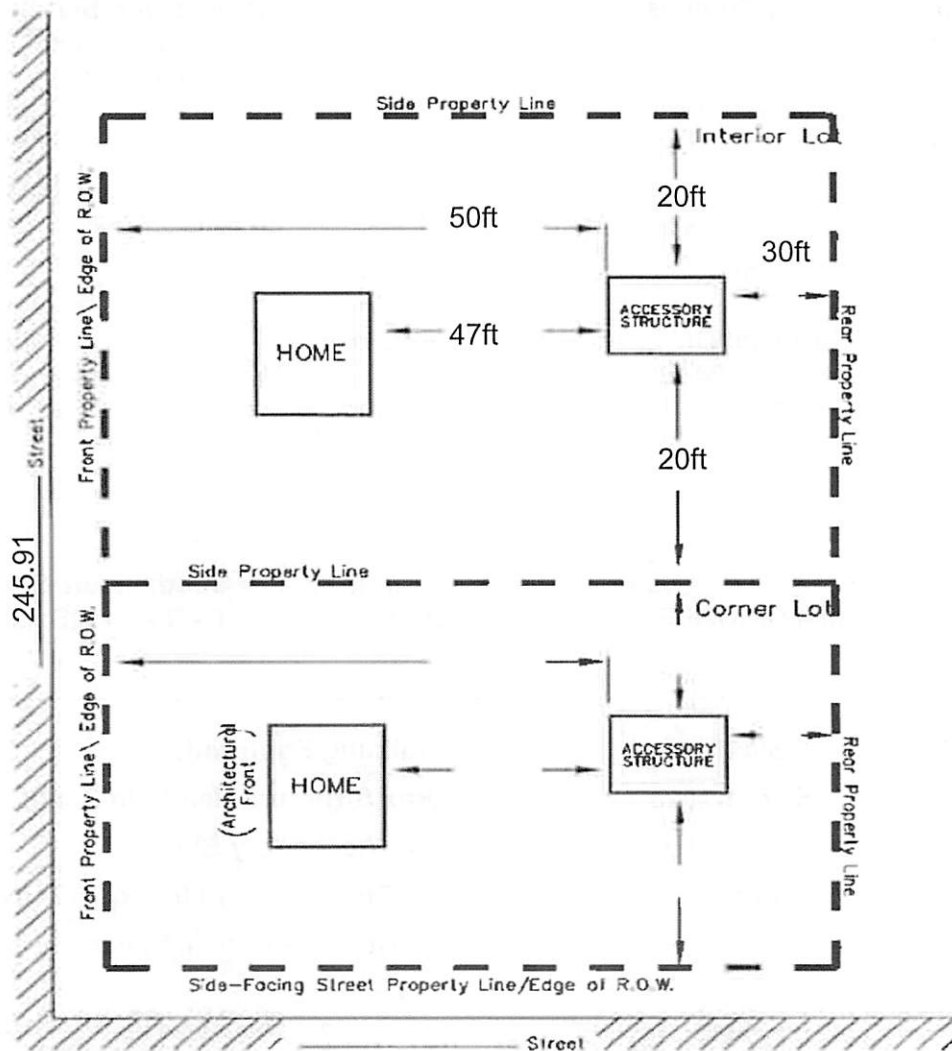

## MINIMUM YARD SETBACKS Storage Shed, Detached Garage, Etc.

### NOTICE FOR APPLICANT (Please Read Before Signing)

Proposals for the installation of an individual water supply and for a sanitary waste disposal system (septic tank) for any structure designed for human occupation must be approved by Weber County Health Department prior to installation.

Tammy Aydelotte

07/21/2017

Planning Dept. Signature of Approval

Date

I hereby certify that I have read and examined this application and know the same to be true and correct. All provisions of laws and ordinances governing this land use will be complied with whether specified herein or not. I make this statement under penalty of perjury.

Contractor/Owner Signature of Approval

Date

# Weber County Land Use Permit Application

**Application submittals are recommended to be submitted with an appointment.  
(801) 399-8791. 2380 Washington Blvd. Suite 240, Ogden, UT 84401**

Date Submitted / Completed	Fees (Office Use)	Receipt Number (Office Use)
----------------------------	-------------------	-----------------------------

## Property Owner Contact Information

Name Kathleen Williams		Mailing Address 6381 S. Raymond Dr. South Weber, Utah 84405	
Phone 801- 540-7880 <i>17899</i>	Fax		
Email Address wkathleenw@outlook.com		Preferred Method of Written Correspondence <input checked="" type="checkbox"/> Email <input type="checkbox"/> Fax <input type="checkbox"/> Mail	

## Authorized Representative Contact Information

Name of Person Authorized to Represent the Property Owner(s)		Mailing Address of Authorized Person	
Phone	Fax		
Email Address		Preferred Method of Written Correspondence <input type="checkbox"/> Email <input type="checkbox"/> Fax <input type="checkbox"/> Mail	

## Property Information

Address 11312 Jim Bridger Dr Huntsville, Ut 84317		Land Serial Number(s) Parcel Number: 230710004	
Subdivision Name Sunridge Highlands # 1	Lot Number 63	Current Zoning F-10	Acreage 2.17
Culinary Water Provider <i>Sunridge</i>	Secondary Water Provider none	Waste Water Provider	Frontage 245'

Detailed Description of Proposed Use/Structure  
Storage Shed: 16 X 12 x 13  
See attached diagrams

## Property Owner Affidavit

I (We), \_\_\_\_\_, depose and say that I (we) am (are) the owner(s) of the property identified in this application and that the statements herein contained, the information provided in the attached plans and other exhibits are in all respects true and correct to the best of my (our) knowledge.

*Kathleen Williams*  
\_\_\_\_\_  
(Property Owner)

\_\_\_\_\_  
(Property Owner)

Subscribed and sworn to me this *21* day of *July*, 20 *17*.



*[Signature]*  
\_\_\_\_\_  
(Notary)

**Authorized Representative Affidavit**

I (We), \_\_\_\_\_, the owner(s) of the real property described in the attached application, do authorized as my (our) representative(s), \_\_\_\_\_, to represent me (us) regarding the attached application and to appear on my (our) behalf before any administrative or legislative body in the County considering this application and to act in all respects as our agent in matters pertaining to the attached application.

\_\_\_\_\_  
(Property Owner)

\_\_\_\_\_  
(Property Owner)

Dated this \_\_\_\_\_ day of \_\_\_\_\_, 20 \_\_\_\_\_, personally appeared before me \_\_\_\_\_, the signer(s) of the Representative Authorization Affidavit who duly acknowledged to me that they executed the same.

\_\_\_\_\_  
(Notary)

## Aydelotte, Tamara

---

**From:** Kathy Williams <WkathleenW@outlook.com>  
**Sent:** Friday, July 21, 2017 9:47 AM  
**To:** Aydelotte, Tamara  
**Subject:** FW: Land Use Permit Approval

Tammy,

This is an email from Roger Colvin on the board of the Sunridge Property Owners Association giving us permission to build the shed. If there is a problem, please let me know. Larry's Cell phone number 801-510-2105.

Larry and Kathleen Williams  
Lot H 63 in the Sunridge Highlands.  
Thank you,  
Sent from [Mail](#) for Windows 10

**From:** [Roger Colvin](#)  
**Sent:** Friday, July 21, 2017 9:37 AM  
**To:** [Kathy Williams](#)  
**Subject:** Re: Land Use Permit Approval

Kathy,

I examined the placement of the shed and it is in accordance with Sunridge regulations. You have permission from the board to receive the Land Use Permit and to begin construction on the shed.

Roger Colvin  
Compliance officer Sunridge Board

Sent from my iPad

On Jul 21, 2017, at 9:05 AM, Kathy Williams <[WkathleenW@outlook.com](mailto:WkathleenW@outlook.com)> wrote:

Roger Colvin  
Sunridge Property Owners Association Board Member  
801-389-1780

Roger,

I applied for a land use permit through Weber County Planning Division for the 12 X 16 storage. I was told that I need written permission from the Sunridge Property Owners Association for them to issue the permit.

You inspected the property in the Sunridge Highlands lot H-63, and gave us permission. Could you please email written permission from the board that I can send to Weber County Planning Division.

Thank you,

Kathy Williams



**Weber County Corporation**

Weber County  
2380 Washington Blvd  
Ogden UT 84401

Customer Receipt	
Receipt Number	50044

Receipt Date
07/21/17

Received From:  
CUSTOMER

Time: 08:18  
Clerk: tbennett

Description	Comment	Amount
Land Use Permit	Land Use Permit	\$60.00

Payment Type	Quantity	Ref	Amount
CREDIT CARD			

AMT TENDERED:	\$60.00
AMT APPLIED:	\$60.00
CHANGE:	\$0.00