



Land Use Permit

Weber County Planning Commission

2380 Washington Blvd. STE 240

Ogden, UT 84401

Phone: (801) 399-8791 FAX: (801) 399-8862

webercountyutah.gov/planning

Permit Number: LUP244-2017

Permit Type: Structure

Permit Date: 08/02/2017

Applicant

Owner

Name: Brent Call
Business:
Address:
, UT
Phone: 801-336-8982

Name: Brent Call
Business:
Address: 2732 N Highway 39
Huntsville, UT 84317
Phone: 801-339-8982

Parcel

Parcel: 230130010

Zoning: F-40 **Area:** 5017.79Sq Ft:

Lot(s): 7

Subdivision: Sourdough/Coyote

Address: 3465 N HWY 39 HUNTSVILLE, UT 84317

T - R - S - QS: 7N - 3E - 08 -

Proposal

Proposed Structure: Small Shed

Building Footprint: 100

Proposed Structure Height: 14

Max Structure Height in Zone: 25

of Dwelling Units: 0

of Accessory Bldgs: 1

Off Street Parking Reqd:

***Is Structure > 1,000 Sq. Ft?** N/A

*If True Need Certif. Statement

Permit Checklist

Access Type: Private Own Front

Alternative Access File #

Greater than 4218 ft above sea level? Yes

Wetlands/Flood Zone? No

Additional Setback Reqd. ? No

Meet Zone Area Frontage? Yes

> 200 ft from paved Road? Yes

Hillside Review Reqd? No

Culinary Water District:

Waste Water System:

Comments

Land use requirements have been met for this small shed located on camp site 7 of the Coyote area. The applicant has provided an approval letter from the Sourdough Board.

Land Use Permit

Structure Setback Graphic: Storage Shed, Detached Garage, Etc.

See additional notes in the comments section

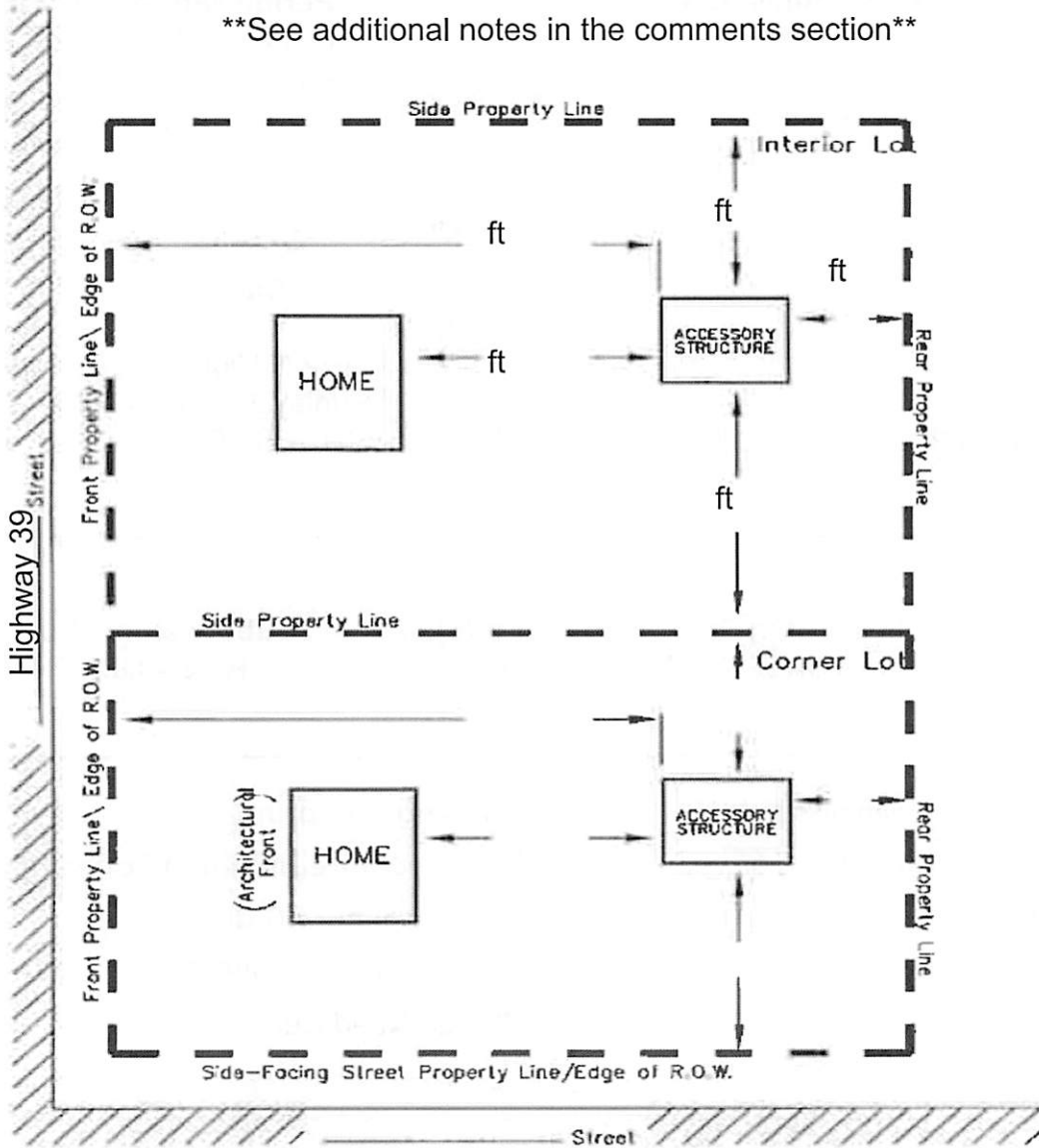

MINIMUM YARD SETBACKS Storage Shed, Detached Garage, Etc.

NOTICE FOR APPLICANT (Please Read Before Signing)

Proposals for the installation of an individual water supply and for a sanitary waste disposal system (septic tank) for any structure designed for human occupation must be approved by Weber County Health Department prior to installation.

Felix Lleverino

08/02/2017

Planning Dept. Signature of Approval

Date

I hereby certify that I have read and examined this application and know the same to be true and correct. All provisions of laws and ordinances governing this land use will be complied with whether specified herein or not. I make this statement under penalty of perjury.

Burt J. Coe

8/2/17

Contractor/Owner Signature of Approval

Date

Weber County Land Use Permit Application

Application submittals are recommended to be submitted with an appointment.
(801) 399-8791. 2380 Washington Blvd. Suite 240, Ogden, UT 84401

Date Submitted / Completed

Fees (Office Use)

Receipt Number (Office Use)

Property Owner Contact Information

Name

SOURDOUGH WILDERNESS RANCH

Mailing Address

5523 S 1900 W STE 9
ROY UT 84067

Phone

801-773-3348

Fax

Email Address

SOURDOUGHRANCH@GMAIL.COM

Preferred Method of Written Correspondence

Email Fax Mail

Authorized Representative Contact Information

Name of Person Authorized to Represent the Property Owner(s)

Brent Call

Mailing Address of Authorized Person

Phone

801-336-8982

Fax

Email Address

Preferred Method of Written Correspondence

Email Fax Mail

Property Information

Address

2732 N HIGHWAY 39
HUNTSVILLE UT 84317

Land Serial Number(s)

23.
23-013-0010

Subdivision Name

Coyote

Lot Number

07

Current Zoning

F-40

Acreage

Culinary Water Provider

Secondary Water Provider

Waste Water Provider

Frontage

120'

Detailed Description of Proposed Use/Structure

shed up to 100 sq-ft

Property Owner Affidavit

I (We), SOURDOUGH WILDERNESS RANCH, depose and say that I (we) am (are) the owner(s) of the property identified in this application and that the statements herein contained, the information provided in the attached plans and other exhibits are in all respects true and correct to the best of my (our) knowledge.

Dany Ford / Dan / Dan
(Property Owner) TRUSTEE

Brent Call
(Property Owner) MEMBER

Subscribed and sworn to me this 2 day of Aug, 2017

Angela Mart
(Notary)

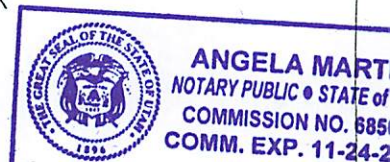



Weber County Corporation

Weber County
2380 Washington Blvd
Ogden UT 84401

Customer Receipt	
Receipt Number	51111

Receipt Date
08/02/17

Received From:
CALL

Time: 16:39
Clerk: amartin

Description	Comment	Amount
ZONING FEES	LUP	\$60.00

Payment Type	Quantity	Ref	Amount
CASH			

AMT TENDERED:	\$60.00
AMT APPLIED:	\$60.00
CHANGE:	\$0.00