

1

Basement Plan

SCALE: 1/4" = 1'-0"

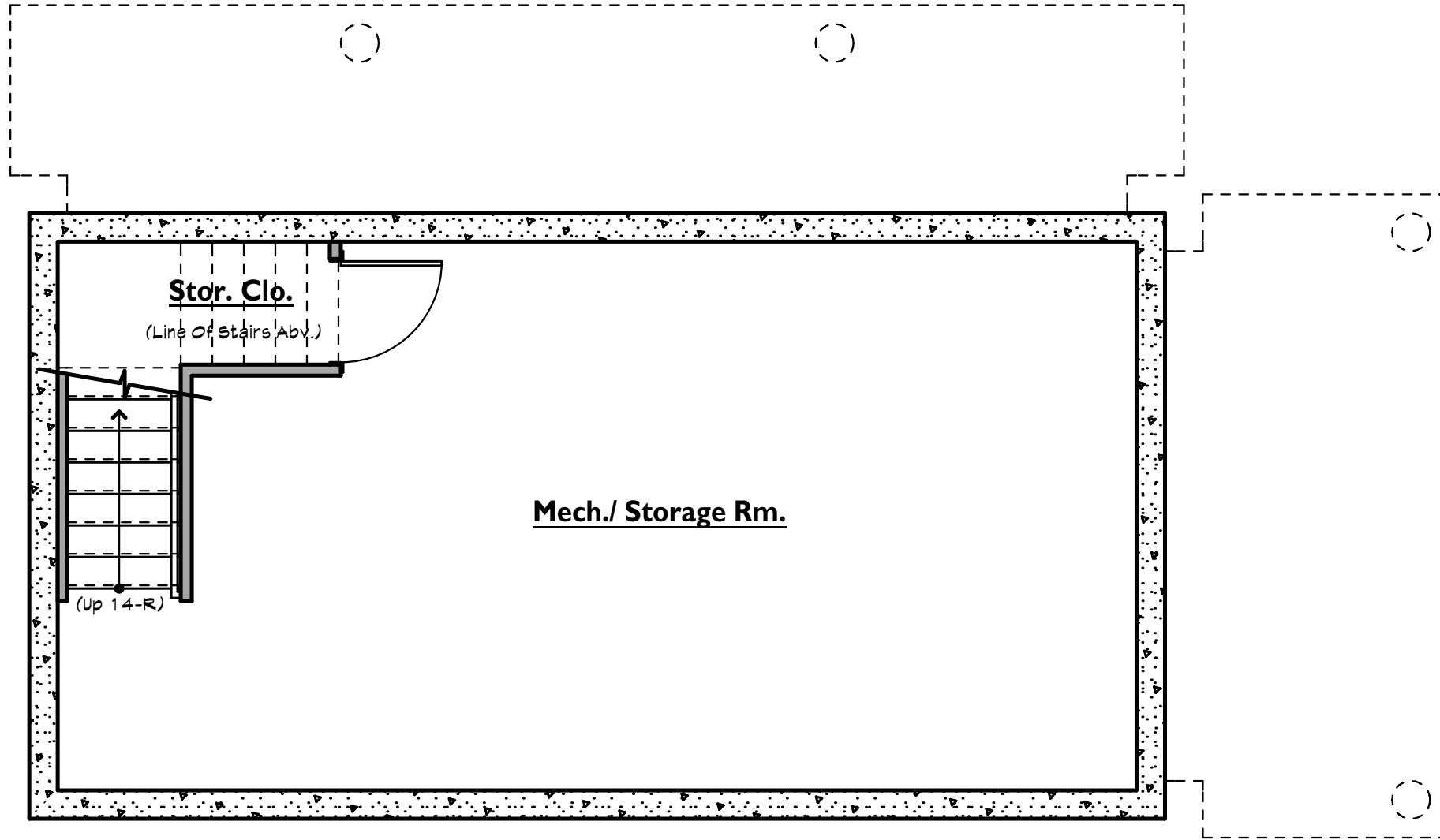

Eden Center Project

A New Development for Eric Smith
Eden, UT 84310

SHEET:

A-0

DATE: 9/29/11

EKMAN DESIGN STUDIO

A R C H I T E C T U R E

STUDIO: 303.730.2757 FAX: 303.730.2774 WEB: www.ekmandesign.com
550 EAST 8TH AVENUE DENVER, CO 80203

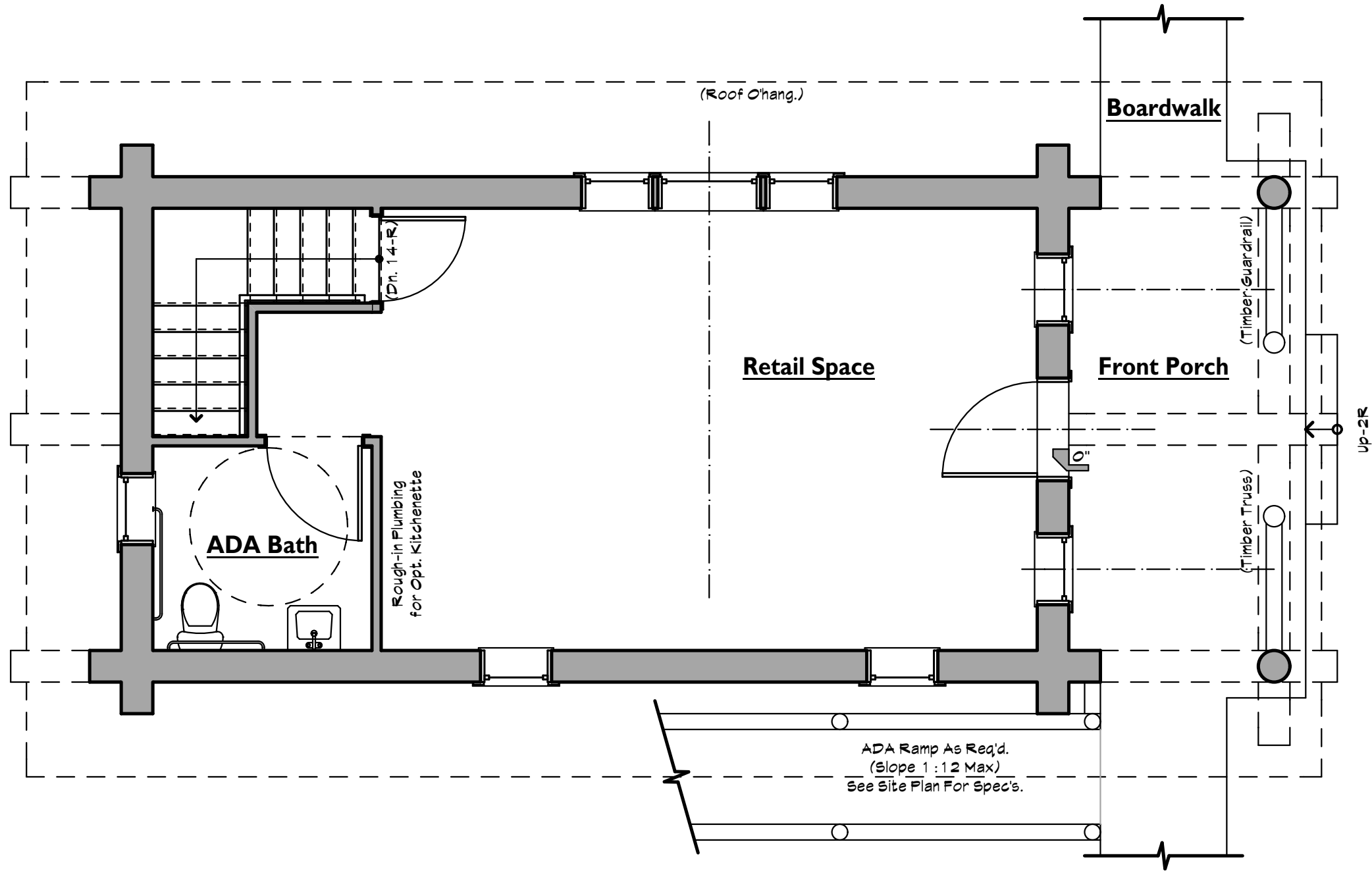

1

First Floor Plan - Front Entry

SCALE: 1/4" = 1'-0"

Eden Center Project

A New Development for Eric Smith

Eden, UT 84310

SHEET:

A-1

DATE: 9/29/11

EKMAN DESIGN STUDIO
 A R C H I T E C T U R E

STUDIO: 303.730.2757 FAX: 303.730.2774 WEB: www.ekmandesign.com
 550 EAST 8TH AVENUE DENVER, CO 80203



Front Elevation - Front Entry

EKMAN DESIGN STUDIO

A R C H I T E C T U R E

STUDIO: 303.730.2757 FAX: 303.730.2774 WEB: www.ekmandesign.com
550 EAST 8TH AVENUE DENVER, CO 80203

Eden Center Project

A New Development for Eric Smith
Eden, UT 84310

SHEET:

A-2

DATE: 9/29/11



Side Elevation - Front Entry

EKMAN DESIGN STUDIO
A R C H I T E C T U R E

STUDIO: 303.730.2757 FAX: 303.730.2774 WEB: www.ekmandesign.com
550 EAST 8TH AVENUE DENVER, CO 80203

Eden Center Project

A New Development for Eric Smith
Eden, UT 84310

SHEET:
A-3
DATE: 9/29/11
© 2011 Ekman Design Studio

Eden Center.pln: A-3 Side Elevation 01 printed by sysadmin at 5:05 PM on 9/29/11

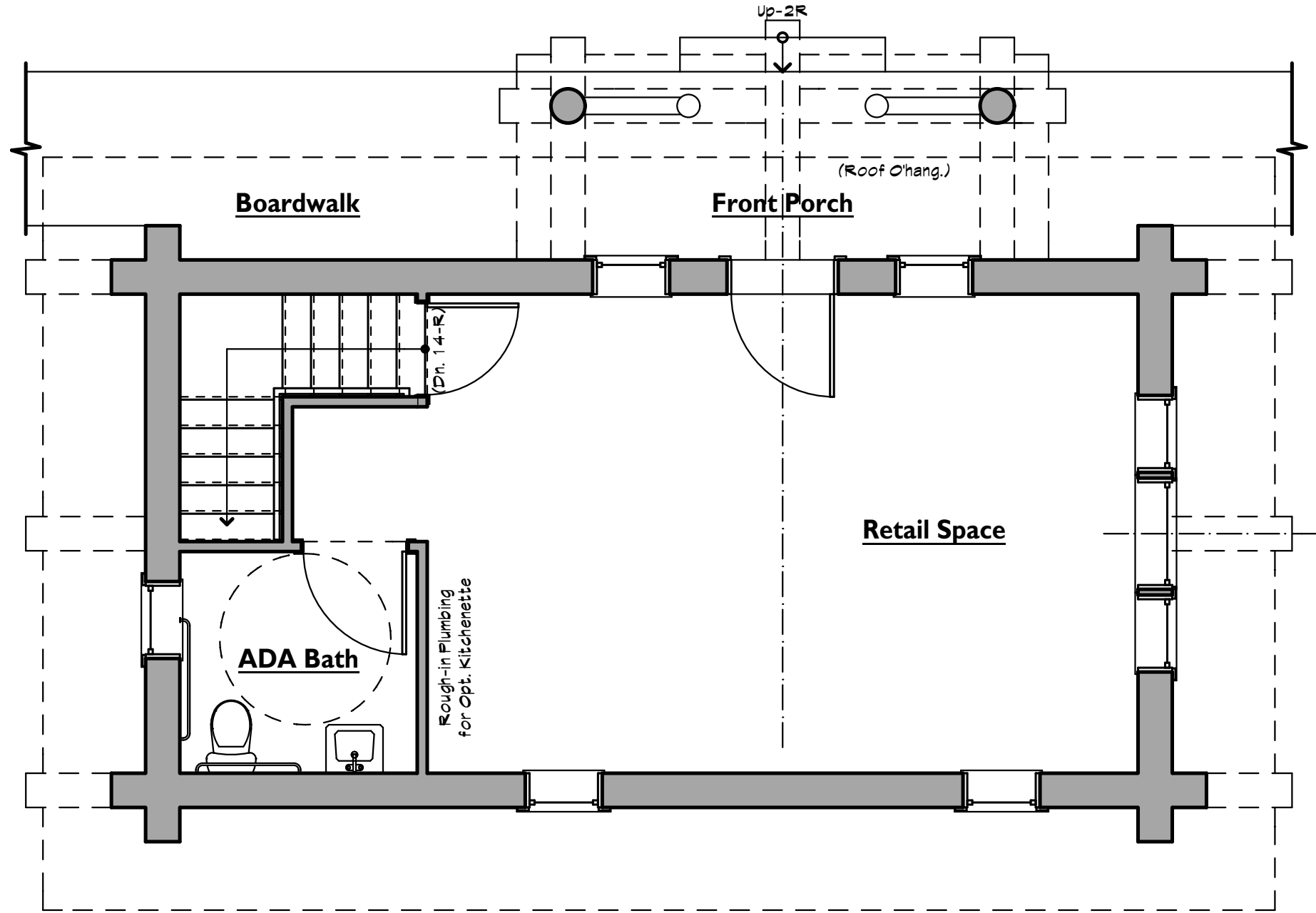

1

First Floor Plan - Side Entry

SCALE: 1/4" = 1'-0"

Eden Center Project

A New Development for Eric Smith
Eden, UT 84310

SHEET:

A-4

DATE: 9/29/11

EKMAN DESIGN STUDIO
ARCHITECTURE

STUDIO: 303.730.2757 FAX: 303.730.2774 WEB: www.ekmandesign.com
550 EAST 8TH AVENUE DENVER, CO 80203



Front Elevation - Side Entry

Eden Center Project

A New Development for Eric Smith
Eden, UT 84310

SHEET:

A-5

DATE: 9/29/11

EKMAN DESIGN STUDIO

A R C H I T E C T U R E

STUDIO: 303.730.2757 FAX: 303.730.2774 WEB: www.ekmandesign.com
550 EAST 8TH AVENUE DENVER, CO 80203



Side Elevation - Side Entry

Eden Center Project

A New Development for Eric Smith
Eden, UT 84310

SHEET:

A-6

DATE: 9/29/11

EKMAN DESIGN STUDIO

A R C H I T E C T U R E

STUDIO: 303.730.2757 FAX: 303.730.2774 WEB: www.ekmandesign.com
550 EAST 8TH AVENUE DENVER, CO 80203

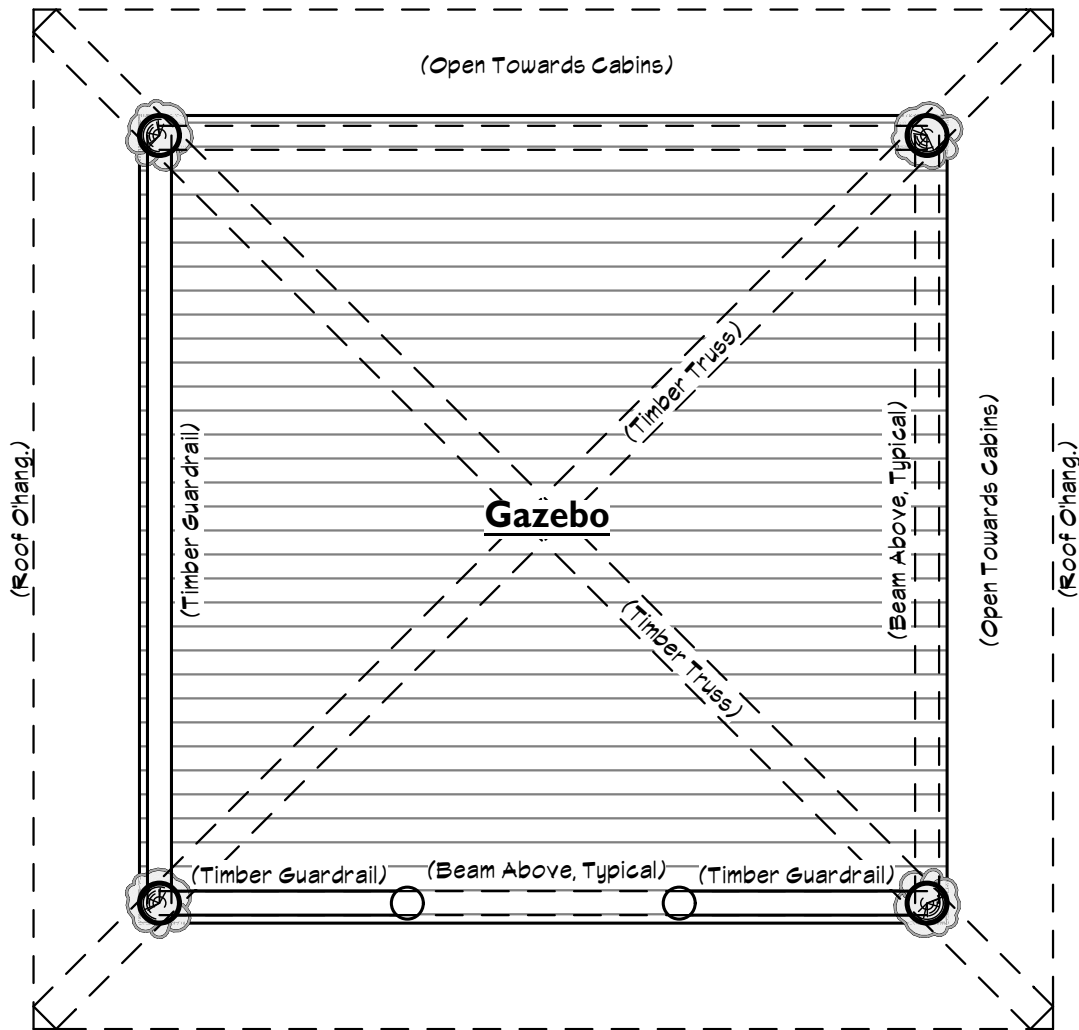

1

Gazebo Plan

SCALE: 1/4" = 1'-0"

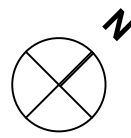

Gazebo Elevation

EKMAN DESIGN STUDIO

A R C H I T E C T U R E

STUDIO: 303.730.2757 FAX: 303.730.2774 WEB: www.ekmandesign.com
550 EAST 8TH AVENUE DENVER, CO 80203

Eden Center.pln: A-7 Gazebo printed by sysadmin at 5:05 PM on 9/29/11

Eden Center Project

A New Development for Eric Smith

Eden, UT 84310

SHEET:

A-7

DATE: 9/29/11

© 2011 Ekman Design Studio

8x4 Marquee Sign

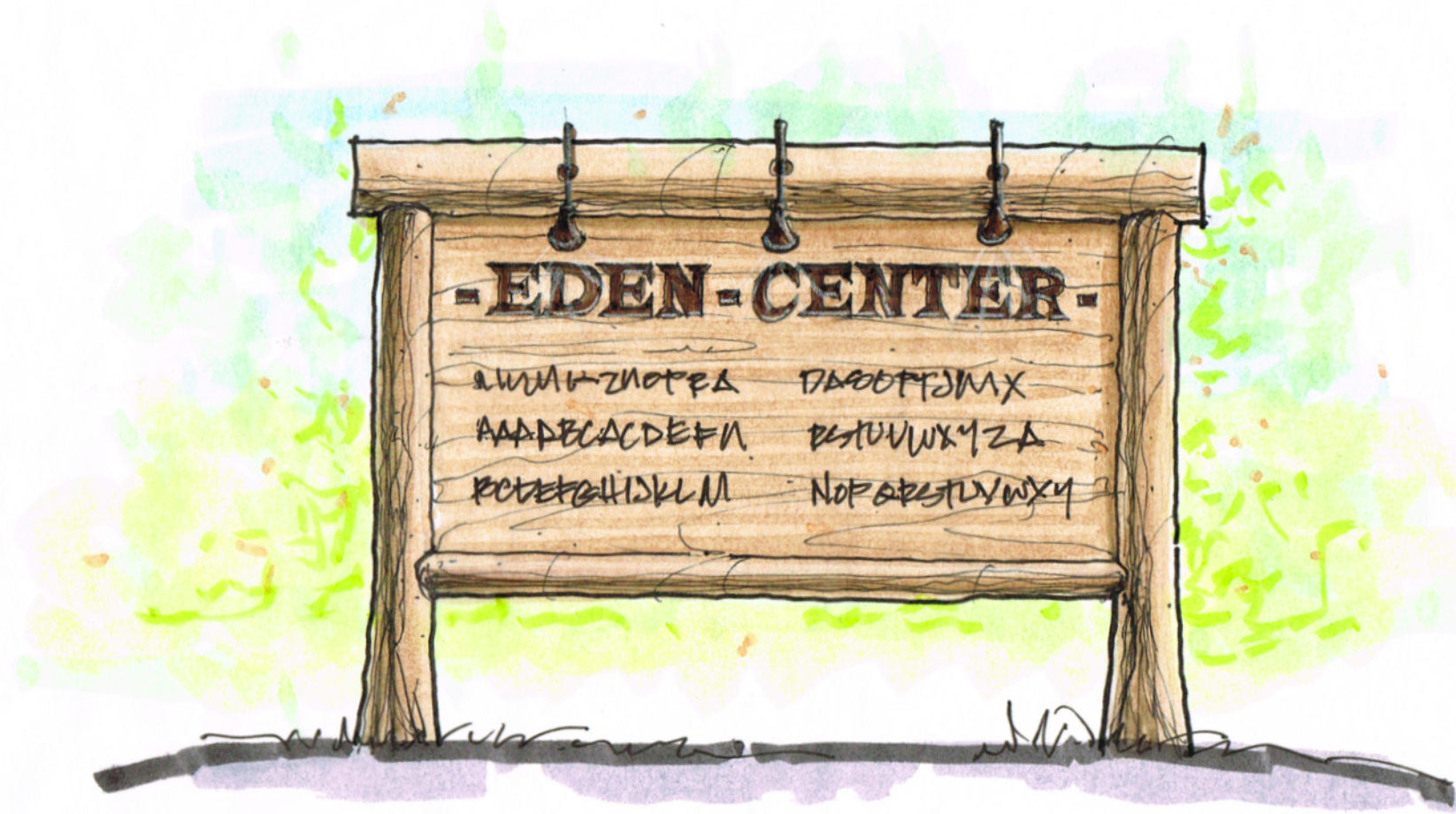

Eden Center Project

A New Development for Eric Smith
Eden, UT 84310

SHEET:

A-8

DATE: 9/29/11

EKMAN DESIGN STUDIO
A R C H I T E C T U R E

STUDIO: 303.730.2757 FAX: 303.730.2774 WEB: www.ekmandesign.com
550 EAST 8TH AVENUE DENVER, CO 80203