

**1** **Basement Plan**  
 SCALE: 1/4" = 1'-0"

**Eden Center Project**  
 A New Development for Eric Smith  
 #Client Street  
 Eden, UT 84310

**EKMAN DESIGN STUDIO**  
 ARCHITECTURE  
 STUDIO: 303.730.2757 FAX: 303.730.2774 WEB: www.ekmandesign.com  
 550 EAST 8TH AVENUE DENVER, CO 80203

SHEET:  
**A-0**  
 DATE: 9/27/11

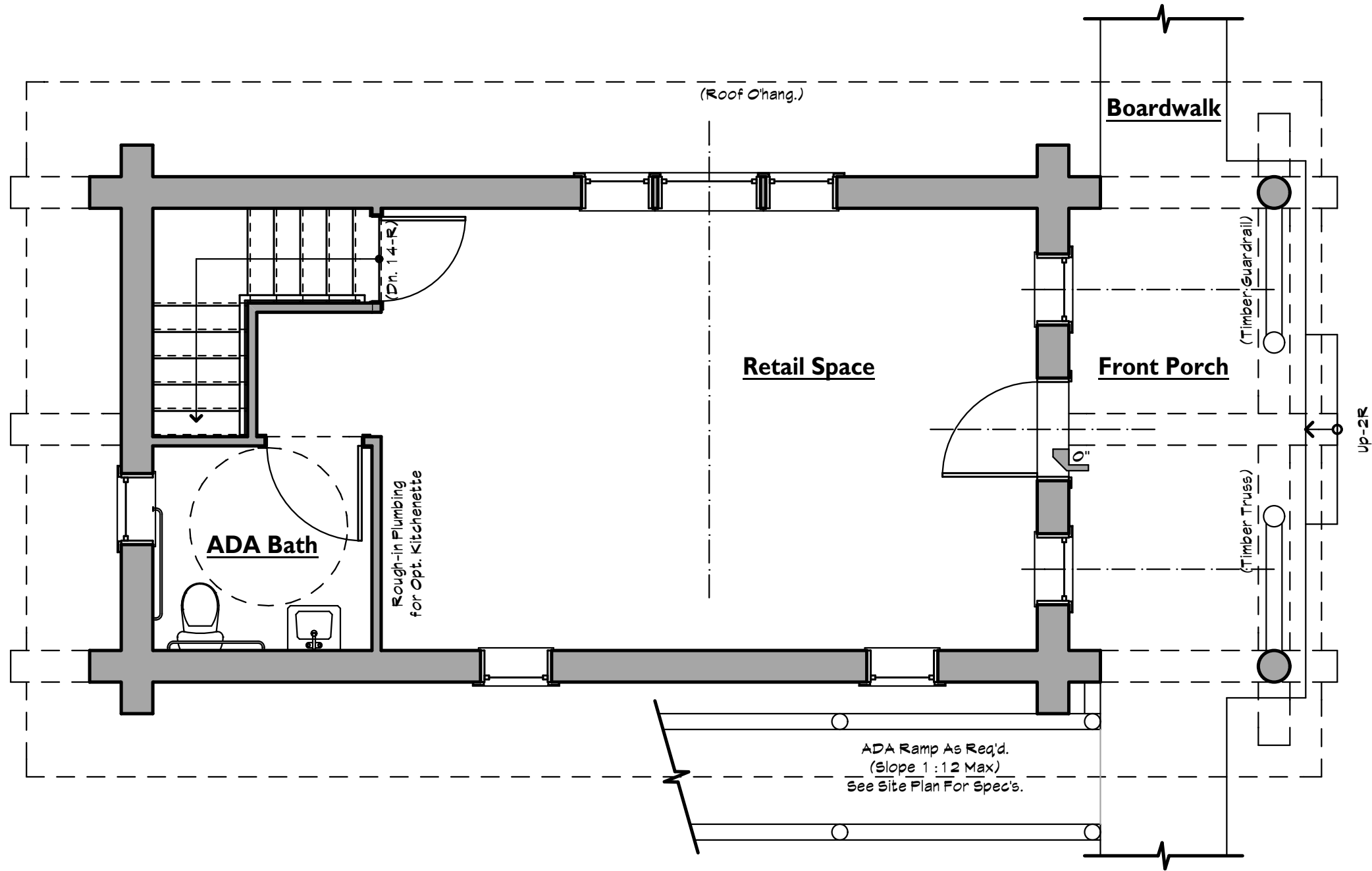

**1** First Floor Plan  
 SCALE: 1/4" = 1'-0"

**Eden Center Project**

A New Development for Eric Smith  
 #Client Street  
 Eden, UT 84310

SHEET:

**A-1**

DATE: 9/27/11

**EKMAN DESIGN STUDIO**  
 A R C H I T E C T U R E

STUDIO: 303.730.2757 FAX: 303.730.2774 WEB: www.ekmandesign.com  
 550 EAST 8TH AVENUE DENVER, CO 80203



Front Elevation

**Eden Center Project**

A New Development for Eric Smith  
#Client Street  
Eden, UT 84310

SHEET:

**A-2**

DATE: 9/27/11

**EKMAN DESIGN STUDIO**

A R C H I T E C T U R E

STUDIO: 303.730.2757 FAX: 303.730.2774 WEB: [www.ekmandesign.com](http://www.ekmandesign.com)  
550 EAST 8TH AVENUE DENVER, CO 80203



Side Elevation

**EKMAN DESIGN STUDIO**

A R C H I T E C T U R E

STUDIO: 303.730.2757 FAX: 303.730.2774 WEB: [www.ekmandesign.com](http://www.ekmandesign.com)  
550 EAST 8TH AVENUE DENVER, CO 80203

**Eden Center Project**

A New Development for Eric Smith  
#Client Street  
Eden, UT 84310

SHEET:

**A-3**

DATE: 9/27/11