

UTILITY PLAN
EDEN CENTER
PART OF THE NORTHWEST 1/4 OF SECTION
34 T7N, R1E, SLB & M, U.S. SURVEY
EDEN CITY, WEBER COUNTY, UTAH
SEPTEMBER 2011

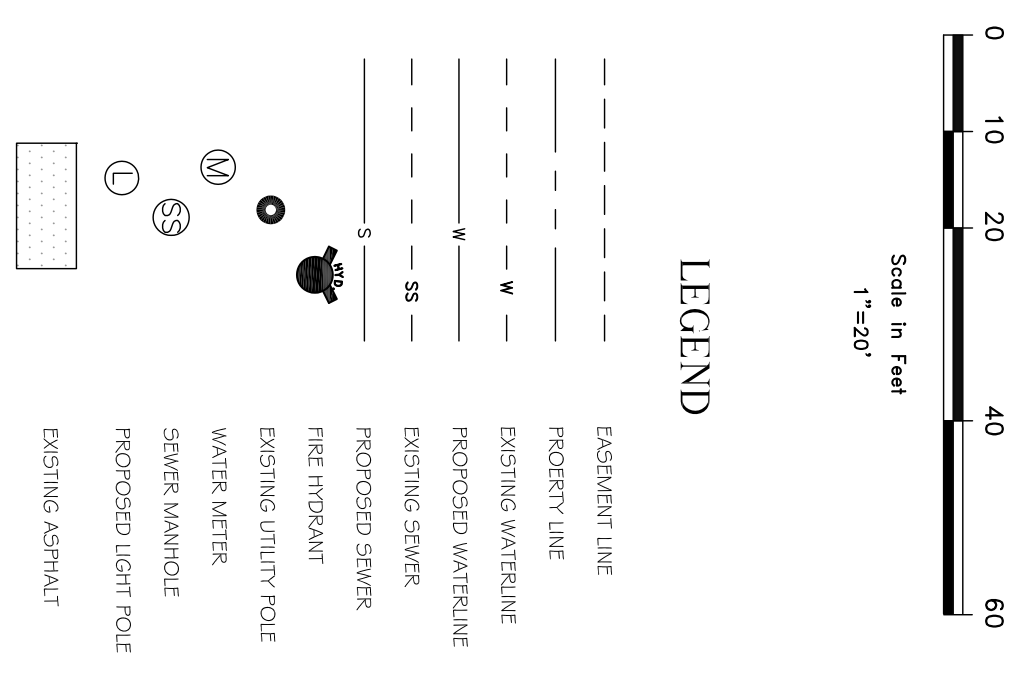
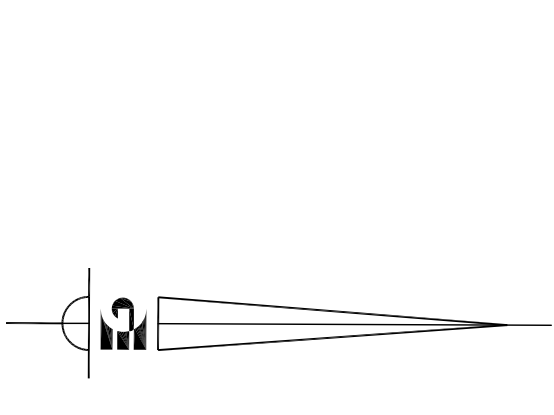
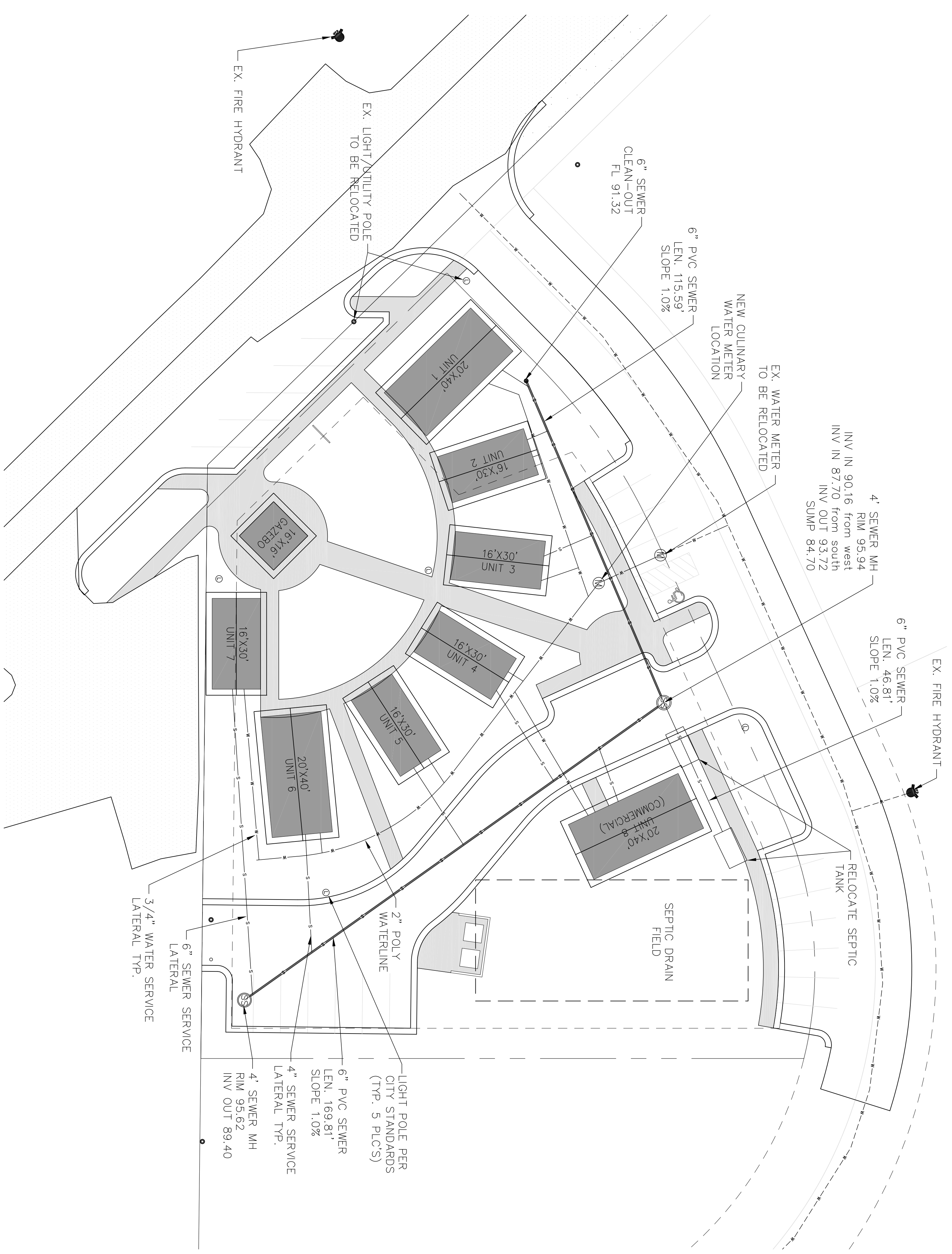

SANITARY SEWER NOTES

1. THE LOCATION OF EXISTING UTILITIES SHOWN ARE APPROXIMATE ONLY, AND THE CONTRACTOR SHALL VERIFY THE LOCATION AND ELEVATION OF ALL UTILITIES SHOWN OR NOT SHOWN ON THESE PLANS.
2. ALL UTILITY CONSTRUCTION SHALL BE IN CONFORMANCE WITH WEBER COUNTY STANDARDS AND SPECIFICATIONS.
3. ALL GRANTY SANITARY SEWER LINES SHALL BE SDR-35 PVC MATERIAL. SEWER LINE CONSTRUCTION AND MATERIALS SHALL CONFORM TO ASTM STANDARDS AND SPECIFICATIONS.
4. CONTRACTOR IS RESPONSIBLE TO PROTECT ALL EXISTING STRUCTURES AND IMPROVEMENTS DURING INSTALLATION OF SANITARY SEWER LINE.

CULINARY WATER NOTES

1. ALL INSTALLATION AND MATERIALS SHALL CONFORM TO EDEN WATERWORKS STANDARDS AND SPECIFICATIONS AND PLANS.
- DISINFECTION TESTS SHALL BE PERFORMED WITH COOPERATION FROM THE CONTRACTOR IN PERFORMING ANY NECESSARY EXCAVATION AND SUBSEQUENT BACKFILLING.
2. UNLESS OTHERWISE SPECIFIED, ALL WATERLINES SHALL BE AWWA C900 PVC CLASS 150, PER ASTM D2241.
3. CONTRACTOR SHALL LOCATE VALVES PRIOR TO CONNECTION WITH EXISTING SYSTEM, BUT SHALL NOT OPERATE ANY VALVE WITHOUT PERMISSION FROM EDEN WATERWORKS.
4. ALL WATER MAINS, VALVES, FIRE HYDRANTS, SERVICES AND APPURTENANCES SHALL BE INSTALLED, TESTED, AND APPROVED PRIOR TO PAVING.

NOTE: ALL CONSTRUCTION TO CONFORM TO EDEN CITY STANDARDS AND SPECIFICATIONS.

NOTICE:

EXISTING UTILITIES ARE SHOWN ON THESE PLANS FOR INFORMATION ONLY. CONTRACTOR SHALL VERIFY THE LOCATION AND DEPTH OF ALL UTILITIES SHOWN OR NOT SHOWN ON THESE PLANS PRIOR TO CONSTRUCTION.

BLUE STAKES BEFORE YOU DIG

1-800-665-4111

DEVELOPER

WOP WOM LLC
FISC SMITH
212 MERCHANT ST. #330
HONOLULU, HI 96813
PHONE: (808) 524-3591
FAX: (808) 524-8603

3 4	<p>Gardner Engineering</p> <p>5875 South Adams Ave. Parkway, Suite 200 • Ogden, UT 84405 Phone (801) 476 0202 • Fax (801) 476-0066</p>	<p>WOP WOM LLC EDEN CENTER UTILITY PLAN</p> <p>EDEN CITY, WEBER COUNTY, UTAH</p>	<p>SCALE: 1" = 20'</p> <p>DATE: SEPTEMBER 2011</p> <p>DESIGN: TMN/SCC</p> <p>DRAWN: SCC</p> <p>CHECKED: TMN</p>	<table border="1" style="width: 100%; border-collapse: collapse;"> <thead> <tr> <th colspan="2">REVISIONS</th> </tr> <tr> <th>DATE</th> <th>DESCRIPTION</th> </tr> </thead> <tbody> <tr> <td> </td> <td> </td> </tr> <tr> <td> </td> <td> </td> </tr> <tr> <td> </td> <td> </td> </tr> </tbody> </table> <p>DWG: SEE PLOT STAMP AT LEFT</p>	REVISIONS		DATE	DESCRIPTION						
		REVISIONS												
DATE	DESCRIPTION													
<p>DWG: SEE PLOT STAMP AT LEFT</p>														