

Street Section (60' R.O.W.)
SCALE: NONE

NOTE:
THESE PAVEMENT THICKNESSES ARE BASED ON A STANDARD SUBGRADE AND MAY BE INCREASED BY THE COUNTY ENGINEER WHEN SUBGRADE C.B.R. IS LESS THAN 10 OR WHEN A GREATER PERCENTAGE OF SUBGRADE IS FOUND TO BE WEAKER THAN THE STANDARD. SUFFICIENT STABILITY DESIGNER MAY SUBMIT AN ALTERNATIVE PAVEMENT DESIGN BASED ON A DETAILED SOILS ANALYSIS FOR

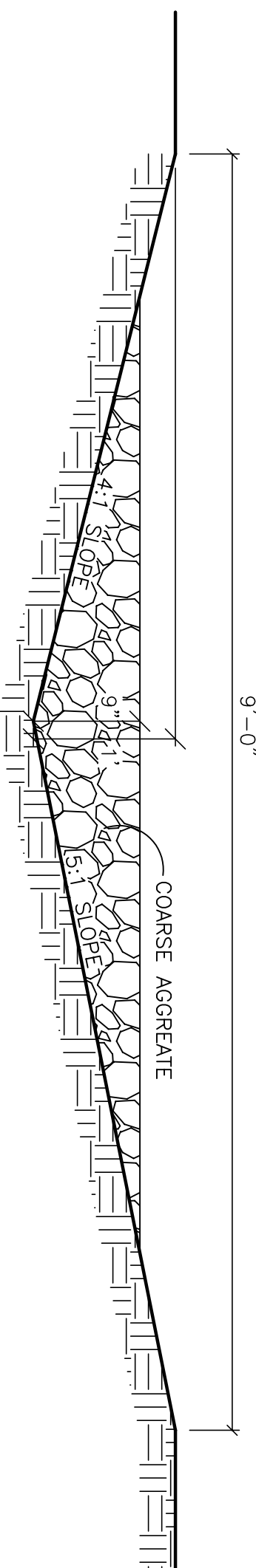

Swale Detail W/ Coarse Aggregate
SCALE: NONE

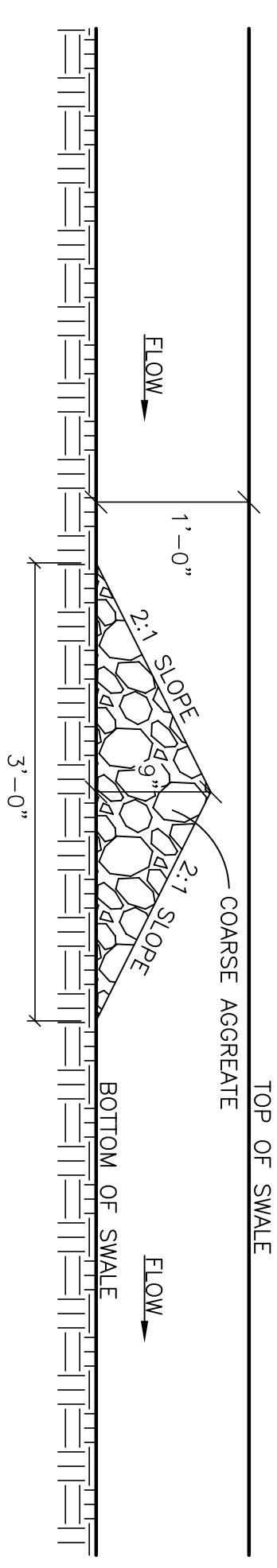

Swale Detail W/ Rock Check Dam
SCALE: NONE

Legend	
— W —	= PROPOSED CULINARY WATER LINE
— EX-W —	= EXISTING CULINARY WATER LINE
— SS —	= PROPOSED SANITARY SEWER LINE
— EX-SS —	= EXISTING SANITARY SEWER LINE
— SD —	= PROPOSED STORM DRAIN LINE
— EX-SD —	= EXISTING STORM DRAIN LINE
— LD —	= PROPOSED LAND DRAIN LINE
— EX-LD —	= EXISTING LAND DRAIN LINE
— SW —	= PROPOSED SECONDARY WATER LINE
— EX-SW —	= EXISTING SECONDARY WATER LINE
— IRR —	= PROPOSED IRRIGATION LINE
— EX-IRR —	= EXISTING IRRIGATION LINE
— OHP —	= EXISTING OVERHEAD POWER LINE
— TEL —	= EXISTING TELEPHONE LINE
— GAS —	= EXISTING NATURAL GAS LINE
— — —	= EXISTING EDGE OF PAVEMENT
— X — X —	= FENCE LINE
— — —	= MASONRY BLOCK/RETAINING WALL
— — —	= DITCH/SWALE FLOWLINE
●	= PROPOSED FIRE HYDRANT
○	= EXISTING FIRE HYDRANT
●	= PROPOSED MANHOLE
○	= EXISTING MANHOLE
●	= PROPOSED SEWER CLEAN-OUT
×	= PROPOSED GATE VALVE
×	= EXISTING GATE VALVE
■	= PROPOSED WATER METER
■	= EXISTING WATER METER
■	= PROPOSED CATCH BASIN
□	= EXISTING CATCH BASIN
●	= EXISTING SPRINKLER
⌵	= PLUG W/ 2" BLOW-OFF
⌵	= AIR-VAC ASSEMBLY
⌵	= PROPOSED REDUCER
⌵	= PLUG & BLOCK
⌵	= STREET LIGHT
⌵	= SIGN
BLDG	= BUILDING
BVC	= BEGIN VERTICAL CURVE
C&G	= CURB & GUTTER
CB	= CATCH BASIN
C.F.	= CURB FEET
C.F.S.	= CUBIC FEET PER SECOND
CL	= CENTERLINE
DI	= DUCTILE IRON
EP	= EDGE OF PAVEMENT
EVC	= END VERTICAL CURVE
FC	= FENCE CORNER
FF	= FINISH FLOOR
FFE	= FINISH FLOOR ELEVATION
FG	= FINISHED GRADE
FH	= FIRE HYDRANT
FL	= FLOW LINE
GB	= GRADE BREAK
HDPE	= HIGH DENSITY POLYETHYLENE PIPE
INV	= INVERT
IRR	= IRRIGATION
LD	= LAND DRAIN
LF	= LINEAR FEET
NG	= NATURAL GRADE
O.C.	= ON CENTER
PC	= POINT OF CURVE
P/C	= POINT OF REVERSE CURVE
PN/C	= POINT OF REVERSE VERTICAL CURVE
PT	= POINT OF TANGENT
PP	= POWER/UTILITY POLE
P.U.E.	= PUBLIC UTILITY EASEMENT
R/C	= REBAR & CAP
RCB	= REINFORCED CONCRETE BOX
RCP	= REINFORCED CONCRETE PIPE
RIM	= RIM OF MANHOLE
R.O.W.	= RIGHT-OF-WAY
SD	= STORM DRAIN
SS	= SANITARY SEWER
SW	= SECONDARY WATER
TBC	= TOP BACK OF CURB
TOE	= TOP OF SLOPE
TOW	= TOP OF WALL
TSW	= TOP OF SIDEWALK
VPI	= VERTICAL POINT OF INTERSECT
W	= CULINARY WATER
WM	= WATER METER
■	= NEW PAVEMENT
■	= NEW CONCRETE

General Notes

1. ALL CONSTRUCTION ON THIS PROJECT SHALL CONFORM TO THE DEVELOPMENT STANDARDS OF WEBER COUNTY AND THE STANDARD REQUIREMENTS CONTAINED THEREIN. WEBER COUNTY PUBLIC WORKS REQUIREMENTS SHALL BE MET.
2. THE LOCATION OF EXISTING UTILITIES SHOWN ARE APPROXIMATE ONLY AND THE CONTRACTOR SHALL VERIFY THE LOCATION AND ELEVATION OF ALL UTILITIES SHOWN OR NOT SHOWN ON THESE PLANS.
3. THE STREET STRUCTURAL CROSS SECTION IS PER WEBER COUNTY DETAILS CONTAINED WITHIN THESE PLANS.
4. WATER LINE PIPE SHALL BE PVC C-900 CLASS 200. WASHOUT ASSEMBLIES SHALL CONSIST OF A KUPFERLE FOUNDRY CO. 2" BLOW-OFF HYDRANT (OR COUNTY-APPROVED EQUIV).
5. SECONDARY WATER LINE SHALL BE PVC C-900 CLASS 200. ALL SECONDARY WATER VALVE LIDS SHALL BE STAMPED "IRRIGATION".

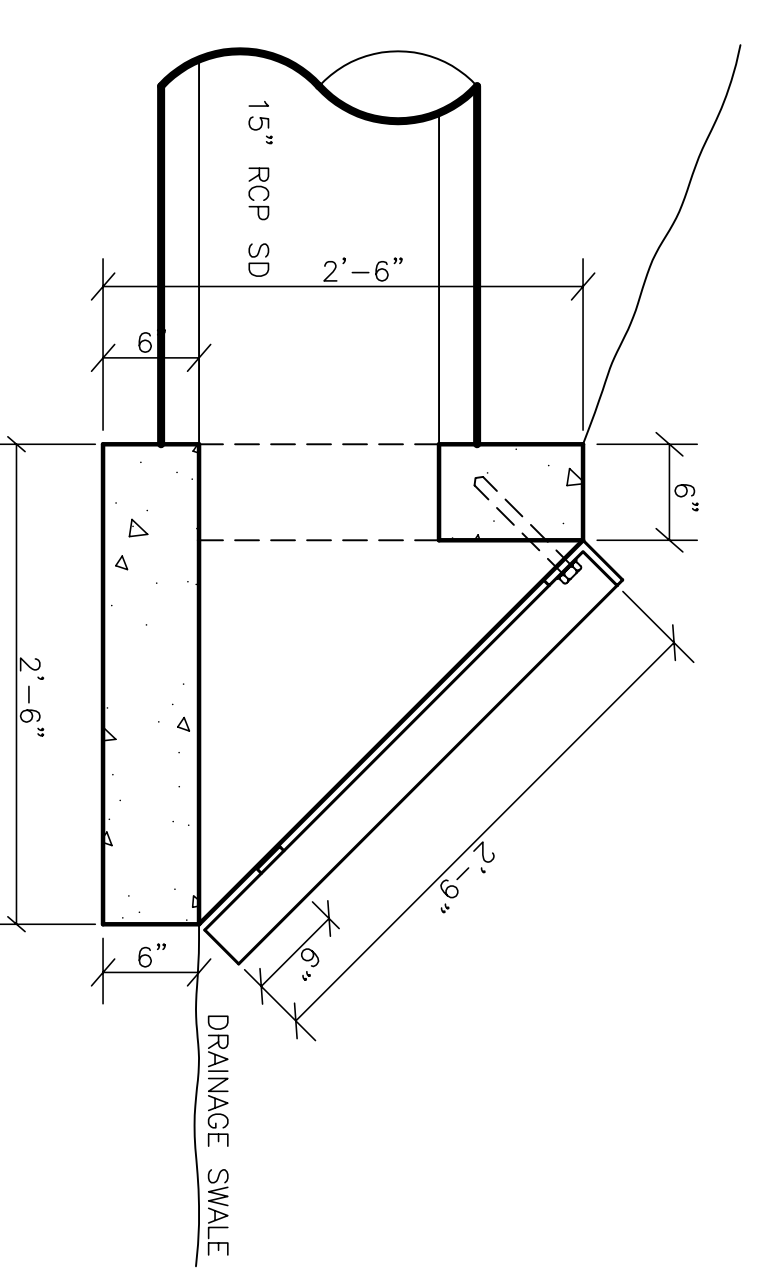

15' Inlet w/Grate
SCALE: 1"=1'

THESE PLANS AND SPECIFICATIONS ARE THE PROPERTY OF REEVE & ASSOCIATES, INC., 4155 S. HARRISON BLVD., EXECUTIVE BLDG. #310, OGDEN, UTAH 84403, AND SHALL NOT BE REPRODUCED, RE-DRAWN, OR USED ON ANY PROJECT OTHER THAN THE PROJECT SPECIFICALLY DESIGNED FOR, WITHOUT THEIR WRITTEN PERMISSION. THE OWNERS AND ENGINEERS OF REEVE & ASSOCIATES, INC. DISCLAIM ANY LIABILITY FOR ANY CHANGES OR MODIFICATIONS MADE TO THESE PLANS OR THE DESIGN THEREON WITHOUT THEIR CONSENT.

Reeve & Associates, Inc.
4155 S. HARRISON BLVD., SUITE 310, OGDEN, UTAH 84403
TEL: (801) 621-3100 FAX: (801) 621-2666 www.reeve-assoc.com
TRAFFIC ENGINEERS • STRUCTURAL ENGINEERS • LANDSCAPE ARCHITECTS

REVISIONS	
DATE	DESCRIPTION
4-14-11	RH County Comments

Lisa Estates Subdivision Phase 1 & 2
WARREN, WEBER COUNTY, UTAH

Street Cross-Sections/ Master Legend/Notes

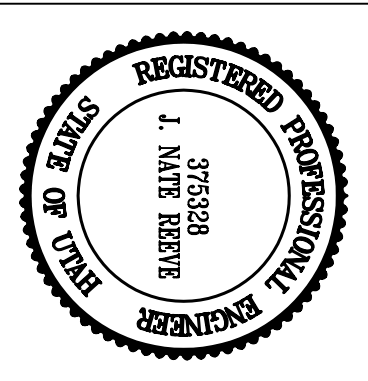

Project Info.
Engineer: J. NATE REEVE, P.E.
Drafter: R. HANSEN
Begin Date: MARCH 18, 2011
Name: LISA ESTATES SUBDIVISION
PHASE 1 & 2
Number: 1714-27

Sheet **2** of 6 Sheets