

**Construction Notes:**

1) ALL CONSTRUCTION IS TO CONFORM TO THE STANDARD DRAWINGS AND SPECIFICATIONS OF WEBER COUNTY.

**CULINARY WATER**

W/10 - 10" PVC C-900 CLASS 200 WATER

**STORM DRAIN**

SD/15 - 15" RCP STORM DRAIN

**SECONDARY WATER**

SW/6 - 6" PVC C-900 SECONDARY WATER LINE

**Reeve & Associates, Inc.**  
 4155 S. HARRISON BLVD., SUITE 310, OGDEN, UTAH 84403  
 TEL: (801) 466-6211 FAX: (801) 466-6212  
 CIVIL ENGINEERS • LANDSCAPE ARCHITECTS



DATE	DESCRIPTION
4-14-11	County Comments
6-15-11	RH County Comments
9-29-11	RH County Comments
6-29-12	RH County Comments
8-01-12	RH County Comments
9-24-12	RH County Comments
2-28-13	RH County Comments

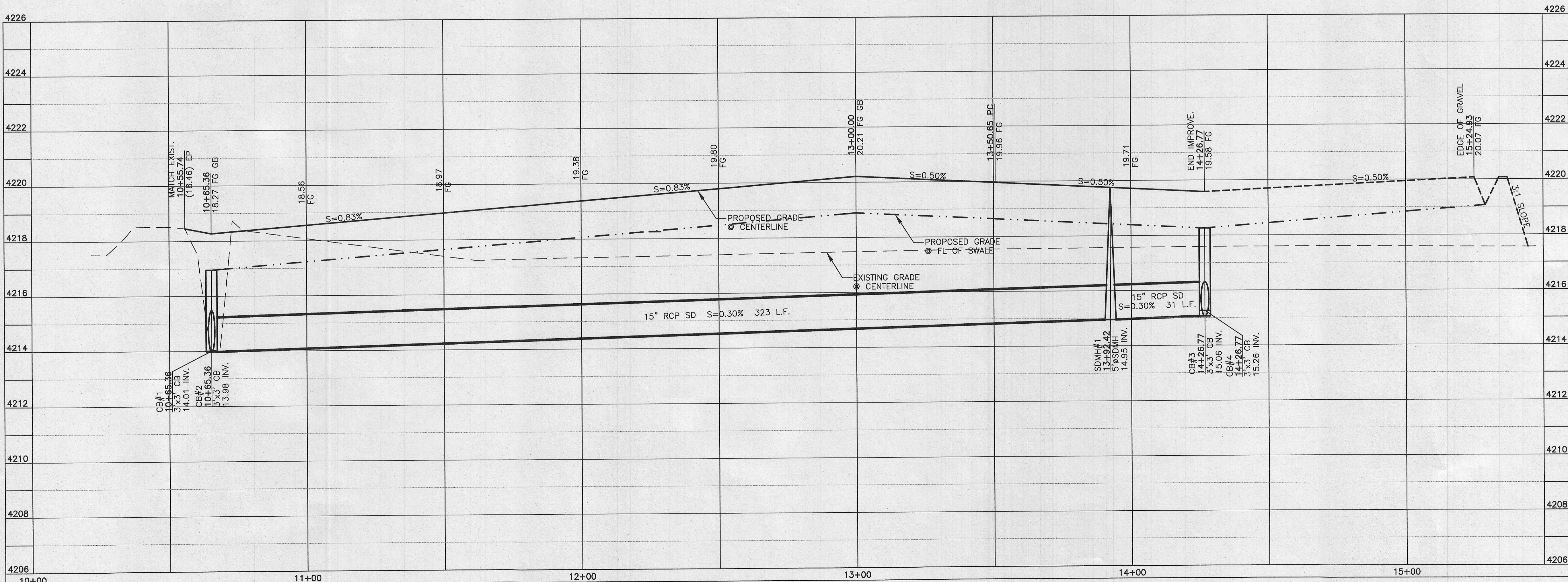
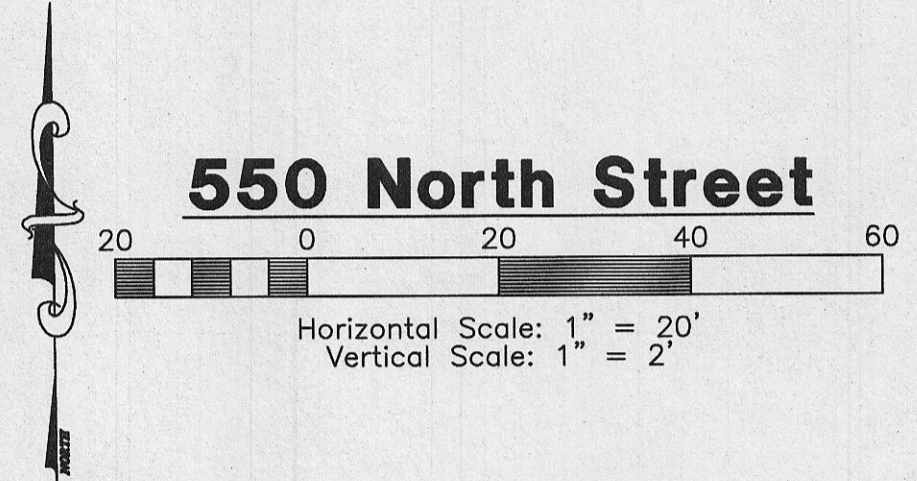

Reeve & Associates, Inc. - Solutions You Can Build On

**Fenster Farm Subdivision Phase-1**  
 WARREN, WEBER COUNTY, UTAH  
**550 North Street**  
**10+00.00 - 15+50.00**

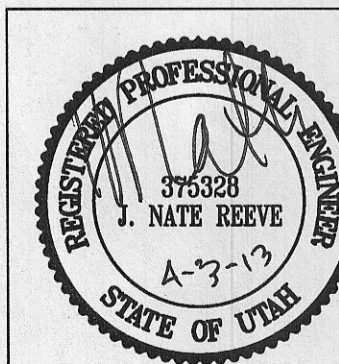

**Project Info.**  
 Engineer: J. NATE REEVE, P.E.  
 Drafter: R. HANSEN  
 Begin Date: MARCH 16, 2011  
 Name: FENSTER FARM SUBDIVISION PHASE-1  
 Number: 1714-26

Blue Stakes Location Center  
**Call: Toll Free 1-800-662-4111**  
 Two Working Days Before You Dig

Sheet **7**  
 3

Revised 2-28-13