

Typical Road Section
SCALE: NONE

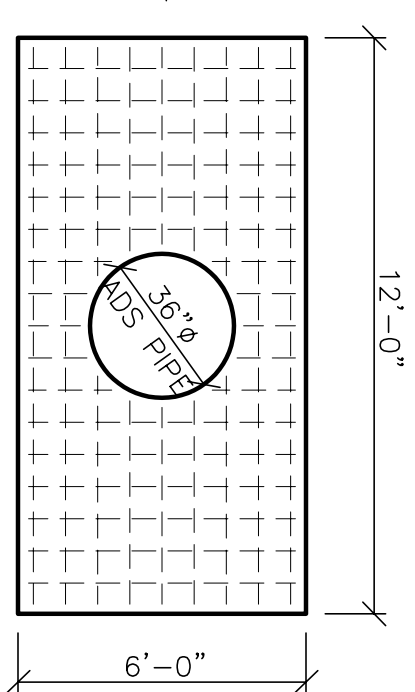

Headwall Detail
SCALE: NONE

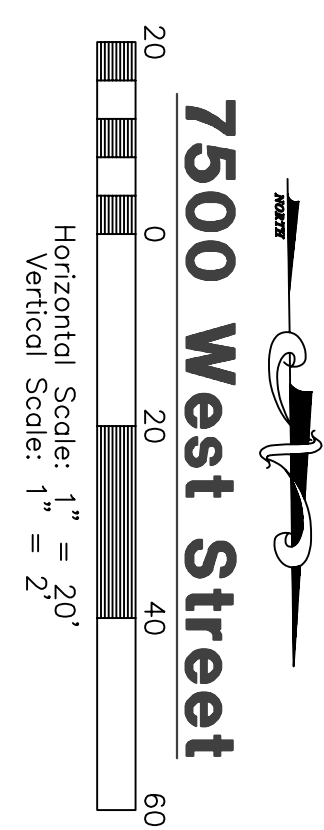
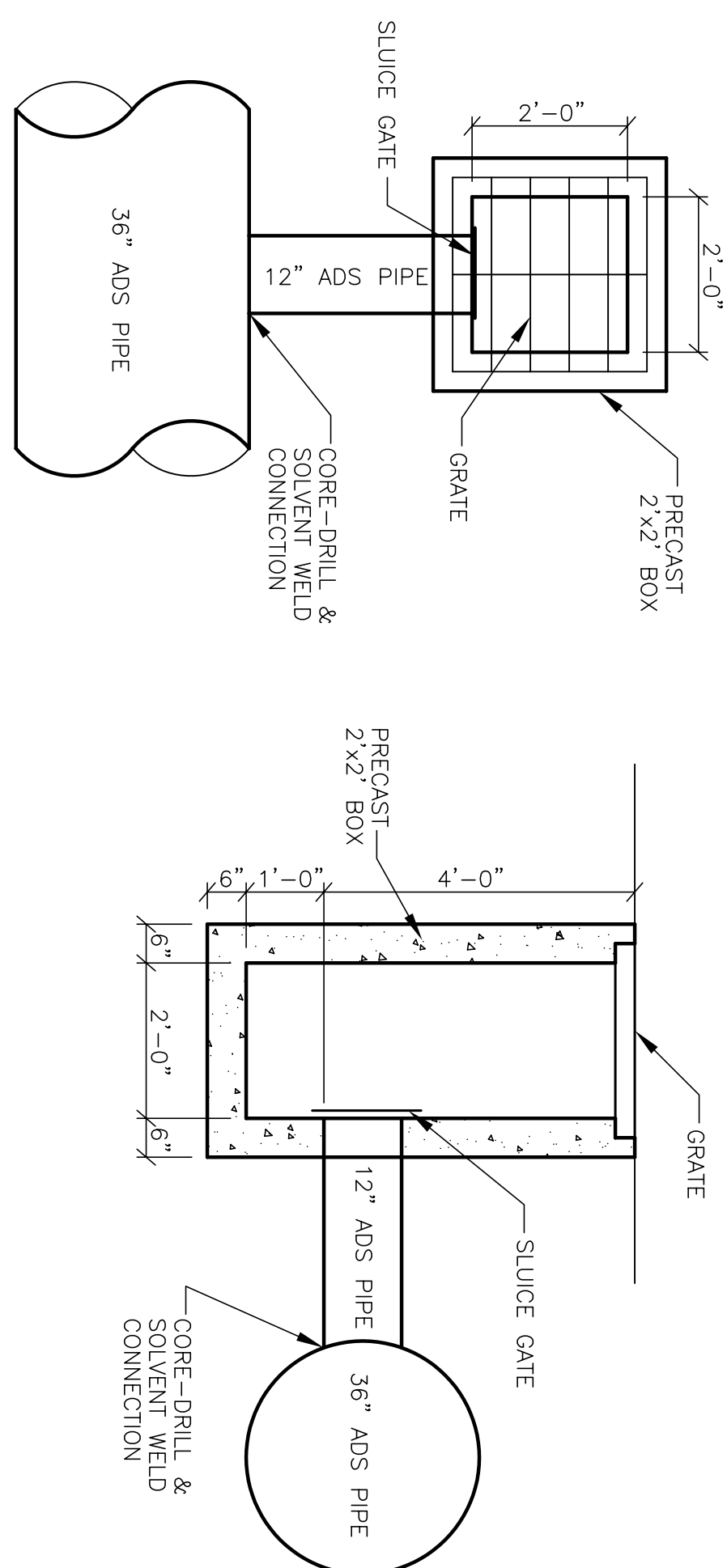

Irrigation Diversion Box
SCALE: 1"=2'

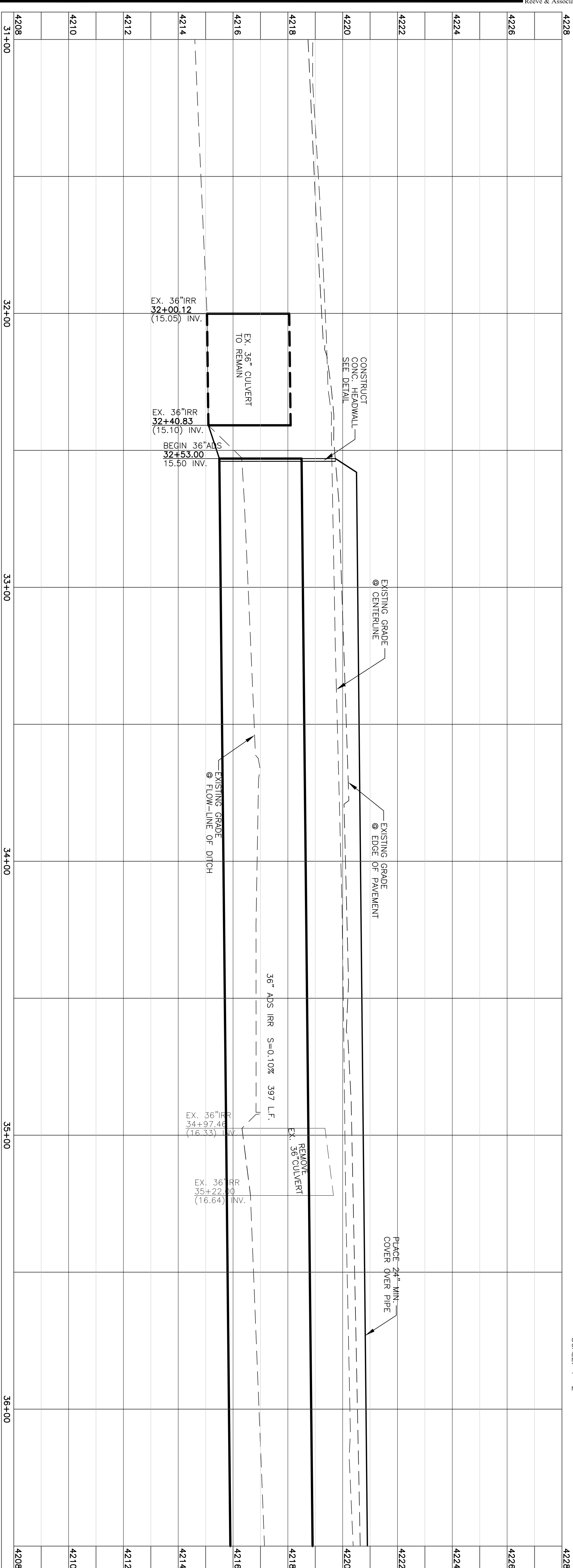

ADS Pipe Notes:

- 1) ALL REVENING, HANDLING, STORAGE, TRENCH CONSTRUCTION & PIPE INSTALLATION AND BACKFILL SHALL FOLLOW ADS (ADVANCED DRAINAGE SYSTEMS) PIPE INSTALLATION GUIDE.
- 2) ALL UNSUBSITABLE FOUNDATION SHALL BE REMOVED BEFORE PIPE INSTALLATION PROCEEDS.
- 3) WHERE THE TRENCH BOTTOM IS UNSTABLE, THE CONTRACTOR SHALL EXCAVATE TO A DEPTH REQUIRED BY THE ENGINEER AND REPLACED W/ SUITABLE MATERIAL. ALL MATERIAL MUST BE NON-COHESIVE SAND/SAND/GRAVEL MIXES AND COMPACTED TO A MINIMUM OF 85% STANDARD PROCTOR DENSITY.
- 5) PLACE AND COMPACT BACKFILL IN LAYERS OF APPROX. 6" DEPTHS.
- 6) AVOID IMPACTING PIPE WITH COMPACTION EQUIPMENT.

Blue Stakes Location Center
Call Toll Free
1-800-662-4111
Two Working Days Before You Dig

THESE PLANS AND SPECIFICATIONS ARE THE PROPERTY OF REEVE & ASSOCIATES, INC., 4155 S. HARRISON BLVD., EXECUTIVE BLDG. #310, OGDEN, UTAH 84403, AND SHALL NOT BE REPRODUCED, RE-DRAWN, OR USED ON ANY PROJECT OTHER THAN THE PROJECT SPECIFICALLY DESIGNED FOR, WITHOUT THEIR WRITTEN PERMISSION. THE OWNERS AND ENGINEERS OF REEVE & ASSOCIATES, INC. DISCLAIM ANY LIABILITY FOR ANY CHANGES OR MODIFICATIONS MADE TO THESE PLANS OR THE DESIGN THEREON WITHOUT THEIR CONSENT.

White Farms Subdivision
WEBER COUNTY, UTAH
7500 West Street
31+00.00 - 36+50.00

REVISIONS	
DATE	DESCRIPTION
2-7-11	RH County Comments

Reeve & Associates, Inc.
4155 S. HARRISON BLVD., SUITE 310, OGDEN, UTAH 84403
TEL: (801) 621-3100 FAX: (801) 621-2668 www.reeve-assoc.com
LAND PLANNERS • CIVIL ENGINEERS • LAND SURVEYORS
TRAFFIC ENGINEERS • STRUCTURAL ENGINEERS • LANDSCAPE ARCHITECTS

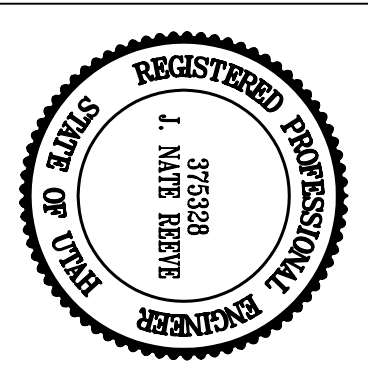

Project Info.	
Engineer:	J. NATE REEVE, P.E.
Order:	R. HANSEN
Begin Date:	DEC. 23, 2010
Name: WHITE FARMS	
SUBDIVISION	
Number:	5895-01
Sheet:	1
Sheets:	3

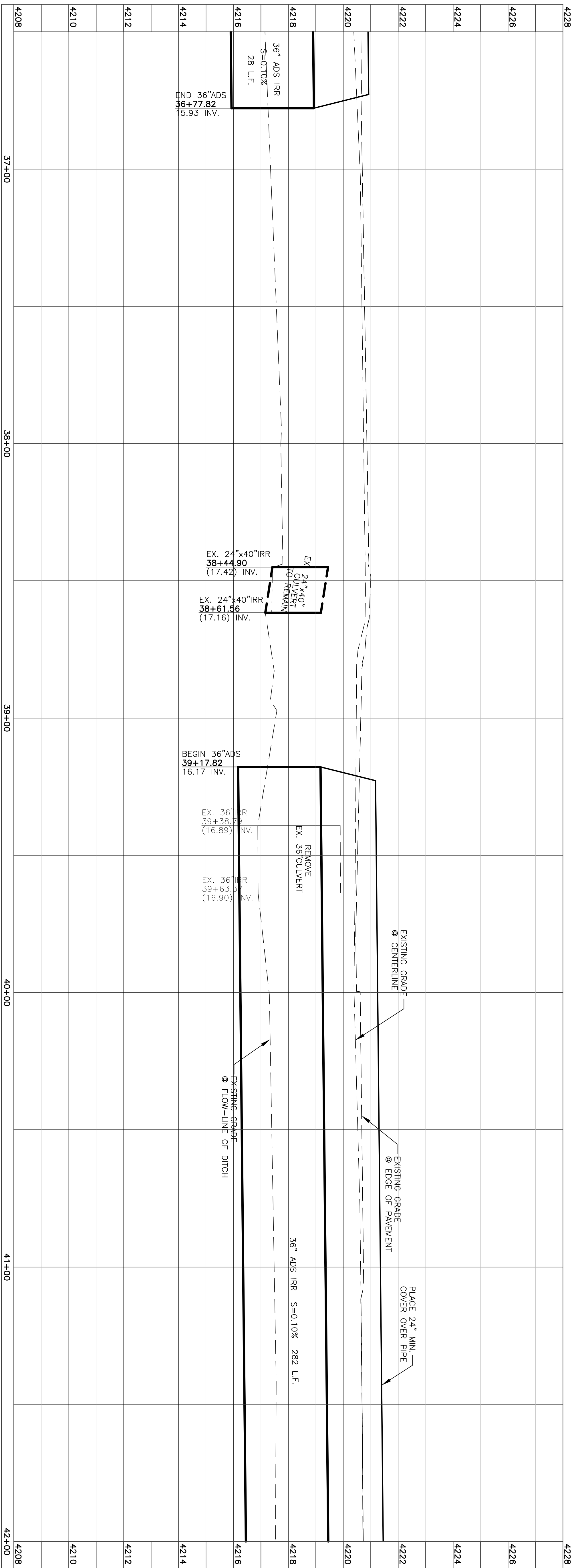
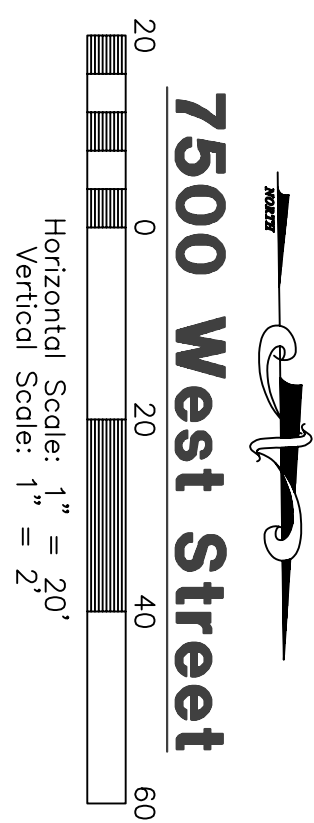
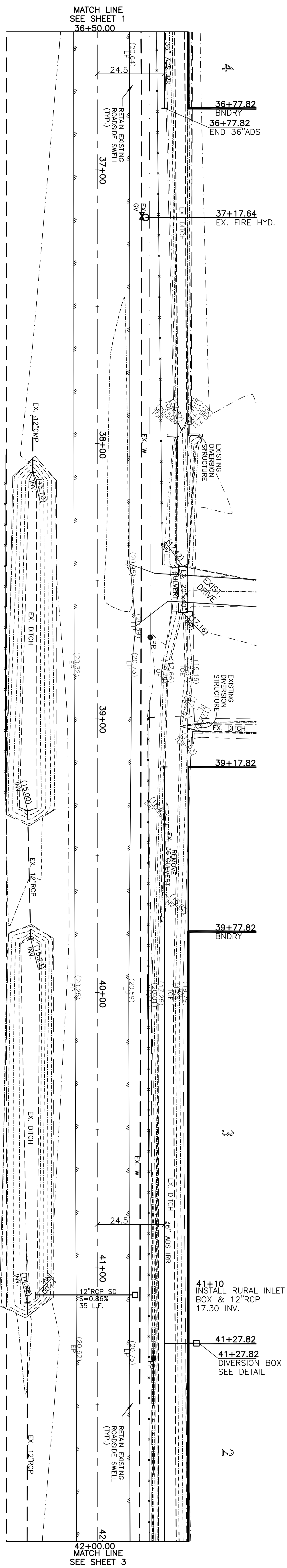

THESE PLANS AND SPECIFICATIONS ARE THE PROPERTY OF REEVE & ASSOCIATES, INC., 4155 S. HARRISON BLVD., EXECUTIVE BLDG., #310, OGDEN, UTAH 84403, AND SHALL NOT BE REPRODUCED, RE-DRAWN, OR USED ON ANY PROJECT OTHER THAN THE PROJECT SPECIFICALLY DESIGNED FOR, WITHOUT THEIR WRITTEN PERMISSION. THE OWNERS AND ENGINEERS OF REEVE & ASSOCIATES, INC. DISCLAIM ANY LIABILITY FOR ANY CHANGES OR MODIFICATIONS MADE TO THESE PLANS OR THE DESIGN THEREON WITHOUT THEIR CONSENT.

Blue Stakes Location Center
Call: Toll Free
1-800-662-4111
 Two Working Days Before You Dig

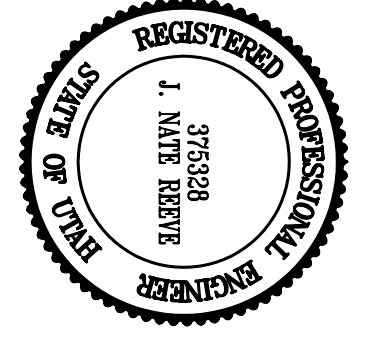

White Farms Subdivision
 WEBER COUNTY, UTAH

7500 West Street
36+50.00 - 42+00.00

REVISIONS	
DATE	DESCRIPTION
2-7-11 RH	County Comments

Reeve & Associates, Inc.
 4155 S. HARRISON BLVD., SUITE 310, OGDEN, UTAH 84403
 TEL: (801) 621-3100 FAX: (801) 621-2666 www.reeve-assoc.com
 LAND PLANNERS • CIVIL ENGINEERS • LAND SURVEYORS
 TRAFFIC ENGINEERS • STRUCTURAL ENGINEERS • LANDSCAPE ARCHITECTS

Sheet	2
Number:	5895-01
Project Info: Engineer: J. NATE REEVE, P.E. Order: R. HANSEN Begin Date: DEC. 23, 2010 Name: WHITE FARMS SUBDIVISION	
Sheet	3

