

# Planning Commission Land Use Permit

Permit Number: LUP480-2016

### Applicant

Name: David Johnson

Address: 2732 N Hwy 39

Phone:

### Owner

Name: SOURDOUGH WILDERNESS R.

Address: 2732 North Highway 39

Phone:

### Parcel

Parcel Number: 230130010

Zoning: F-40

Total Parcel Area: 5017

(\*If Zoned S-1, See Specific Height Requirements)

Address: 2732 NORTH HIGHWAY 39  
HUNTSVILLE, UT 84310

**\*\*See Diagram on Back Side for Setbacks**

Section: ALL OF Township: 7N Range: 3E

Subdivision: Sourdough Lot(s): 114

Proposed Structure:

Structure Area Used: 100

Is Structure > 1,000 Sq. Ft.?

\*If True, Need Certif. Statement

# of Dwelling Units:

# of Accessory Bldgs:

# Off-Street Parking Reqd:



### Permit Checklist:

Public by/Right of Use Road?

> 200 ft. from Paved Road? NA

< 4218 ft. above Sea Level? No

Culvert Required? NA

Wetlands/Flood Zone? NA

If Yes, Culvert Size:

**\*Any Work in the Right of Way requires an Excavation Permit**

Additional Frontage Reqd.? N/A

OR Special Exception? Case #

Meet Zone Area & Frontage?

Hillside Review Reqd.? No Case #

Culinary Water District: NA

Waste Water System: NA

Comments: Sourdough wilderness ranch 10x10 shed.

Structure Setback Graphic:

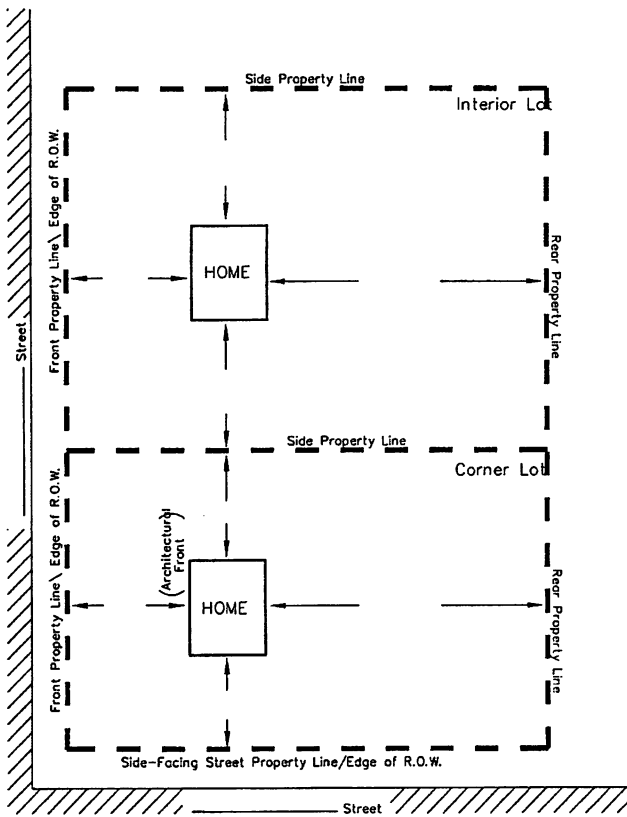

MINIMUM YARD SETBACKS  
New Dwelling, Addition, Etc.

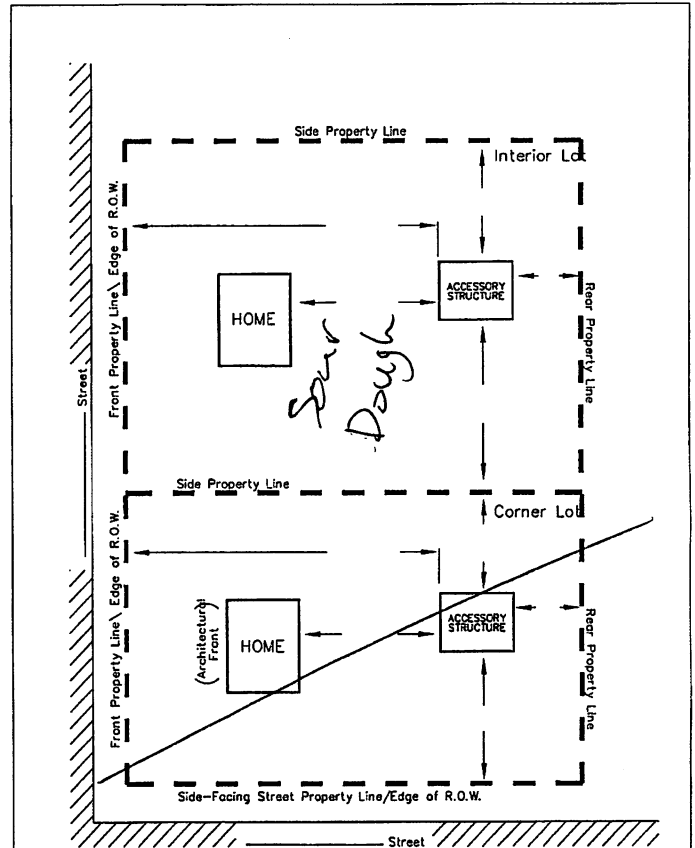

MINIMUM YARD SETBACKS  
Storage Shed, Detached Garage, Etc.

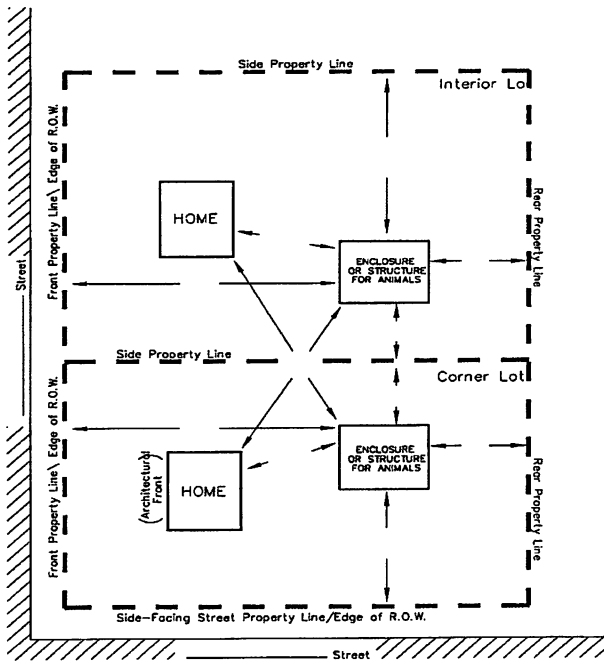

MINIMUM YARD SETBACKS  
Barn, Corral, or Stable

**NOTICE FOR APPLICANT (Please Read Before Signing)**

Proposals for the installation of an individual water supply and for a sanitary waste disposal system (septic tank) for any structure designed for human occupation must be approved by the Weber County Health Department prior to installation.

*[Signature]* \_\_\_\_\_ *8-8-2016*  
 Planning Dept. Signature of Approval Date

This permit becomes null and void if use or construction authorized has not commenced within 180 days or if there is a zone change affecting this property. I hereby certify that I have read and examined this application and know the same to be true and correct. All provisions of laws and ordinances governing this land use will be complied with whether specified herein or not. I make this statement under penalty of perjury. I hereby agree to make the requirements as specified on this permit issued to the owner of land as signed below.

*[Signature]* \_\_\_\_\_  
 Contractor/Owner Signature of Approval Date