



Planning Commission Land Use Permit

Permit Number: LUP390-2016

Applicant

Name: SOURDOUGH WILDERNESS RANCH INC
Address: 2732 North Highway 39
Phone: 801-668-1607

Owner

Name: SOURDOUGH WILDERNESS R.
Address: 2732 North Highway 39
Phone:

Parcel

Parcel Number: 230130010
Total Parcel Area: 5017
Address: 2732 NORTH HIGHWAY 39
HUNTSVILLE, UT 84310

Zoning: F-40
*(*If Zoned S-1, See Specific Height Requirements)*

****See Diagram on Back Side for Setbacks**

Section: 4,5,8,9,17 **Township:** 7N **Range:** 3E

Subdivision: Sourdough **Lot(s):** 71

Proposed Structure: Storage Shed

Structure Area Used: 100

Is Structure > 1,000 Sq. Ft.? *If True, Need Certif. Statement

of Dwelling Units: 0 **# of Accessory Bldgs:** 1 **# Off-Street Parking Req'd:** 0



Permit Checklist:

Public by/Right of Use Road?

> 200 ft. from Paved Road? Yes

< 4218 ft. above Sea Level? Yes

Wetlands/Flood Zone? No

Culvert Required? No

If Yes, Culvert Size:

***Any Work in the Right of Way requires an Excavation Permit**

Additional Frontage Req'd.? No

OR Special Exception? Case #

Meet Zone Area & Frontage? True

Hillside Review Req'd.? NA Case #

Culinary Water District: NA

Waste Water System: NA

Comments: This permit is for a 10'x10' shed in the Sourdough Wilderness Ranch Lot 71 Elkhorn for Kellie Anderson

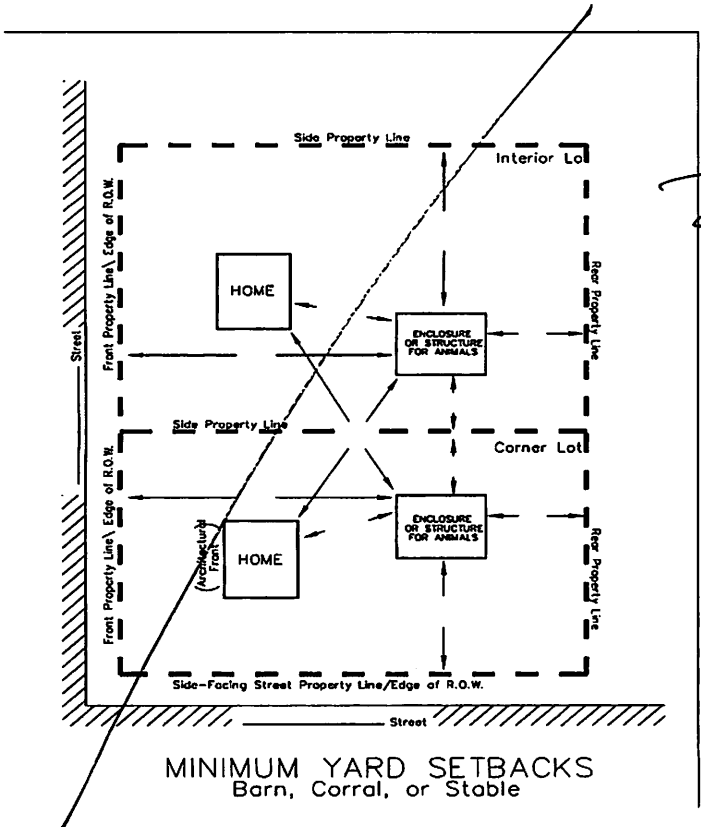
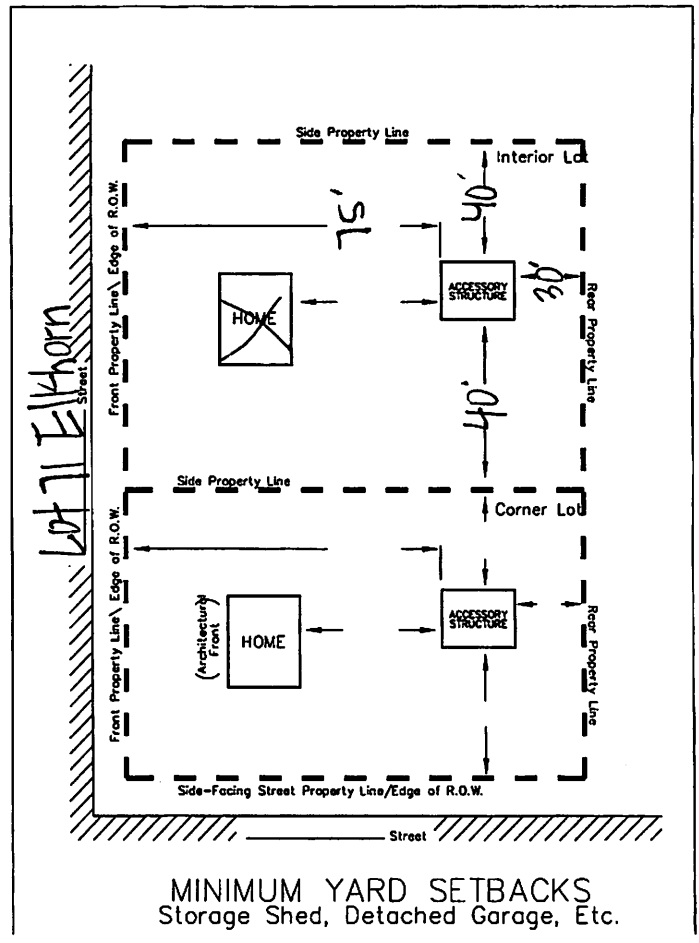
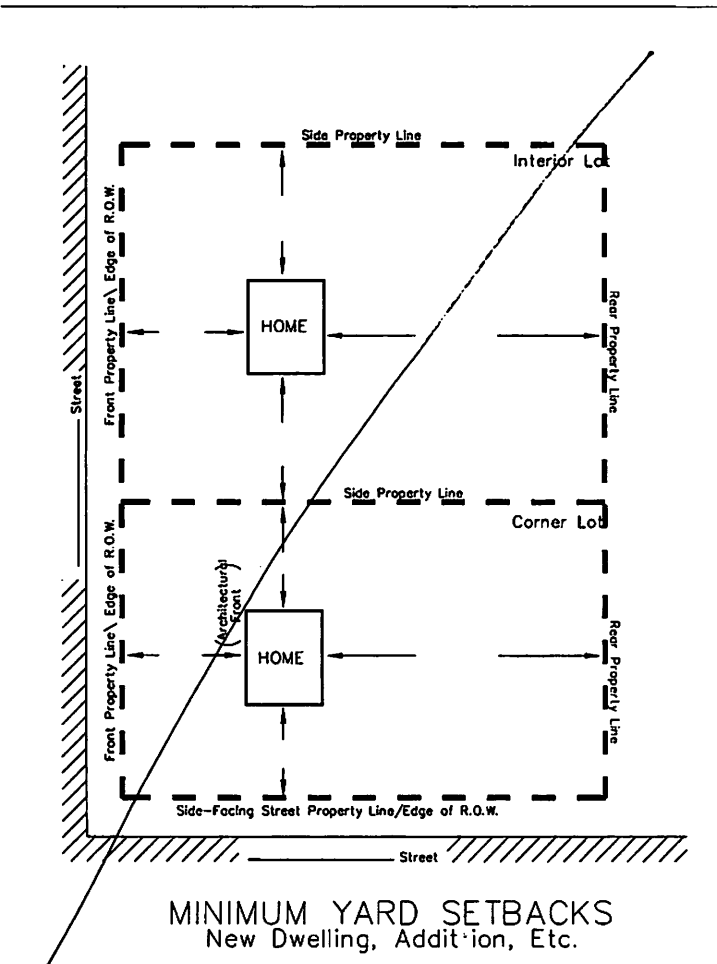

NOTICE FOR APPLICANT (Please Read Before Signing)

Proposals for the installation of an individual water supply and for a sanitary waste disposal system (septic tank) for any structure designed for human occupation must be approved by the Weber County Health Department prior to installation.

Paul Kiper 5/23/16
 Planning Dept. Signature of Approval Date

This permit becomes null and void if use or construction authorized has not commenced within 180 days or if there is a zone change affecting this property. I hereby certify that I have read and examined this application and know the same to be true and correct. All provisions of laws and ordinances governing this land use will be complied with whether specified herein or not. I make this statement under penalty of perjury. I hereby agree to make the requirements as specified on this permit issued to the owner of land as signed below.

Kelli Anderson 5/23/16
 Contractor/Owner Signature of Approval Date

Weber County Land Use Permit Application

Application submittals are recommended to be submitted with an appointment.
(801) 399-8791. 2380 Washington Blvd. Suite 240, Ogden, UT 84401

Date Submitted / Completed

Fees (Office Use)

Receipt Number (Office Use)

Property Owner Contact Information

Name

Kellie Anderson

Mailing Address

Phone

801-668-1607

Fax

Email Address

kbradford@gmail.com

Preferred Method of Written Correspondence

Email Fax Mail

Authorized Representative Contact Information

Name of Person Authorized to Represent the Property Owner(s)

Mailing Address of Authorized Person

Phone

Fax

Email Address

Preferred Method of Written Correspondence

Email Fax Mail

Property Information

Address

Sourdough wilderness Ranch
2732 North Highway 39
Huntsville, UT 84317

Land Serial Number(s)

23-013-0010

Subdivision Name

Elkhorn

Lot Number

71

Current Zoning

F-40

Acreage

1/2

Culinary Water Provider

NA

Secondary Water Provider

NA

Waste Water Provider

NA

Frontage

Detailed Description of Proposed Use/Structure

Property Owner Affidavit

— Sourdough HOA approval —

I (We), Bud Sargent ~~depose and say that I (we) am (are) the owner(s) of the property identified in this application and that the statements herein contained, the information provided in the attached plans and other exhibits are in all respects true and correct to the best of my (our) knowledge.~~

* See attached signature for owner/tenant

(Property Owner)

(Property Owner)

Subscribed and sworn to me this _____ day of _____, 20 _____

(Notary)

Authorized Representative Affidavit

I (We), _____, the owner(s) of the real property described in the attached application, do authorized as my (our) representative(s), _____, to represent me (us) regarding the attached application and to appear on my (our) behalf before any administrative or legislative body in the County considering this application and to act in all respects as our agent in matters pertaining to the attached application.

(Property Owner)

(Property Owner)

Dated this _____ day of _____, 20 _____, personally appeared before me _____, the signer(s) of the Representative Authorization Affidavit who duly acknowledged to me that they executed the same.

(Notary)

Weber County Land Use Permit Application

Application submittals are recommended to be submitted with an appointment.
(801) 399-8791. 2380 Washington Blvd. Suite 240, Ogden, UT 84401

Date Submitted / Completed

Fees (Office Use)

Receipt Number (Office Use)

Property Owner Contact Information

Name

Kellie Anderson

Mailing Address

Phone

Fax

Email Address

Preferred Method of Written Correspondence

Email Fax Mail

Authorized Representative Contact Information

Name of Person Authorized to Represent the Property Owner(s)

Mailing Address of Authorized Person

Phone

Fax

Email Address

Preferred Method of Written Correspondence

Email Fax Mail

Property Information

Address

Courtdough Wilderness

Land Serial Number(s)

23-013-0010

Subdivision Name

Elkhorn

Lot Number

71

Current Zoning

F-40

Acreage

Culinary Water Provider

N/A

Secondary Water Provider

N/A

Waste Water Provider

N/A

Frontage

Detailed Description of Proposed Use/Structure

Property Owner Affidavit

I (We), Kellie Anderson, depose and say that I (we) am (are) the owner(s) of the property identified in this application and that the statements herein contained, the information provided in the attached plans and other exhibits are in all respects true and correct to the best of my (our) knowledge.

* Kellie Anderson

(Property Owner)

(Property Owner)

Subscribed and sworn to me this _____ day of _____, 20 _____

(Notary)

Authorized Representative Affidavit

I (We), _____, the owner(s) of the real property described in the attached application, do authorized as my (our) representative(s), _____, to represent me (us) regarding the attached application and to appear on my (our) behalf before any administrative or legislative body in the County considering this application and to act in all respects as our agent in matters pertaining to the attached application.

(Property Owner)

(Property Owner)

Dated this _____ day of _____, 20 _____, personally appeared before me _____, the signer(s) of the Representative Authorization Affidavit who duly acknowledged to me that they executed the same.

(Notary)

- Material - walls 2x4 (16" centers) / 1" III - siding
- Floor 2x6 pressure treated (16" centers) 3/4" ply wood.
- Roof 2x4 (16" centers) 1/2" partial board / Tin 5:12 pitch

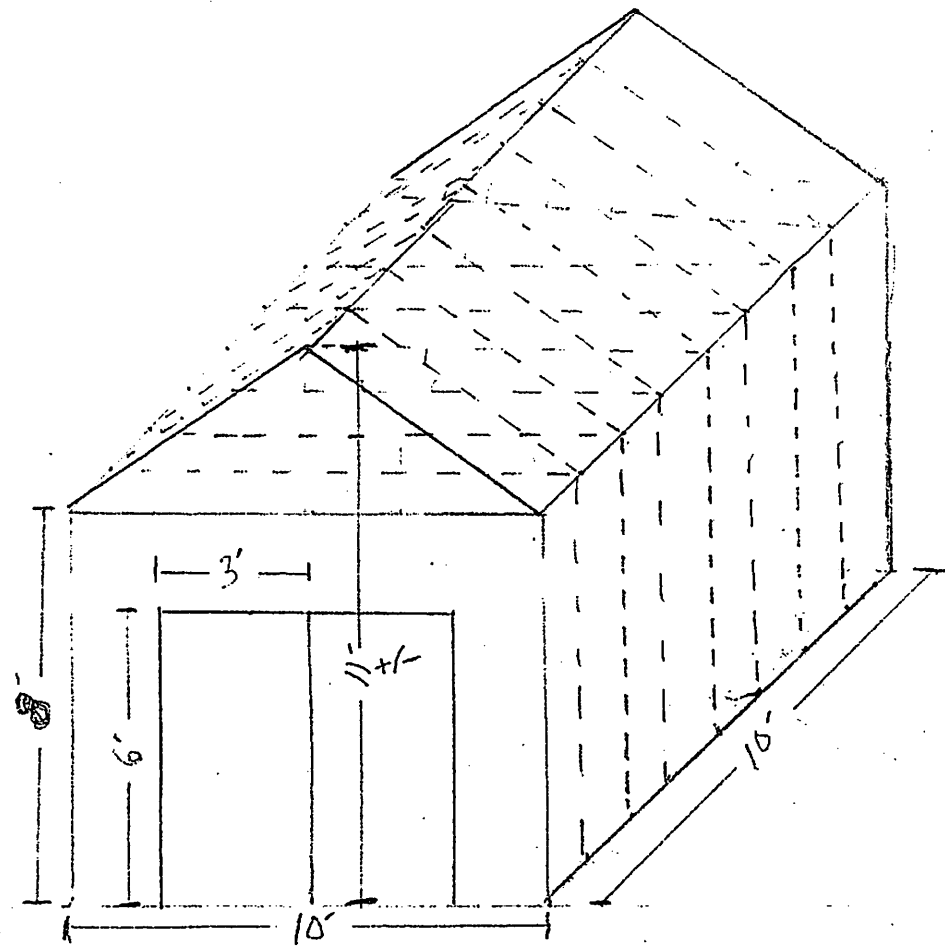



Weber County Corporation

Weber County
2380 Washington Blvd
Ogden UT 84401

Customer Receipt	
Receipt Number	13711

Receipt Date
05/23/16

Received From:
Anderson

Time: 16:45
Clerk: tbennett

Description	Comment	Amount
land use	land use	\$20.00

Payment Type	Quantity	Ref	Amount
CASH			

AMT TENDERED: \$20.00
 AMT APPLIED: \$20.00
 CHANGE: \$0.00