

Date: 5/16/2016

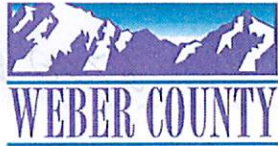

Planning Commission Land Use Permit

Page 1 of 2

Printed: 5/16/2016

Permit Number: LUP388-2016

Applicant

Name: THORSON, SHANE R & WF
Address: 6678 W 1900 N

Phone:

Owner

Name: THORSON, SHANE R & WF
Address: 6678 W 1900 N

Phone:

Parcel

Parcel Number: 191440001

Total Parcel Area:

Address: 6678 W 1900 N

Zoning:

(*If Zoned S-1, See Specific Height Requirements)

****See Diagram on Back Side for Setbacks**

SW 1/4 Section: 36

Township: 7N

Range: 3W

Subdivision:

Lot(s):

Proposed Structure: New Outbuilding

Structure Area Used: 200

Is Structure > 1,000 Sq. Ft.?

*If True, Need Certif. Statement

of Dwelling Units: 1

of Accessory Bldgs: 1

Off-Street Parking Req'd: 2



Permit Checklist:

Public by/Right of Use Road?

> 200 ft. from Paved Road? No

< 4218 ft. above Sea Level? Yes

Culvert Required? No

Wetlands/Flood Zone? No

If Yes, Culvert Size:

***Any Work in the Right of Way requires an Excavation Permit**

Additional Frontage Req'd.? no

OR Special Exception? Case #

Meet Zone Area & Frontage? True

Hillside Review Req'd.? No Case #

Culinary Water District: NA

Waste Water System: NA

Comments: This permit is for a new 200 sq ft shed to the side of the home.

Structure Setback Graphic:

Storage Shed, DetachedGarage,etc

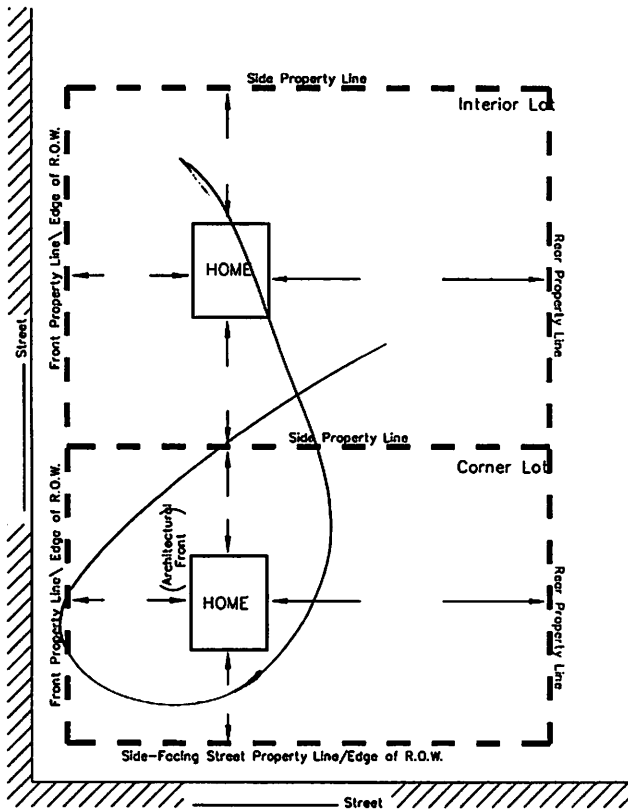

MINIMUM YARD SETBACKS
New Dwelling, Addition, Etc.

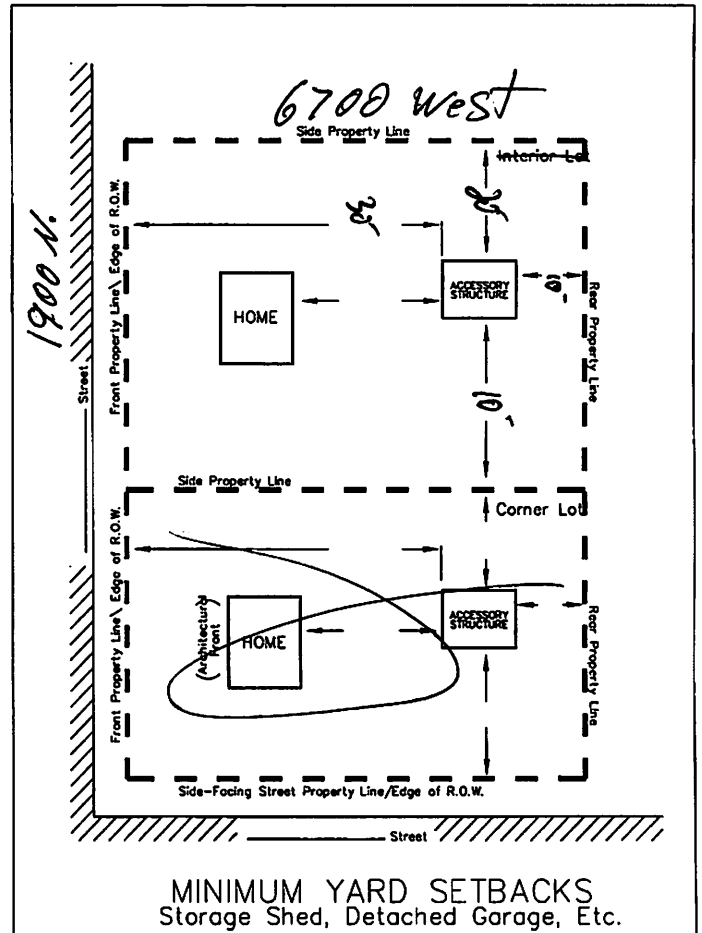

MINIMUM YARD SETBACKS
Storage Shed, Detached Garage, Etc.

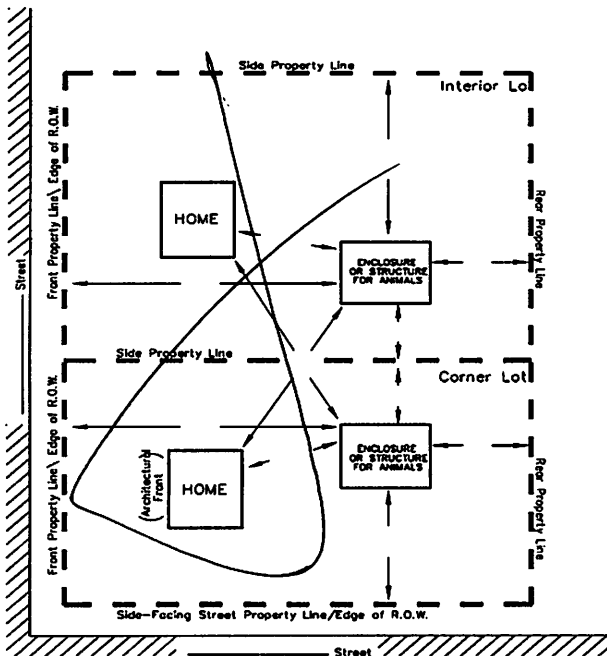

MINIMUM YARD SETBACKS
Barn, Corral, or Stable

NOTICE FOR APPLICANT (Please Read Before Signing)

Proposals for the installation of an individual water supply and for a sanitary waste disposal system (septic tank) for any structure designed for human occupation must be approved by the Weber County Health Department prior to installation.

[Signature] 5/16/16
 Planning Dept/Signature of Approval Date

This permit becomes null and void if use or construction authorized has not commenced within 180 days or if there is a zone change affecting this property. I hereby certify that I have read and examined this application and know the same to be true and correct. All provisions of laws and ordinances governing this land use will be complied with whether specified herein or not. I make this statement under penalty of perjury. I hereby agree to make the requirements as specified on this permit issued to the owner of land as signed below.

[Signature] 27 May 16
 Contractor/Owner Signature of Approval Date

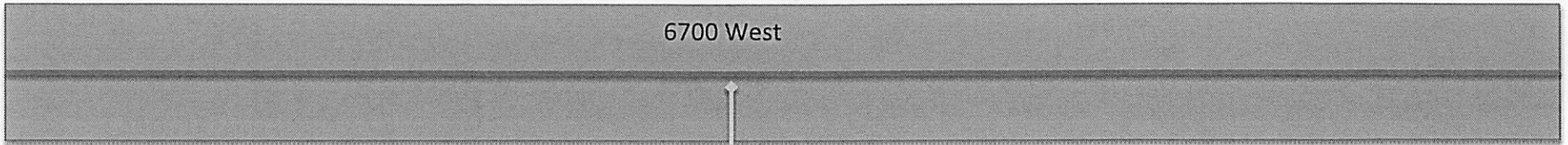

6700 West

50'

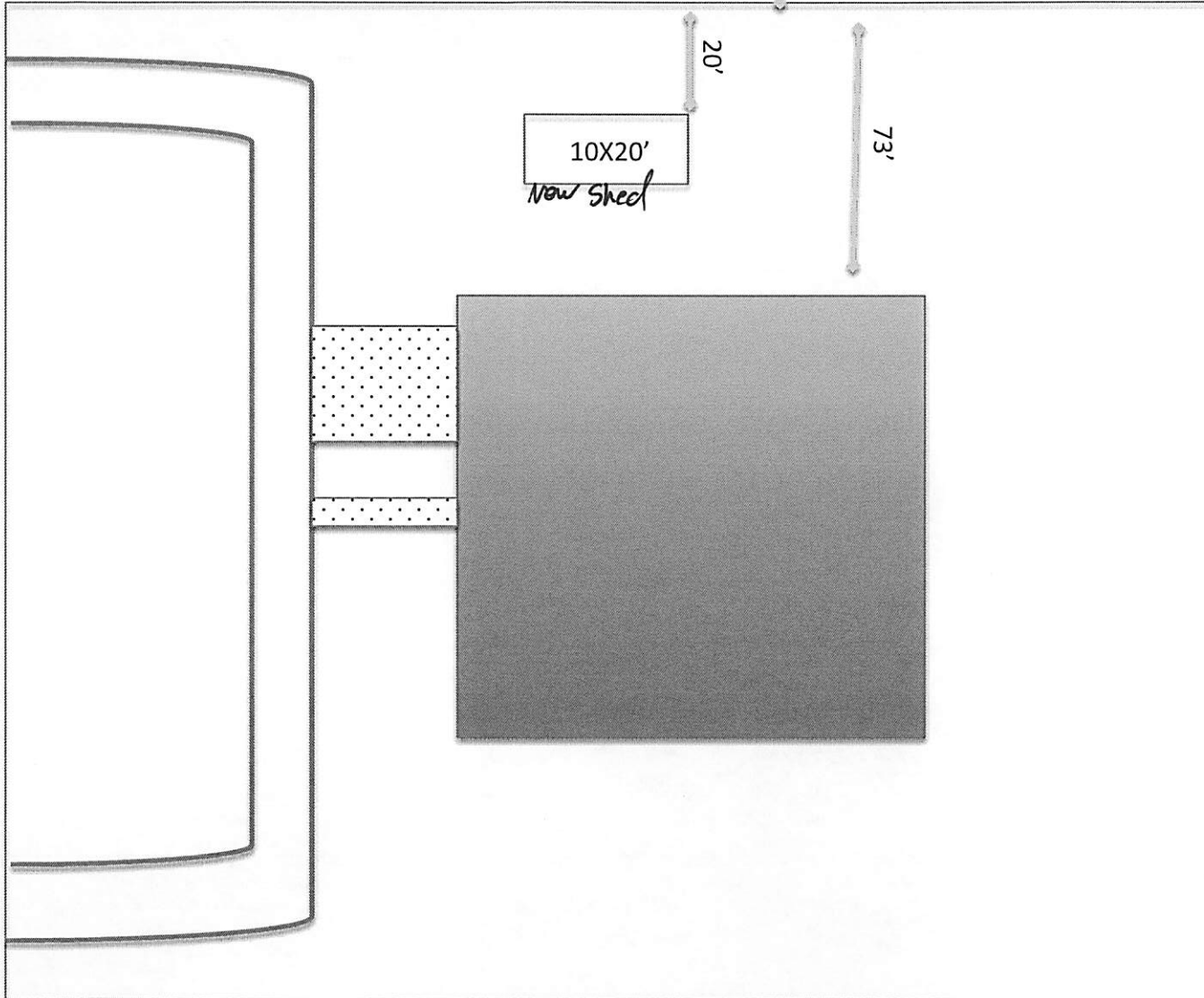

Shane Thorson
19-144-0001
6678 West 1900 N



Weber County Corporation

Weber County
2380 Washington Blvd
Ogden UT 84401

Customer Receipt	
Receipt Number	13048

Receipt Date
05/16/16

Received From:
shane thorson

Time: 16:27
Clerk: amartin

Description	Comment	Amount
zoning fees	land use permit	\$50.00

Payment Type	Quantity	Ref	Amount
CHECK		10074867	

AMT TENDERED: \$50.00
AMT APPLIED: \$50.00
CHANGE: \$0.00