

Weber County Stormwater Construction Activity Permit

Application submittals will be accepted by appointment only. (801) 399-8374. 2380 Washington Blvd. Suite 240, Ogden, UT 84401

Date Submitted <i>1-14-16</i>	Fees (Office Use) <i>_____</i>	Receipt Number (Office Use) <i>_____</i>	Priority Site (Office Use) <input type="radio"/> Yes <input checked="" type="radio"/> No	Permit Number (Office Use) <i>2016-02</i>
----------------------------------	-----------------------------------	---	---	--

Property Owner/Authorized Representative Contact Information		Project Information					
Name of Property Owner(s)/Authorized Representative(s) <i>Keith Watson</i>		Project Name <i>Watson Garage</i>					
Phone <i>801 452-5020</i>	Fax <i>_____</i>	Project Address <i>4135 E River Dr Eden UT 84310</i>					
Email Address <i>kw4185@htrmail.com</i>		<table border="1" style="width: 100%; border-collapse: collapse;"> <tr> <td style="width: 50%;">Estimated Project Length (mo) <i>6 months</i></td> <td style="width: 50%;">Previous Permit No. (if applicable)</td> </tr> <tr> <td>Estimated Start Date</td> <td>Actual Start Date</td> </tr> </table>		Estimated Project Length (mo) <i>6 months</i>	Previous Permit No. (if applicable)	Estimated Start Date	Actual Start Date
Estimated Project Length (mo) <i>6 months</i>	Previous Permit No. (if applicable)						
Estimated Start Date	Actual Start Date						
Mailing Address of Property Owner(s)/Authorized Representative(s) <i>4135 E River Dr Eden UT 84310</i>							

Submittal Checklist

The application shall include a Storm Water Pollution Prevention Plan which meets the criteria set forth in Section 40-3-4 of the county ordinances.

The applicant shall file the application on or before the following dates:

Subdivision: The date that the applicant submits the preliminary subdivision development plat application.

Site Plan: The date that the applicant submits a site plan application or amended site plan.

Building Permit: The date that the applicant submits a building permit application if the applicant proposes to construct a building on an existing lot or parcel.

Land Use Permit: The date that the applicant submits a land use permit application.

Other: At least two (2) weeks before the developer intends to perform any type of work not listed above that would require a Storm Water Construction Activity Permit pursuant to this Chapter.

Failure to acquire a required Storm Water Construction Activity Permit is grounds for tabling a related subdivision application, site plan application, conditional use permit application, or building permit application. It is unlawful to commence work (move dirt) on a development site before obtaining a required Storm Water Construction Activity Permit.

Note: A pre-construction meeting is required before performing any on-site earth work, unless waived by the county engineer.

Applicant Narrative

Please explain your request.

Garage

Authorization

By signing below the Owner / Representative authorizes the county to enter the property to perform inspections.

Owner or Authorized Representative Signature <i>Keith Watson</i>	Date <i>1-20-16</i>
Signature of Approval <i>_____</i>	Date <i>1-14-16</i>

- 1-1600 sqft
- 2-Solitude Builders
- 3-~~6" mound~~ 6" mound
- 4-Hauled off site

- 5-Hauled off site
- 6-Staked Down
- 7 Gravel Driveway
- 8 Yes 6" mound around Building site
- 9- stays onsite

1. ALL FOUNDATIONS AND SITES SHALL BE SET UP ON SITE DURING THE PERIOD OF CONSTRUCTION AND SHALL BE MAINTAINED THROUGHOUT THE CONSTRUCTION PERIOD.
2. THE GRADE SHALL BE MAINTAINED AS NEAR AS POSSIBLE TO THE ORIGINAL GRADE AND SHALL BE MAINTAINED THROUGHOUT THE CONSTRUCTION PERIOD.
3. THE GRADE SHALL BE MAINTAINED AS NEAR AS POSSIBLE TO THE ORIGINAL GRADE AND SHALL BE MAINTAINED THROUGHOUT THE CONSTRUCTION PERIOD.
4. THE GRADE SHALL BE MAINTAINED AS NEAR AS POSSIBLE TO THE ORIGINAL GRADE AND SHALL BE MAINTAINED THROUGHOUT THE CONSTRUCTION PERIOD.
5. THE GRADE SHALL BE MAINTAINED AS NEAR AS POSSIBLE TO THE ORIGINAL GRADE AND SHALL BE MAINTAINED THROUGHOUT THE CONSTRUCTION PERIOD.
6. THE GRADE SHALL BE MAINTAINED AS NEAR AS POSSIBLE TO THE ORIGINAL GRADE AND SHALL BE MAINTAINED THROUGHOUT THE CONSTRUCTION PERIOD.
7. THE GRADE SHALL BE MAINTAINED AS NEAR AS POSSIBLE TO THE ORIGINAL GRADE AND SHALL BE MAINTAINED THROUGHOUT THE CONSTRUCTION PERIOD.
8. THE GRADE SHALL BE MAINTAINED AS NEAR AS POSSIBLE TO THE ORIGINAL GRADE AND SHALL BE MAINTAINED THROUGHOUT THE CONSTRUCTION PERIOD.
9. THE GRADE SHALL BE MAINTAINED AS NEAR AS POSSIBLE TO THE ORIGINAL GRADE AND SHALL BE MAINTAINED THROUGHOUT THE CONSTRUCTION PERIOD.

SITE PLAN
 4135 EAST RIVER DRIVE
 EDEN, UTAH
 SCALE: 1" = 20'-0"
 AREA: 2.25 AC ±

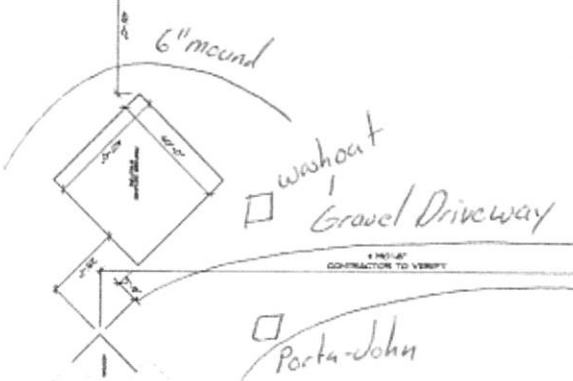

PLEASE NOTE:
 THIS SITE PLAN IS A REPRESENTATION OF THE PROPOSED FOUNDATIONAL CONSTRUCTION AND IS NOT A CONTRACT DOCUMENT. THE CONTRACTOR SHALL BE RESPONSIBLE FOR OBTAINING ALL NECESSARY PERMITS AND FOR VERIFYING THE ACCURACY OF ALL INFORMATION PROVIDED HEREON. THE CONTRACTOR SHALL BE RESPONSIBLE FOR OBTAINING ALL NECESSARY PERMITS AND FOR VERIFYING THE ACCURACY OF ALL INFORMATION PROVIDED HEREON.

LEGEND
 --- PROPERTY LINE
 --- SETBACK LINE
 --- EXISTING HOME FOOTPRINT
 --- NEW ADDITION FOOTPRINT

HABITATIONS
 1000 S. 1000 E. SUITE 100
 WASHINGTON, UT 84787
 (435) 734-1111
 WWW.HABITATIONS.COM

HABITATIONS
 AUTHORIZED COPY
 ALL RIGHTS RESERVED
 10/2015