

# Weber County Stormwater Construction Activity Permit

Application submittals will be accepted by appointment only. (801) 399-8374. 2380 Washington Blvd. Suite 240, Ogden, UT 84401

Date Submitted <b>6-24-15</b>	Fees (Office Use) _____	Receipt Number (Office Use) _____	Priority Site (Office Use) <input type="radio"/> Yes <input checked="" type="radio"/> No	Permit Number (Office Use) <b>205-46</b>
----------------------------------	----------------------------	--------------------------------------	---	---

Property Owner/Authorized Representative Contact Information		Project Information	
Name of Property Owner(s)/Authorized Representative(s) JSC Custom Homes and Remodeling		Project Name Dunn Residence	
Phone (801) 430-6622	Fax (801) 745-2512	Project Address 1034 N 7100 E Huntsville Ut 84317	
Email Address jed@jsc-builders.com			
Mailing Address of Property Owner(s)/Authorized Representative(s) 1245 S 9400 E Huntsville Ut 84317			
		Estimated Project Length (mo) 10	Previous Permit No. (if applicable)
		Estimated Start Date 7-21-2015	Actual Start Date

## Submittal Checklist

The application shall include a Storm Water Pollution Prevention Plan which meets the criteria set forth in Section 33-3-4 of the county ordinances.

The applicant shall file the application on or before the following dates:

**Subdivision:** The date that the applicant submits the preliminary subdivision development plat application.

**Site Plan:** The date that the applicant submits a site plan application or amended site plan.

**Building Permit:** The date that the applicant submits a building permit application if the applicant proposes to construct a building on an existing lot or parcel.

**Land Use Permit:** The date that the applicant submits a land use permit application.

**Other:** At least two (2) weeks before the developer intends to perform any type of work not listed above that would require a Storm Water Construction Activity Permit pursuant to this Chapter.

Failure to acquire a required Storm Water Construction Activity Permit is grounds for tabling a related subdivision application, site plan application, conditional use permit application, or building permit application. It is unlawful to commence work (move dirt) on a development site before obtaining a required Storm Water Construction Activity Permit.

Note: A pre-costruction meeting is required before performing any on-site earth work, unless waived by the county engineer.

## Applicant Narrative

Please explain your request.

## Authorization

By signing below the Owner / Representative authorizes the county to enter the property to perform inspections.

Owner or Authorized Representative Signature 	Date <b>6-24-15</b>
Signature of Approval 	Date <b>6-25-15</b>

# DUNN Residence. Supp Plan.

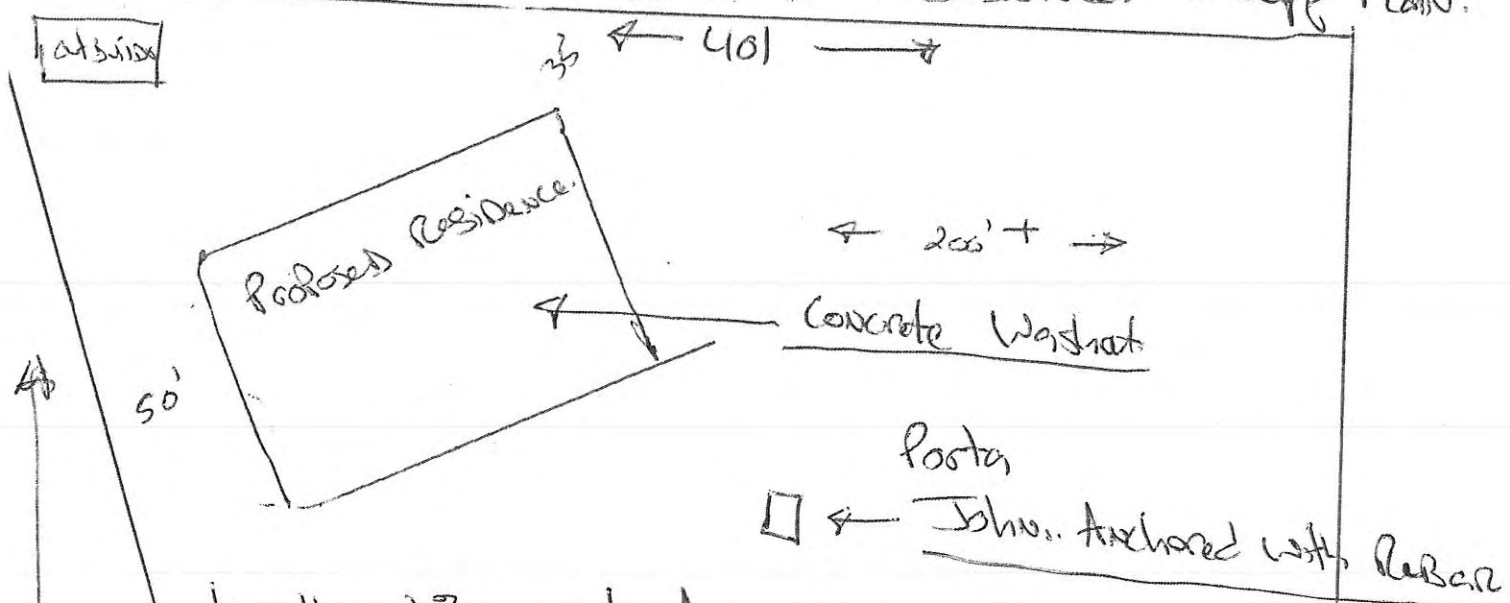

less than 2% slope  
Natural Vegetation.  
Silt screen.

1. Approximately 4000 sqft Disturbed
2. Responsible Party : JED SLANTA
3. No Neighbors In close proximity
4. Excavation Spoil Stored onsite
5. Concrete Washout In Excavation.
6. Posta Johns located on site map.
7. Entrance. is 400' long & will be Gravel
8. Any and all mats will be removed from Roadways.
9. The Swell located at the west end. with have a culvert
10. Storm water will Drain Into Existing Soils.
11. No other Occupation

500'

N

