

Date:

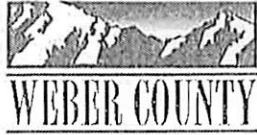

Planning Commission Land Use Permit

Page 1 of 2

Printed: 7/21/2015

Permit Number: LUP175-2015

Applicant

Name: Weber School District
Address: 5320 Adams Ave Parkway

Phone: 801-476-7800

Owner

Name: Weber School District
Address: 5320 Adams Ave Parkway

Phone: 801-476-7800

Parcel

Parcel Number: 150800058

Zoning: A-1

Total Parcel Area: 52 Acres

(*If Zoned S-1, See Specific Height Requirements)

Address: 4452 West 2200 South
Ogden, UT 84401

**See Diagram on Back Side for Setbacks

Section: 29

Township: 6 N

Range: 2 W

Subdivision:

Lot(s):

Proposed Structure: Acricultural

Structure Area Used: 4800

Is Structure > 1,000 Sq. Ft.? True *If True, Need Certif. Statement

of Dwelling Units: 0

of Accessory Bldgs: 2

Off-Street Parking Req'd: 0



Permit Checklist:

Public by/Right of Use Road?

> 200 ft. from Paved Road? No

< 4218 ft. above Sea Level? NA

Wetlands/Flood Zone? NA

Culvert Required? NA

If Yes, Culvert Size:

***Any Work in the Right of Way requires an Excavation Permit**

Additional Frontage Req'd.? No

OR Special Exception? False Case #

Meet Zone Area & Frontage? True

Hillside Review Req'd.? NA Case #

Culinary Water District: NA

Waste Water System: NA

Comments: Setbacks for animals: 40 feet from any dwelling and not closer than 75 feet from any dwelling on an adjacent lot, 100 feet from a property line adjacent to a street and not less than 25 feet from any lot line
LUC #104-5-5 Permitted uses in the A-1 zone on lots larger than 5 acres states:
"The keeping and raising of not more than ten hogs, more than 16 weeks old, provided that no person shall feed any such hog any market refuse, house refuse, garbage or offal other than that produced on the premises."

Structure Setback Graphic: Barns, Corrals, or Stables

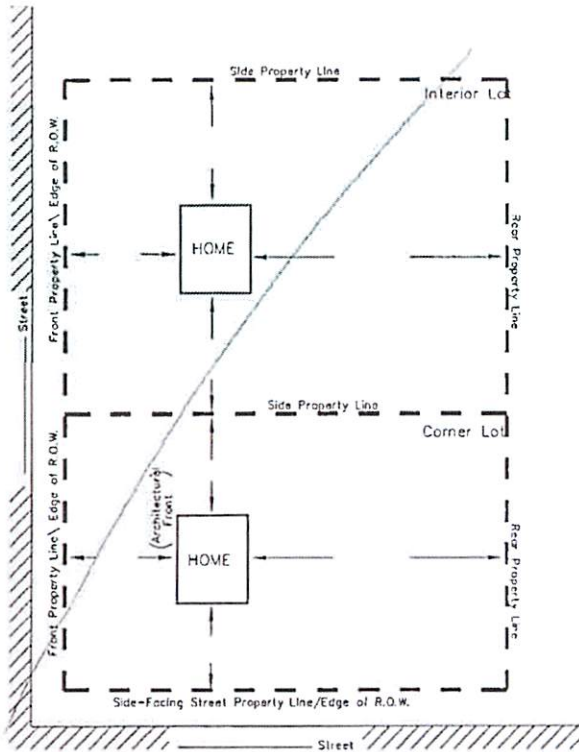

MINIMUM YARD SETBACKS
New Dwelling, Addition, Etc.

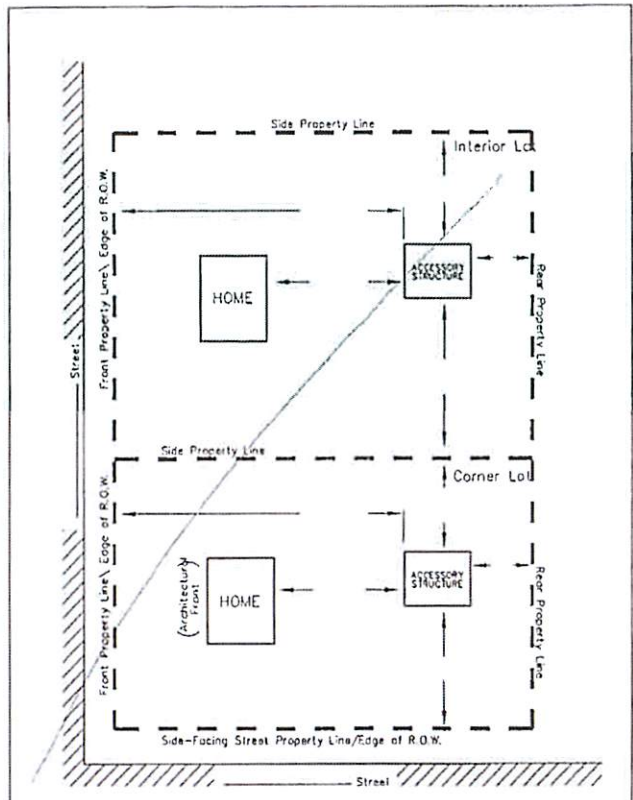

MINIMUM YARD SETBACKS
Storage Shed, Detached Garage, Etc.

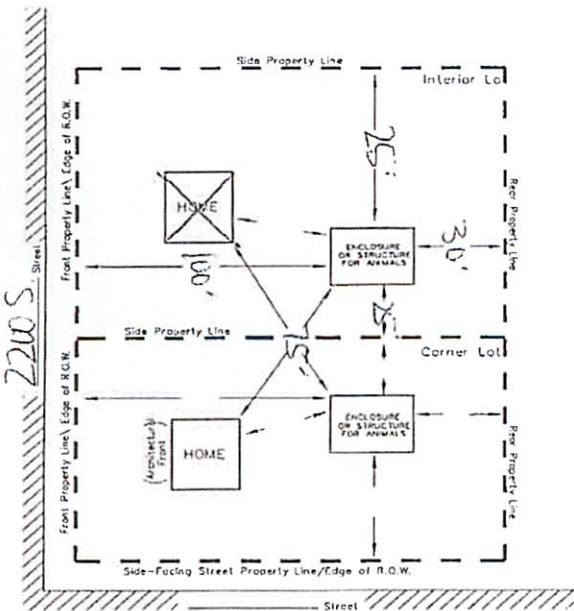

MINIMUM YARD SETBACKS
Barn, Corral, or Stable

NOTICE FOR APPLICANT (Please Read Before Signing)

Proposals for the installation of an individual water supply and for a sanitary waste disposal system (septic tank) for any structure designed for human occupation must be approved by the Weber County Health Department prior to installation.

Chad Murphree 7/21/15
 Planning Dept. Signature of Approval Date

This permit becomes null and void if use or construction authorized has not commenced within 180 days or if there is a zone change affecting this property. I hereby certify that I have read and examined this application and know the same to be true and correct. All provisions of laws and ordinances governing this land use will be complied with whether specified herein or not. I make this statement under penalty of perjury. I hereby agree to make the requirements as specified on this permit issued to the owner of land as signed below.

Chad Murphree
 Contractor/Owner Signature of Approval Date