



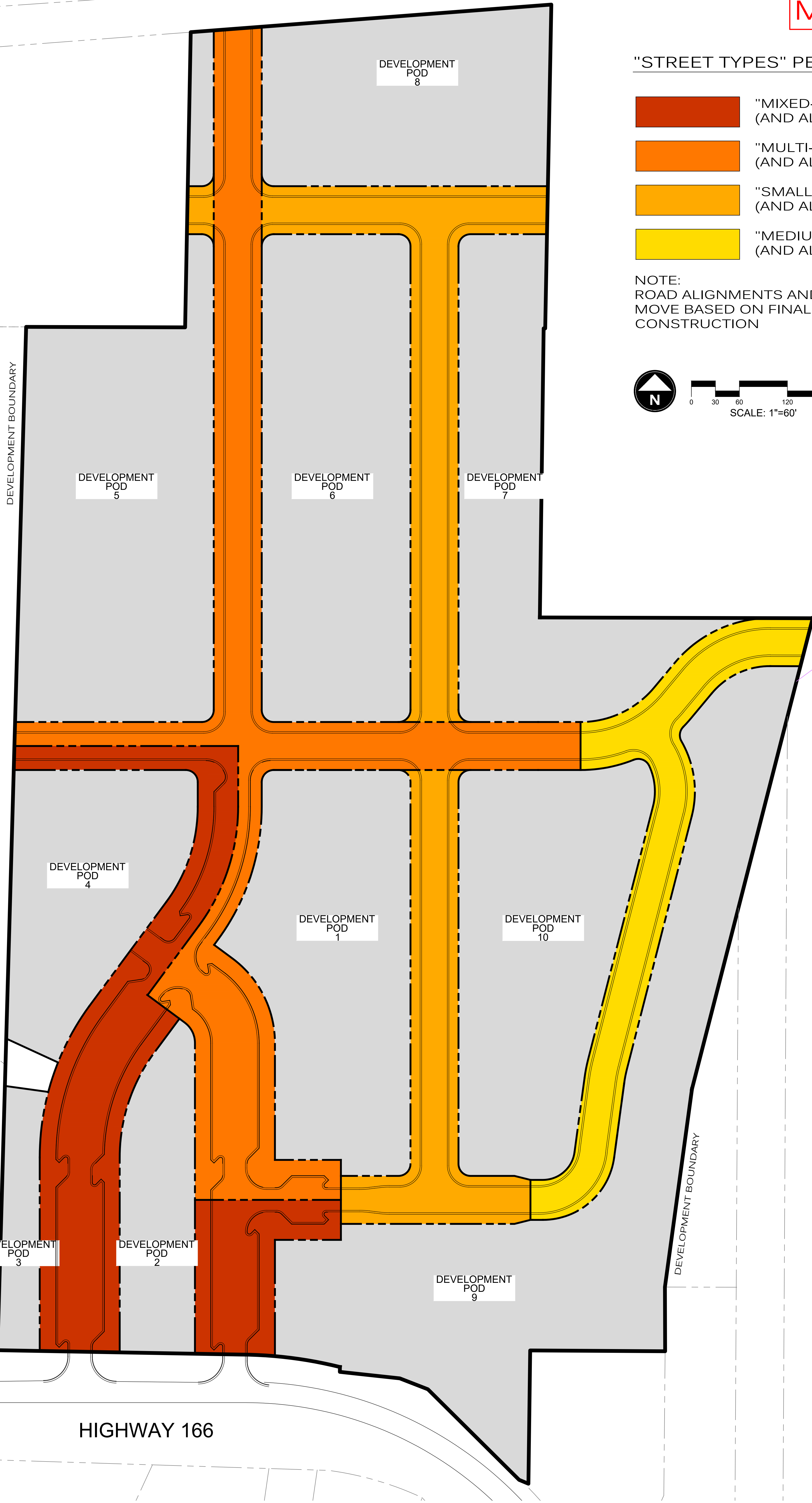
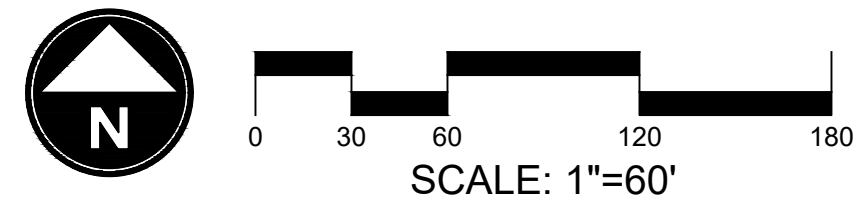


EXHIBIT B MASTER PLAN

"STREET TYPES" PER FORM-BASED ZONE

-  "MIXED-USE COMMERCIAL" (AND ALL INCLUDED USES)
-  "MULTI-FAMILY RESIDENTIAL" (AND ALL INCLUDED USES)
-  "SMALL LOT RESIDENTIAL" (AND ALL INCLUDED USES)
-  "MEDIUM LOT RESIDENTIAL" (AND ALL INCLUDED USES)

NOTE:
ROAD ALIGNMENTS AND LOT LINES SUBJECT TO
MOVE BASED ON FINAL ENGINEERING AND
CONSTRUCTION



SHEET TITLE:
MASTER PLAN

SHEET NUMBER:
EX. B

EDEN CROSSING

MASTER PLAN
WEBER COUNTY, UTAH

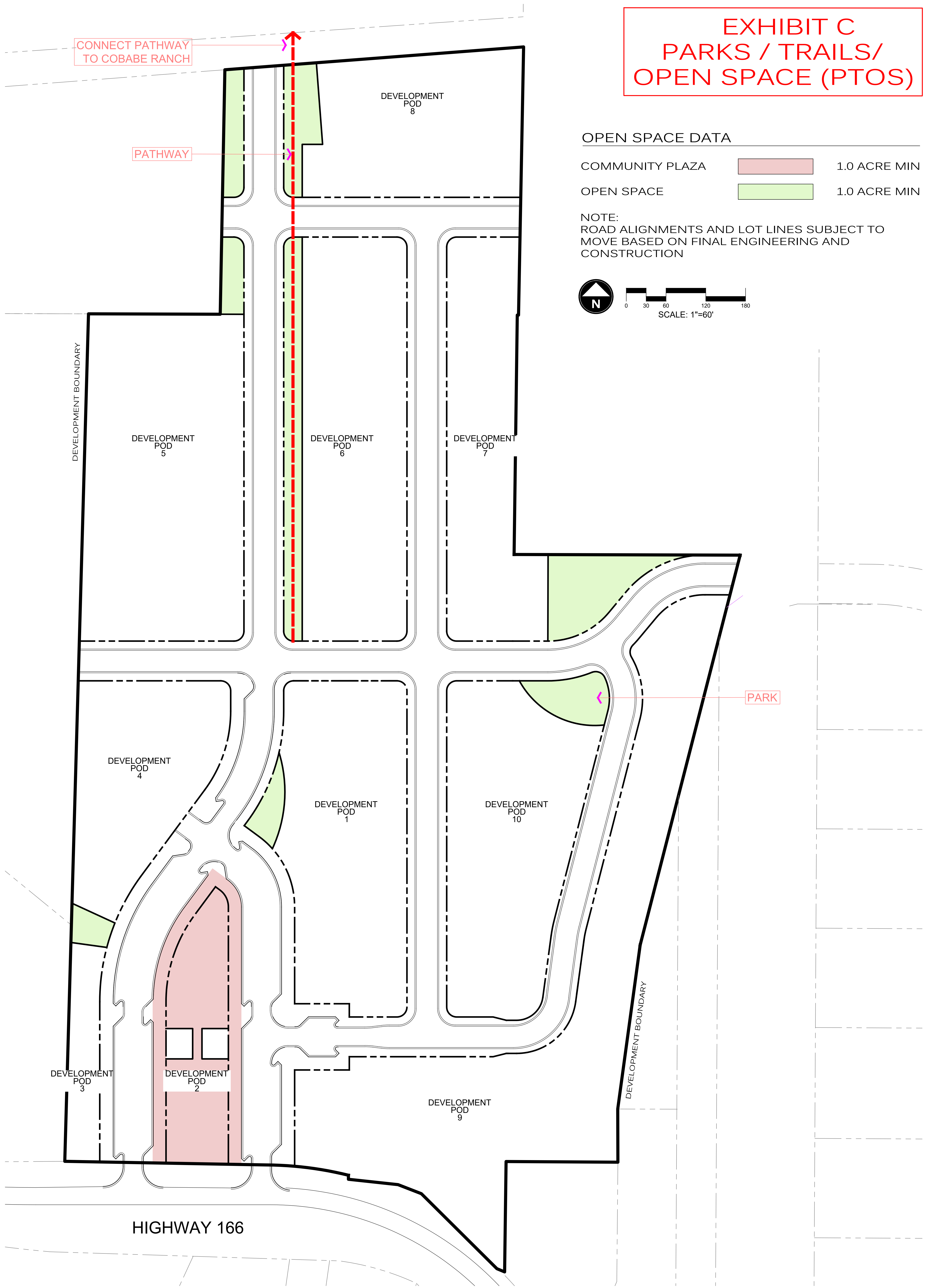
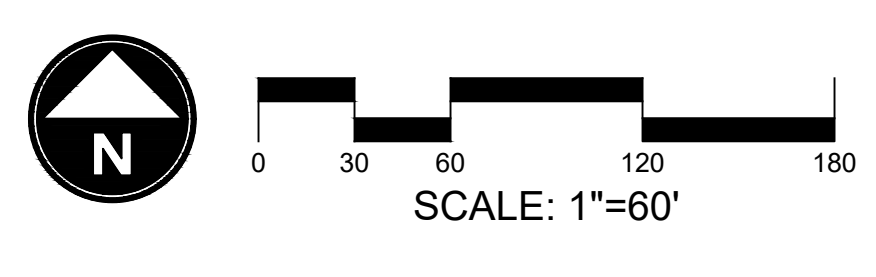


EXHIBIT C PARKS / TRAILS/ OPEN SPACE (PTOS)

OPEN SPACE DATA

COMMUNITY PLAZA		1.0 ACRE MIN
OPEN SPACE		1.0 ACRE MIN

NOTE:
ROAD ALIGNMENTS AND LOT LINES SUBJECT TO
MOVE BASED ON FINAL ENGINEERING AND
CONSTRUCTION



SHEET TITLE:
PARKS / TRAILS
OPEN SPACE (PTOS)

SHEET NUMBER:
EX. C

EDEN CROSSING

MASTER PLAN
WEBER COUNTY, UTAH

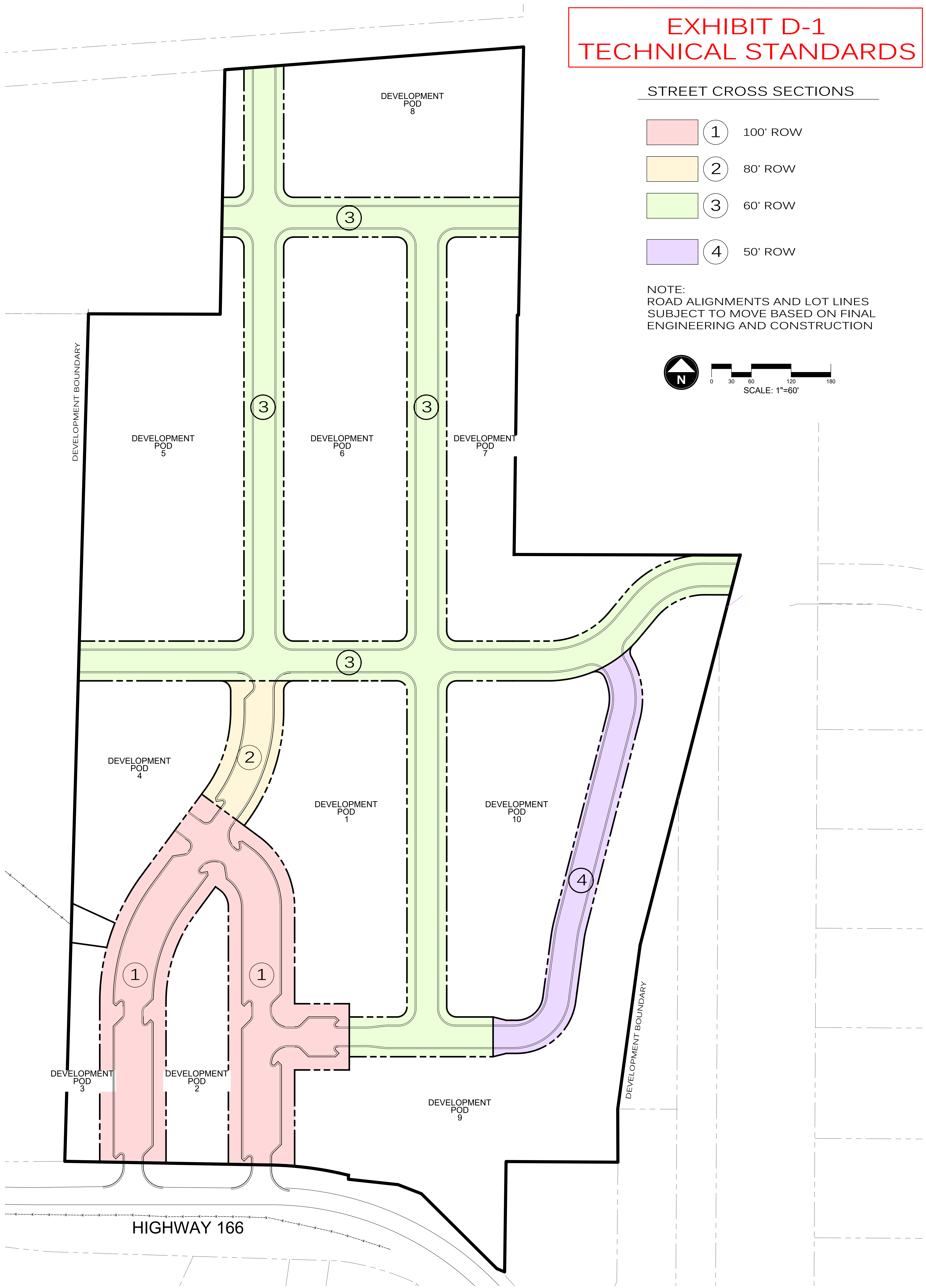
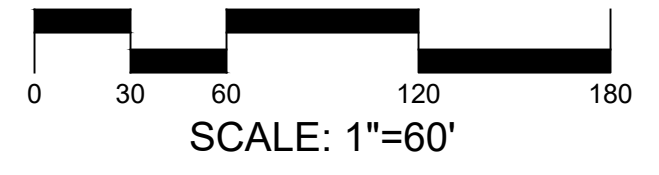


EXHIBIT D-1 TECHNICAL STANDARDS

STREET CROSS SECTIONS

- ① 100' ROW
- ② 80' ROW
- ③ 60' ROW
- ④ 50' ROW

NOTE:
ROAD ALIGNMENTS AND LOT LINES
SUBJECT TO MOVE BASED ON FINAL
ENGINEERING AND CONSTRUCTION



SHEET TITLE:
**TECHNICAL
STANDARDS**

SHEET NUMBER:
EX. D-1

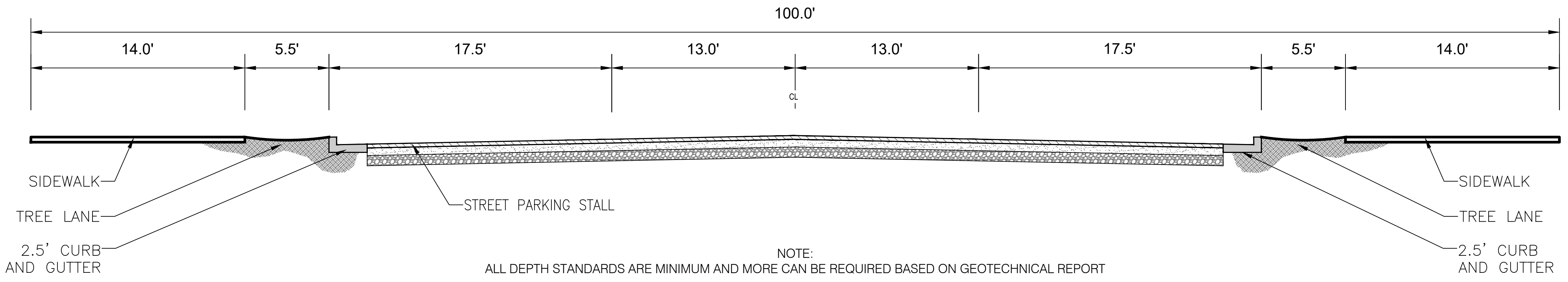
EDEN CROSSING

MASTER PLAN
WEBER COUNTY, UTAH

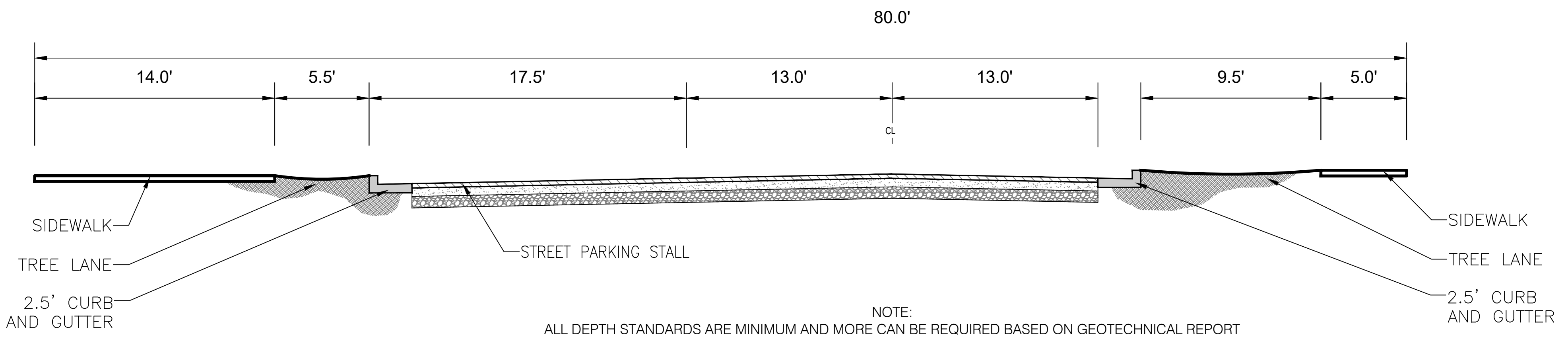


EXHIBIT D-2 TECHNICAL STANDARDS

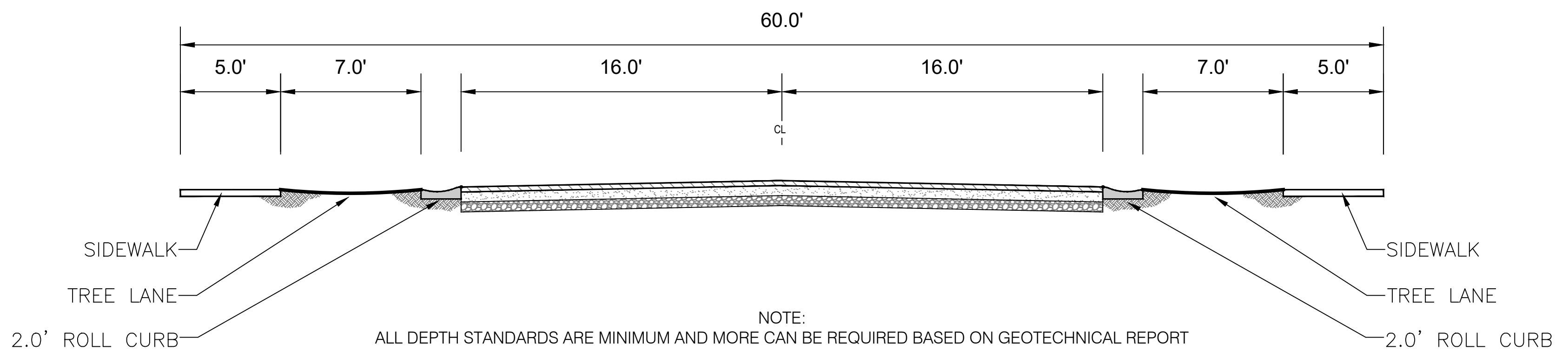
STREET CROSS SECTIONS



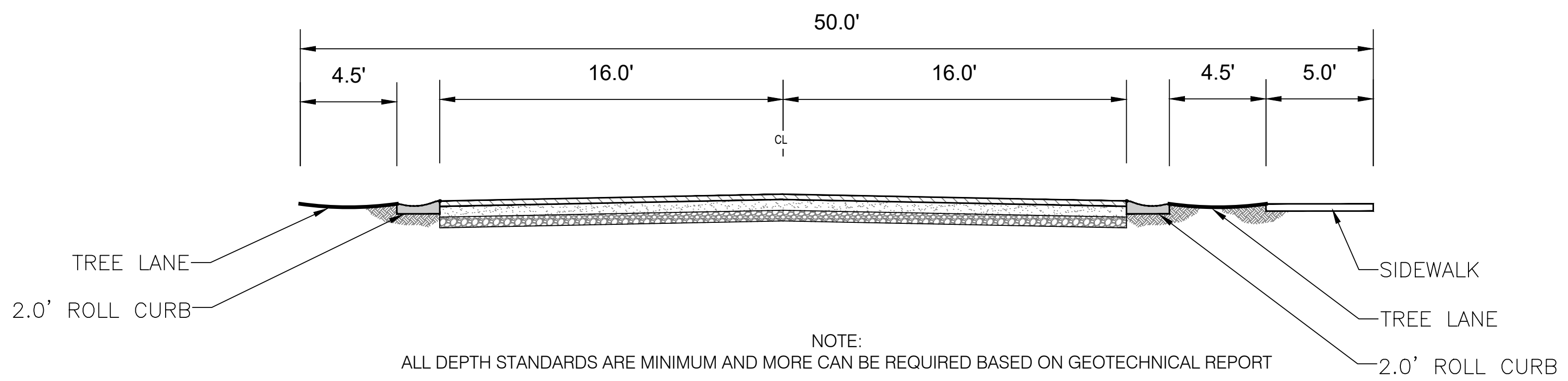
100' ROW - TYPICAL ROADWAY
NOT TO SCALE



80' ROW - TYPICAL ROADWAY
NOT TO SCALE



60' ROW - TYPICAL ROADWAY
NOT TO SCALE



50' ROW - TYPICAL ROADWAY
NOT TO SCALE

ROAD PROFILES

NOT TO SCALE

SHEET TITLE:
TECHNICAL STANDARDS

SHEET NUMBER:
EX. D-2

EDEN CROSSING

MASTER PLAN
WEBER COUNTY, UTAH

