

Planning Commission Land Use Permit

Permit Number: LUP105-2015

Applicant

Name: Blaine Land
Address: 7849 South 2100 East
Phone: 8014798306

Owner

Name: LAND, R BLAINE & WF
Address: 7849 S 2100 E
Phone:

Parcel

Parcel Number: 231120001
Total Parcel Area:
Address: 7390 JEREMIAH JOHNSON N

Zoning:
(*If Zoned S-1, See Specific Height Requirements)

****See Diagram on Back Side for Setbacks**

Section: **Township:** **Range:**
Subdivision: **Lot(s):**

Proposed Structure: RV Pad

Structure Area Used:

Is Structure > 1,000 Sq. Ft.? *If True, Need Certif. Statement

of Dwelling Units: 0 **# of Accessory Bldgs:** 0 **# Off-Street Parking Reqd:**



Permit Checklist:

Public by/Right of Use Road?			
> 200 ft. from Paved Road?	<u>No</u>		
< 4218 ft. above Sea Level?		<u>Wetlands/Flood Zone?</u>	<u>No</u>
Culvert Required?	<u>?</u>	If Yes, Culvert Size:	
*Any Work in the Right of Way requires an Excavation Permit			
Additional Frontage Reqd.?	<u>No</u>	OR Special Exception?	Case #
Meet Zone Area & Frontage?	<u>True</u>	Hillside Review Reqd.?	Case #
Culinary Water District:	<u>Sunridge</u>	Waste Water System:	<u>Individual</u>

Comments: renewl of a land use permit for a rv in Sunridge Highlands #4

Structure Setback Graphic: RV Pad

RV pad

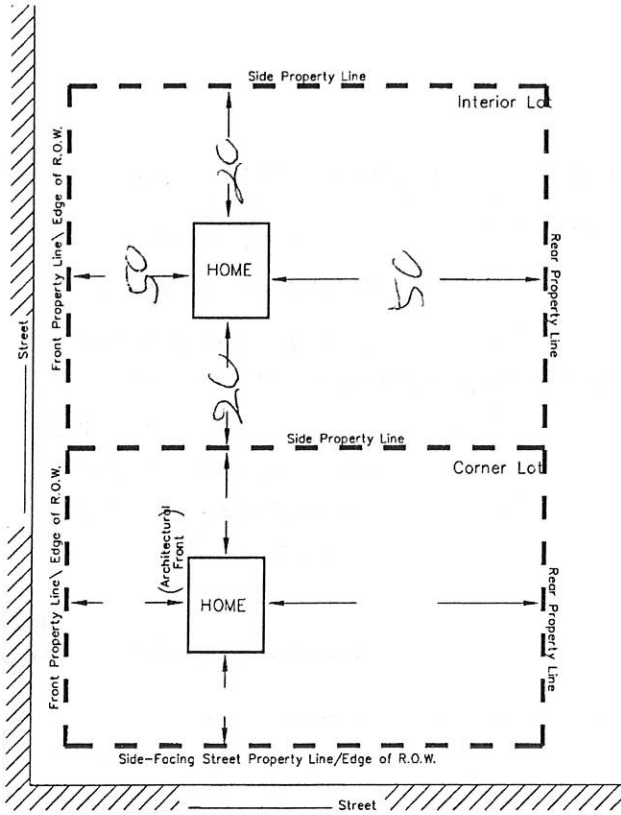

MINIMUM YARD SETBACKS
New Dwelling, Addition, Etc.

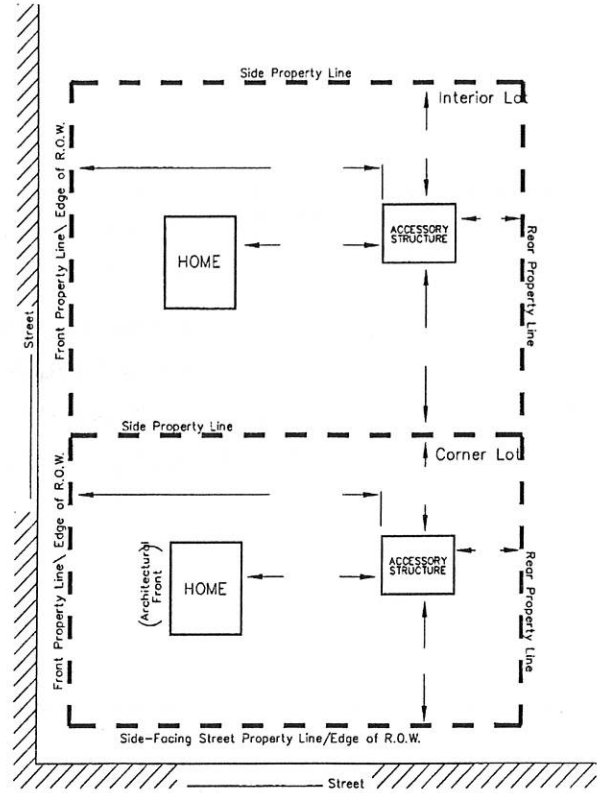

MINIMUM YARD SETBACKS
Storage Shed, Detached Garage, Etc.

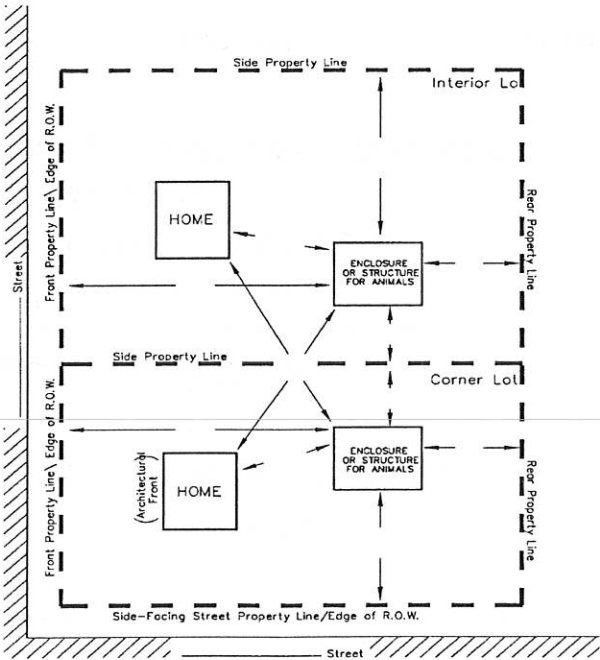

MINIMUM YARD SETBACKS
Barn, Corral, or Stable

NOTICE FOR APPLICANT (Please Read Before Signing)

Proposals for the installation of an individual water supply and for a sanitary waste disposal system (septic tank) for any structure designed for human occupation must be approved by the Weber County Health Department prior to installation.

Jim Jones 5-19-15
Planning Dept. Signature of Approval Date

This permit becomes null and void if use or construction authorized has not commenced within 180 days or if there is a zone change affecting this property. I hereby certify that I have read and examined this application and know the same to be true and correct. All provisions of laws and ordinances governing this land use will be complied with whether specified herein or not. I make this statement under penalty of perjury. I hereby agree to make the requirements as specified on this permit issued to the owner of land as signed below.

R. Blum
Contractor/Owner Signature of Approval Date



FINAL APPROVAL OF INDIVIDUAL WASTEWATER SYSTEM

2570 Grant Avenue
Ogden, Utah 84401
OFFICE (801) 399-8381
FAX (801) 399-8323

August 27, 2003

BLAINE LAND
7849 S 2100 E
SOUTH WEBER, UT 84405-

Permit No. W99954 ABSORPTION FIELD

This is to certify that on August 22, 2003 the Weber-Morgan Health Department made a final inspection of the individual wastewater disposal system installed at the construction site address of: 7390 N JEREMIAH JOHNSON in WEBER COUNTY, UTAH.

At the time of the final inspection, the wastewater system was found to be in compliance with the requirements of the Weber-Morgan Health Department. Approval to place the above-referenced wastewater system into service is hereby granted to **BLAINE LAND**.

This individual wastewater disposal system will require periodic maintenance to keep the system working properly. In addition, care must be taken not to disturb or damage the **ABSORPTION FIELD**. The attached document will provide you with information on the proper care and maintenance of this wastewater disposal system.

If you have any questions or need further assistance please contact this office at (801) 399-8381.



Representative, Weber-Morgan Health Department