

Ogden Valley Community Church

Landscape Plan

- * Evergreen Trees, spaced 40 ft apart, 6 ft tall, type TBD
- Maple Trees, minimum 2" trunk
- Shrubs, 5 gallon size, type TBD

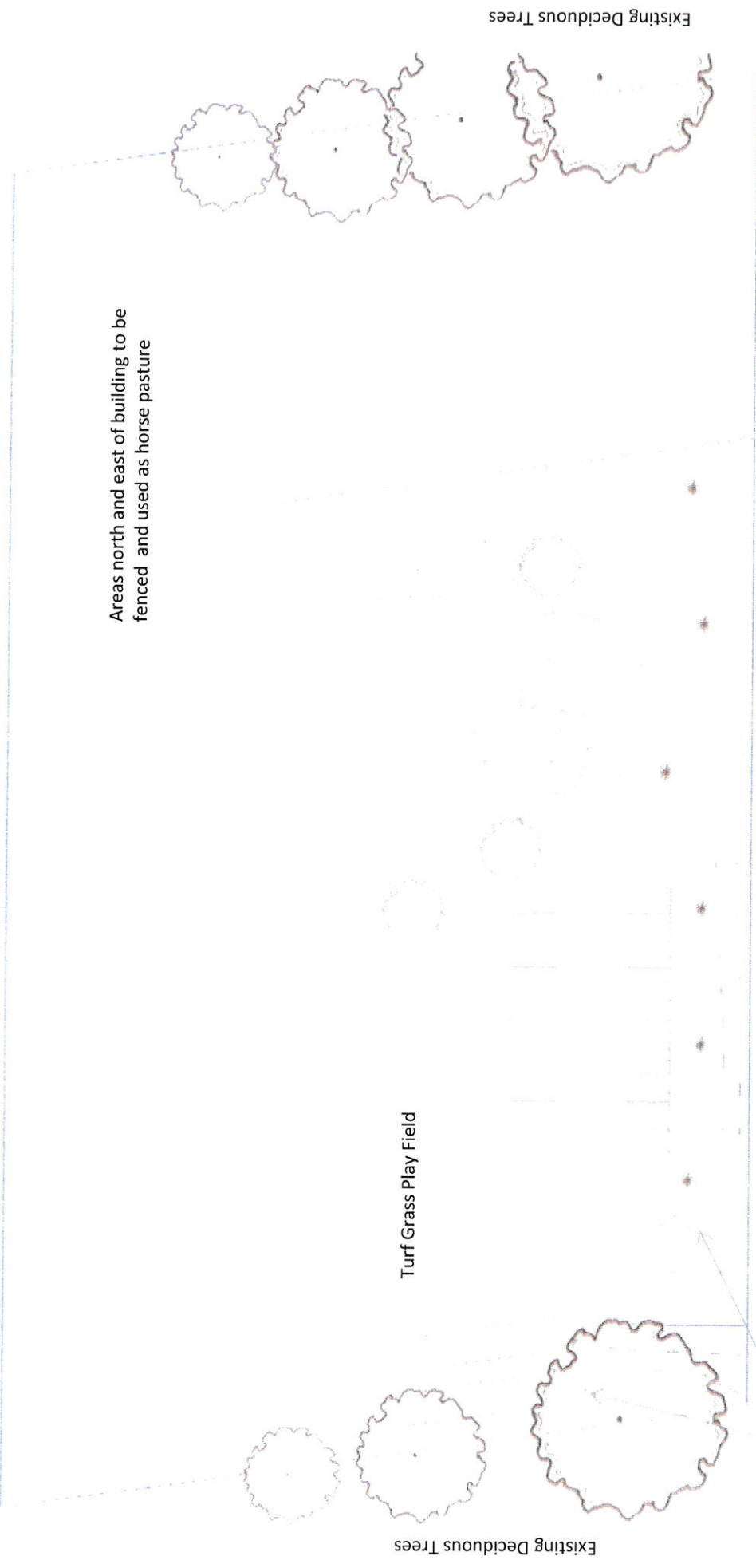

•All areas where shrubbery is shown will have mulch ground cover and decorative river rock borders when not otherwise separated by a walkway or driveway.
 •Walkways will be poured concrete or concrete pavers.
 •Irrigation for shrubs and trees will be via above-ground drip lines connected to secondary water pump.
 •Irrigation for turf grass will be via impact-rotary sprinklers fed by above-ground hoses connected to secondary water pump.
 •Area between the road and the parking lot/driveway to be seeded with natural grass.

Total Lot Area (approx. excluding road):	138384	sq ft
Non-developed area (horse pasture):	70379	sq ft
Developed area:	68132	sq ft
Pavement Area:	11219	sq ft
Building Area:	6250	sq ft
Landscaped Area:	50663	sq ft
Turf Grass Area:	25115	sq ft
% Total Lot Landscaped:	36.6	%
% Developed Area Landscaped:	74.4	%
% Landscaped Area Turf Grass:	49.6	%